

NO. OF COPIES RECEIVED	
DISTRIBUTION	
SANTA FE	
FILE	
U.S.G.S.	
LAND OFFICE	
OPERATOR	

# NEW MEXICO OIL CONSERVATION COMMISSION

Form C-101  
Revised 1-4-65

5A. Indicate Type of Lease  
STATE ☐ FEE ☒

5. State Oil & Gas Lease No.

## APPLICATION FOR PERMIT TO DRILL, DEEPEN, OR PLUG BACK

1a. Type of Work DRILL <input checked="" type="checkbox"/> DEEPEN <input type="checkbox"/> PLUG BACK <input type="checkbox"/>		7. Unit Agreement Name
b. Type of Well OIL WELL <input checked="" type="checkbox"/> GAS WELL <input type="checkbox"/> OTHER <input type="checkbox"/>		8. Farm or Lease Name Sanders
2. Name of Operator Adobe Oil Company		9. Well No. 1
3. Address of Operator 1100 Western United Life Bldg. - Midland, Texas 79701		10. Well No. & Location Cerca
4. Location of Well UNIT LETTER G LOCATED 1980 FEET FROM THE North LINE AND 1780 FEET FROM THE East LINE OF SEC. 27 TWP. 13-S RGE. 34-E NMPM		12. County Lea
19. Proposed Depth 10,900		19A. Formation Wolfcamp
20. Rotary or C.T. Rotary		
21. Elevations (Show whether DF, RT, etc.) 4128 Gr	21A. Kind & Status Plug. Bond	21B. Drilling Contractor Unknown
22. Approx. Date Work will start November 15, 1974		

## PROPOSED CASING AND CEMENT PROGRAM

SIZE OF HOLE	SIZE OF CASING	WEIGHT PER FOOT	SETTING DEPTH	SACKS OF CEMENT	EST. TOP
17-1/2	13-3/8	48	400'	300	Circ
11	8-5/8	24, 28, 32	4400	400	3600
7-7/8	5-1/2	17, 20	10,850	500	8500

APPROVAL VALID  
FOR 90 DAYS UNLESS  
DRILLING COMMENCED,

EXPIRES 1-23-75

IN ABOVE SPACE DESCRIBE PROPOSED PROGRAM: IF PROPOSAL IS TO DEEPEN OR PLUG BACK, GIVE DATA ON PRESENT PRODUCTIVE ZONE AND PROPOSED NEW PRODUCTIVE ZONE. GIVE BLOWOUT PREVENTER PROGRAM, IF ANY.

I hereby certify that the information above is true and complete to the best of my knowledge and belief.

Signed [Signature] Title Vice President Date October 21, 1974

(This space for State Use)

APPROVED BY [Signature] TITLE SUPERVISOR DISTRICT I DATE OCT 28 1974

CONDITIONS OF APPROVAL, IF ANY:

NEW MEXICO OIL CONSERVATION COMMISSION  
WELL LOCATION AND ACREAGE DEDICATION PL.

Form C-102  
Supersedes C-128  
Effective 1-1-65

All distances must be from the outer boundaries of the Section.

Operator <b>ADOBE OIL CO.</b>		Lease <b>SANDERS</b>		Well No. <b>1</b>	
Unit Letter <b>"G"</b>	Section <b>27</b>	Township <b>13-S</b>	Range <b>34-E</b>	County <b>LEA</b>	
Actual Footage Location of Well:					
1980 feet from the		NORTH line and		1780 feet from the EAST line	
Ground Level Elev. <b>4128</b>	Producing Formation <b>WOLFCAMP</b>		Pool <b>CERCA</b>		Dedicated Acreage: <b>160</b> <del>40</del> Acres

1. Outline the acreage dedicated to the subject well by colored pencil or hatchure marks on the plat below.
2. If more than one lease is dedicated to the well, outline each and identify the ownership thereof (both as to working interest and royalty).
3. If more than one lease of different ownership is dedicated to the well, have the interests of all owners been consolidated by communitization, unitization, force-pooling, etc?

☒ Yes ☐ No If answer is "yes," type of consolidation **POOLING AGREEMENT IN LEASES.**

If answer is "no," list the owners and tract descriptions which have actually been consolidated. (Use reverse side of this form if necessary.) \_\_\_\_\_

No allowable will be assigned to the well until all interests have been consolidated (by communitization, unitization, forced-pooling, or otherwise) or until a non-standard unit, eliminating such interests, has been approved by the Commission.

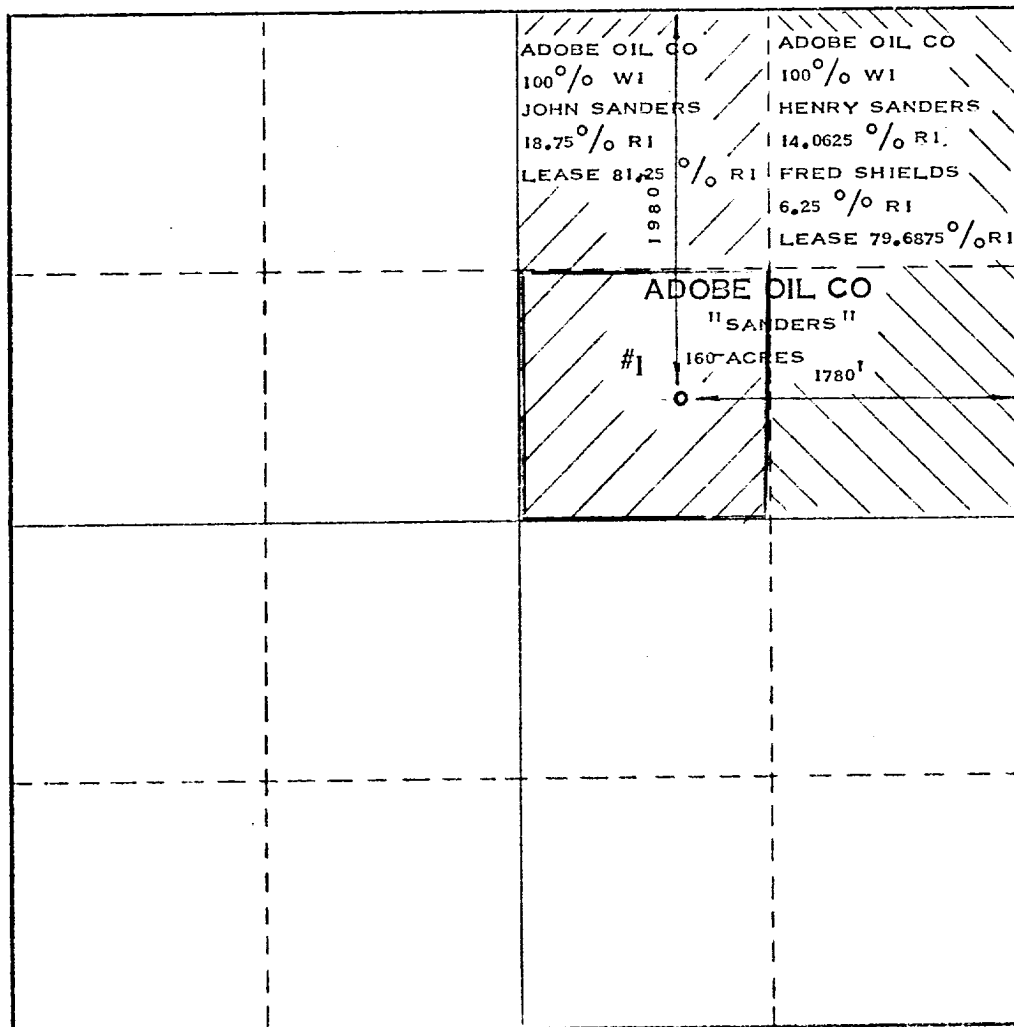

CERTIFICATION

I hereby certify that the information contained herein is true and complete to the best of my knowledge and belief.

*M. D. Rogers*

Name

**M. D. Rogers**

Position

**Vice President**

Company

**Adobe Oil Company**

Date

**October 21, 1974**

I hereby certify that the well location shown on this plat was plotted from field notes of actual surveys made by me or under my supervision, and that the same is true and correct to the best of my knowledge and belief.

Date Surveyed

**OCTOBER 17, 1974**

Registered Professional Engineer and Land Surveyor

*Max A. Schumann Jr.*

**MAX A. SCHUMANN JR.**

Certificate No.

**1510**

