

NEW MEXICO OIL CONSERVATION COMMISSION
WELL LOCATION AND ACREAGE DEDICATION PLAT

Form C-102
Supersedes C-128
Effective 1-1-65

All distances must be from the outer boundaries of the Section.

Operator R. L. BURNS, CORP.		Lease State 30		Well No. 2
Unit Letter B	Section 30	Township 13 South	Range 33 East	County Lea
Actual Footage Location of Well: 660 feet from the north line and 1980 feet from the east line				
Ground Level Elev. 4282.5	Producing Formation Bough "C"	Pool Baum Upper Basin	Dedicated Acreage: 160 Acres	

1. Outline the acreage dedicated to the subject well by colored pencil or hachure marks on the plat below.
2. If more than one lease is dedicated to the well, outline each and identify the ownership thereof (both as to working interest and royalty).
3. If more than one lease of different ownership is dedicated to the well, have the interests of all owners been consolidated by communitization, unitization, force-pooling, etc?

☒ Yes ☐ No If answer is "yes," type of consolidation One lease

If answer is "no," list the owners and tract descriptions which have actually been consolidated. (Use reverse side of this form if necessary.)

No allowable will be assigned to the well until all interests have been consolidated (by communitization, unitization, forced-pooling, or otherwise) or until a non-standard unit, eliminating such interests, has been approved by the Commission.

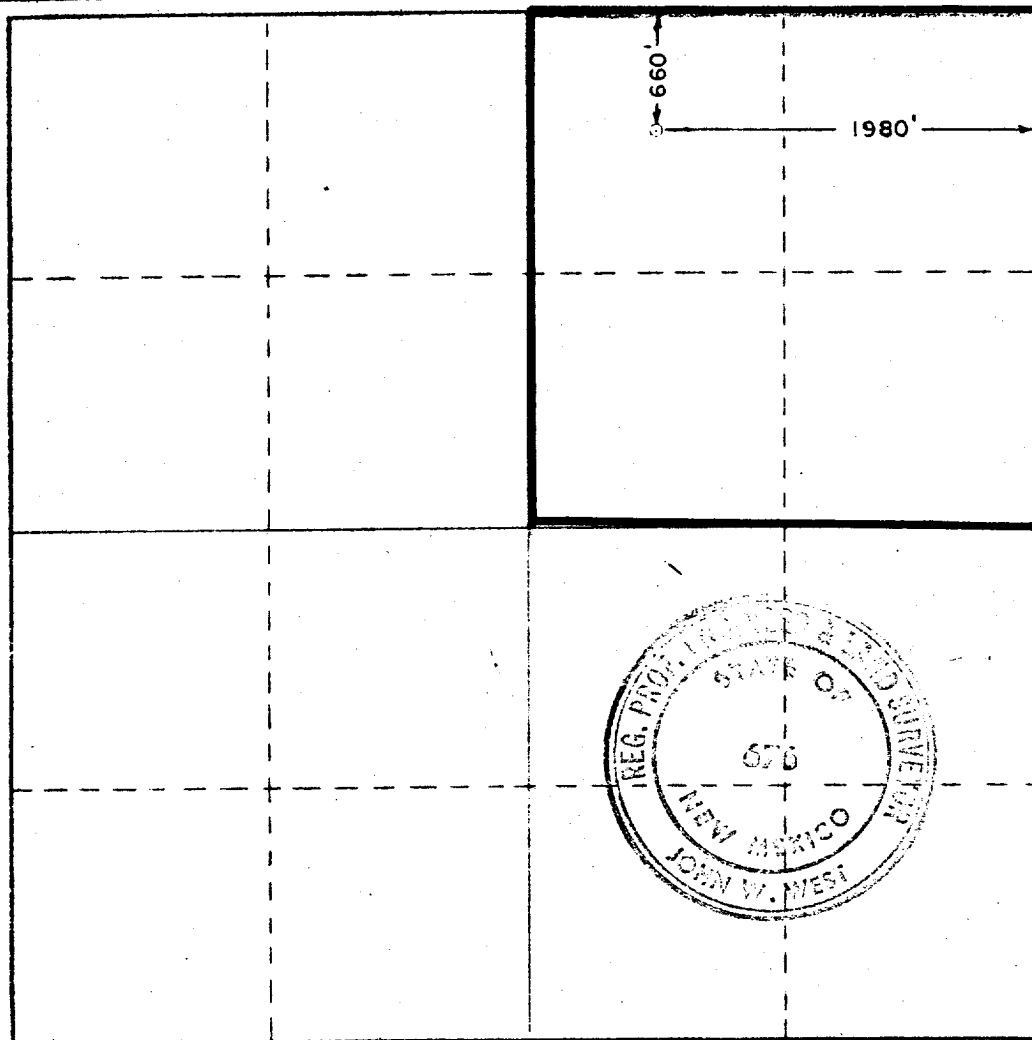

CERTIFICATION

I hereby certify that the information contained herein is true and complete to the best of my knowledge and belief.

Wayne Carlton
Name

Wayne Carlton
Position

Production Engineer
Company

R. L. Burns Corp.
Date

October 22, 1976

I hereby certify that the well location shown on this plat was plotted from field notes of actual surveys made by me or under my supervision, and that the same is true and correct to the best of my knowledge and belief.

Date Surveyed

Oct. 19, 1976

Registered Professional Engineer and/or Land Surveyor

John W. West
Certificate No. **676**

0 330 660 990 1320 1650 1980 2310 2640 2970 3300 3630 3960 4290 4620 4950 5280 5610 5940 6270 6600

RECEIVED

OCT 2 1978

OIL CONSERVATION BOARD
WASHINGTON, D.C.

114

[illegible]

IP (Upper Pennsylvanian) Perfs 9803-11' P 94 BOPD + 126 BW.
Pot based on 24 hr test. GOR 893; gty 42.1

CONTR Robinson Bros. OPER'S ELEV 4283' GL, 4294' KB PD 10,000' RT

F.R. 11-1-76
(Pennsylvanian)
11-8-76 TD 4054'; WOC
11-15-76 Drlg 5255'
12-1-76 Drlg 9646'
12-13-76 TD 9965'; WOCU
1-5-77 TD 9965'; PBD 9910'; Prep Acid
Perf (Upper Pennsylvanian) @ 9803', 9804', 9805',
9807', 9810', 9811' w/2 SPI
1-11-77 TD 9965'; PBD 9910'; Tstg
Acid (9803-11') 3150 gals (15%)
1-17-77 TD 9965'; PBD 9910'; Complete
LOG TOPS: Yates 2518', San Andres 3967', Glorieta
5412', Tubb 6819', Abo 7521', Wolfcamp 8959',
Pennsylvanian 9640', Bough "C" 9725' 1-4-16 NM

LEA
BURNS, R. L. CORP. . . . Baum
2 State "30"
Sec 30, T13S, R33E

NM
Page #2

1-17-77 Continued
LOGS RUN: DILL, FDC, M1CL
BHT 135 deg
1-22-77 COMPLETION ISSUED

1-4-16 NM
IC 30-025-70216-76
