

STATE OF NEW MEXICO  
ENERGY AND MINERALS DEPARTMENT

OIL CONSERVATION DIVISION  
P. O. BOX 2088  
SANTA FE, NEW MEXICO 87501

Form C-101  
Revised 10-1-78

NO. OF COPIES RECEIVED	
DISTRIBUTION	
SANTA FE	
FILE	
U.S.G.S.	
LAND OFFICE	
OPERATOR	

5A. Indicate Type of Lease	
STATE <input type="checkbox"/>	FEE <input checked="" type="checkbox"/>
5. State Oil & Gas Lease No.	

APPLICATION FOR PERMIT TO DRILL, DEEPEN, OR PLUG BACK

1a. Type of Work		7. Unit Agreement Name	
b. Type of Well DRILL <input checked="" type="checkbox"/> DEEPEN <input type="checkbox"/> PLUG BACK <input type="checkbox"/> OIL WELL <input checked="" type="checkbox"/> GAS WELL <input type="checkbox"/> OTHER <input type="checkbox"/> SINGLE ZONE <input checked="" type="checkbox"/> MULTIPLE ZONE <input type="checkbox"/>		8. Farm or Lease Name Field	
2. Name of Operator DyAd Associates		9. Well No. 1	
3. Address of Operator 1107 Petroleum Bldg.; Midland, Texas 79701		10. Field and Pool, or Wildcat Gladiola	
4. Location of Well UNIT LETTER <u>G</u> LOCATED <u>1980</u> FEET FROM THE <u>North</u> LINE AND <u>1700</u> FEET FROM THE <u>East</u> LINE OF SEC. <u>25</u> TWP. <u>12-S</u> RGE. <u>37-E</u> NMPM		11. DESIGNATED	
		12. County Lea	
		19. Proposed Depth 12,500	
		19A. Formation Devonian	
		20. Rotary or C.T. Rotary	
21. Elevations (Show whether DF, RT, etc.) 3873.2 GL		21A. Kind & Status Plug. Bond 1 well- \$10,000	
		21B. Drilling Contractor Moranco	
		22. Approx. Date Work will start 3-20-84	

PROPOSED CASING AND CEMENT PROGRAM

SIZE OF HOLE	SIZE OF CASING	WEIGHT PER FOOT	SETTING DEPTH	SACKS OF CEMENT	EST. TOP
17-1/2"	13-3/8"	48#	400'	380 sks.	surface
11"	8-5/8"	24 & 32#	4500'	1600 sks.	surface
7-7/8"	5-1/2"	17#	12,500'	540 sks.	9000'

APPROVAL VALID FOR 180 DAYS  
PERMIT EXPIRES 9/19/84  
UNLESS DRILLING UNDERWAY

IN ABOVE SPACE DESCRIBE PROPOSED PROGRAM: IF PROPOSAL IS TO DEEPEN OR PLUG BACK, GIVE DATA ON PRESENT PRODUCTIVE ZONE AND PROPOSED NEW PRODUCTIVE ZONE. GIVE BLOWOUT PREVENTER PROGRAM, IF ANY.

I hereby certify that the information above is true and complete to the best of my knowledge and belief.

Signed Tom D. Lynch Title Partner Date 3-14-84

(This space for Same Use)

ORIGINAL SIGNED BY JERRY SEXTON

MAR 19 1984

APPROVED BY DISTRICT 1 SUPERVISOR TITLE  DATE

CONDITIONS OF APPROVAL, IF ANY:

RECEIVED  
MAR 15 1984  
O.C.D.  
HOBBS OFFICE

NEW MEXICO OIL CONSERVATION COMMISSION  
WELL LOCATION AND ACREAGE DEDICATION PLAT

Superintendent

All distances must be from the water bearing formation.

DYAD ASSOCIATES			FIELD		
G	Section 25	Township 12S	Range 37E	LEA	
1980 NORTH 1700 EAST					
1980		line and		40	
873.2		Devonian		Gladiola	

- Outline the acreage dedicated to the subject well by colored pencil or hatchure marks on the plat below.
- If more than one lease is dedicated to the well, outline each and identify the ownership thereof (both as to working interest and royalty).
- If more than one lease of different ownership is dedicated to the well, have the interests of all owners been consolidated by communitization, unitization, force-pooling, etc?

☐ Yes ☐ No If answer is "yes" type of consolidation \_\_\_\_\_

If answer is "no" list the owners and tract descriptions which have actually been consolidated. (Use reverse side of this form if necessary.) \_\_\_\_\_

No allowable will be assigned to the well until all interests have been consolidated (by communitization, unitization, forced-pooling, or otherwise) or until a non-standard unit, eliminating such interests, has been approved by the Commission.

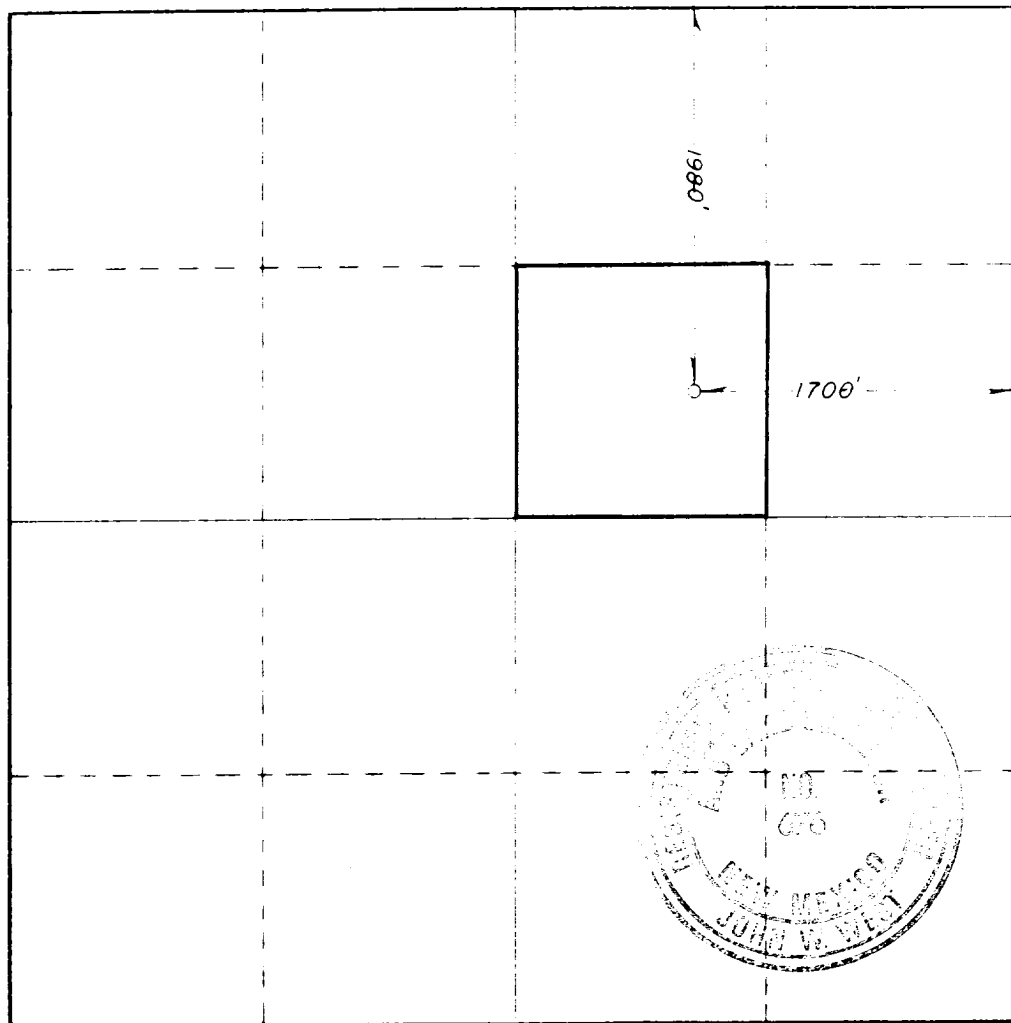

CERTIFICATION

I hereby certify that the information contained herein is true and complete to the best of my knowledge and belief.

*Tom O. Dykes*  
Partner  
DyAd Associate  
3-14-84

I hereby certify that the well location shown on this plat was plotted from field notes of actual surveys made by me or under my supervision, and that the same is true and correct to the best of my knowledge and belief.

3/8/84

Registered Interest and Location  
of the Well

*John W. West*

Certificate No. JOHN W. WEST  
RONALD J. EASON

330 660 990 1320 1650 1980 2310 2640 2970 3300 3630 3960 4290 4620 4950 5280 5610 5940 6270 6600 6930 7260 7590 7920 8250 8580 8910 9240 9570 9900

RECEIVED  
MAR 15 1984  
O.C.D.  
HOBBS OFFICE

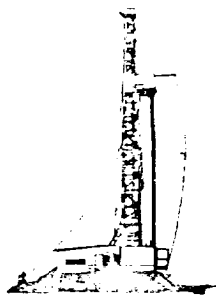

**9,000' – 14,000'**

P.O. Box 1860 • Hobbs, New Mexico 88240 • 505/397-3511 • 915/563-0562

### **DRAWWORKS**

Brewster N-75  
Drum: 1 1/4" Lebus grooved  
Compound: 2-engine oil bath chain drive  
Brake: Hydromatic Parkersburg 40"  
Satellite Automatic Driller  
Duo-O-Matic Crown Block Protector

### **ENGINES**

Two 610-H.P. D379TA Caterpillar Diesel.

### **DERRICK**

Lee C. Moore, 131', 550,000-lb. nominal capacity.

### **SUBSTRUCTURE**

Lee C. Moore, 14 1/2' high, 550,000-lb. nominal capacity.

### **MUD PUMPS**

Pump No. 1: Emsco DB700, 700-H.P. with steel fluid end,  
4 3/4" – 7 3/4" liners, 16" stroke, Compound driven.  
Pump No. 2: Emsco 500, 500-H.P. powered by D379  
Caterpillar Diesel.

### **DRILL STRING**

3,000' 4 1/2" Grade E, 20-lb.  
Tool Joints: 4 1/2" XH, 6 1/4" OD  
11,000' 4 1/2" Grade E, 16.60-lb.  
Tool Joints: 4 1/2" XH, 6 1/4" OD  
Thirty Drilco spiral-grooved 6 1/2" OD, 2 1/4" ID with 4 1/2" H-90  
Joints.  
Other sized drillpipe and drillcollars available.

### **BLOWOUT PREVENTERS**

One Shaffer LWS hydraulic double 11" x 5,000 p.s.i. One  
Hyaril 11" x 5,000 p.s.i. Choke manifold 4" x 5,000 p.s.i.  
fringed connections. Payne 4-valve accumulator closing  
unit.

### **MUD SYSTEM**

Three 30' x 7 1/2' x 6' steel pits with 700-bbl capacity and  
one 250-bbl slug pit. Complete low pressure circulating  
system, consisting of four submerged mud guns and two  
countersunk jets in each pit. System utilizes a 6 x 8  
centrifugal pump, powered by diesel.

### **MUD HOUSE**

One 8' x 30' Steel Storage House.

### **COMMUNICATIONS**

24-hour direct telephone interconnection through Hobbs  
(505/393-1111) or Midland-Odessa (915/563-0562).

### **OTHER EQUIPMENT**

**BLOCKS.** 350-ton.

**HOOK.** 350-ton.

**SWIVEL.** 350-ton.

**ROTARY TABLE.** 20 1/2".

**SHALE SHAKER.** Harrisburg single screen.

**ELECTRICAL POWER.** Two 50-kw AC generators powered  
by diesel engines. AC fluorescent or mercury lights. All  
vapor-proof.

**FRESH WATER STORAGE.** Three 500-bbl horizontal tanks.

**HOUSING.** One 12' x 65' air-conditioned trailer house with  
sleeping and cooking facilities.