

NEW MEXICO OIL CONSERVATION COMMISSION
WELL LOCATION AND ACREAGE DEDICATION PLAT

Form O-102
Supersedes O-128
Effective 1-1-77

All distances must be from the outer boundaries of the Section

Operator RAPID COMPANY INC.			Lease McKay State		Well No. 2
Tract Letter '0'	Section 18	Township 13 South	Range 32 East	County Lea	
Actual Surface Location of Well: 660 feet from the South line and 1980 feet from the East line					
Ground Level Elev. 4362.6	Producing Formation Queen		Pool Caprock	Dedicated Acreage: 40 Acres	

1. Outline the acreage dedicated to the subject well by colored pencil or hachure marks on the plat below.
2. If more than one lease is dedicated to the well, outline each and identify the ownership thereof (both as to working interest and royalty).
3. If more than one lease of different ownership is dedicated to the well, have the interests of all owners been consolidated by communitization, unitization, force-pooling, etc?

☐ Yes ☐ No If answer is "yes," type of consolidation _____

If answer is "no," list the owners and tract descriptions which have actually been consolidated. (Use reverse side of this form if necessary.) _____

No allowable will be assigned to the well until all interests have been consolidated (by communitization, unitization, forced-pooling, or otherwise) or until a non-standard unit, eliminating such interests, has been approved by the Commission.

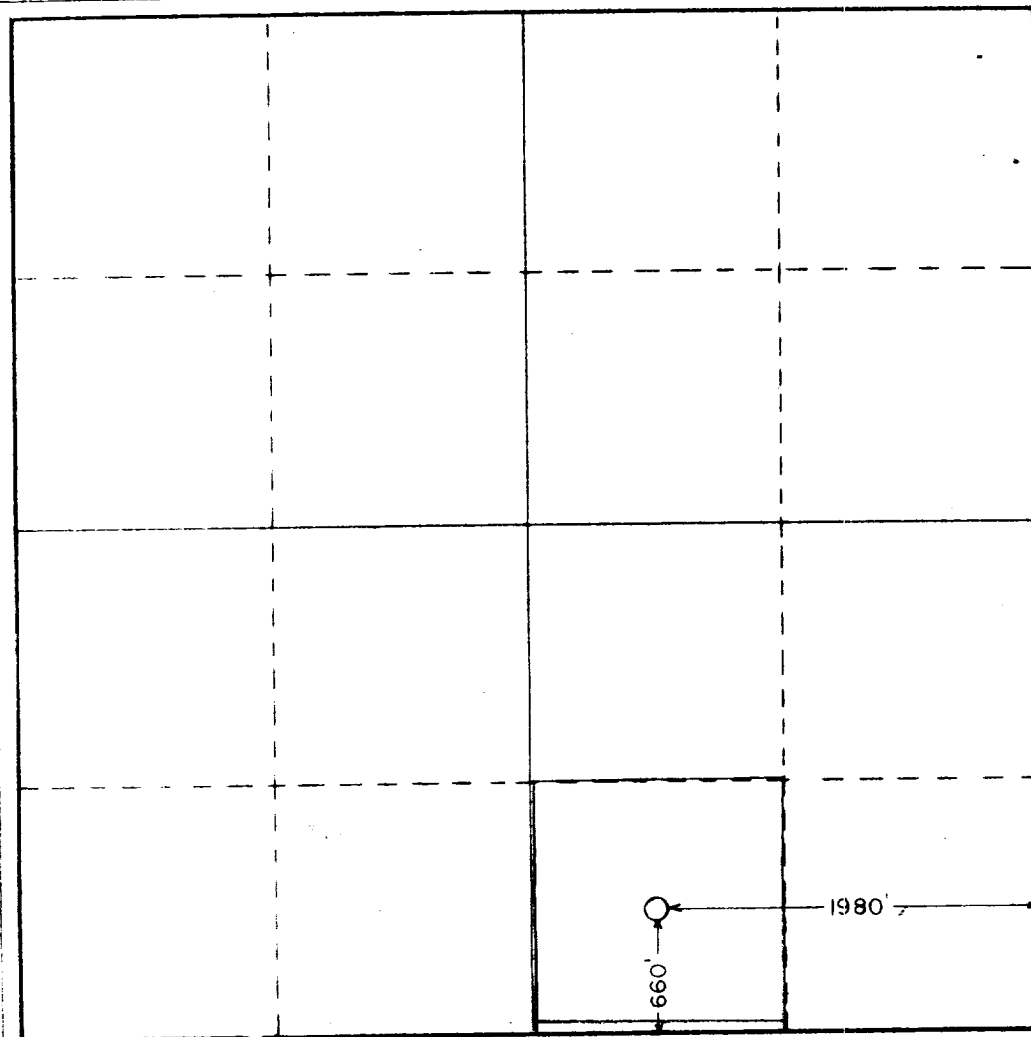

CERTIFICATION

I hereby certify that the information contained herein is true and complete to the best of my knowledge and belief.

Name
Thomas H. Jones
Position
Agent
Company
Rapid Company, Inc.
Date
11/13/79

I hereby certify that the location shown on this plat was plotted from notes of surveys made by _____ under my supervision, and that the same is true and correct to the best of my knowledge and belief. 3640

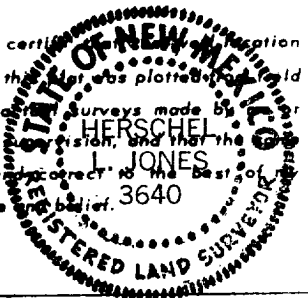

Date Surveyed
November 13, 1979
Registered Professional Engineer
and/or Land Surveyor

Thomas H. Jones
Certificate No. 3640

RECEIVED
NOV 13 1979
Q.C.D. HOBBS, OFFICE



9-3-6 NM
IC 30-025-70457-79