

**NEW MEXICO OIL CONSERVATION COMMISSION
WELL LOCATION AND ACREAGE DEDICATION PLAT**

Form C-102
Superseding C-128
Effective 1-1-65

All distances must be from the outer boundaries of the Section.

Operator Maguire Oil Co.			Lease Hodge		Well No. 1
Unit Letter C	Section 33	Township 12 South	Range 38 East	County Lea	
Actual Footage Location of Well: 1980 feet from the West line and 330 feet from the North line					
Ground Level Elev. 3821.75	Producing Formation Wolfcamp & Devonian		Pool Wildcat	Dedicated Acreage: 40	

1. Outline the acreage dedicated to the subject well by colored pencil or hachure marks on the plat below.
2. If more than one lease is dedicated to the well, outline each and identify the ownership thereof (both as to working interest and royalty).
3. If more than one lease of different ownership is dedicated to the well, have the interests of all owners been consolidated by communitization, unitization, force-pooling, etc?

☐ Yes ☒ No If answer is "yes," type of consolidation _____

If answer is "no," list the owners and tract descriptions which have actually been consolidated. (Use reverse side of this form if necessary.) See attached list

No allowable will be assigned to the well until all interests have been consolidated (by communitization, unitization, forced-pooling, or otherwise) or until a non-standard unit, eliminating such interests, has been approved by the Commission.

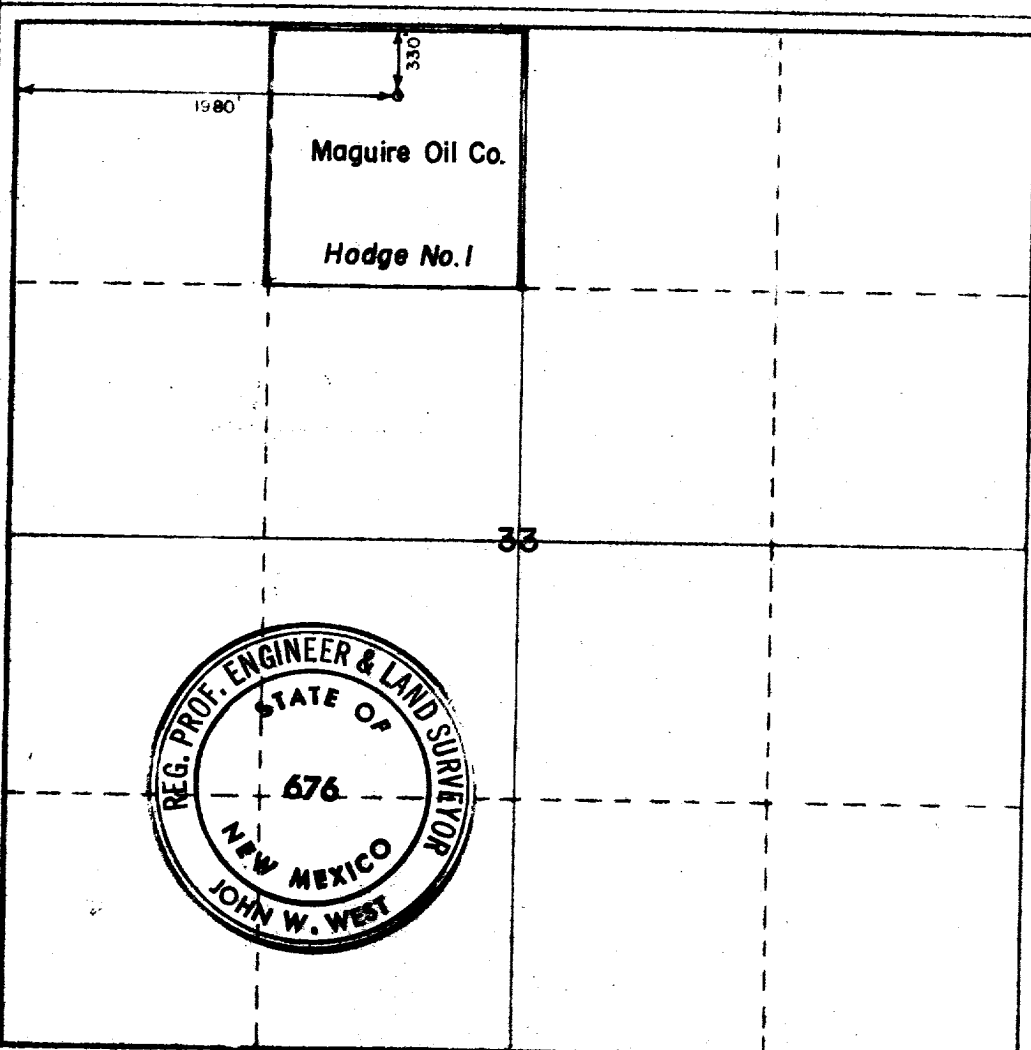

CERTIFICATION

I hereby certify that the information contained herein is true and complete to the best of my knowledge and belief.

G.T. Coffman
Name

G.T. Coffman

Position

Vice President

Company

Maguire Oil Company

Date

November 26, 1979

I hereby certify that the well location shown on this plat was plotted from field notes of actual surveys made by me or under my supervision, and that the same is true and correct to the best of my knowledge and belief.

Date Surveyed

11-13-79

Registered Professional Engineer and/or Land Surveyor

John W. West

Certificate No **JOHN W. WEST 676**
PATRICK A. ROMERO 6883
Ronald J. Eideen 3239

LEASE SCHEDULE

<u>NAME/ROYALTY OWNER'S</u>	<u>TRACT</u>	<u>NET ACRES</u>	<u>EXPIRATION DATE</u>
John L. Smith	$W\frac{1}{2}E\frac{1}{2}$ Sec. 32, $E\frac{1}{2}W\frac{1}{2}$ Sec. 33	104.17	9/8/82
Wm. R. Colvin	Sec. 33, $W\frac{1}{2}$	15	8/17/82
A. R. Brown	Sec. 33, $W\frac{1}{2}$	10	8/28/82
L. L. Ford	Sec. 33, $W\frac{1}{2}$	30	10/4/84
Alice Jones	Sec. 33, $W\frac{1}{2}$	7.5	10/11/82
J. D. Jones, Ind & Tr	Sec. 33, $W\frac{1}{2}$	1.875	10/9/82
Texas Commerce Bk, Tr.	Sec. 33, $W\frac{1}{2}$	4.875	10/9/82
J. P. Hodge	Sec. 33, $W\frac{1}{2}$	28.333	12/31/82
<u>WORKING INTEREST OWNER'S</u>			
Maguire Oil Company	37.50%		
Penn Explorations Ltd/1979	18.75%		
Joseph Petroleum Corp.	12.50%		
Western Reserve	25%		
	<u>1.0000%</u>		

RECEIVED

NOV 28 1979

OIL CONSERVATION DIV.

111