

NO. OF COPIES RECEIVED	
DISTRIBUTION	
SANTA FE	
FILE	
U.S.G.S.	
LAND OFFICE	
OPERATOR	

NEW MEXICO OIL CONSERVATION COMMISSION

30-025-26603

Form C-101
Revised 1-1-65

5A. Indicate Type of Lease
STATE <input checked="" type="checkbox"/> FEE <input type="checkbox"/>
5. State Oil & Gas Lease No.
K-5919

APPLICATION FOR PERMIT TO DRILL, DEEPEN, OR PLUG BACK

1a. Type of Work		7. Unit Agreement Name	
b. Type of Well DRILL <input checked="" type="checkbox"/> DEEPEN <input type="checkbox"/> PLUG BACK <input type="checkbox"/> OIL WELL <input checked="" type="checkbox"/> GAS WELL <input type="checkbox"/> OTHER <input type="checkbox"/> SINGLE ZONE <input checked="" type="checkbox"/> MULTIPLE ZONE <input type="checkbox"/>		8. Name or Lease Name	
2. Name of Operator		9. Well No.	
Southland Royalty Company		1	
3. Address of Operator		10. Field	
1100 Wall Towers West, Midland, Texas 79701		Baum Upper Penn North	
4. Location of Well		11. County	
UNIT LETTER N LOCATED 660 FEET FROM THE south LINE		Lea	
AND 1980 FEET FROM THE west LINE OF SEC. 25 TWP. 13S RGE. 32E NMDM			
15. Proposed Depth		16. Formation	
10,000'		Penn	
21. Elevation (show whether DT, RL, etc.)		22. Rotary or C.T.	
4300.4' GR		Rotary	
21A. Kind & Status Plug. Bond		22. Approx. Date Work will start	
Blanket		1-5-80	
21B. Drilling Contractor			
Hondo Drlg.			

23.

PROPOSED CASING AND CEMENT PROGRAM

SIZE OF HOLE	SIZE OF CASING	WEIGHT PER FOOT	SETTING DEPTH	SACKS OF CEMENT	EST. TOP
17 1/2"	13 3/8"	48#	360'	375	Circ.
11"	8 5/8"	28 & 24#	4100'	950	Circ.
7 7/8"	5 1/2"	17 & 15.5#	10,000'	420	7000'

Set surface csg. @ 360'. Circ. cement. Drill 11" hole with brine water to prevent washout to 4100'. Set 8 5/8" csg & cmt. w/950 sx. circ. cmt. Drill 7 7/8" hole to TD of 9970'. Run logs. If commercial, cmt. 5 1/2" csg. w/420 sx. cmt. Est cmt top @ 7000'.

MUD PROGRAM: 0-360 spud mud, 360-4100 brine water, paper & starch for seepage, 4100-9000' fresh water, 9000-TD fresh water mud, vis 32, fluid loss 10-12 cc. MW 8.5.

BOP PROGRAM: Test BOP each new installation. Test w/Yellow Jacket Inc. after setting 8 5/8" csg. Test BOP @ 9000'.

IN ABOVE SPACE DESCRIBE PROPOSED PROGRAM; IF PROPOSAL IS TO DEEPEN OR PLUG BACK, GIVE DATA ON PRESENT PRODUCTIVE ZONE AND PROPOSED NEW PRODUCTIVE ZONE. GIVE BLOWOUT PREVENTER PROGRAM, IF ANY.

I hereby certify that the information above is true and complete to the best of my knowledge and belief.

Signed C. Harvey Can Title District Engineer Date 12-17-79
(This space for State Use)

APPROVED BY [Signature] TITLE SUPERVISOR DISTRICT I DATE DEC 26 1979
CONDITIONS OF APPROVAL, IF ANY:

RECEIVED
DEC 0 1979

RECEIVED
DEC 20 1979
OIL CONSERVATION DIV

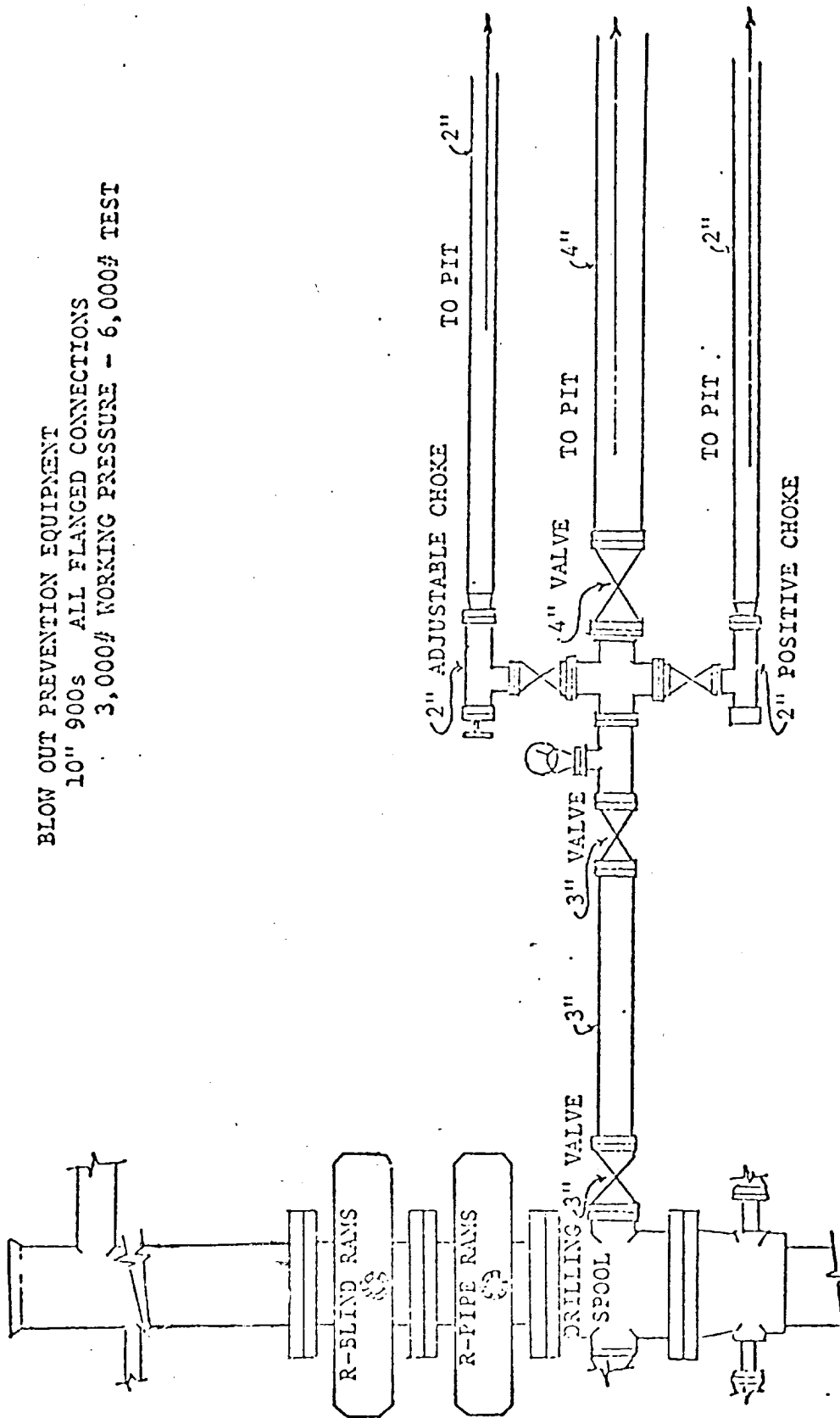

BLOW OUT PREVENTION EQUIPMENT
 10" 900s ALL FLANGED CONNECTIONS
 3,000# WORKING PRESSURE - 6,000# TEST

**NEW MEXICO OIL CONSERVATION COMMISSION
WELL LOCATION AND ACREAGE DEDICATION PLAT**

Form C-107
Supersedes C-128
Effective 1-1-65

All distances must be from the outer boundaries of the Section

Operator Southland Royalty Co			Lease Lea State		Well No. 1
Unit Letter N	Section 25	Township 13 South	Range 32 East	County Lea	
Actual Footage Location of Well: 660 feet from the South line and 1980 feet from the West line					
Ground Level Elev. 4300.4	Producing Formation BOUGH C (PENN)		Pool BAUM NORTH Upper Penn	Dedicated Acreage 160	

1. Outline the acreage dedicated to the subject well by colored pencil or hatchure marks on the plat below.
2. If more than one lease is dedicated to the well, outline each and identify the ownership thereof (both as to working interest and royalty).
3. If more than one lease of different ownership is dedicated to the well, have the interests of all owners been consolidated by communitization, unitization, force-pooling, etc?

☐ Yes ☒ No If answer is "yes," type of consolidation _____

If answer is "no," list the owners and tract descriptions which have actually been consolidated. (Use reverse side of this form if necessary.) _____

No allowable will be assigned to the well until all interests have been consolidated (by communitization, unitization, forced-pooling, or otherwise) or until a non-standard unit, eliminating such interests, has been approved by the Commission.

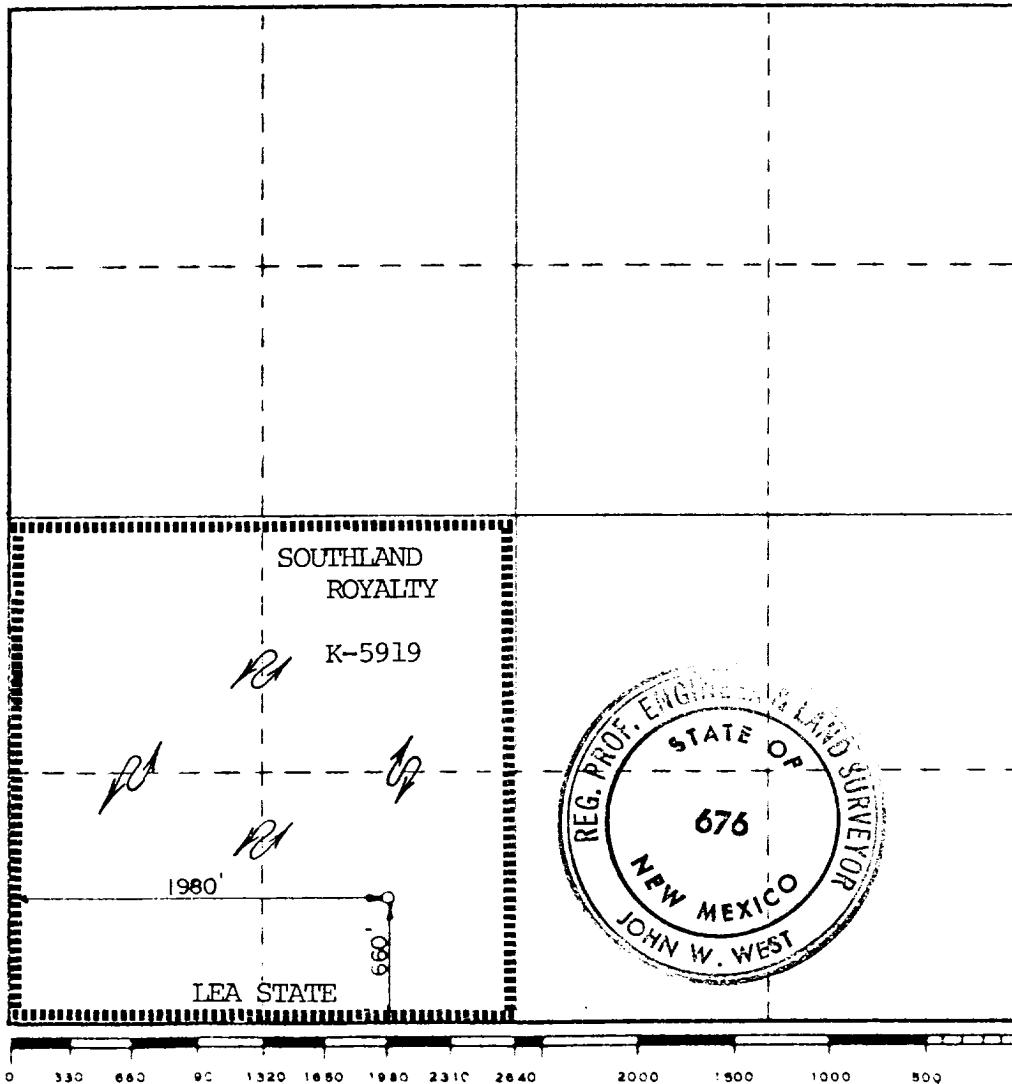

CERTIFICATION

I hereby certify that the information contained herein is true and complete to the best of my knowledge and belief.

C. Harvey Can

Name
District Engineer
Position
Southland Royalty Company
Company
12-14-79
Date

I hereby certify that the well location shown on this plat was plotted from field notes of actual surveys made by me or under my supervision and that the same is true and correct to the best of my knowledge and belief.

Date Surveyed
December 4, 1979
Registered Professional Engineer and/or Land Surveyor
John W. West
Certificate No. **John W. West 676**
Ronald J. Edison 1234

RECEIVED
DEC 20 1979
OIL CONSUMPTION

111