

DISTRICT I  
1625 N. French Dr., Hobbs, NM 88240

State of New Mexico  
Energy, Minerals and Natural Resources Department

Form C-101  
Revised March 17, 1999  
Instructions on back  
Submit to appropriate District Office  
State Lease - 6 Copies  
Fee Lease - 5 Copies

DISTRICT II  
811 South First, Artesia, NM 88210

OIL CONSERVATION DIVISION

PO BOX 2088  
Santa Fe, NM 87504-2088

DISTRICT III  
1000 Rio Brazos Rd., Aztec, NM 87410

DISTRICT IV  
2040 South Pacheco, Santa Fe, NM 87501

☐ AMENDED REPORT

APPLICATION FOR PERMIT TO DRILL, RE-ENTER, DEEPEN, PLUGBACK, OR ADD A ZONE

<sup>1</sup> Operator Name and Address Yates Petroleum Corporation 105 South Fourth Street Artesia, New Mexico 88210		<sup>2</sup> OGRID Number 025575
		<sup>3</sup> API Number 30-025-27224
<sup>4</sup> Property Code 2692D	<sup>5</sup> Property Name Dome Nonombre "AWZ" State	<sup>6</sup> Well No. #7 S

<sup>7</sup> Surface Location

UL or lot no.	Section	Township	Range	Lot Idn	Feet from the	North/South Line	Feet from the	East/West Line	County
H	31	13 S	34 E		1980	North	660	East	Lea

<sup>8</sup> Proposed Bottom Hole Location If Different From Surface

UL or lot no.	Section	Township	Range	Lot Idn	Feet from the	North/South Line	Feet from the	East/West Line	County
H	31	13 S	34E		1857	North	206	East	Lea
<sup>9</sup> Proposed Pool 1 Wildcat Mississippian					<sup>10</sup> Proposed Pool 2				

<sup>11</sup> Work Type Code E	<sup>12</sup> Well Type Code G	<sup>13</sup> Cable/Rotary R	<sup>14</sup> Lease Type Code S	<sup>15</sup> Ground Level Elevation 4164.8'
<sup>16</sup> Multiple No	<sup>17</sup> Proposed Depth 13,174'	<sup>18</sup> Formation Mississippian	<sup>19</sup> Contractor Not Determined	<sup>20</sup> Spud Date ASAP

<sup>21</sup> Proposed Casing and Cement Program

Hole Size	Casing Size	Casing weight/feet	Setting Depth	Sacks of Cement	Estimated TOC
17 1/2"	13 3/8'	48#	390'-in place	400 sx	Circulated
12 1/4"	8 5/8"	24# & 32#	4204'-in place	2300 sx	Circulated
7 7/8"	5 1/2"-cutoff	17# & 20#	5037'-13,174'	2000 sx	Approx. 5050'
7 7/8"	5 1/2"	17# & 20#	0-5037'	500 sx	Into 8 5/8" casing

<sup>22</sup> Describe the proposed program. If this application is to DEEPEN or PLUG BACK give the data on the present productive zone and proposed new productive zone. Describe the blowout prevention program, if any. Use additional sheets if necessary.

Approval for RE-Entry -- CANNOT produce until Non-Standard Bottomhole Location is approved in Santa Fe.  
See attached sheet for proposed program.

Permit Expires 1 Year From Approval

Re-Entry

my knowledge and belief. Signature: <i>Clifton May</i>		OIL CONSERVATION DIVISION	
Printed name: Clifton May		Approved by: <i>[Signature]</i>	
Title: Regulatory Agent		Title: <i>[Signature]</i>	
Date: 11/17/00	Phone: (505) 748-1471	Approval Date: NOV 21 2000	Expiration Date:
		Conditions of Approval Attached <input type="checkbox"/>	

JCE

dp

## **YATES PETROLEUM CORPORATION**

Dome Nonombre "AWZ" State #1

1980' FNL & 660' FEL (Surface Location)

1857' FNL & 206' FEL (Bottom Hole Location)

Section 31, T. 13 S., R. 34 E

Lea County, New Mexico

Lease #VA-1439

### **PROPOSED PLANS:**

Yates Petroleum Corporation proposes to re-enter this well using a pulling unit. Will drill out the plugs to the 8 5/8" casing shoe at 4204' and pressure test casing. Then drill out the plug at the 5 1/2" casing stub at 5037', dress off and splice the 5 1/2" casing and cement with sufficient volume of class C cement (500 sacks) to tie back into the 8 5/8" casing. Yates will then drill plugs inside the 5 1/2" casing to PBTD at approximately 13,100' (TD is 13,142' measured depth). Existing and new Morrow and Atoka zones will be tested. A 3000 psi BOP will be installed on the 8 5/8' casing at the beginning of operations and will be tested daily for operational.

Mud to be used for splicing the 5 1/2" casing will be 9.0 ppg with 33-40 vis. Inside casing, 2% KCL water will be used. Bit sizes will be 7 7/8" inside the 8 5/8" casing and open hole, and 4 3/4" inside the 5 1/2" casing. A directional survey will be run to determine bottom hole location for the Morrow and Atoka.

District I

1625 N. French Dr., Hobbs, NM 88240

District II

811 South First, Artesia, NM 88210

District III

1000 Rio Brazos Rd., Aztec, NM 87410

District IV

2040 South Pacheco, Santa Fe, NM 87505

State of New Mexico  
Energy, Minerals & Natural Resources

OIL CONSERVATION DIVISION  
2040 South Pacheco  
Santa Fe, NM 87505

Form C-102  
Revised March 17, 1999

Submit to Appropriate District Office  
State Lease - 4 Copies  
Fee Lease - 3 Copies

☐ AMENDED REPORT

WELL LOCATION AND ACREAGE DEDICATION PLAT

1 API Number 30-025-27224		2 Pool Code ✓		3 Pool Name Wildcat Mississippian		
4 Property Code 26920		5 Property Name Dome Nonombre "AWZ" State			6 Well Number 1	
7 OGRID No. 025575		8 Operator Name Yates Petroleum Corporation			9 Elevation 4164.8'	

10 Surface Location

UL or lot no. H	Section 31	Township 13S	Range 34E	Lot Idn	Feet from the 1980'	North/South line North	Feet from the 660'	East/West line East	County Lea
--------------------	---------------	-----------------	--------------	---------	------------------------	---------------------------	-----------------------	------------------------	---------------

11 Bottom Hole Location If Different From Surface

UL or lot no. H	Section 31	Township 13 S	Range 34E	Lot Idn	Feet from the 1857	North/South line North	Feet from the 206'	East/West line East	County Lea
12 Dedicated Acres 320		13 Joint or Infill		14 Consolidation Code		15 Order No.			

NO ALLOWABLE WILL BE ASSIGNED TO THIS COMPLETION UNTIL ALL INTERESTS HAVE BEEN CONSOLIDATED OR A NON-STANDARD UNIT HAS BEEN APPROVED BY THE DIVISION

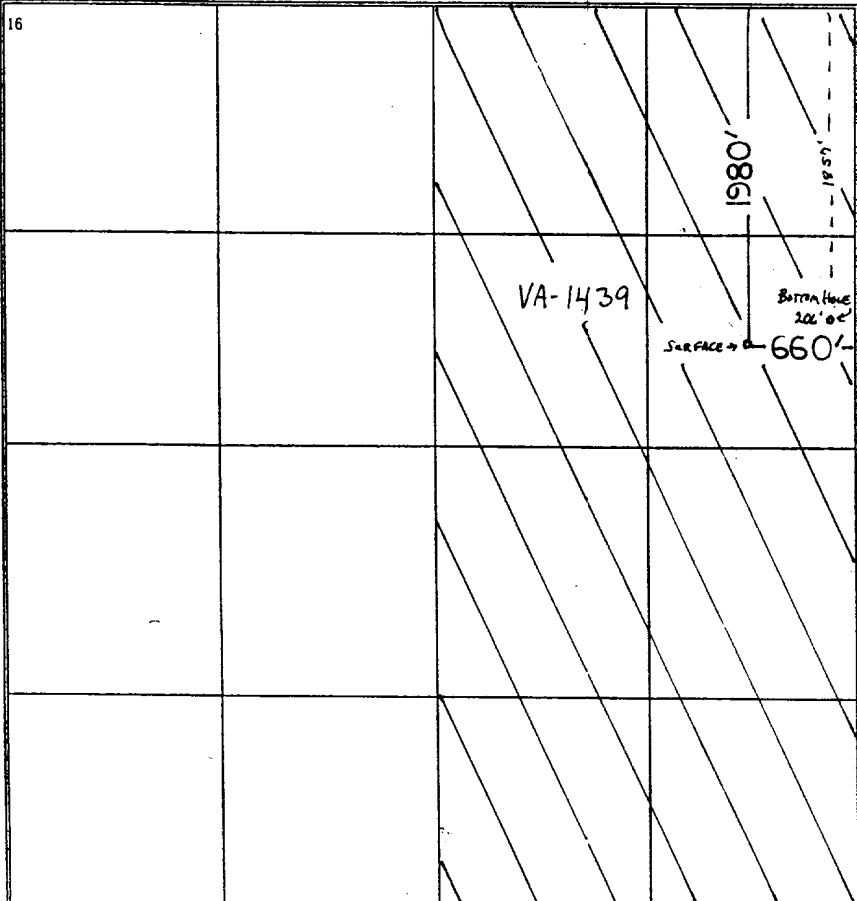
16						17 OPERATOR CERTIFICATION I hereby certify that the information contained herein is true and complete to the best of my knowledge and belief	
						Signature Clifton R. May	
						Printed Name Regulatory Agent	
						Title 11-17-2000	
Date		18 SURVEYOR CERTIFICATION I hereby certify that the well location shown on this plat was plotted from field notes of actual surveys made by me or under my supervision, and that the same is true and correct to the best of my belief. See Original Plat					
Date of Survey		Signature and Seal of Professional Surveyor:					
Certificate Number							

MEXICO OIL CONSERVATION COMMISSION  
WELL LOCATION AND ACREAGE DEDICATION PLATForm C-102  
Supersedes C-128  
Effective 1-1-65

All distances must be from the outer boundaries of the Section

Operator <b>Dome Petroleum Corp.</b>		Lease <b>Dome No Nombre State 31 State</b>		Well No. <b>1</b>
Unit Letter <b>H</b>	Section <b>31</b>	Township <b>13South</b>	Range <b>34East</b>	County <b>Lea</b>
Actual Footage Location of Well: <b>1980</b> feet from the <b>North</b> line and <b>660</b> feet from the <b>East</b> line				
Ground Level Elev. <b>4164.80'</b>	Producing Formation <b>Morrow</b>	Pool <b>Wildcat</b>	Dedicated Acreage: <b>320</b> Acres	

1. Outline the acreage dedicated to the subject well by colored pencil or hachure marks on the plat below.
2. If more than one lease is dedicated to the well, outline each and identify the ownership thereof (both as to working interest and royalty).
3. If more than one lease of different ownership is dedicated to the well, have the interests of all owners been consolidated by communitization, unitization, force-pooling, etc?

☐ Yes ☐ No If answer is "yes," type of consolidation \_\_\_\_\_

If answer is "no," list the owners and tract descriptions which have actually been consolidated. (Use reverse side of this form if necessary.) \_\_\_\_\_

No allowable will be assigned to the well until all interests have been consolidated (by communitization, unitization, forced-pooling, or otherwise) or until a non-standard unit, eliminating such interests, has been approved by the Commission.

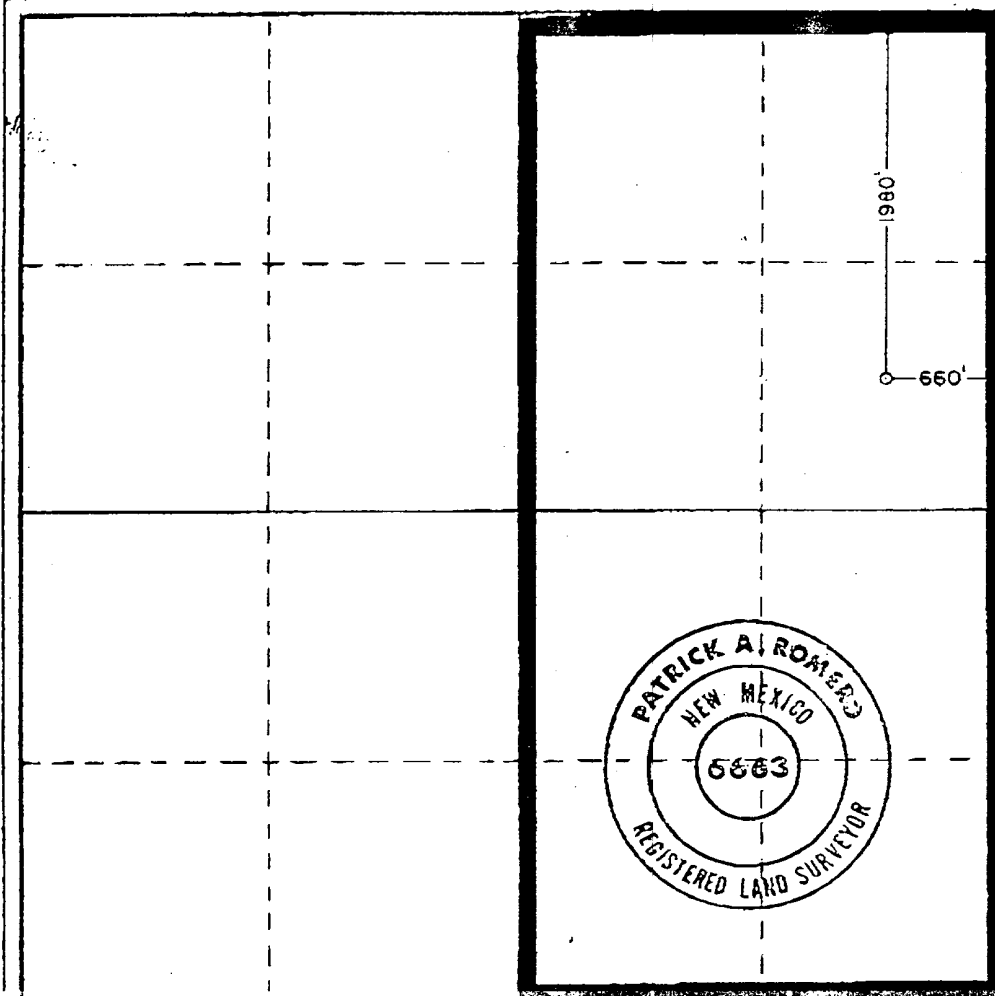

## CERTIFICATION

I hereby certify that the information contained herein is true and complete to the best of my knowledge and belief.

Name

**O.H. Routh**

Position

**Agent**

Company

**Dome Petroleum Corp.**

Date

**1-15-81**

I hereby certify that the well location shown on this plat was plotted from field notes of actual surveys made by me or under my supervision, and that the same is true and correct to the best of my knowledge and belief.

Date Surveyed

**Jan. 12, 1981**Registered Professional Engineer  
and/or Land Surveyor**Patrick A. Romero**

# YATES PETROLEUM CORPORATION

## TYPICAL 3,000 p.s.i. BLOWOUT PREVENTER SCHEMATIC

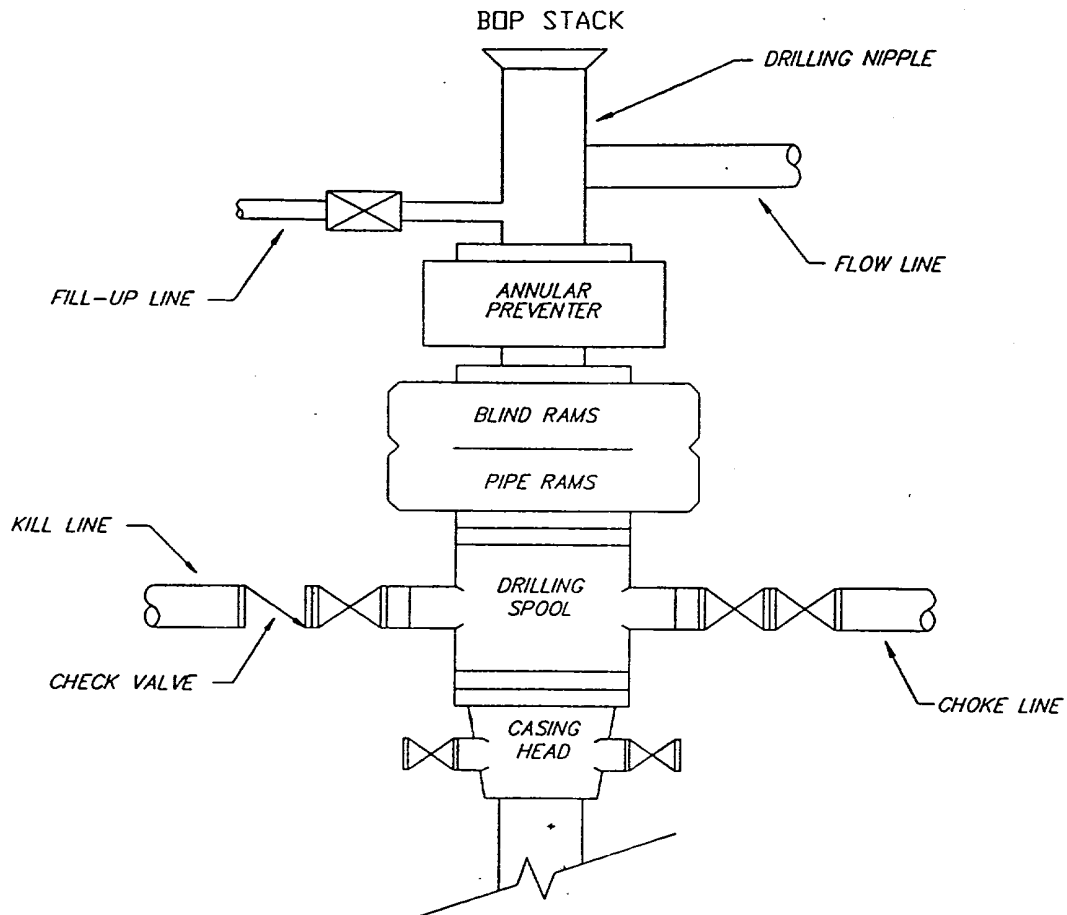

## TYPICAL 3,000 p.s.i. CHOKE MANIFOLD SCHEMATIC

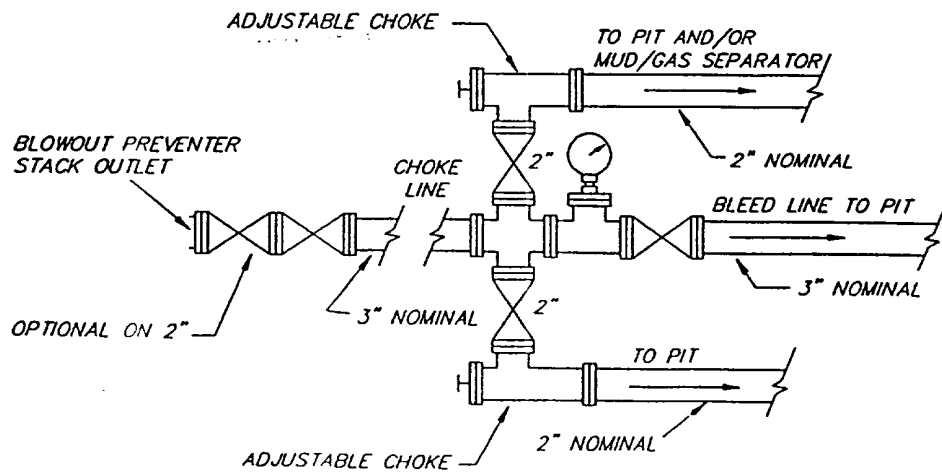

# Viking Pet., Inc.

WELL NAME: Dome - No. 1 State # 1 FIELD AREA: Lea Canyon NM

LOCATION: 1980' ENL & 660' FEL Sec. 31, T. 13 S., R. 34 E.

L: 0 ZERO: 0 AGL: 0

D: 0 ORIG. DRILLG./COMPL. DATE: 0

COMMENTS: Spud: 2-28-81  
P&A 7-17-82

## CASING PROGRAM:

SIZE/WT./GR./CONN.	DEPTH SET
13 3/8" 48# H-40 ST&C	390'
8 5/8" 32# K-55 ST&C	4204'
5 1/2" 17# & 20# N-80 & S-95	13,142'

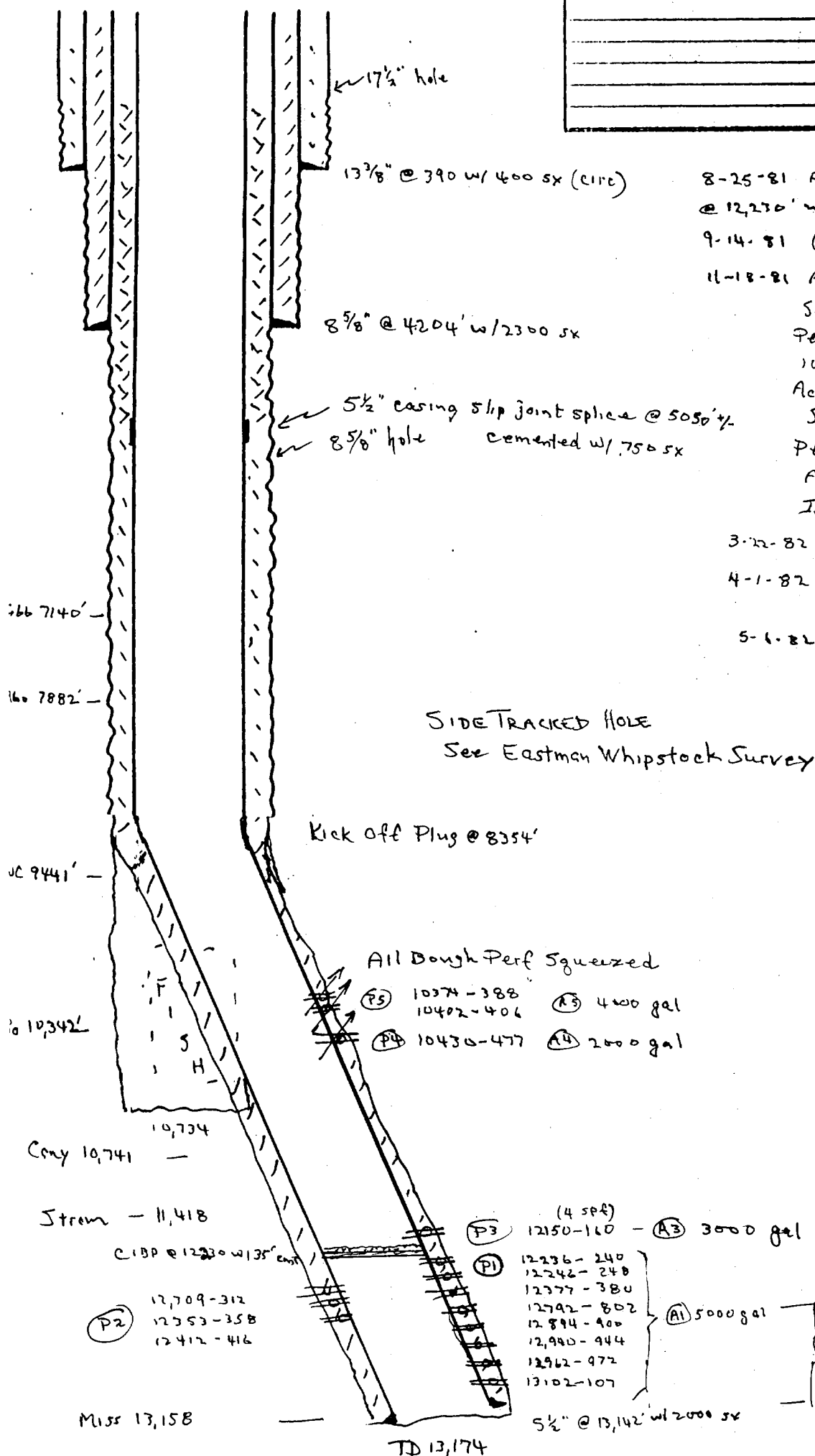

8-25-81 Abdn Morrow by setting CIBP @ 12,230' w/ 36' ent.

9-14-81 Chg operator from Dome to Viking

11-18-81 Acid 12,150'-12,160' w/ 3000 gal 15% Set BP @ 12,000' w/ 35' ent.

Perf 10,445'-10,447' &

10,430'-10,435' w/ 250' Acid 500 gal 10% Acid 2000 gal

Swab 40% oil, 5% gas Perf 10,402'-10,406' & 10,374'-388'

Acid w/ 4000 gal Swab 40% oil Installed pumping equip.

3-22-82 Continue pump test 10,402'-44'

4-1-82 Set 10,420'. Put 10,374'-406' back on pump.

5-1-82 Continue pump test 10,374'-44'

After

10-12-00 Ray S.