

STATE OF NEW MEXICO  
ENERGY AND MINERALS DEPARTMENT

CONSERVATION DIVISION  
P. O. BOX 2088  
SANTA FE, NEW MEXICO 87501

30-025-27294

Form C-101  
Revised 10-1-78

NO. OF COPIES RECEIVED	
DISTRIBUTION	
SANTA FE	
FILE	
U.S.G.S.	
LAND OFFICE	
OPERATOR	

5A. Indicate Type of Lease  
STATE ☒ FEE ☐  
5. State Oil & Gas Lease No.

APPLICATION FOR PERMIT TO DRILL, DEEPEN, OR PLUG BACK

1a. Type of Work  
DRILL ☒ DEEPEN ☐ PLUG BACK ☐

b. Type of Well  
OIL WELL ☒ GAS WELL ☐ OTHER ☐  
SINGLE ZONE ☐ MULTIPLE ZONE ☐

2. Name of Operator  
HARPER OIL CO.

3. Address of Operator  
904 HIGHTOWER BLDG., OKLAHOMA CITY, OK 73102

4. Location of Well  
UNIT LETTER B LOCATED 660 FEET FROM THE North LINE

AND 1980 FEET FROM THE East LINE OF SEC. 31 TWP. 12 South, R. 34 East NMPM

7. Unit Agreement Name  
EAST HIGHTOWER

8. Farm or Lease Name  
Harfield State

9. Well No. 1  
~~STATE HARFIELD STATE~~

10. Field and Pool, or Wildcat  
E. HIGHTOWER LOWER PENN  
UNDESIGNATED

12. County  
LEA

11. Elevation (Show whether DT, RT, etc.)	21A. Kind & Status Plug. Bond 50,000.00 BLANKET	19. Proposed Depth 10,500	19A. Formation PENNSYLVANIAN	20. Rotary or C.T. ROTARY
	21B. Drilling Contractor WARTON DRILLING	22. Approx. Date Work will start MARCH 8, 1981		

23. PROPOSED CASING AND CEMENT PROGRAM

SIZE OF HOLE	SIZE OF CASING	WEIGHT PER FOOT	SETTING DEPTH	SACKS OF CEMENT	EST. TOP
17 1/2	13 3/8	48#	360'	375 SKS	SURFACE
12 1/4	8 5/8	24# & 28#	4,200'	2600 SKS	SURFACE
7 7/8	5 1/2	17#	10,500'	500 SKS CLASS "C"	8500'

The following BOP equipment will be used on this well:

- 5000# W.P. Double Ram Preventor
- 3000# W.P. Annular Preventor
- 4" x 2" 5000# W.P. Choke Manifold
- Koomey accumulator and valves w/remote stand

APPROVAL VALID FOR 180 DAYS  
PERMIT EXPIRES 8/26/81  
UNLESS DRILLING UNDERWAY

ABOVE SPACE DESCRIBE PROPOSED PROGRAM: IF PROPOSAL IS TO DEEPEN OR PLUG BACK, GIVE DATA ON PRESENT PRODUCTIVE ZONE AND PROPOSED NEW PRODUCTIVE ZONE. GIVE BLOWOUT PREVENTER PROGRAM, IF ANY.

I hereby certify that the information above is true and complete to the best of my knowledge and belief.

Signed Charles E. Loring Title Drilling Manager Date February 20, 1981  
(This space for State Use)

APPROVED BY [Signature] TITLE SUPERVISOR DISTRICT 1 DATE 2/26/81  
CONDITIONS OF APPROVAL, IF ANY:

**NEW MEXICO OIL CONSERVATION COMMISSION  
WELL LOCATION AND ACREAGE DEDICATION PLAT**

Form C-102  
Supersedes C-128  
Effective 1-1-65

All distances must be from the outer boundaries of the Section.

Operator <b>Harper Oil Co.</b>			Lease <b>State Warfield State</b>			Well No. <b>1</b>		
Tract Letter <b>B</b>	Section <b>31</b>	Township <b>12 South</b>	Range <b>34 East</b>	County <b>Lea</b>				
Actual Footage Location of Well: <b>660</b> feet from the <b>north</b> line and <b>1980</b> feet from the <b>east</b> line								
Ground Level Elev. <b>4203.8</b>	Producing Formation <b>Lenn</b>		Owner <b>E. Hightower L. Lenn</b>			Dedicated Acreage: <b>80</b> Acres		

1. Outline the acreage dedicated to the subject well by colored pencil or hatchure marks on the plat below.
2. If more than one lease is dedicated to the well, outline each and identify the ownership thereof (both as to working interest and royalty).
3. If more than one lease of different ownership is dedicated to the well, have the interests of all owners been consolidated by communitization, unitization, force-pooling, etc?

☐ Yes    ☐ No    If answer is "yes," type of consolidation \_\_\_\_\_

If answer is "no," list the owners and tract descriptions which have actually been consolidated. (Use reverse side of this form if necessary.) \_\_\_\_\_

No allowable will be assigned to the well until all interests have been consolidated (by communitization, unitization, forced-pooling, or otherwise) or until a non-standard unit, eliminating such interests, has been approved by the Commission.

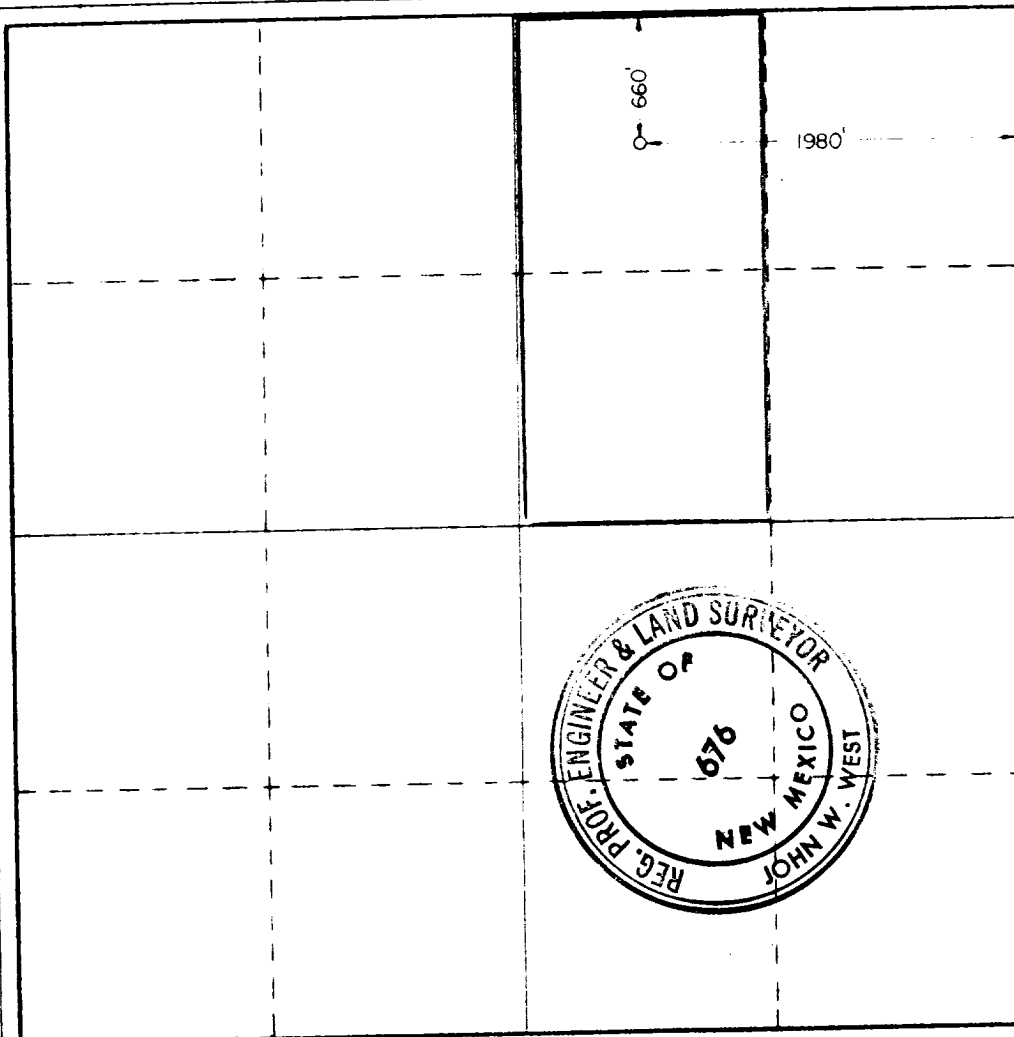

**CERTIFICATION**

I hereby certify that the information contained herein is true and complete to the best of my knowledge and belief.

*Clyde C. Herring*  
Name  
Operator, mgr.  
Position

Company

Date

I hereby certify that the well location shown on this plat was plotted from field notes of actual surveys made by me or under my supervision, and that the same is true and correct to the best of my knowledge and belief.

Date Surveyed

**2-15-81**

Registered Professional Engineer and/or Land Surveyor

*John W. West*  
Certificate No. **JOHN W. WEST 676**  
**PATRICK A. ROMERO 6663**  
**Ronald J. Eidson 3239**

0 330 660 990 1320 1650 1980 2310 2640 2970 3300 3630 3960 4290 4620 4950 5280 5610 5940 6270 6600