

30-025-27512

STATE OF NEW MEXICO  
ENERGY AND MINERALS DEPARTMENT

OIL CONSERVATION DIVISION  
P. O. BOX 2088  
SANTA FE, NEW MEXICO 87501

Form C-101  
Revised 10-1-78

NO. OF COPIES RECEIVED	
DISTRIBUTION	
SANTA FE	
FILE	
U.S.G.S.	
LAND OFFICE	
OPERATOR	

5A. Indicate Type of Lease STATE <input type="checkbox"/> FEE <input checked="" type="checkbox"/>
5. State Oil & Gas Lease No.
7. Unit Agreement Name
8. Farm or Lease Name Harben-Davis
9. Well No. 1
10. Field and Pool, or Wildcat Gladiola, SW Dev.
12. County Lea

APPLICATION FOR PERMIT TO DRILL, DEEPEN, OR PLUG BACK

Type of Work  
Type of Well  
OIL WELL ☒ GAS WELL ☐ OTHER ☐  
Name of Operator  
Challenger Minerals Inc.  
Address of Operator  
701 Petroleum Building, Midland, Texas 79701  
Location of Well  
UNIT LETTER 0 LOCATED 660 FEET FROM THE south LINE  
1980 FEET FROM THE east LINE OF SEC. 26 TWP. 12 RGE. 37 NE/4  
19. Proposed Depth  
12,600'  
19A. Formation  
Devonian  
20. Rotary or C.T.  
Rotary  
21A. Kind & Status Plug. Bond  
Blanket & Current  
21B. Drilling Contractor  
Unknown  
22. Approx. Date Work will start  
9-1-81  
Elevations (Show whether DE, RT, etc.)  
3878' GL

PROPOSED CASING AND CEMENT PROGRAM

SIZE OF HOLE	SIZE OF CASING	WEIGHT PER FOOT	SETTING DEPTH	SACKS OF CEMENT	EST. TOP
17½"	13-3/8"	48	450'	410	circ.
12½"	8-5/8"	24 & 32	4500'	1900	circ.
7-7/8"	5½"	17	12600'	680	9000'

As soon as Contractor is designated, will file form C-103 showing blow out stack.

Drill 17½" hole to 450'; run and cem. 13-3/8" csg. @ 450', cem w/410 sx and circ. cem.; WOC; test csg. to 1000# psi; drill a 12½" hole to 4500'; run 8-5/8" csg. to 4500' and cem. w/1900 sx cem; WOC 18 hrs; drill 7-7/8" hole with water to 9500'; mud up @ 9500' to maintain water loss to less than 15 cc's with a Vis of 34-36, and Wt at ±9#/gal; possible DST's in the Wolfcamp at about 9800'; drill to approximately 12,600' in the Devonian; if production is indicated, run and set 5½" csg. to total depth and cem. w/680 sx; estimated top of cem. is 9000'

APPROVAL VALID FOR 180 DAYS  
PERMIT EXPIRES 2/9/82  
UNLESS DRILLING UNDERWAY

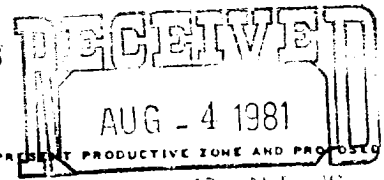

BELOW SPACE DESCRIBE PROPOSED PROGRAM; IF PROPOSAL IS TO DEEPEN OR PLUG BACK, GIVE DATA ON PRESENT PRODUCTIVE ZONE AND PROPOSED NEW PRODUCTION ZONE. GIVE BLOWOUT PREVENTER PROGRAM, IF ANY.

I hereby certify that the information above is true and complete to the best of my knowledge and belief.

Signed by M. R. Carter Title Geologist Date 7-30-81

(This space for State Use)  
Only Signed by Larry Sexton  
DATE & SUPERVISOR  
APPROVED BY \_\_\_\_\_ TITLE \_\_\_\_\_ DATE \_\_\_\_\_  
CONDITIONS OF APPROVAL, IF ANY

7 1981

NEW MEXICO OIL CONSERVATION COMMISSION  
WELL LOCATION AND ACREAGE DEDICATION PLAT

Form C-102  
Supersedes C-128  
Effective 1-1-65

All distances must be from the outer boundaries of the Section.

Operator <b>CHALLENGER MINERALS INC.</b>		Lease <b>Harben-Davis</b>		Well No. <b>1</b>
Unit Letter	Section <b>26</b>	Township <b>12-S</b>	Range <b>37-E</b>	County <b>Lea</b>
Actual Footage Location of Well: <b>660'</b> feet from the <b>South</b> line and <b>1980'</b> feet from the <b>East</b> line				
Ground Level Elev: <b>3878'</b>	Producing Formation <b>Devonian</b>	Pool <b>Gladiola, SW</b>	Dedicated Acreage: <b>80</b> Acres	

- Outline the acreage dedicated to the subject well by colored pencil or hachure marks on the plat below.
- If more than one lease is dedicated to the well, outline each and identify the ownership thereof (both as to working interest and royalty).
- If more than one lease of different ownership is dedicated to the well, have the interests of all owners been consolidated by communitization, unitization, force-pooling, etc?

☒ Yes ☐ No If answer is "yes," type of consolidation in the leases

If answer is "no," list the owners and tract descriptions which have actually been consolidated. (Use reverse side of this form if necessary.) \_\_\_\_\_

No allowable will be assigned to the well until all interests have been consolidated (by communitization, unitization, forced-pooling, or otherwise) or until a non-standard unit, eliminating such interests, has been approved by the Commission.

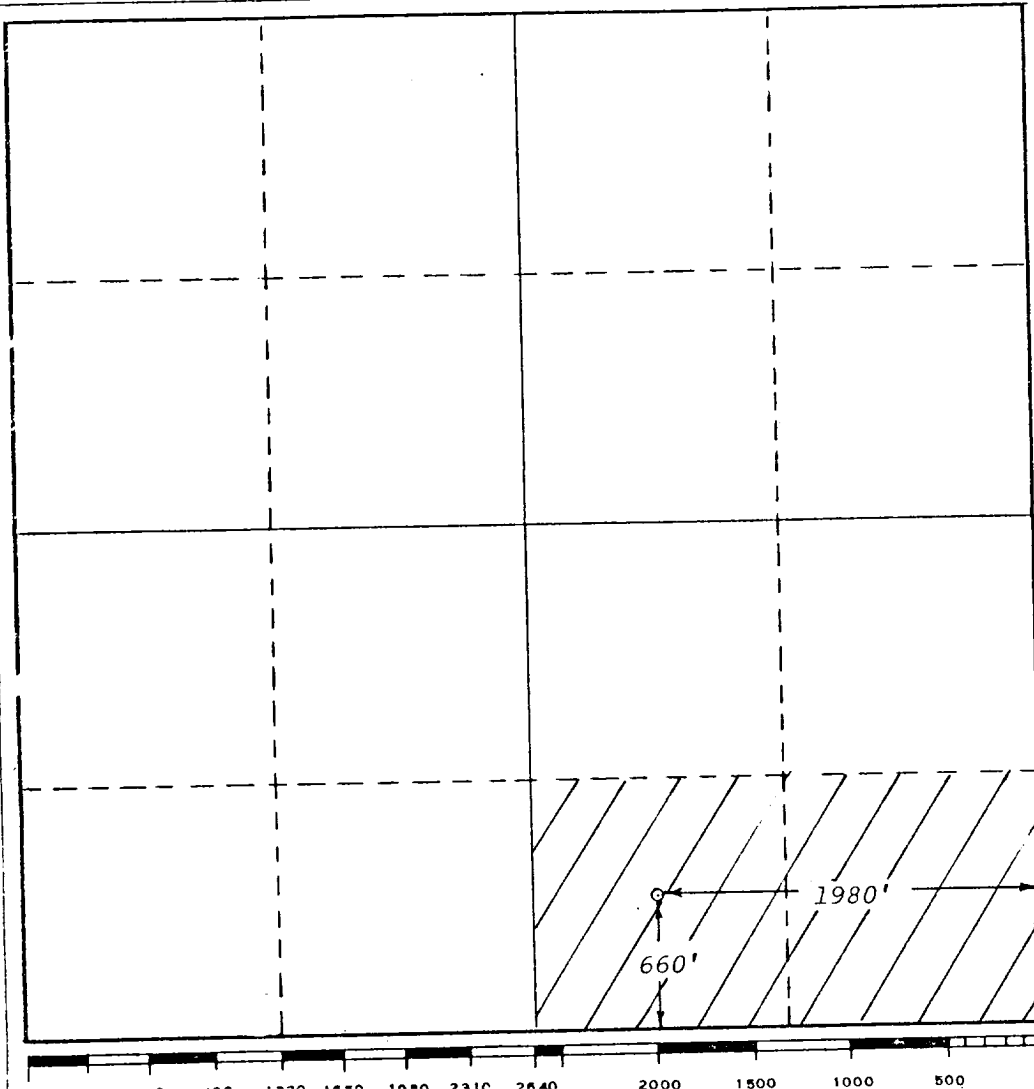

CERTIFICATION

I hereby certify that the information contained herein is true and complete to the best of my knowledge and belief.

Name M. A. Crutcher  
Position Geologist  
Company Challenger Minerals, Inc.  
Date 7-13-81

I hereby certify that the well location shown on this plat was plotted from field notes or other reliable source by me or under my supervision, and that the same is true and correct to the best of my knowledge and belief.  
**GARY D. BOSWELL**

Date Subscribed July 14, 1981  
**Gary D. Boswell**  
Registered Professional Engineer and/or Land Surveyor

Gary D. Boswell  
Certificate No. **6689**

RECEIVED

06/21/81

AUG 6 1981

EEF

GIL CONSERVATION DIV.