

NO. OF
DISTRIBUTION
SANTA FE
FILE
U.S.G.S.
LAND OFFICE
OPERATOR

NEW MEXICO OIL CONSERVATION COMMISSION

30-025-27605

Form C-101
Revised 1-1-65

1A. Indicate Type of Lease
STATE ☒ FEE ☐
5. State Oil & Gas Lease No.
L-6717

APPLICATION FOR PERMIT TO DRILL, DEEPEN, OR PLUG BACK

1a. Type of Work
DRILL ☒ DEEPEN ☐ PLUG BACK ☐
b. Type of Well
OIL WELL ☒ GAS WELL ☐ OTHER ☐ SINGLE ZONE ☐ MULTIPLE ZONE ☐
2. Name of Operator
MWJ PRODUCING COMPANY
3. Address of Operator
1804 First National Bank Bldg. Midland, Texas 79701
4. Location of Well
UNIT LETTER E LOCATED 1980 FEET FROM THE north LINE
660 west 26 14S 33E NMPM
7. Unit Agreement Name
8. Farm or Lease Name
Saunders, State 26
9. Well No.
1
10. Field and Pool, or Wildcat
Saunders Permo Upper Penn
12. County
Lea
19. Proposed Depth
10,200'
19A. Formation
Penn
20. Rotary or C.T.
Rotary
21. Elevations (Show whether DF, RT, etc.)
4189.4 GL
21A. Kind & Status Plug. Bond
Blanket-Current
21B. Drilling Contractor
Tri-Service Drlg Co.
22. Approx. Date Work will start
10/30/81

23.

PROPOSED CASING AND CEMENT PROGRAM

SIZE OF HOLE	SIZE OF CASING	WEIGHT PER FOOT	SETTING DEPTH	SACKS OF CEMENT	EST. TOP
17"	13-3/8"	48#	365'	400 sx	surface
11"	8-5/8"	24 & 32#	4000'	1500 sx	365' $\frac{1}{2}$
7-7/8"	5-1/2"	15.5 & 17#	10200'	200 sx	9000'

Plan to move in Cable Tool Rig to spud & drill until Rotary Rig is available.

Note: Gas is not dedicated

IN ABOVE SPACE DESCRIBE PROPOSED PROGRAM: IF PROPOSAL IS TO DEEPEN OR PLUG BACK, GIVE DATA ON PRESENT PRODUCTIVE ZONE AND PROPOSED NEW PRODUCTIVE ZONE. GIVE BLOWOUT PREVENTER PROGRAM, IF ANY.

I hereby certify that the information above is true and complete to the best of my knowledge and belief.

Signed Dat Bishop Title Agent Date 10/15/81

(This space for State Use)

As Signed by

APPROVED BY _____ TITLE _____ DATE _____

CONDITIONS OF APPROVAL, IF ANY:

* refer to the lease document.

180
4/19/82

**MEXICO OIL CONSERVATION COMMISSION
WELL LOCATION AND ACREAGE DEDICATION PLAT**

Form C-102
Supersedes C-128
Effective 1-1-65

All distances must be from the outer boundaries of the Section.

Operator MWJ PRODUCING COMPANY			Lease Saunders, State 26 ²⁶		Well No. 1
Unit Letter E	Section 26	Township 14 South	Range 33 East	County Lea	
Actual Footage Location of Well: 1980 feet from the North line and 660 feet from the West line					
Ground Level Elev. 4189.4	Producing Formation Penn		Pool Saunders Permo Upper Penn		Dedicated Acreage: 40 Acres

1. Outline the acreage dedicated to the subject well by colored pencil or hatchure marks on the plat below.
2. If more than one lease is dedicated to the well, outline each and identify the ownership thereof (both as to working interest and royalty).
3. If more than one lease of different ownership is dedicated to the well, have the interests of all owners been consolidated by communitization, unitization, force-pooling, etc?

☐ Yes ☐ No If answer is "yes," type of consolidation _____

If answer is "no," list the owners and tract descriptions which have actually been consolidated. (Use reverse side of this form if necessary.) _____

No allowable will be assigned to the well until all interests have been consolidated (by communitization, unitization, forced-pooling, or otherwise) or until a non-standard unit, eliminating such interests, has been approved by the Commission.

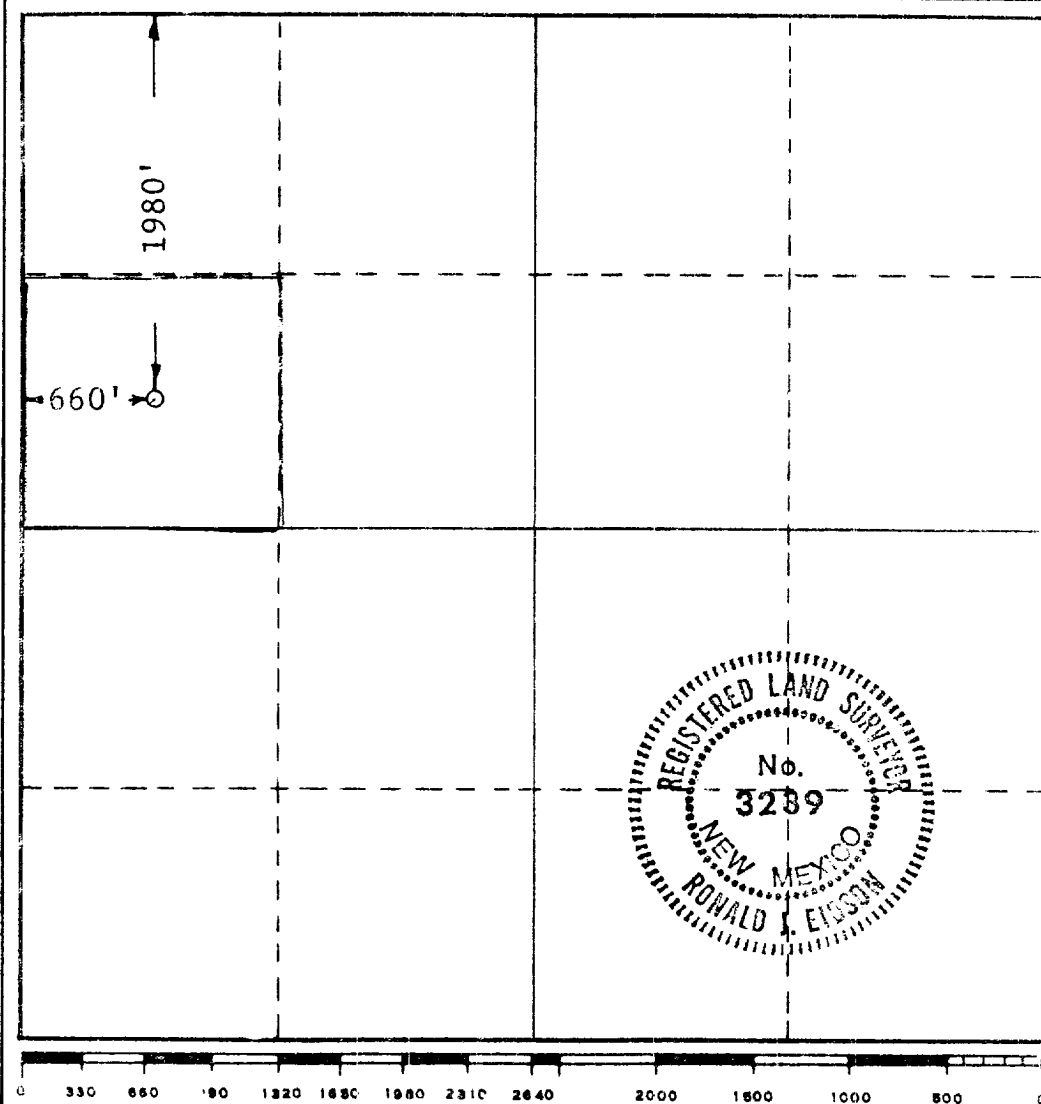

CERTIFICATION

I hereby certify that the information contained herein is true and complete to the best of my knowledge and belief.

Pat Bishop

Name
Pat Bishop

Position
Agent

Company
MWJ PRODUCING COMPANY

Date
10/15/81

I hereby certify that the well location shown on this plat was plotted from field notes of actual surveys made by me or under my supervision, and that the same is true and correct to the best of my knowledge and belief.

Date Surveyed
October 14, 1981

Registered Professional Engineer and/or Land Surveyor

Ronald J. Eidson

Certificate No. **JOHN W. WEST 676**
PATRICK A. ROMERO 6663
Ronald J. Eidson 3239

173

1981

1981