

NO. OF COPIES RECEIVED		
DISTRIBUTION		
SANTA FE		
FILE		
U.S.G.S.		
LAND OFFICE		
OPERATOR		

NEW ☐ ICO OIL CONSERVATION COMMISSION

30-025-27853  
Form C-101  
Revised 1-1-65

5A. Indicate Type of Lease	
STATE <input checked="" type="checkbox"/>	FEE <input type="checkbox"/>
5. State Oil & Gas Lease No. K-4-177	
7. Unit Agreement Name	
8. Farm or Lease Name State 8	
9. Well No. #3	
10. Field and Pool, or Wildcat Baum <i>Upper Penn</i>	
12. County Lea	
19. Proposed Depth 10,100'	19A. Formation Upper Penn
20. Rotary or C.T. Rotary	
21A. Kind & Status Plug. Bond Blanket	21B. Drilling Contractor Undesignated
22. Approx. Date Work will start July 1, 1982	

APPLICATION FOR PERMIT TO DRILL, DEEPEN, OR PLUG BACK

a. Type of Work

b. Type of Well  
 DRILL ☒ DEEPEN ☐ PLUG BACK ☐  
 OIL WELL ☒ GAS WELL ☐ OTHER ☐  
 SINGLE ZONE ☐ MULTIPLE ZONE ☐

c. Name of Operator  
Coastal Oil & Gas Corp.

d. Address of Operator  
P. O. Box 235 Midland, Texas 79702

e. Location of Well  
 UNIT LETTER E LOCATED 1980 FEET FROM THE north LINE  
660 FEET FROM THE west LINE OF SEC. 8 TWP. 14 S RGE. 33 E NMPM

f. Elevations (Show whether DF, RT, etc.)  
4257.1'

PROPOSED CASING AND CEMENT PROGRAM

SIZE OF HOLE	SIZE OF CASING	WEIGHT PER FOOT	SETTING DEPTH	SACKS OF CEMENT	EST. TOP
17 1/2"	13 3/8"	48	380	427	Circ.
12 1/4"	8 5/8"	24 & 28	4100'	1650	Circ.
7 7/8"	5 1/2"	17	10100'	180	9000

1. Surface Casing: C1 "C" + 2%
2. Protective Casing: 1450 sxs lite + 3# gilsonite + 1/4# Flocele tail-in 200 sxs C1 "C".
3. Production Casing: 50/50 Poz + 6% Halid-9 + 1/4# Flocele.

APPROVAL VALID FOR 180 DAYS  
 PERMIT EXPIRES 12/17/82  
 UNLESS DRILLING UNDERWAY

ABOVE SPACE DESCRIBE PROPOSED PROGRAM: IF PROPOSAL IS TO DEEPEN OR PLUG BACK, GIVE DATA ON PRESENT PRODUCTIVE ZONE AND PROPOSED NEW PRODUCTION ZONE. GIVE BLOWOUT PREVENTER PROGRAM, IF ANY.

I hereby certify that the information above is true and complete to the best of my knowledge and belief.

Signed Les Clements Title Operations Analyst Date 6-11-82

(This Space Reserved for Operator Signature)

Les Clements

APPROVED BY Oil & Gas Insp. TITLE \_\_\_\_\_ DATE \_\_\_\_\_

CONDITIONS OF APPROVAL, IF ANY:

JUN 17 1982

NEW MEXICO OIL CONSERVATION COMMISSION  
WELL LOCATION AND ACREAGE DEDICATION PLAT

Form C-102  
Supersedes C-128  
Effective 1-1-65

All distances must be from the outer boundaries of the Section

Operator <b>COASTAL OIL &amp; GAS CO.</b>		Lease <b>STATE 8</b>		Well No. <b>3</b>	
Unit Letter <b>E</b>	Section <b>8</b>	Township <b>14 SOUTH</b>	Range <b>33 EAST</b>	County <b>LEA</b>	
Actual Footage Location of Well: <b>1980</b> feet from the <b>NORTH</b> line and <b>660</b> feet from the <b>WEST</b> line					
Ground Level Elev. <b>4257.1'</b>	Producing Formation <b>Upper Pennsylvanian</b>		Pool <b>Baum, Upper Penn</b>		Dedicated Acreage: <b>160</b> Acres

1. Outline the acreage dedicated to the subject well by colored pencil or hachure marks on the plat below.
2. If more than one lease is dedicated to the well, outline each and identify the ownership thereof (both as to working interest and royalty).
3. If more than one lease of different ownership is dedicated to the well, have the interests of all owners been consolidated by communitization, unitization, force-pooling, etc?

☐ Yes ☒ No If answer is "yes," type of consolidation \_\_\_\_\_

If answer is "no," list the owners and tract descriptions which have actually been consolidated (Use reverse side of this form if necessary.) \_\_\_\_\_

No allowable will be assigned to the well until all interests have been consolidated (by communitization, unitization, forced-pooling, or otherwise) or until a non-standard unit, eliminating such interests, has been approved by the Commission.

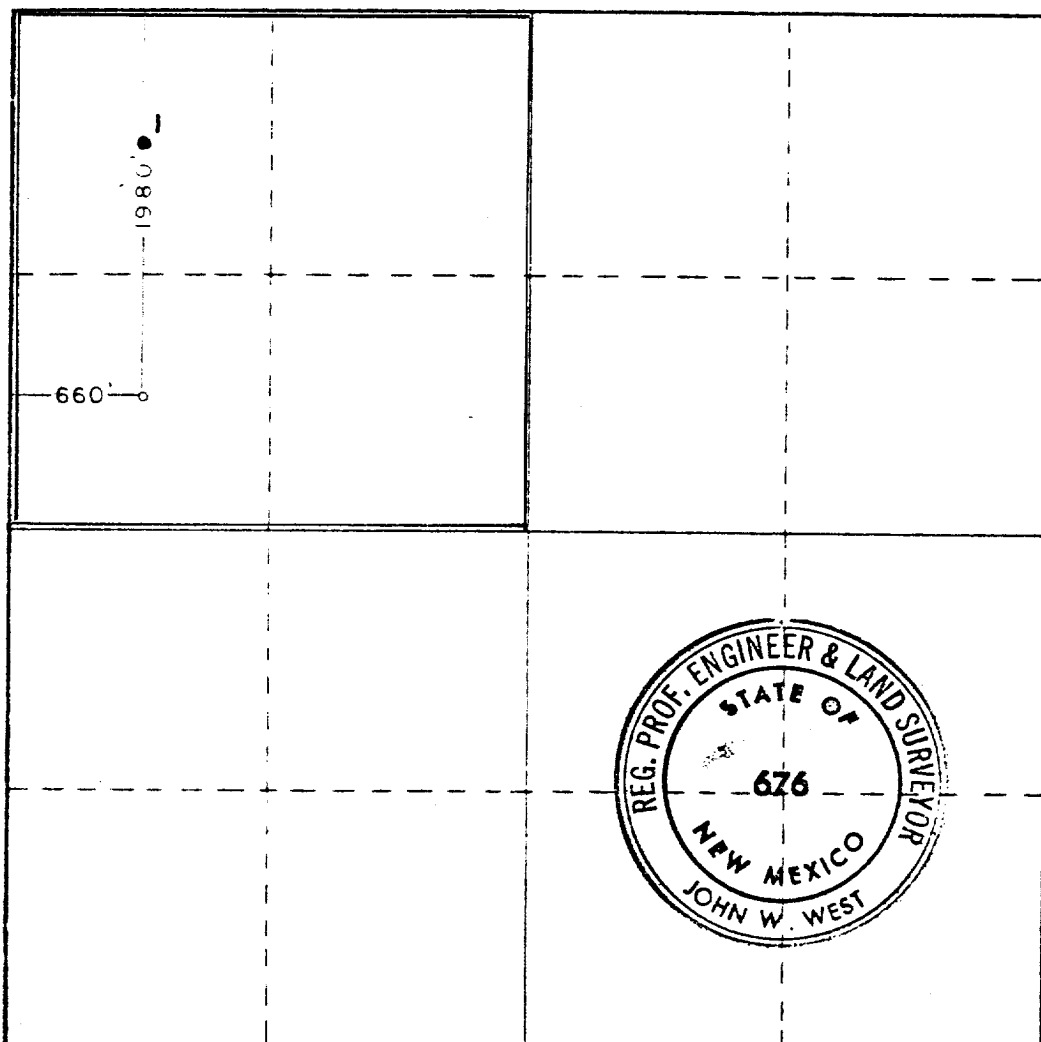

CERTIFICATION

I hereby certify that the information contained herein is true and complete to the best of my knowledge and belief.

Name  
*David H Campbell*

Position  
**S. Petroleum Engineer**

Company  
**Coastal Oil & Gas Corp.**

Date  
**June 11, 1982**

I hereby certify that the well location shown on this plat was plotted from field notes of actual surveys made by me or under my supervision, and that the same is true and correct to the best of my knowledge and belief.

Date Surveyed  
**6-3-82**

Registered Professional Engineer and/or Land Surveyor

*John W. West*

Certificate No. **JOHN W. WEST 676**  
**PATRICK A. ROMERO 6883**  
**Ronald J. Eidson 3239**



RECEIVED

JUN 14 1982

MAIL ROOMS OFFICE

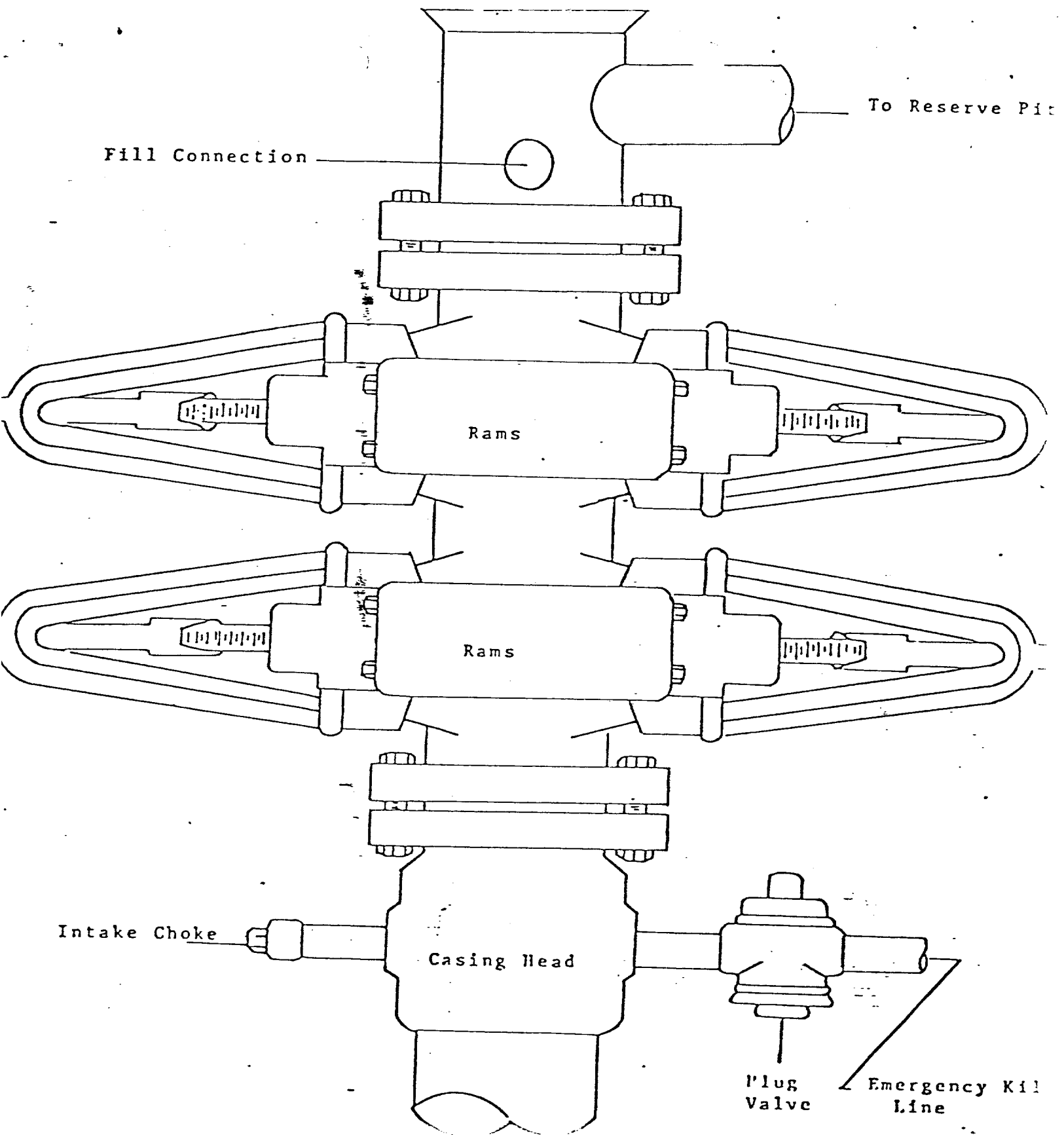

3000 PSI Working Pressure  
Blowout Preventer Stack

RECEIVED

JUN 16 1982

O.C.D.  
HOBBS OFFICE