

All distances must be from the outer boundaries of the Section.

EUROPA ENERGY, INC.		Lease		Key Federal Comm.		Well No. 1
Section 7	Township 13 South	Range 35 East	County Lea			
1980 feet from the South line and		1980 feet from the East line		Dedicated Acreage:		320 Acres
Sound Level Elev. 4102	Producing Formation Pennsylvanian	Pool Wildcat				

- Outline the acreage dedicated to the subject well by colored pencil or hatchure marks on the plat below.
- If more than one lease is dedicated to the well, outline each and identify the ownership thereof (both as to working interest and royalty).
- If more than one lease of different ownership is dedicated to the well, have the interests of all owners been consolidated by communitization, unitization, force-pooling, etc?

Yes No If answer is "yes," type of consolidation Communitization Agreement pending

If answer is "no," list the owners and tract descriptions which have actually been consolidated (Use reverse side of this form if necessary.)
No allowable will be assigned to the well until all interests have been consolidated (by communitization, unitization, forced-pooling, or otherwise) or until a non-standard unit, eliminating such interests, has been approved by the Division.

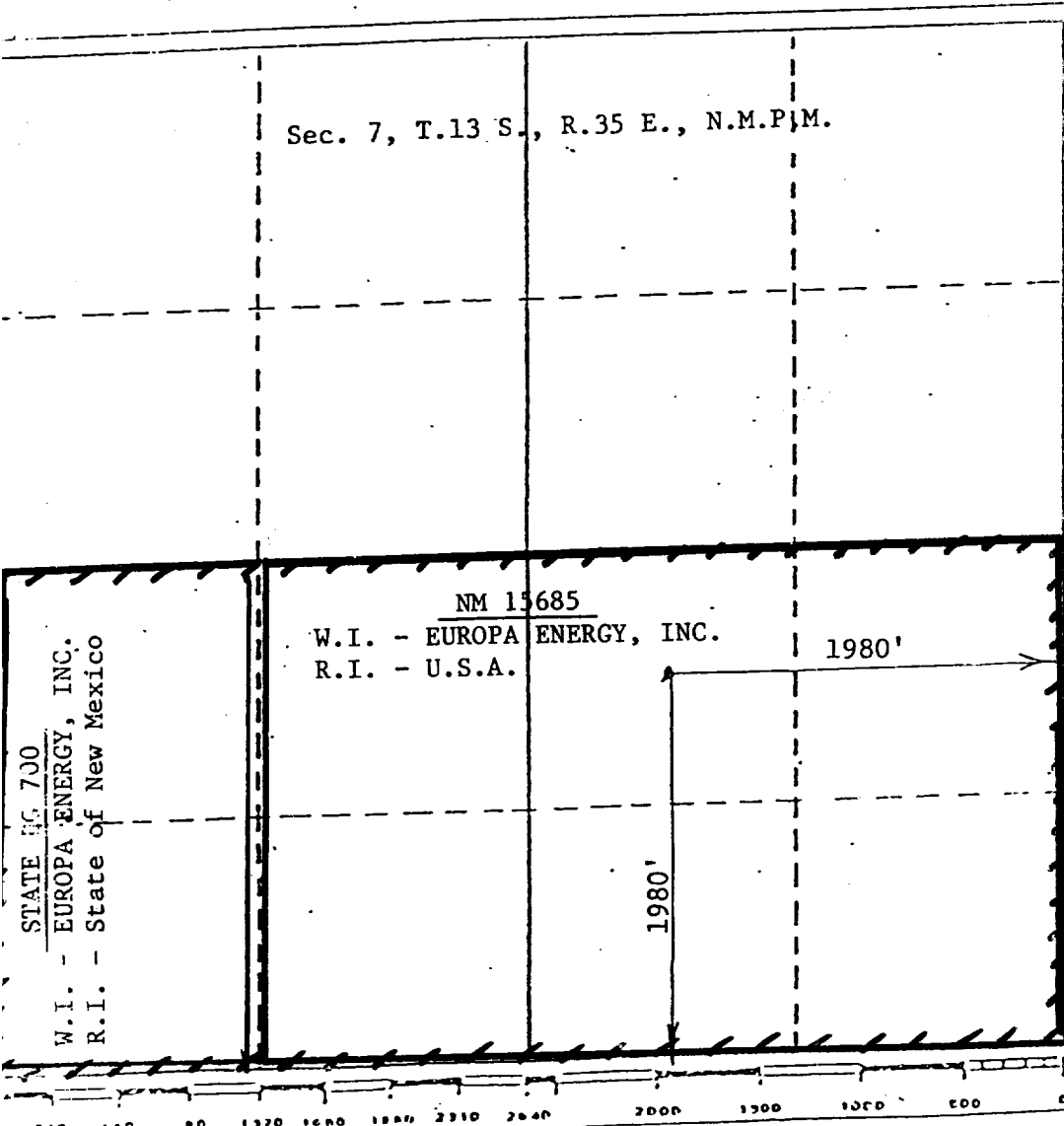

CERTIFICATION

I hereby certify that the information contained herein is true and complete to the best of my knowledge and belief.

Jerry W. Long
Name: JERRY W. LONG

Position: Agent

Company: EUROPA ENERGY, INC.

Date: September 23, 1982

I hereby certify that the well location shown on this plat was plotted from field notes of actual surveys made by me or under my supervision, and that the same is true and correct to the best of my knowledge and belief.

Date Surveyed: September 23, 1982

Registered Professional Engineer and/or Land Surveyor

John D. Jaques
John D. Jaques, P.E. & L.S.
Certificate No. 6290

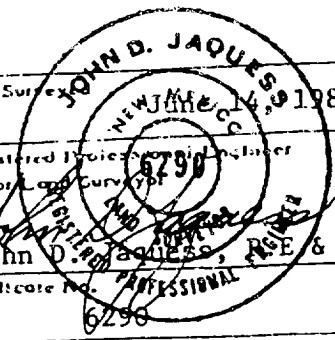

STATE NO. 700
W.I. - EUROPA ENERGY, INC.
R.I. - State of New Mexico

RECEIVED
OCT 4 1992
HOBBS OFFICE