

NO. OF COPIES RECEIVED	
DISTRIBUTION	
SANTA FE	
FILE	
U.S.G.S.	
LAND OFFICE	
OPERATOR	

5A. Indicate Type of Lease
STATE <input checked="" type="checkbox"/> FEED <input type="checkbox"/>
5. State Oil & Gas Lease No.
E-7169

APPLICATION FOR PERMIT TO DRILL, DEEPEN, OR PLUG BACK

1a. Type of Work		7. Unit Agreement Name	
b. Type of Well DRILL <input checked="" type="checkbox"/> DEEPEN <input type="checkbox"/> PLUG BACK <input type="checkbox"/> OIL WELL <input checked="" type="checkbox"/> GAS WELL <input type="checkbox"/> OTHER <input type="checkbox"/> SINGLE ZONE <input checked="" type="checkbox"/> MULTIPLE ZONE <input type="checkbox"/>		8. Farm or Lease Name	
2. Name of Operator CELERON OIL AND GAS COMPANY		9. Well No. 1	
3. Address of Operator P.O. Box 52088 Lafayette, La. 70505		10. Field and Pool, or Wildcat WC	
4. Location of Well UNIT LETTER <u>I</u> LOCATED <u>1980</u> FEET FROM THE <u>South</u> LINE AND <u>660</u> FEET FROM THE <u>East</u> LINE OF SEC. <u>33</u> TWP. <u>13S</u> RGE. <u>38E</u> NMPM		11. County LEA	
19. Proposed Depth 12700		19A. Formation Devonian	
20. Rotary or C.T. Rotary			
21. Elevations (show whether DF, HT, etc.) 3818' GR		21A. Kind & Status Plug. Bond \$50,000 Blanket/applied for	
21B. Drilling Contractor Undetermined at present		22. Approx. Date Work will start 1 Nov. 82	

23.

PROPOSED CASING AND CEMENT PROGRAM

SIZE OF HOLE	SIZE OF CASING	WEIGHT PER FOOT	SETTING DEPTH	SACKS OF CEMENT	EST. TOP
17½"	13-3/8"	48	400	± 350	Surf.
12½"	9-5/8"	47	4500	± 1000	1500
8½"	5½"	17 & 20	12700'	± 1500	9700'

Drill 17½" hole to ± 400' to cover fresh water sands. Set 13-3/8" casing at this depth. Mud type - Spud.

Drill 12½" hole to ± 4500'. Set 9-5/8" casing at this depth. Mud type - Native.

Drill 8½" or 8-3/4" hole to TD. Hole size dependent upon bit availability. Mud up at approximately 9000'.

5000# BOP's will be used while drilling.

APPROVAL VALID FOR 180 DAYS
PERMIT EXPIRES 4-22-83
UNLESS DRILLING UNDERWAY

IN ABOVE SPACE DESCRIBE PROPOSED PROGRAM; IF PROPOSAL IS TO DEEPEN OR PLUG BACK, GIVE DATA ON PRESENT PRODUCTIVE ZONE AND PROPOSED NEW PRODUCTIVE ZONE. GIVE BLOWOUT PREVENTER PROGRAM, IF ANY.

I hereby certify that the information above is true and complete to the best of my knowledge and belief.

Signed Clyde Adcock, Jr. Title Drilling Engineer Date September 24, 1982

(This space for State Use)

APPROVED BY Eddie W. Dean TITLE OIL & GAS INSPECTOR DATE OCT 22 1982

CONDITIONS OF APPROVAL, IF ANY:

RECEIVED

OCT 18 1982

O.C.B.
HOBBS OFFICE

RECEIVED

OCT 18 1982

O.C.B.
HOBBS OFFICE

**NEW MEXICO OIL CONSERVATION COMMISSION
WELL LOCATION AND ACREAGE DEDICATION PLAT**

Form O-1
Supersedes O-12B
Effective 1-1-75

All distances must be from the outer boundaries of the Section

Operator Celeron Oil & Gas Company			Lease State		Well No. 1
Unit Letter "I"	Section 33	Township T-13-S	Range R-38-E	County Lea	
Actual Footage Location of Well: 1980 feet from the South line and 660 feet from the East line.					
Ground Level Elev. 3818	Producing Formation Devonian		Pool		Dedicated Acreage: 40 Acres

1. Outline the acreage dedicated to the subject well by colored pencil or hachure marks on the plat below.
NE/4 SE/4 Section 33-T13S-R38E, Lea Co., NM
2. If more than one lease is dedicated to the well, outline each and identify the ownership thereof (both as to working interest and royalty).
3. If more than one lease of different ownership is dedicated to the well, have the interests of all owners been consolidated by communitization, unitization, force-pooling, etc?

☐ Yes ☐ No If answer is "yes," type of consolidation _____

If answer is "no," list the owners and tract descriptions which have actually been consolidated. (Use reverse side of this form if necessary.) _____

No allowable will be assigned to the well until all interests have been consolidated (by communitization, unitization, forced-pooling, or otherwise) or until a non-standard unit, eliminating such interests, has been approved by the Commission.

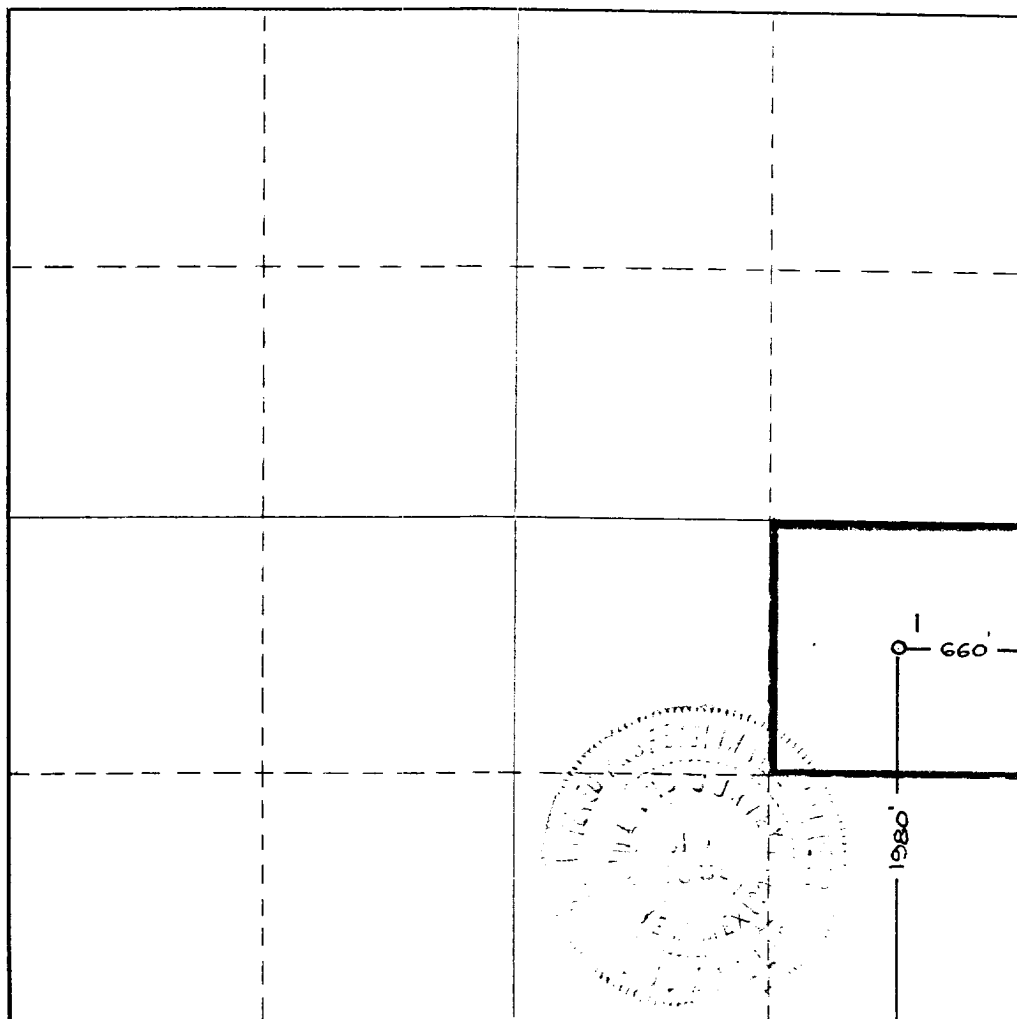

CERTIFICATION

I hereby certify that the information contained herein is true and complete to the best of my knowledge and belief.

Delmer D. Jones
Name

Delmer D. Jones

Position

Drilling Manager

Company

CELERON OIL & GAS COMPANY

Date

September 24, 1982

I hereby certify that the well location shown on this plat was plotted from field notes of actual surveys made by me or under my supervision, and that the same is true and correct to the best of my knowledge and belief.

September 15, 1982

Date Surveyed

Registered Professional Engineer
and/or Land Surveyor

W. O. Wallis

Certificate No.

1635

0 330 660 990 1320 1650 1980 2310 2640 2000 1500 1000 500

RECEIVED
OCT 18 1982
C.O.D.
HOBUS OFFICE

RECEIVED
OCT 1 1982
C.O.D.
HOBUS OFFICE

173