

30-025-28009

NO. OF COPIES RECEIVED	
DISTRIBUTION	
SANTA FE	
FILE	
U.S.G.S.	
LAND OFFICE	
OPERATOR	

## NEW MEXICO OIL CONSERVATION COMMISSION

Form C-101  
Revised 1-1-65

5A. Indicate Type of Lease STATE <input checked="" type="checkbox"/> FEE <input type="checkbox"/>
5. State Oil & Gas Lease No. K-4670
7. Unit Agreement Name
8. Farm or Lease Name State "DY"
9. Well No. 1
10. Field and Pool, or Wildcat Baum-Upper Penn <b>UNDESIGNATED</b>
12. County Lea
19. Proposed Depth 10,000
19A. Formation Penn, Upper
20. Rotary or C.T. Rotary
21B. Drilling Contractor
22. Approx. Date Work will start

## APPLICATION FOR PERMIT TO DRILL, DEEPEN, OR PLUG BACK

1a. Type of Work	1b. Type of Well DRILL <input checked="" type="checkbox"/> DEEPEN <input type="checkbox"/> PLUG BACK <input type="checkbox"/> OIL WELL <input checked="" type="checkbox"/> GAS WELL <input type="checkbox"/> OTHER <input type="checkbox"/> SINGLE ZONE <input type="checkbox"/> MULTIPLE ZONE <input type="checkbox"/>
2. Name of Operator Amoco Production Company	
3. Address of Operator P. O. Box 68, Hobbs, New Mexico 88240	
4. Location of Well UNIT LETTER <u>K</u> LOCATED <u>1953</u> FEET FROM THE <u>West</u> LINE AND <u>1980</u> FEET FROM THE <u>South</u> LINE OF SEC. <u>19</u> TWP. <u>13-S</u> RGE. <u>33-E</u> NMPM	
21A. Kind & Status Plug. Bond Blanket on file	21B. Drilling Contractor
22. Approx. Date Work will start	

## PROPOSED CASING AND CEMENT PROGRAM

SIZE OF HOLE	SIZE OF CASING	WEIGHT PER FOOT	SETTING DEPTH	SACKS OF CEMENT	EST. TOP
17-1/2	13-3/8	48#	450'	Circ.	Surface
11" or 12-1/4	8-5/8	32#	4060'	Circ.	Surface
7-7/8	5-1/2"	17, 15.5#	10000'	tie back to 8-5/8	4060'

Propose to drill and equip well in upper Penn zone. After reaching TD, logs will be run and evaluated; perforate and/or stimulate as necessary in attempting commercial production.

Mud Program: 0-450 Native mud and fresh water  
450-4060 Native mud and brine water  
4060-10000 Fresh water with minimum properties for safe hole conditions  
use mud sweeps if necessary.

APPROVAL VALID FOR 180 DAYS  
PERMIT EXPIRES 5/2/83  
UNLESS DRILLING UNDERWAY.

IN ABOVE SPACE DESCRIBE PROPOSED PROGRAM; IF PROPOSAL IS TO DEEPEN OR PLUG BACK, GIVE DATA ON PRESENT PRODUCTIVE ZONE AND PROPOSED NEW PRODUCTIVE ZONE. GIVE BLOWOUT PREVENTER PROGRAM, IF ANY.

I hereby certify that the information above is true and complete to the best of my knowledge and belief.

Signed Charles M. Serrin Title Assist. Admin. Analyst Date 11-1-82

(This space for State Use)

ORIGINAL SIGNED BY

APPROVED BY JERRY SEXTON TITLE

CONDITIONS OF APPROVAL, PERMIT 1 SUPR

NOV 2 1982

RECEIVED

NOV 2 1982

O.C.D.  
HOBBS OFFICE

**NEW MEXICO OIL CONSERVATION COMMISSION  
WELL LOCATION AND ACREAGE DEDICATION PLAT**

Form C-102  
Supersedes C-128  
Effective 1-1-65

All distances must be from the outer boundaries of the Section.

Operator <b>AMOCO PRODUCTION CO.</b>			Lease <b>STATE DY</b>		Well No. <b>1</b>
Unit Letter <b>K</b>	Section <b>19</b>	Township <b>13S</b>	Range <b>33E</b>	County <b>LEA</b>	
Actual Footage Location of Well: <div style="display: flex; justify-content: space-between;"> <span><b>1980</b> feet from the <b>SOUTH</b> line and <b>1953</b> feet from the <b>WEST</b> line</span> </div>					
Ground Level Elev. <b>4292.8</b>	Producing Formation <b>Penn., Upper</b>		Pool <b>Baum-Upper Penn</b>	Dedicated Acreage: <b>160</b> Acres	

1. Outline the acreage dedicated to the subject well by colored pencil or hachure marks on the plat below.
2. If more than one lease is dedicated to the well, outline each and identify the ownership thereof (both as to working interest and royalty).
3. If more than one lease of different ownership is dedicated to the well, have the interests of all owners been consolidated by communitization, unitization, force-pooling, etc?

☐ Yes    ☐ No    If answer is "yes," type of consolidation \_\_\_\_\_

If answer is "no," list the owners and tract descriptions which have actually been consolidated. (Use reverse side of this form if necessary.) \_\_\_\_\_

No allowable will be assigned to the well until all interests have been consolidated (by communitization, unitization, forced-pooling, or otherwise) or until a non-standard unit, eliminating such interests, has been approved by the Commission.

NOTE: AN AREA 600x800 FEET WAS CHECKED WITH AN M-SCOPE AND NO BURIED PIPELINE WAS FOUND.

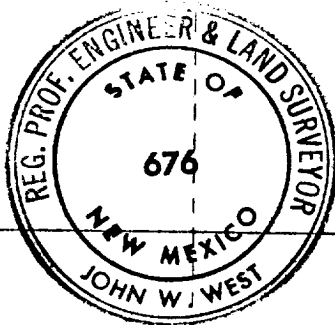

**CERTIFICATION**

I hereby certify that the information contained herein is true and complete to the best of my knowledge and belief.

Name: *Charles M. Loring*  
 Position: **Assist. Admin. Analyst**  
 Company: **Amoco Production Company**  
 Date: **11-1-82**

I hereby certify that the well location shown on this plat was plotted from field notes of actual surveys made by me or under my supervision, and that the same is true and correct to the best of my knowledge and belief.

Date Surveyed: **10/30/82**  
 Registered Professional Engineer and/or Land Surveyor

*John W. West*  
 Certificate No. \_\_\_\_\_

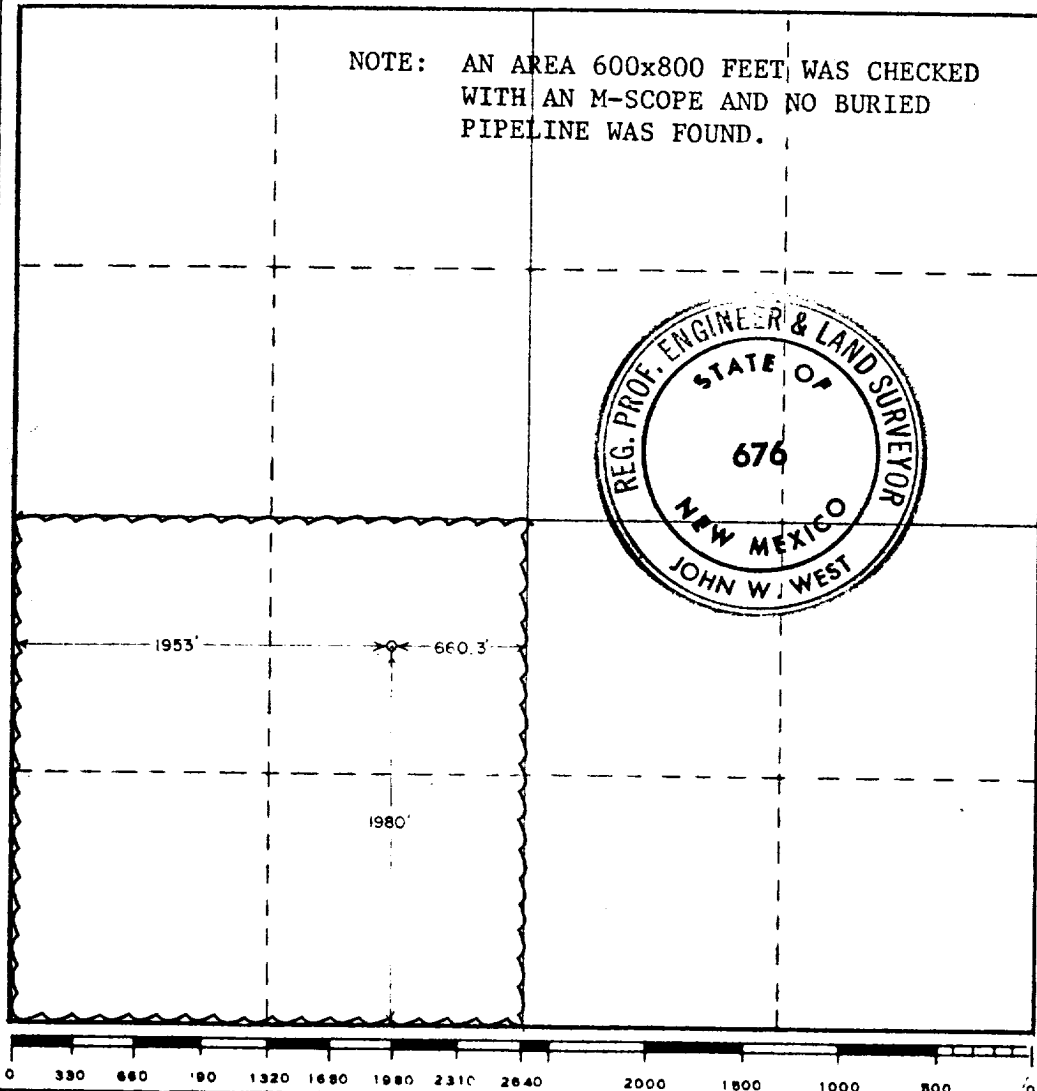

1. BOP'S TO BE FLUID OPERATED.
2. BOP'S AND ALL FITTINGS MUST BE IN GOOD CONDITION AND RATED AT 3000 PSI W.P. MINIMUM.
3. EQUIPMENT THROUGH WHICH BIT MUST PASS SHALL BE AT LEAST AS LARGE AS CASING SIZE BEING DRILLED THROUGH.
4. NIPPLE ABOVE BOP'S SHALL BE SAME SIZE AS LAST CASING SET.
5. UPPER KELLY COCK IS REQUIRED AND SHALL BE 3000# W.P. MINIMUM.
6. T. I. W. OR COMPARABLE SAFETY VALVE SHALL BE AVAILABLE ON RIG FLOOR WITH CONNECTION OR SUBS TO FIT ANY TOOL JOINT IN THE STRING. VALVE TO BE FULL BORE 5000# MIN.
7. VALVE NEXT TO SPOOL SHALL BE 4". OTHER EQUIPMENT MAY BE 3" OR 4". ALL CHOKE MANIFOLD EQUIPMENT SHALL BE FLANGED. FLOW LINE FROM MANIFOLD TO BE MINIMUM OF 3" AND STRAIGHT AS POSSIBLE WITH MINIMUM BENDS.
8. FLUID LINES FROM ACCUMULATOR TO BOP'S AND ALL REMOTE CONTROL FLUID LINES SHALL BE STEEL, AND RATED AT OR ABOVE MAXIMUM ACCUMULATOR PRESSURE. LINES SHALL BE ROUTED IN BUNDLES AND ADEQUATELY PROTECTED FROM DAMAGE.
9. USE RAMS IN FOLLOWING POSITIONS:\*

	<u>DRILLING</u>	<u>RUNNING CASING</u>
UPPER RAM	DRILL PIPE	CASING
LOWER RAM	BLIND	BLIND

\*AMOCO AREA SUPT. MAY REVERSE LOCATION OF RAMS.

10. CHOKE MANIFOLD, BEYOND SECOND VALVE FROM CROSS MAY BE OPTIONALLY POSITIONED OUTSIDE OF SUBSTRUCTURE.
11. EXTENSIONS AND HAND WHEELS TO BE INSTALLED AND BRACED AT ALL TIMES.
12. TWO INCH (2") LINES AND VALVES ARE PERMITTED ON THE KILL LINE.

NOTE: ALL UNMARKED VALVES MAY BE PLUG OR GATE VALVE, METAL TO METAL SEAL.

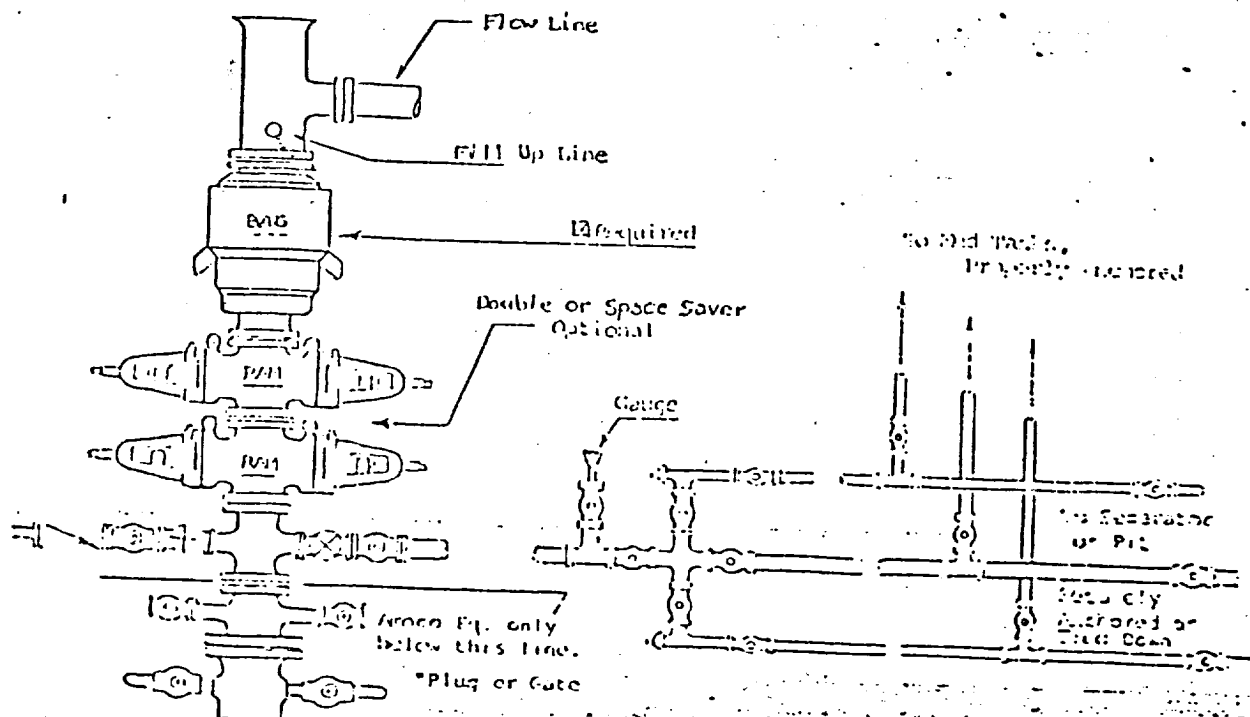

RECEIVED

NOV 2 1982

O.C.D.  
HOBBS OFFICE

173