

30-025-28082

Form C-101
Revised 1-1-65

NEW MEXICO OIL CONSERVATION COMMISSION

NO. OF COPIES RECEIVED	
DISTRIBUTION	
SANTA FE	
FILE	
U.S.G.S.	
LAND OFFICE	
OPERATOR	

5A. Indicate Type of Lease STATE <input checked="" type="checkbox"/> FEE <input type="checkbox"/>
5. State Oil & Gas Lease No. K-3657

APPLICATION FOR PERMIT TO DRILL, DEEPEN, OR PLUG BACK

1a. Type of Work b. Type of Well OIL WELL <input checked="" type="checkbox"/> GAS WELL <input type="checkbox"/> OTHER <input type="checkbox"/> SINGLE ZONE <input checked="" type="checkbox"/> MULTIPLE ZONE <input type="checkbox"/>		7. Unit Agreement Name	
2. Name of Operator Cabot Petroleum Corporation		8. Farm or Lease Name New Mexico State "T" State	
3. Address of Operator Box 5001, Pampa, Texas 79065		9. Well No. 3	
4. Location of Well UNIT LETTER "D" LOCATED 660 FEET FROM THE North LINE AND 520 FEET FROM THE West LINE OF SEC. 4 TWP. 14S RGE. 33E NMPM		10. Field and Pool, or Wildcat Baum (Upper Penn.)	
		12. County Lea	
		19. Proposed Depth 10,000'	
		19A. Formation Upper Penn.	
		20. Rotary or C.T. Rotary	
21. Elevations (Show whether DF, RT, etc.) 4241' GR		21A. Kind & Status Plug. Bond \$50,000 Blanket in force #749971	
		21B. Drilling Contractor Not named yet	
		22. Approx. Date Work will start 2-1-83	

23.

PROPOSED CASING AND CEMENT PROGRAM

SIZE OF HOLE	SIZE OF CASING	WEIGHT PER FOOT	SETTING DEPTH	SACKS OF CEMENT	EST. TOP
17-1/2"	13-3/8"	48#	400'	420	Surface
12-1/4"	8-5/8"	24#	4100'	1925	Surface
7-7/8"	5-1/2"	17#	10000'	555	3000'

Drill a replacement for Well #2. Form C-103 has been submitted and approved 11-23-82.

Double Ram, Hydraulic-Operated B.O.P. will be used.

APPROVAL VALID FOR 180 DAYS
PERMIT EXPIRES 6/15/83
UNLESS DRILLING UNDERWAY

IN ABOVE SPACE DESCRIBE PROPOSED PROGRAM: IF PROPOSAL IS TO DEEPEN OR PLUG BACK, GIVE DATA ON PRESENT PRODUCTIVE ZONE AND PROPOSED NEW PRODUCTIVE ZONE. GIVE BLOWOUT PREVENTER PROGRAM, IF ANY.

I hereby certify that the information above is true and complete to the best of my knowledge and belief.

Signed Tavel S. Anderson Title Agent Date 12-6-82

(This space for State Use)

ORIGINAL SIGNED BY

APPROVED BY JERRY SEXTON TITLE DISTRICT SUPERVISOR DATE DEC 15 1982

CONDITIONS OF APPROVAL IF ANY:

RECEIVED

RECEIVED

DEC 14 1982

DEC 8 1982

HOBBS

O.C.D.

HOBBS OFFICE

**NEW MEXICO OIL CONSERVATION COMMISSION
WELL LOCATION AND ACREAGE DEDICATION PLAT**

Form C-102
Supersedes C-128
Effective 1-1-65

All distances must be from the outer boundaries of the Section.

Operator CABOT PETROLEUM CORPORATION			Lease NEW MEXICO STATE T State		Well No. 3
Unit Letter D	Section 4	Township 14-S	Range 33-E	County LEA COUNTY NEW MEXICO	
Actual Footage Location of Well:					
660		feet from the NORTH		line and 520	
feet from the		WEST		line	
Ground Level Elev: 4241'	Producing Formation Upper Penn.		Pool Baum	Dedicated Acreage: 160 Acres	

1. Outline the acreage dedicated to the subject well by colored pencil or hachure marks on the plat below.
2. If more than one lease is dedicated to the well, outline each and identify the ownership thereof (both as to working interest and royalty).
3. If more than one lease of different ownership is dedicated to the well, have the interests of all owners been consolidated by communitization, unitization, force-pooling, etc?

☐ Yes ☐ No If answer is "yes," type of consolidation _____

If answer is "no," list the owners and tract descriptions which have actually been consolidated. (Use reverse side of this form if necessary.) _____

No allowable will be assigned to the well until all interests have been consolidated (by communitization, unitization, forced-pooling, or otherwise) or until a non-standard unit, eliminating such interests, has been approved by the Commission.

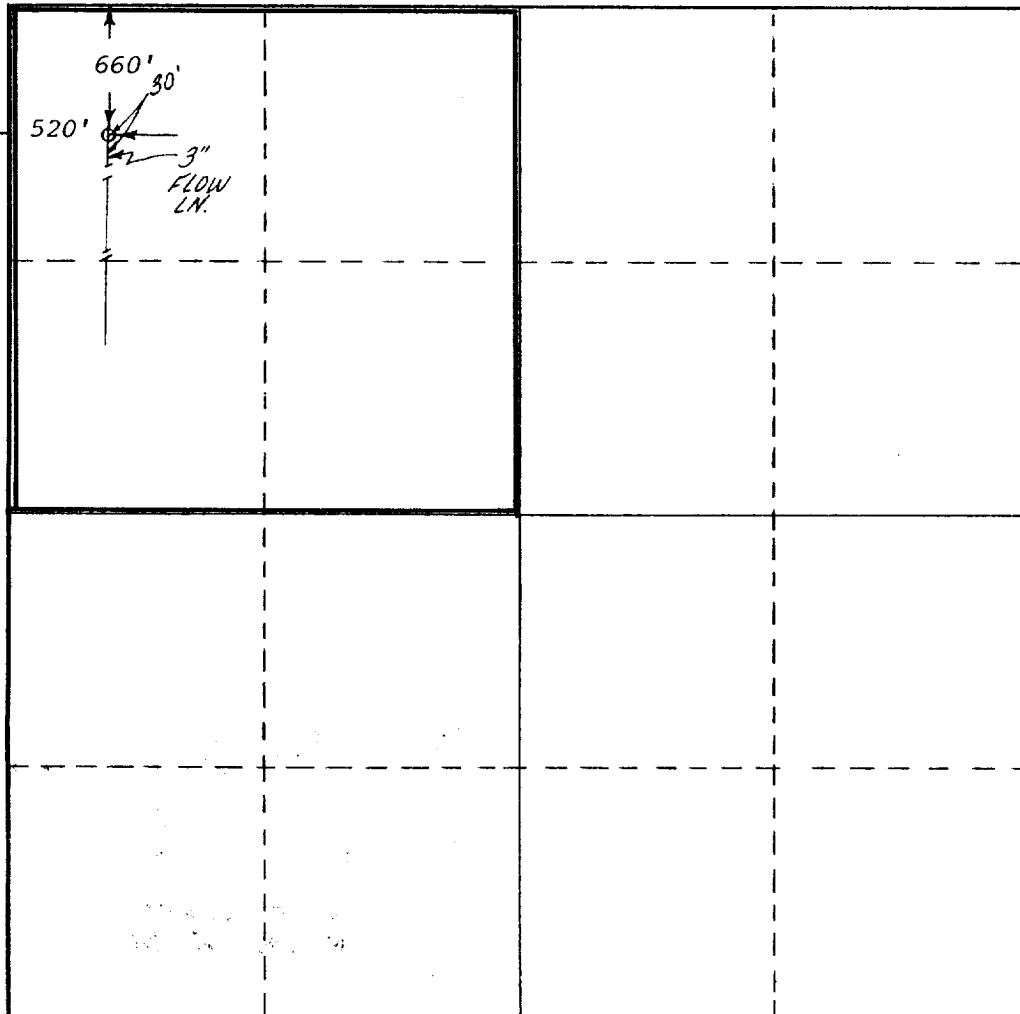

CERTIFICATION

I hereby certify that the information contained herein is true and complete to the best of my knowledge and belief.

Tamara Andrus

Name

Agent

Position

Cabot Petroleum Corporation

Company

December 6, 1982

Date

I hereby certify that the well location shown on this plat was plotted from field notes of actual surveys made by me or under my supervision, and that the same is true and correct to the best of my knowledge.

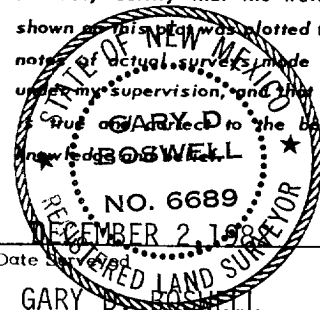

Date

Registered Professional Engineer
and/or Land Surveyor

Gary D. Boswell

Certificate No.

6689

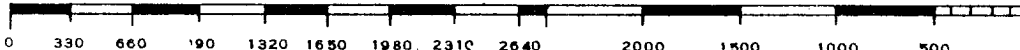

RECEIVED

DEC 14 1982

OLD
HOBBS OFFICE

RECEIVED

DEC 8 1982

PCA
HOBBS OFFICE

28/12/82
11/12/82
11/12/82