

30-025-28103

NO. OF COPIES RECEIVED	
DISTRIBUTION	
SANTA FE	
FILE	
U.S.G.S.	
LAND OFFICE	
OPERATOR	

NEW MEXICO OIL CONSERVATION COMMISSION

Form O-1-1
Revised 1-78

1A. Indicate by check STATE <input checked="" type="checkbox"/> FEDERAL <input type="checkbox"/>
2. State Oil & Gas Lease No. K-6231

APPLICATION FOR PERMIT TO DRILL, DEEPEN, OR PLUG BACK

1a. Type of Work b. Type of Well DRILL <input checked="" type="checkbox"/> DEEPEN <input type="checkbox"/> PLUG BACK <input type="checkbox"/> OIL WELL <input checked="" type="checkbox"/> GAS WELL <input type="checkbox"/> OTHER <input type="checkbox"/> SINGLE ZONE <input checked="" type="checkbox"/> MULTIPLE ZONE <input type="checkbox"/>		7. Unit Agreement No.
2. Name of Operator Marks & Garner Production Co.		8. Name of Leaseholder Huber State
3. Address of Operator c/o Oil REports & Gas Services, Inc. Box 763, Hobbs, NM 88240		9. Well No. 3
4. Location of Well UNIT LETTER <u>A</u> LOCATED <u>660</u> FEET FROM THE <u>North</u> LINE AND <u>660</u> FEET FROM THE <u>East</u> LINE OF SEC. <u>2</u> TWP. <u>14S</u> RGE. <u>33E</u> N.M.P.M.		10. Field name, or Section Lazy J Penn
		11. County Lea
		12. Proposed Depth 10,000
		13A. Formation Penn
		13B. Drilling Contractor Hondo Drllg. Co.
21. Elevations (Show whether DF, RT, etc.) 4187.7		21A. Kind & Status Plug. Bond Blanket
		21B. Date of Completion 12/27/82

PROPOSED CASING AND CEMENT PROGRAM

SIZE OF HOLE	SIZE OF CASING	WEIGHT PER FOOT	SETTING DEPTH	SACKS OF CEMENT	EST. TOP
17	13 3/8	48#	375	350	Circ.
11	8 5/8	24# & 32#	4220	500	2250
7 7/8	5 1/2	17#	10,000	600	6540

Completion to be conventional perforation & treatment.

Blowout preventor sketch attached.

Cement on the 8 5/8 casing m.s. be
run from the bottom of the well to
the surface of the casing using the
water cement slurry with 100 lbs. of
Dry seal at the top of the slot.

APPROVAL VALID FOR 180 DAYS
PERMIT EXPIRES 6/23/83
UNLESS DRILLING UNDERWAY

IN ABOVE SPACE DESCRIBE PROPOSED PROGRAM; IF PROPOSAL IS TO DEEPEN OR PLUG BACK, GIVE DATA ON PRESENT PRODUCTIVE ZONE AND PROPOSED NEW PRODUCTIVE ZONE. GIVE BLOWOUT PREVENTER PROGRAM, IF ANY.

I hereby certify that the information above is true and complete to the best of my knowledge and belief.

Signed W. J. H. H. H. Title Agent Date 12/22/82

(This space for State Use)

APPROVED BY ORIGINAL SIGNED BY
JERRY SEXTON TITLE DISTRICT 1 SUPR. DATE DEC 22 1982
CONDITIONS OF APPROVAL, IF ANY:

RECEIVED

DEC 19 1982

122
HOBBS OFFICE

**NEW MEXICO OIL CONSERVATION COMMISSION
WELL LOCATION AND ACREAGE DEDICATION PLAT**

Form O-102
Supersedes C-128
Effective 1-1-65

All distances must be from the outer boundaries of the Section

Operator MARKS & GARNER			Lease Huber State		Well No. 23
Block Letter A	Section 2	Township 14 South	Range 33 East	County Lea	
Actual Well Location of Well:					
660	feet from the	North	line and	660	feet from the
Greater of well below:		Pre-existing formation	Pool	Dedicated Acreage:	
4187.7'		Penn	Lazy J	40.45	Acres

1. Outline the acreage dedicated to the subject well by colored pencil or hatchure marks on the plat below.
2. If more than one lease is dedicated to the well, outline each and identify the ownership thereof (both as to working interest and royalty).
3. If more than one lease of different ownership is dedicated to the well, have the interests of all owners been consolidated by communitization, unitization, force-pooling, etc?

Yes ☐ No ☐ If answer is "yes," type of consolidation _____

If answer is "no," list the owners and tract descriptions which have actually been consolidated. (Use reverse side of this form if necessary.) _____

No allowable will be assigned to the well until all interests have been consolidated (by communitization, unitization, force-pooling, or otherwise) or until a non-standard unit, eliminating such interests, has been approved by the Commission.

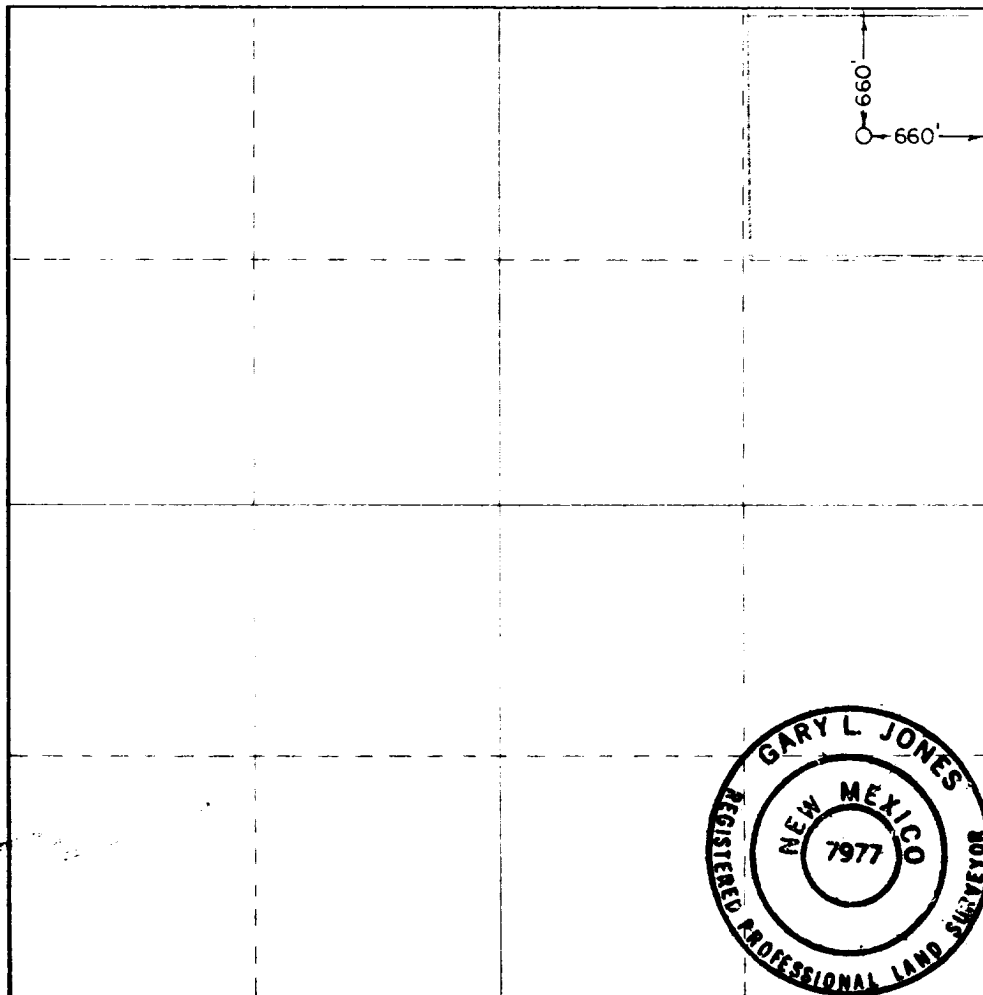

CERTIFICATION

I hereby certify that the information contained herein is true and complete to the best of my knowledge and belief.

[Signature]

Agent

Marks & Garner Production Company

12/22/82

I hereby certify that the well location shown on this plat was plotted from field notes of actual surveys made by me or under my supervision, and that the same is true and correct to the best of my knowledge and belief.

Date Surveyed

December 17, 1982

Registered Professional Engineer and/or Land Surveyor

[Signature]

Certificate No.

7977

RECEIVED

DEC 22 1982

O.C.D.
HOBBS OFFICE

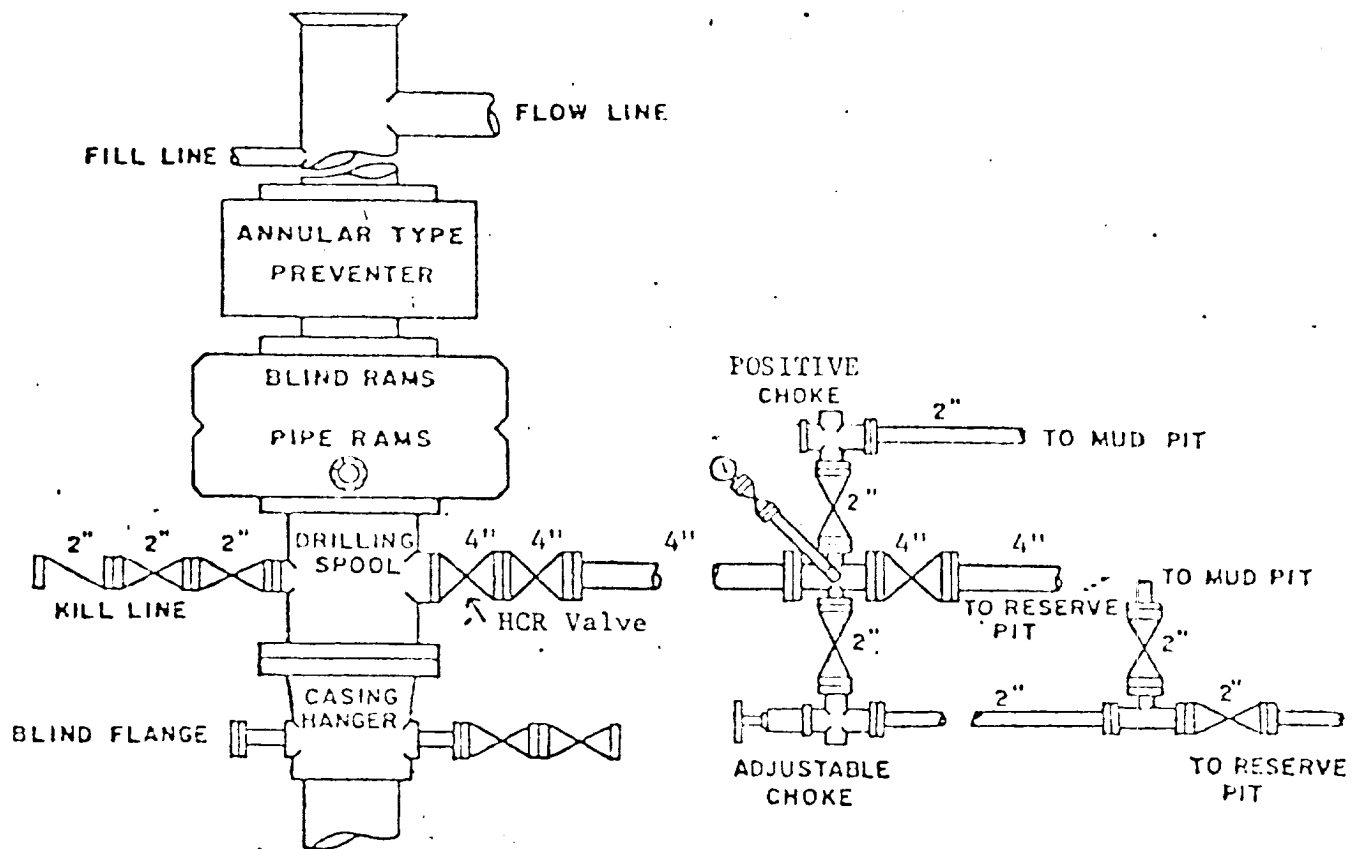

Hondo Drilling Company
Rig No. 3

1, 200, 000

DEC 22 1980

MOBIS OFFICE

2000000
12/21/80
12/21/80