

30-025-28136

NO. OF COPIES RECEIVED	
DISTRIBUTION	
SANTA FE	
FILE	
U.S.G.S.	
LAND OFFICE	
OPERATOR	

NEW MEXICO OIL CONSERVATION COMMISSION

Form C-101
Revised 1-1-85

5A. Indicate Type of Lease
STATE FEE

5. State Oil & Gas Lease No.
LG-3675

APPLICATION FOR PERMIT TO DRILL, DEEPEN, OR PLUG BACK

1a. Type of Work
b. Type of Well
DRILL DEEPEN PLUG BACK
OIL WELL GAS WELL OTHER SINGLE ZONE MULTIPLE ZONE

6. Name of Operator
Yates Petroleum Corporation

7. Unit Agreement Name
Swan "VB"

8. Field and Pool, or Well Unit
Saunders Permo Penn

9. Well No.
2

10. Location of Well
UNIT LETTER J LOCATED 1980 FEET FROM THE South LINE
AND 1980 FEET FROM THE East LINE OF SEC. 21 TWP. 14S RGE. 33E

11. County
Lea

12. Proposed Depth
10200'

13A. Formation
Permo Penn

13B. Rotary or C.C.
Rotary

14. Blowout Preventer (Show whether DP, RT, etc.)
4213.1 GL

21A. Kind & Status Plug. Bond
Blanket

21B. Drilling Contractor
Landis 3

22. Approx. Date Work will start
ASAP

PROPOSED CASING AND CEMENT PROGRAM

SIZE OF HOLE	SIZE OF CASING	WEIGHT PER FOOT	SETTING DEPTH	SACKS OF CEMENT	EST. TOP
17-1/2"	13-3/8"	48# J-55	450'	400 sx	Circulate
12-1/4"	8-5/8"	24# J-55	4200'	1300 sx	400'
7-7/8"	5-1/2"	17# N-80-L 17# K-55-L 17# K-55-S 17# N-80-L	TD	450 sx	9200'

We propose to drill a 10200' well and test the Permo Penn and intermediate formations. Approximately 450' of surface casing will be set and cemented circulated and approximately 4200' of intermediate casing will be set and cement circulated back to about 400'. Production casing will be set to TD and cemented back to approximately 9200'.

MUD PROGRAM: FW gel to 450'; native mud 4200'; water + paper to 7500'; Starch-driskak KCL to TD.

BOP PROGRAM: BOP's will be installed at the offset and tested daily.

IN ABOVE SPACE DESCRIBE PROPOSED PROGRAM; IF PROPOSAL IS TO DEEPEN OR PLUG BACK, GIVE DATA ON PRESENT PRODUCTIVE ZONE AND PROPOSED NEW PRODUCTIVE ZONE. GIVE BLOWOUT PREVENTER PROGRAM, IF ANY.

I hereby certify that the information above is true and complete to the best of my knowledge and belief.

Signed Eddie W. Seay Title Regulatory Agent Date 1-25-83

(This space for State Use)
ORIGINAL SIGNED BY
EDDIE W. SEAY

APPROVED BY _____ TITLE _____ DATE JAN 25 1983

CONDITIONS OF APPROVAL, IF ANY:

APPROVAL VALID FOR 180 DAYS
PERMIT EXPIRES 7/25/83
UNLESS DRILLING UNDERWAY

RECEIVED

JAN 25 1983

**C.C.D.
HOBBS OFFICE**

NEW MEXICO OIL CONSERVATION COMMISSION
WELL LOCATION AND ACREAGE DEDICATION PLAT

Form C-102
Supersedes C-128
Effective 1-1-65

All distances must be from the outer boundaries of the Section.

Operator YATES PETROLEUM CORPORATION			Lease SWAN "VB" STATE		Well No. 2
Tract Letter J	Section 21	Township 14 South	Range 33 East	County Lea	
Actual Footage Location of Well: 1980 feet from the South line and 1980 feet from the East line					
Ground Level Elev. 4213.1	Producing Formation PERMO-PENN		Pool SAUNDERS PERMO-PENN		Dedicated Acreage: 40 Acres

1. Outline the acreage dedicated to the subject well by colored pencil or hachure marks on the plat below.
2. If more than one lease is dedicated to the well, outline each and identify the ownership thereof (both as to working interest and royalty).
3. If more than one lease of different ownership is dedicated to the well, have the interests of all owners been consolidated by communitization, unitization, force-pooling, etc?

Yes No If answer is "yes," type of consolidation _____

If answer is "no," list the owners and tract descriptions which have actually been consolidated. (Use reverse side of this form if necessary.) _____

No allowable will be assigned to the well until all interests have been consolidated (by communitization, unitization, forced-pooling, or otherwise) or until a non-standard unit, eliminating such interests, has been approved by the Commission.

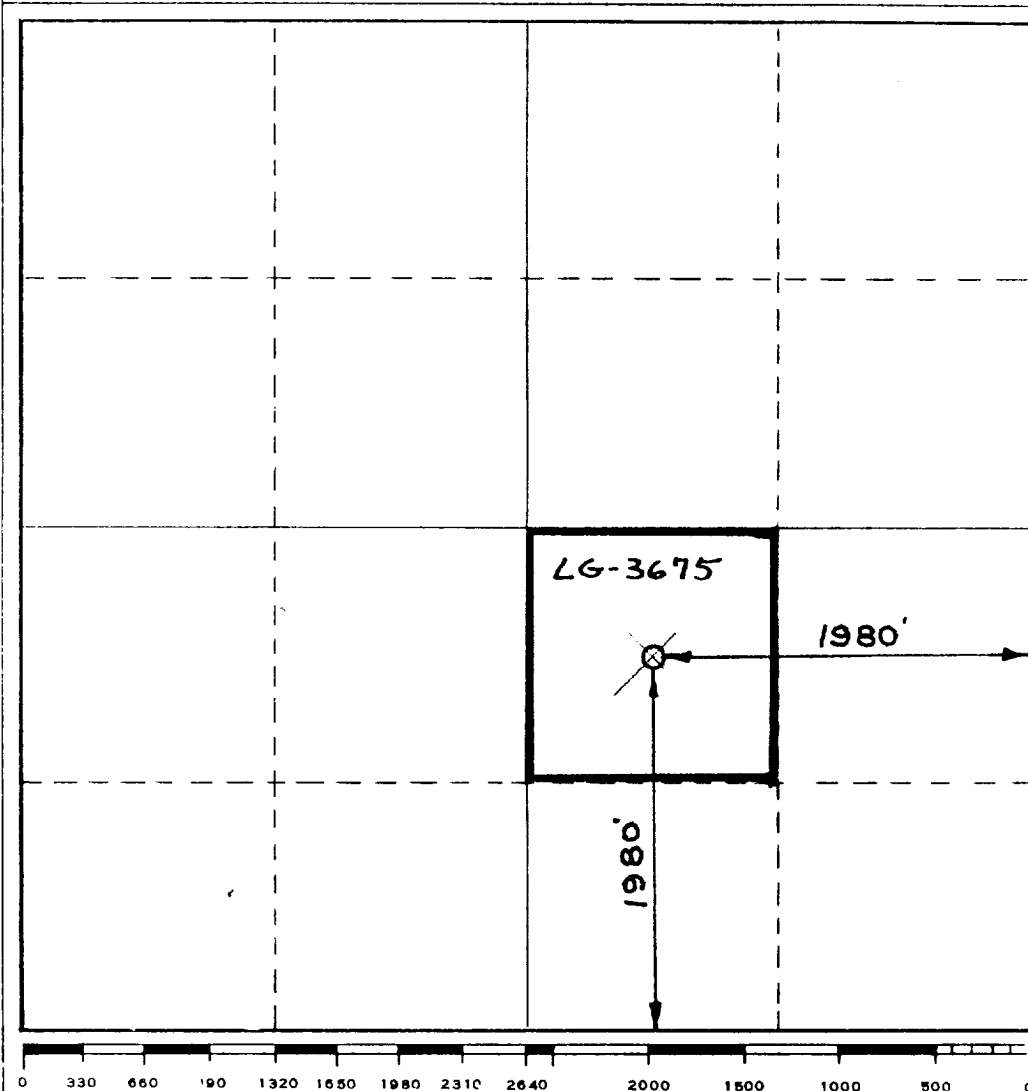

CERTIFICATION

I hereby certify that the information contained herein is true and complete to the best of my knowledge and belief.

Gliserio Rodriguez
Name:

GLISERIO RODRIGUEZ
Position

AGENT

Company
YATES PETROLEUM CORP

Date
1-25-83

I hereby certify that the well location shown on this plat was plotted from field notes of actual survey made by me or under my supervision, and that the same is true and correct to the best of my knowledge and belief.

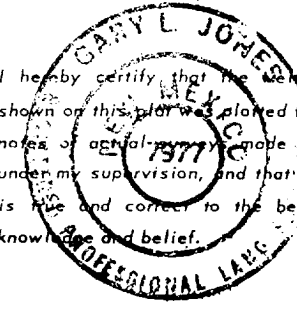

Date Surveyed
Jan. 25 1983

Registered Professional Engineer and/or Land Surveyor

Gary L. Jones
Certificate No.

7977

RECEIVED

JAN 25 1983

O.C.D.
HOBBS OFFICE

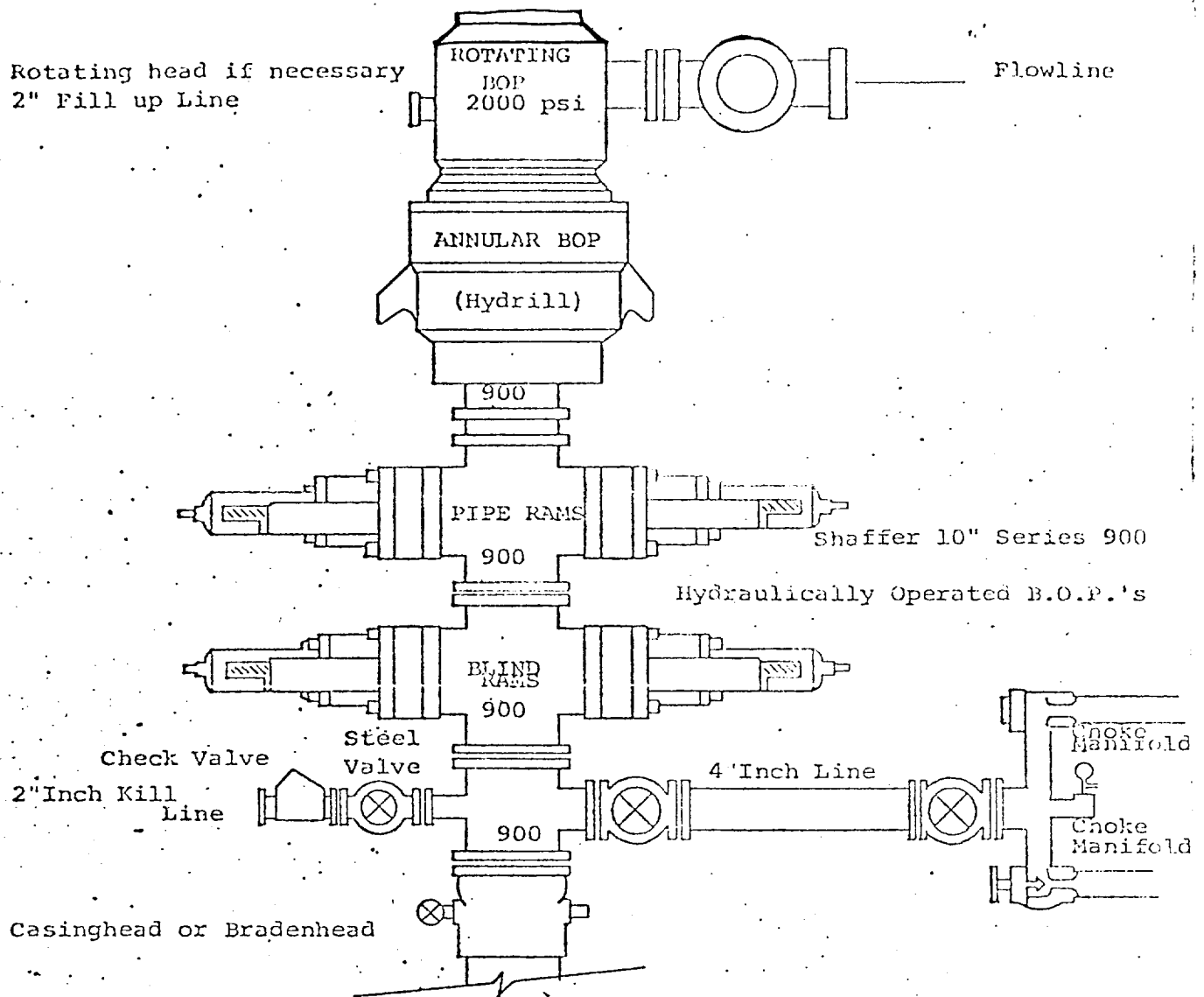

THE FOLLOWING CONSTITUTE MINIMUM BLOWOUT PREVENTER REQUIREMENTS

1. All preventers to be hydraulically operated with secondary manual controls installed prior to drilling out from under casing.
2. Choke outlet to be a minimum of 4" diameter.
3. Kill line to be of all steel construction of 2" minimum diameter.
4. All connections from operating manifolds to preventers to be all steel. hole or tube a minimum of one inch in diameter.
5. The available closing pressure shall be at least 15% in excess of that required with sufficient volume to operate the B.O.P.'s.
6. All connections to and from preventer to have a pressure rating equivalent to that of the B.O.P.'s.
7. Inside blowout preventer to be available on rig floor.
8. Operating controls located a safe distance from the rig floor.
9. Hole must be kept filled on trips below intermediate casing. Operator not responsible for blowouts resulting from not keeping hole full.
10. D. P. float must be installed and used below zone of first gas intrusion.

Wm. H. ...

RECEIVED

JAN 25 1923

U.S. DEPT. OF JUSTICE
RECORDS DIVISION

FILE

*Director
Prof. ...
9.26.86*

Director Prof. ... 10-30-22