

NO. OF COPIES RECEIVED	
DISTRIBUTION	
SANTA FE	
FILE	
U.S.G.S.	
LAND OFFICE	
OPERATOR	

5A. Indicate Type of Lease  
STATE ☒ FEE ☐  
5. State Oil & Gas Lease No.  
LG-2942

APPLICATION FOR PERMIT TO DRILL, DEEPEN, OR PLUG BACK

4. Type of Work  
a. Type of Well DRILL ☒ DEEPEN ☐ PLUG BACK ☐  
OIL WELL ☒ GAS WELL ☐ OTHER ☐ SINGLE ZONE ☐ MULTIPLE ZONE ☐

7. Unit Agreement Name  
8. Farm or Lease Name  
Dean Ranch "XA" St.

6. Name of Operator  
Yates Petroleum Corporation  
Address of Operator  
207 S. 4th, Artesia, New Mexico 88210

9. Well No.  
1

7. Location of Well  
UNIT LETTER H LOCATED 1980 FEET FROM THE North LINE

10. Field and Pool, or Wildcat  
Tulok Penn

ND 660 FEET FROM THE East LINE OF SEC. 28 TWP. 14S RGE. 32E

INDICATED

17. County  
Lea

1. Elevation (Show whether DT, RI, etc.) 4315.4' GL	21A. Kind & Status Plug. Bond Blanket	19. Proposed Depth 10,150'	19A. Formation Permo-Penn	20. Rotary or C.T. Rotary
		21B. Drilling Contractor Collier #11	22. Approx. Date Work will start ASAP	

PROPOSED CASING AND CEMENT PROGRAM

SIZE OF HOLE	SIZE OF CASING	WEIGHT PER FOOT	SETTING DEPTH	SACKS OF CEMENT	EST. TOP
17 1/2"	13 3/8"	48# J-55	450'	400 sx	circulated
12 1/4"	8 5/8"	24# J-55	4200'	1300 sx	400'
7 7/8"	5 1/2"	17# N-80-L	TD		
		17# K-55-L			
		17# K-55-S			
		17# N-80-L			

We propose to drill a 10,150' well and test the Permo-Penn and intermediate formations. Approximately 450' of surface casing will be set and cement circulated and approximately 4200' of intermediate will be set and cement circulated back to about 400'. Production casing will be set to TD and cemented back to approximately 9200'.

MUD PROGRAM: FW gel to 450', native mud 4200', water & paper to 7500', starch/driskpak/KCL to TD.

BOP PROGRAM: BOP's will be installed at the offset and tested daily.

GAS NOT DEDICATED.

ABOVE SPACE DESCRIBE PROPOSED PROGRAM; IF PROPOSAL IS TO DEEPEN OR PLUG BACK, GIVE DATA ON PRESENT PRODUCTIVE ZONE AND PROPOSED NEW PRODUCTIVE ZONE. GIVE BLOWOUT PREVENTER PROGRAM, IF ANY.

I hereby certify that the information above is true and complete to the best of my knowledge and belief.

Signed Gloria Rody Title Regulatory Agent Date 3/2/83

(This space for State Use)

ORIGINAL SIGNED BY JERRY SEXTON

MAR 3 1983

APPROVED BY DISTRICT 1 SUPERVISOR TITLE  DATE

CONDITIONS OF APPROVAL, IF ANY:

APPROVAL VALID FOR 180 DAYS  
PERMIT EXPIRES 7/31/83  
UNLESS DRILLING UNDERWAY

**NEW MEXICO OIL CONSERVATION COMMISSION  
WELL LOCATION AND ACREAGE DEDICATION PLAT**

Form C-102  
Supersedes C-128  
Effective 1-1-65

All distances must be from the outer boundaries of the Section.

Operator <b>YATES PETROLEUM CORPORATION</b>			Lease <b>Dean Ranch "XA" State <i>Comm</i></b>		Well No. <b>1</b>
Unit Letter <b>H</b>	Section <b>28</b>	Township <b>14 South</b>	Range <b>32 East</b>	County <b>Lea</b>	
Actual Portion Location of Well: <b>1980</b> feet from the <b>North</b> line and <b>660</b> feet from the <b>East</b> line					
Ground Level Elev. <b>4315.4'</b>	Producing Formation <b>Permo Penn</b>		Pool <b>Tulk Penr.</b>		Dedicated Acreage: <b>160</b> Acres

1. Outline the acreage dedicated to the subject well by colored pencil or hachure marks on the plat below.
2. If more than one lease is dedicated to the well, outline each and identify the ownership thereof (both as to working interest and royalty).
3. If more than one lease of different ownership is dedicated to the well, have the interests of all owners been consolidated by communitization, unitization, force-pooling, etc?

☒ Yes    ☐ No    If answer is "yes," type of consolidation communitization

If answer is "no," list the owners and tract descriptions which have actually been consolidated. (Use reverse side of this form if necessary.) \_\_\_\_\_

No allowable will be assigned to the well until all interests have been consolidated (by communitization, unitization, forced-pooling, or otherwise) or until a non-standard unit, eliminating such interests, has been approved by the Commission.

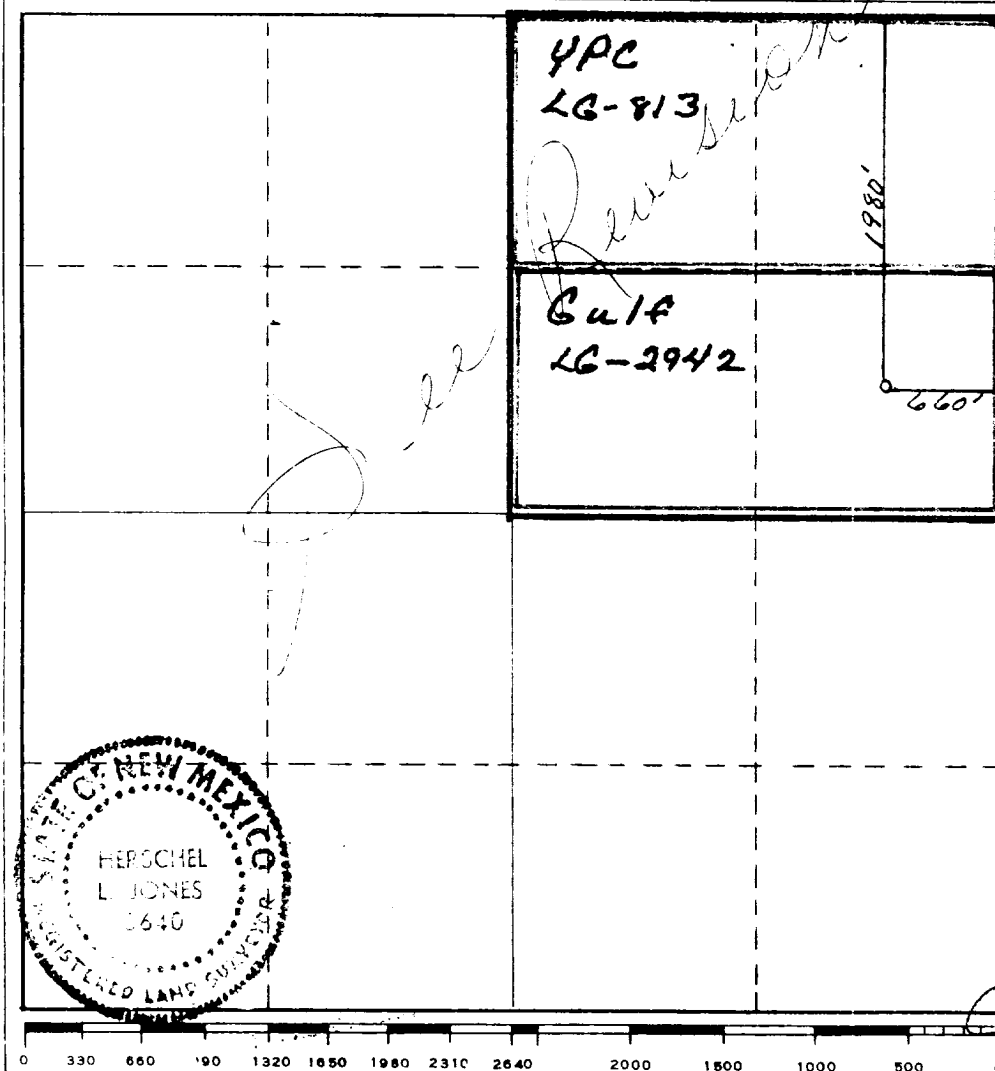

**CERTIFICATION**

I hereby certify that the information contained herein is true and complete to the best of my knowledge and belief.

Name

**Gliserio Rodriguez**

Position

**Regulatory Agent**

Company

**Yates Petroleum Corp.**

Date

**3/2/83**

I hereby certify that the well location shown on this plat was plotted from field notes of actual surveys made by me or under my supervision, and that the same is true and correct to the best of my knowledge and belief.

Date Surveyed

**March 1, 1983**

Registered Professional Engineer  
and/or Land Surveyor

Certificate No.

**3640**

Rotating head if necessary  
2" Fill up Line

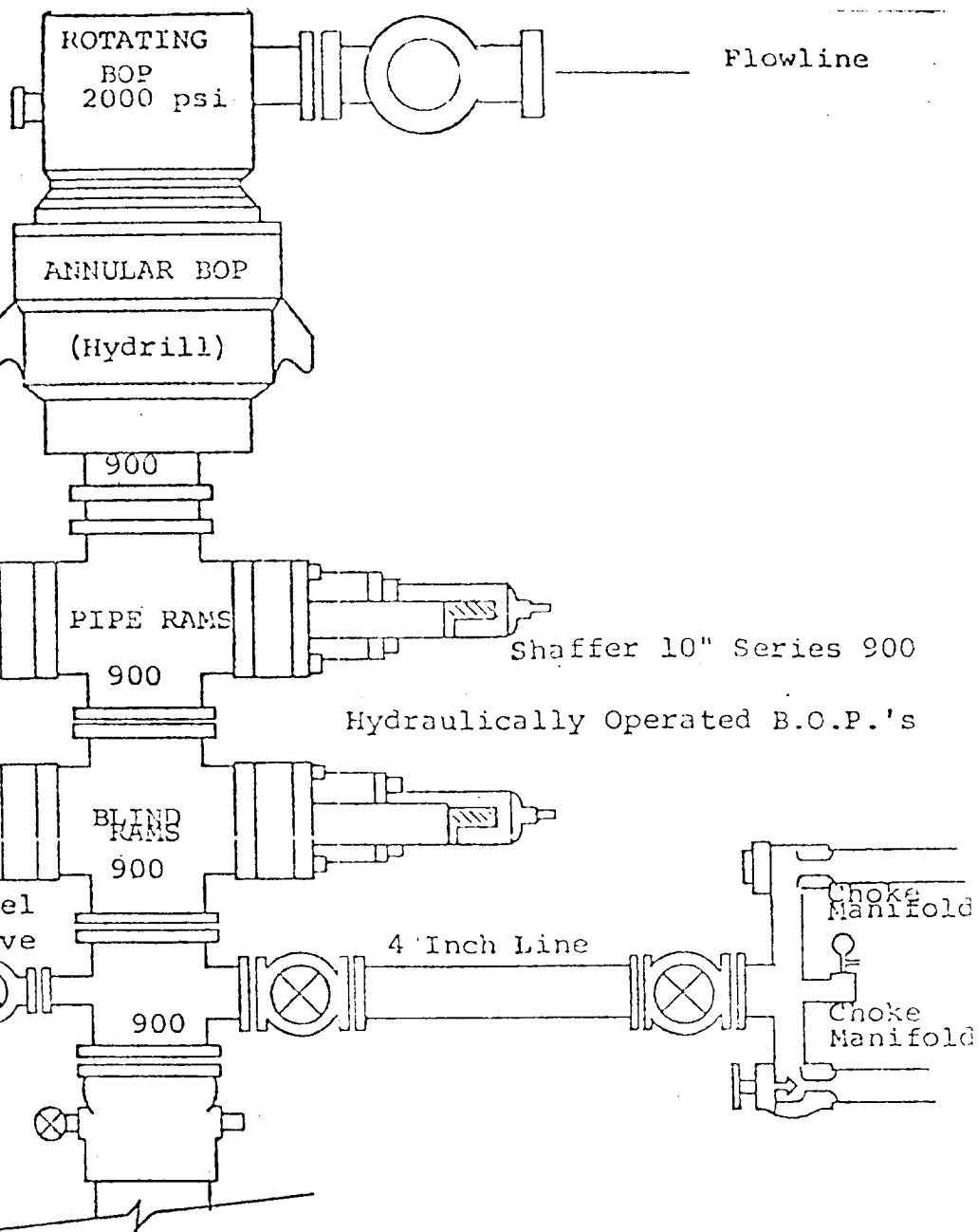

THE FOLLOWING CONSTITUTE MINIMUM BLOWOUT PREVENTER REQUIREMENTS

1. All preventers to be hydraulically operated with secondary manual controls installed prior to drilling out from under casing.
2. Choke outlet to be a minimum of 4" diameter.
3. Kill line to be of all steel construction of 2" minimum diameter.
4. All connections from operating manifolds to preventers to be all steel. Hole or tube a minimum of one inch in diameter.
5. The available closing pressure shall be at least 15% in excess of that required with sufficient volume to operate the B.O.P.'s.
6. All connections to and from preventer to have a pressure rating equivalent to that of the B.O.P.'s.
7. Inside blowout preventer to be available on rig floor.
8. Operating controls located a safe distance from the rig floor.
9. Hole must be kept filled on trips below intermediate casing.
10. B. P. float must be installed and used below zone of first gas intrusion.

RECEIVED  
MAR 2 1983  
O.C.D.  
HOBBS OFFICE

173