

NO. OF COPIES RECEIVED	
DISTRIBUTION	
SANTA FE	
FILE	
U.S.G.S.	
LAND OFFICE	
OPERATOR	

5A. Indicate Type of Lease
STATE <input checked="" type="checkbox"/> REC <input type="checkbox"/>
5. State Oil & Gas Lease No.
LG-4904

APPLICATION FOR PERMIT TO DRILL, DEEPEN, OR PLUG BACK

a. Type of Work		7. Unit Agreement Name	
b. Type of Well		8. Farm or Lease Name	
DRILL <input checked="" type="checkbox"/>	DEEPEN <input type="checkbox"/>	Wallaby "WZ" St. Com	
OIL WELL <input checked="" type="checkbox"/>	GAS WELL <input type="checkbox"/>	9. Well No.	
OTHER <input type="checkbox"/>	SINGLE ZONE <input type="checkbox"/>	1	
Name of Operator		10. Field and Pool, or Wildcat	
Yates Petroleum Corporation		Unders. Baum-Upper Pe	
Address of Operator		11. County	
207 S. 4th, Artesia, New Mexico 88210		Lea	
Location of Well		12. County	
UNIT LETTER N	LOCATED 660	Lea	
FEET FROM THE South	LINE		
1980	FEET FROM THE West		
LINE OF SEC. 18	TWP. 13S		
RGE. 33E	NMPM		
19. Proposed Depth		19A. Formation	20. Rotary or C.T.
10,300'		Bough "C"	Rotary
1. Elevations (Show whether DF, KI, etc.)	21A. Kind & Status Plug. Bond	21B. Drilling Contractor	22. Approx. Date Work will start
4287.3' GL	Blanket	Ard Drilling	ASAP

PROPOSED CASING AND CEMENT PROGRAM

SIZE OF HOLE	SIZE OF CASING	WEIGHT PER FOOT	SETTING DEPTH	SACKS OF CEMENT	EST. TOP
17 1/2"	13 3/8"	48# J-55	appr. 400'	400 sx	circulated
12 1/4"	8 5/8"	24# J-55	appr. 4200'	2450 sx	circulated
7 7/8"	5 1/2"	17# K&N	TD	300 sx	

Propose to drill and test the Bough "C" and intermediate horizons. Approximately 400' of surface casing will be set, cement circulated, and approximately 4200' of intermediate casing will be set, cement circulated. If commercial, will case, cement, perforate and stimulate as needed for production.

MUD PROGRAM: FW gel to 400', native mud 4200', water/paper to 7500', starch-drisk-KCL to TD.

BOP PROGRAM: BOP's on 8 5/8" casing, tested daily.

GAS NOT DEDICATED.

APPROVAL VALID FOR 180 DAYS
PERMIT EXPIRES 9/19/83
UNLESS DRILLING UNDERWAY

ABOVE SPACE DESCRIBE PROPOSED PROGRAM; IF PROPOSAL IS TO DEEPEN OR PLUG BACK, GIVE DATA ON PRESENT PRODUCTIVE ZONE AND PROPOSED NEW PRODUCTION ZONE, GIVE BLOWOUT PREVENTER PROGRAM, IF ANY.

I hereby certify that the information above is true and complete to the best of my knowledge and belief.

Signed Jerry Sexton Title Regulatory Agent Date 3/14/83

(This space for State Use)

ORIGINAL SIGNED BY JERRY SEXTON

APPROVED BY DISTRICT 1 SUPERVISOR TITLE DATE MAR 14 1983

CONDITIONS OF APPROVAL, IF ANY:

RECEIVED

MAR 14 1983

**O.C.D.
HOBBS OFFICE**

NEW MEXICO OIL CONSERVATION COMMISSION
WELL LOCATION AND ACREAGE DEDICATION PLAT

Form C-102
Supersedes C-128
Effective 1-1-65

All distances must be from the outer boundaries of the Section.

Operator YATES PETROLEUM CORPORATION			Lease Wallaby WZ State COM		Well No. 1
Unit Letter N	Section 18	Township 13 South	Range 33 East	County Lea	
Actual Footage Location of Well: 660 feet from the South line and 1980 feet from the West line					
Ground Level Elev. 4287.3	Producing Formation BOLAN C	Pool Hunter Baum-Hagerman		Dedicated Acreage: 160 Acres	

1. Outline the acreage dedicated to the subject well by colored pencil or hatchure marks on the plat below.
2. If more than one lease is dedicated to the well, outline each and identify the ownership thereof (both as to working interest and royalty).
3. If more than one lease of different ownership is dedicated to the well, have the interests of all owners been consolidated by communitization, unitization, force-pooling, etc?

☒ Yes ☐ No If answer is "yes," type of consolidation COMMUNITIZATION

If answer is "no," list the owners and tract descriptions which have actually been consolidated. (Use reverse side of this form if necessary.)

No allowable will be assigned to the well until all interests have been consolidated (by communitization, unitization, forced-pooling, or otherwise) or until a non-standard unit, eliminating such interests, has been approved by the Commission.

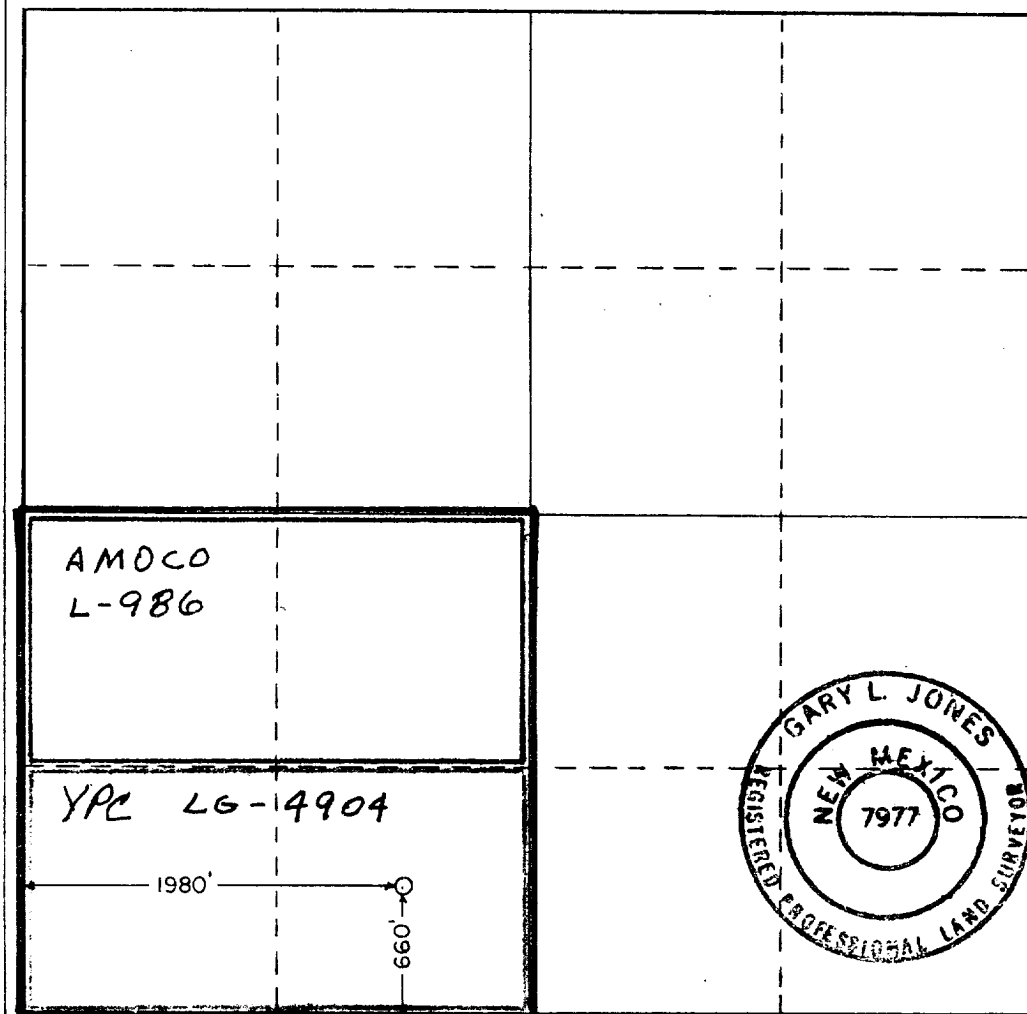

CERTIFICATION

I hereby certify that the information contained herein is true and complete to the best of my knowledge and belief.

Gliserio Rodriguez
Name

GLISERIO RODRIGUEZ
Position

AGENT

Company
YATES PETROLEUM CORP

Date
3-14-83

I hereby certify that the well location shown on this plat was plotted from field notes of actual surveys made by me or under my supervision, and that the same is true and correct to the best of my knowledge and belief.

Date Surveyed
March 9, 1983

Registered Professional Engineer and/or Land Surveyor

Gary L. Jones
Certificate No.

7977

0 330 660 990 1320 1650 1980 2310 2640 2000 1500 1000 500

RECEIVED

MAR 14 1983

**O.C.D.
HOBBS OFFICE**

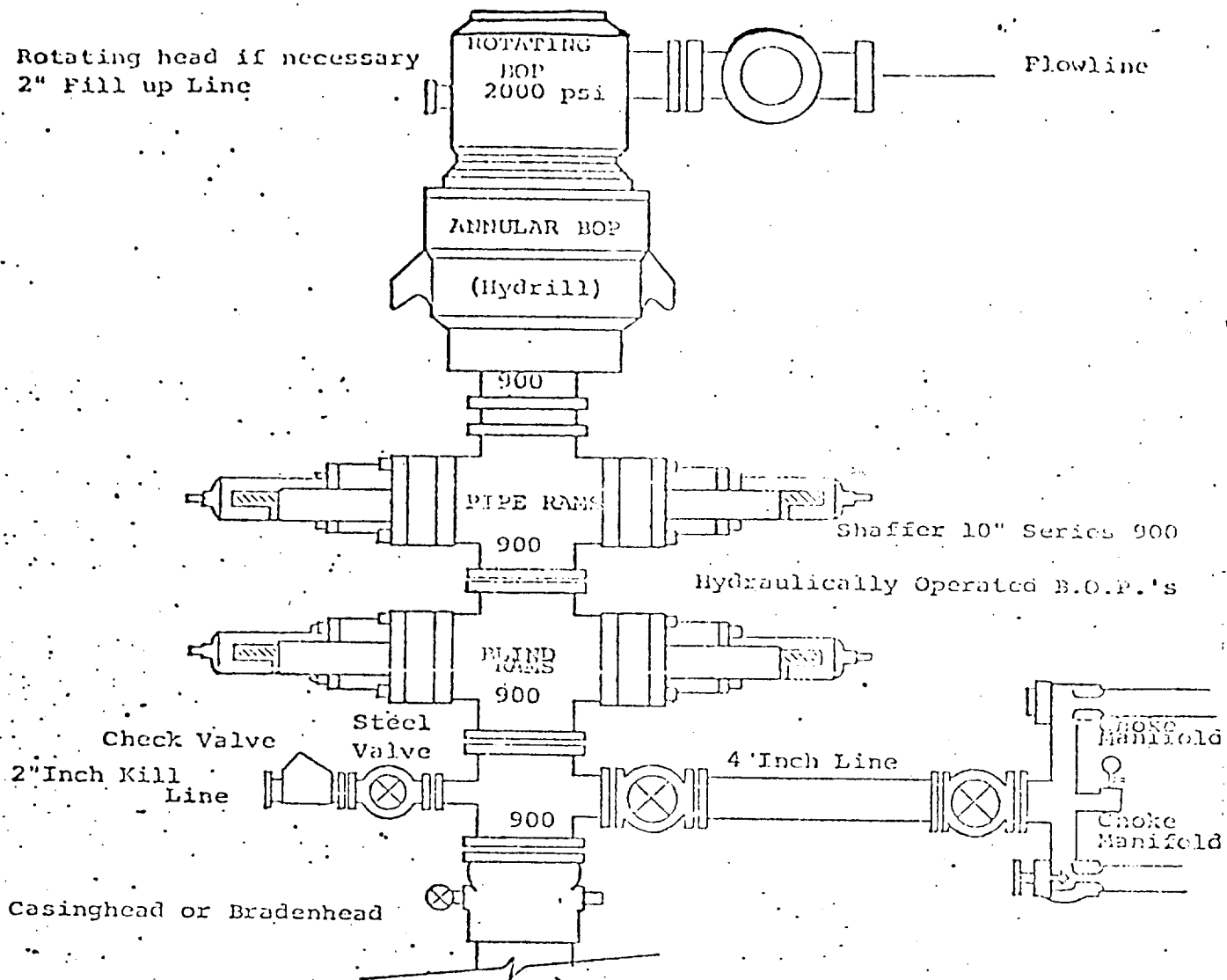

THE FOLLOWING CONSTITUTE MINIMUM BLOWOUT PREVENTER REQUIREMENTS

1. All preventers to be hydraulically operated with secondary manual controls installed prior to drilling out from under casing.
2. Choke outlet to be a minimum of 4" diameter.
3. Kill line to be of all steel construction of 2" minimum diameter.
4. All connections from operating manifolds to preventers to be all steel. hole or tube a minimum of one inch in diameter.
5. The available closing pressure shall be at least 15% in excess of that required with sufficient volume to operate the B.O.P.'s.
6. All connections to and from preventer to have a pressure rating equivalent to that of the B.O.P.'s.
7. Inside blowout preventer to be available on rig floor.
8. Operating controls located a safe distance from the rig floor.
9. Hole must be kept filled on trips below intermediate casing. Operator not responsible for blowouts resulting from not keeping hole full.
10. D. P. float must be installed and used below zone of first gas intrusion.

RECEIVED

MAR 14 1983

O.C.D.
HOBBS OFFICE

10/5/83
10