

STATE OF NEW MEXICO
ENERGY AND MINERALS DEPARTMENT

OIL CONSERVATION DIVISION
P. O. BOX 2088
SANTA FE, NEW MEXICO 87501

Form C-101
Revised 10-1-78

NO. OF COPIES RECEIVED	
DISTRIBUTION	
SANTA FE	
FILE	
U.S.G.S.	
LAND OFFICE	
OPERATOR	

5A. Indicate Type of Lease STATE <input checked="" type="checkbox"/> FEE <input type="checkbox"/>
5. State Oil & Gas Lease No. LG-8294
7. Unit Agreement Name
8. Farm or Lease Name State "22"
9. Well No. 2
10. Field and Pool, or Wildcat Undesignated
12. County Lea
19. Proposed Depth 8894'-8906'
19A. Formation Abo
20. Rotary or C.T.
21. Elevations (Show whether DF, RT, etc.) 4317' KB
21A. Kind & Status Plug. Bond
21B. Drilling Contractor
22. Approx. Date Work will start Oct 27, 1986

APPLICATION FOR PERMIT TO DRILL, DEEPEN, OR PLUG BACK

1a. Type of Work	1b. Type of Well DRILL <input type="checkbox"/> DEEPEN <input type="checkbox"/> PLUG BACK <input checked="" type="checkbox"/> OIL WELL <input checked="" type="checkbox"/> GAS WELL <input type="checkbox"/> OTHER <input type="checkbox"/> SINGLE ZONE <input type="checkbox"/> MULTIPLE ZONE <input type="checkbox"/>
2. Name of Operator Coastal Oil & Gas Corporation	3. Address of Operator P. O. Box 235, Midland, Texas 79702
4. Location of Well UNIT LETTER 0 LOCATED 660 FEET FROM THE south LINE AND 1340 FEET FROM THE east LINE OF SEC. 22 TWP. 14-S RGE. 32-E NMPM	
23.	

PROPOSED CASING AND CEMENT PROGRAM

SIZE OF HOLE	SIZE OF CASING	WEIGHT PER FOOT	SETTING DEPTH	SACKS OF CEMENT	EST. TOP

This well is producing from Bough "B" and Bough "C" perms in the Tulk (Penn) Field. The proposed recompletion is in the Abo formation from 8894'08906'. The procedure is as follows:

1. POOH with rods and tubing.
2. Set RBP at 8950' and test to 2500 psi.
3. Perforate Abo from 8894'-8906' with 2 SPF. Acidize perms with 20% HCl.
4. Run tubing and rods and pump test well.

There is no known Abo production in the immediate area. This is our only producing well in the SE/4 of this section, which is all we have leased (160 acres).

IN ABOVE SPACE DESCRIBE PROPOSED PROGRAM; IF PROPOSAL IS TO DEEPEN OR PLUG BACK, GIVE DATA ON PRESENT PRODUCTIVE ZONE AND PROPOSED NEW PRODUCTIVE ZONE. GIVE BLOWOUT PREVENTER PROGRAM, IF ANY.

I hereby certify that the information above is true and complete to the best of my knowledge and belief.

Signed B. L. Smith B. L. Smith Title Petroleum Engineer Date 10-24-86

(This space for State Use)

Eddie W. Sney

APPROVED BY Oil & Gas Division TITLE Oil & Gas Division DATE OCT 28 1986

CONDITIONS OF APPROVAL, IF ANY:

NEW MEXICO OIL CONSERVATION COMMISSION
WELL LOCATION AND ACREAGE DEDICATION PLAT

Form C-103
Supersedes C-128
Effective 1-1-83

All distances must be from the outer boundaries of the Section

Lessor COASTAL OIL & GAS CO.			Lease STATE 22		Well No. 2
Well Letter 0	Section 22	Township 14 SOUTH	Range 32 EAST	County LEA	
Actual Footage Location of Well:					
660 feet from the SOUTH line and		1340 feet from the EAST line			
Ground Level Elev. 4302.84	Producing Formation Bough "C" also		Pool Tulk (Penn) also	Dedicated Acreage: 160	

1. Outline the acreage dedicated to the subject well by colored pencil or hatchure marks on the plat below.
2. If more than one lease is dedicated to the well, outline each and identify the ownership thereof (both as to working interest and royalty).
3. If more than one lease of different ownership is dedicated to the well, have the interests of all owners been consolidated by communitization, unitization, force-pooling, etc?

☐ Yes ☒ No If answer is "yes," type of consolidation _____

If answer is "no," list the owners and tract descriptions which have actually been consolidated. (Use reverse side of this form if necessary.) _____

No allowable will be assigned to the well until all interests have been consolidated (by communitization, unitization, forced-pooling, or otherwise) or until a non-standard unit, eliminating such interests, has been approved by the Commission.

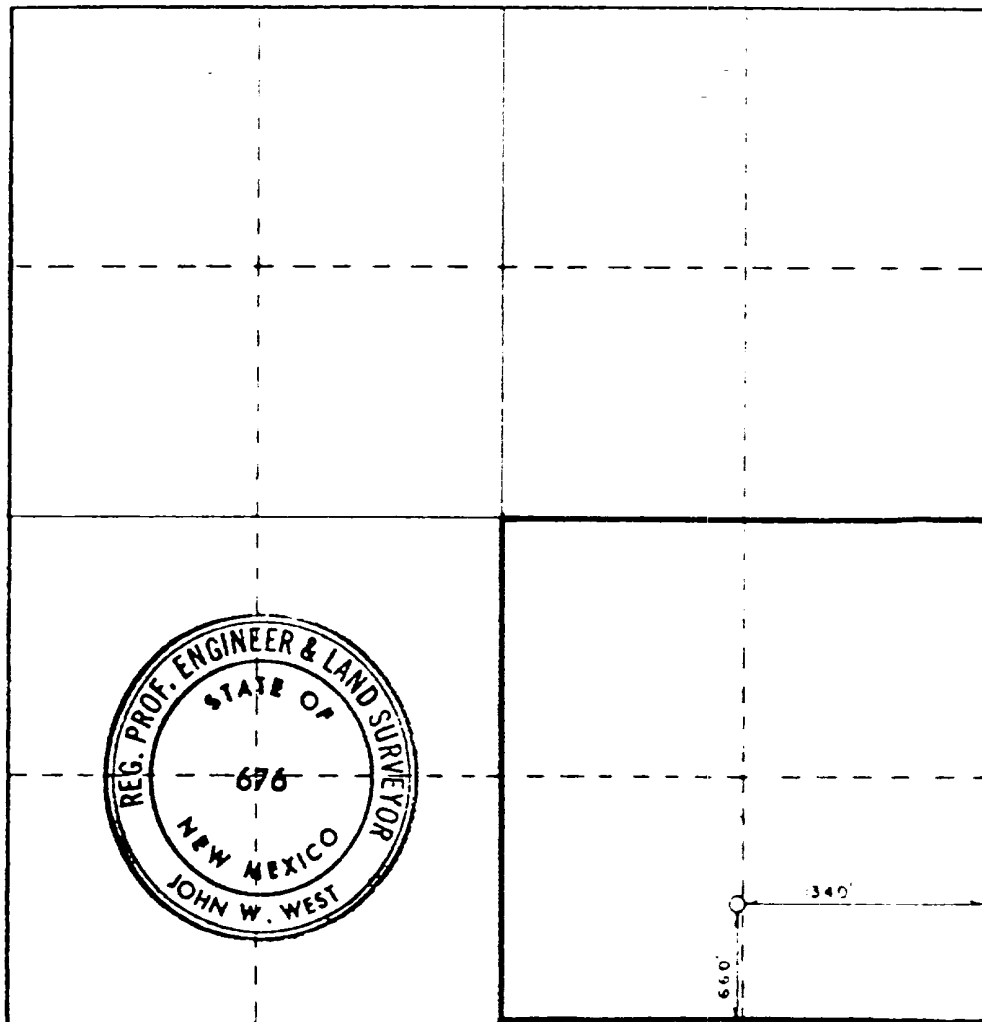

CERTIFICATION

I hereby certify that the information contained herein is true and complete to the best of my knowledge and belief

Name
B. L. Smith
Position
Petroleum Engineer
Company
Coastal Oil & Gas Corp.
Date

I hereby certify that the well location shown on this plat was plotted from field notes of actual surveys made by me or under my supervision, and that the same is true and correct to the best of my knowledge and belief.

Date Surveyed
OCTOBER 25, 1983
Registered Professional Engineer and/or Land Surveyor

John W. West
Certificate No. **JOHN W. WEST, 676**