

NO. OF COPIES RECEIVED	
DISTRIBUTION	
SANTA FE	
FILE	
U.S.G.S.	
LAND OFFICE	
OPERATOR	

Form C-105
Revised 11-84

NEW MEXICO OIL CONSERVATION COMMISSION WELL COMPLETION OR RECOMPLETION REPORT AND LOG

5a. Indicate Type of Lease	
State <input type="checkbox"/>	Fee <input checked="" type="checkbox"/>
5. State Oil & Gas Lease No.	

1a. TYPE OF WELL	
OIL WELL <input type="checkbox"/>	GAS WELL <input type="checkbox"/> DRY <input checked="" type="checkbox"/> OTHER _____
b. TYPE OF COMPLETION	
NEW WELL <input type="checkbox"/> WORK OVER <input type="checkbox"/> DEEPEN <input type="checkbox"/>	PLUG BACK <input type="checkbox"/> DIFF. RESVR. <input type="checkbox"/> OTHER _____

7. Unit Agreement Name
8. Farm or Lease Name Smith
9. Well No. 1
10. Field and Pool, or Wildcat Wildcat

2. Name of Operator
Union Texas Petroleum Corporation

3. Address of Operator
4000 N. Big Spring, Suite 500, Midland, Texas 79705

4. Location of Well
UNIT LETTER F LOCATED 1980 FEET FROM THE North LINE AND 1980 FEET FROM

THE West LINE OF SEC. 13 TWP. 14S RGE. 37E Lea County

15. Date Spudded 2-9-84	16. Date T.D. Reached 3-10-84	17. Date Compl. (Ready to Prod.) Dry	18. Elevations (DF, RKB, RT, GR, etc.) 3816 GL	19. Elev. Casinghead ---
----------------------------	----------------------------------	---	---	-----------------------------

20. Total Depth 10,800	21. Plug Back T.D. Surface	22. If Multiple Compl., How Many P&A	23. Intervals Drilled By Rotary Tools 0-10800	Cable Tools ---
---------------------------	-------------------------------	---	---	--------------------

24. Producing interval(s), of this completion - Top, Bottom, Name None	25. Was Directional Survey Made Yes
---	--

26. Type Electric and Other Logs Run	27. Was Well Cored No
--------------------------------------	--------------------------

28. CASING RECORD (Report all strings set in well)					
CASING SIZE	WEIGHT LB. FT.	DEPTH SET	HOLE SIZE	CEMENTING RECORD	AMOUNT PULLED
13-3/8	54.5	424	17-1/2	400 sx "C" Circulated	None
8-5/8	24,28 & 32	4685	11	1700 HWL + 300 sx "C"	None

29. LINER RECORD					30. TUBING RECORD		
SIZE	TOP	BOTTOM	SACKS CEMENT	SCREEN	SIZE	DEPTH SET	PACKER SET

31. Perforation Record (Interval, size and number) None	32. ACID, SHOT, FRACTURE, CEMENT SQUEEZE, ETC.	
	DEPTH INTERVAL	AMOUNT AND KIND MATERIAL USED

33. PRODUCTION							
Date First Production		Production Method (Flowing, gas lift, pumping - Size and type pump)				Well Status (Prod. or Shut-in)	
Date of Test	Hours Tested	Choke Size	Prod'n. For Test Period	Oil - Bbl.	Gas - MCF	Water - Bbl.	Gas - Oil Ratio
Flow Tubing Press.	Casing Pressure	Calculated 24-Hour Rate	Oil - Bbl.	Gas - MCF	Water - Bbl.	Oil Gravity - API (Corr.)	

34. Disposition of Gas (Sold, used for fuel, vented, etc.)	Test Witnessed By
--	-------------------

35. List of Attachments

36. I hereby certify that the information shown on both sides of this form is true and complete to the best of my knowledge and belief.

SIGNED *William H. Higgins* TITLE Regul. Compl. Coordinator DATE 4-1-85

INSTRUCTIONS

This form is to be filed with the appropriate District Office of the Commission not later than 30 days after the completion of any newly-drilled or deepened well. It shall be accompanied by one copy of all electrical and radio-activity logs run on the well and a summary of all special tests conducted, including drill stem tests. All depths reported shall be measured depths. In the case of directionally drilled wells, true vertical depths shall also be reported. For multiple completions, Items 30 through 34 shall be reported for each zone. The form is to be filed in quintuplicate except on state land, where six copies are required. See Rule 1105.

INDICATE FORMATION TOPS IN CONFORMANCE WITH GEOGRAPHICAL SECTION OF STATE

Southeastern New Mexico

Northwestern New Mexico

T. Anhy <u>2250</u>	T. Canyon	T. Ojo Alamo	T. Penn. "B"
T. Salt	T. Strawn	T. Kirtland-Fruitland	T. Penn. "C"
B. Salt	T. Atoka	T. Pictured Cliffs	T. Penn. "D"
T. Yates <u>3300</u>	T. Miss	T. Cliff House	T. Leadville
T. 7 Rivers	T. Devonian	T. Menefee	T. Madison
T. Queen	T. Silurian	T. Point Lookout	T. Elbert
T. Grayburg	T. Montoya	T. Mancos	T. McCracken
T. San Andres <u>4650</u>	T. Simpson	T. Gallup	T. Ignacio Qtzite
T. Glorieta	T. McKee	Base Greenhorn	T. Granite
T. Paddock	T. Ellenburger	T. Dakota	T.
T. Blinberry <u>7452</u>	T. Gr. Wash	T. Morrison	T.
T. Tubb	T. Granite	T. Todilto	T.
T. Drinkard	T. Delaware Sand	T. Entrada	T.
T. Abo	T. Bone Springs	T. Wingate	T.
T. Wolfcamp <u>10,238</u>	T.	T. Chinle	T.
T. Penn.	T.	T. Permian	T.
T. Cisco (Bough C) <u>10,742</u>	T.	T. Penn. "A"	T.

OIL OR GAS SANDS OR ZONES

No. 1, from.....to.....	No. 4, from.....to.....
No. 2, from.....to.....	No. 5, from.....to.....
No. 3, from.....to.....	No. 6, from.....to.....

IMPORTANT WATER SANDS

Include data on rate of water inflow and elevation to which water rose in hole.

No. 1, from.....to.....feet.....
No. 2, from.....to.....feet.....
No. 3, from.....to.....feet.....
No. 4, from.....to.....feet.....

FORMATION RECORD (Attach additional sheets if necessary)

From	To	Thickness in Feet	Formation	From	To	Thickness in Feet	Formation
0	2250	2250	Sand & Shale				
2250	3300	750	Salt, Anhydrite, Sand & Dolomite				
3300	4650	1350	Anhydrite, Dolomite, Sand & Salt				
4650	8150	3500	Dolomite & Lime				
8150	9600	1450	Dolomite & Shale				
9600	10,800	1200	Limestone & Sandy Shale				

RECEIVED
APR 11 1935
FIELD OFFICE

NEW-MEXICO OIL CONSERVATION COMMISSION
WELL LOCATION AND ACREAGE DEDICATION PLAT

Form C-102
Supersedes C-128
Effective 1-1-65

All distances must be from the outer boundaries of the Section.

Operator ENSTAR PETROLEUM, INC.			Lease SMITH			Well No. 1		
Unit Letter "F"	Section 13	Township 14 - S		Range 37 - E	County LEA N.MEX.			
Actual Footage Location of Well:								
1980 feet from the NORTH line and			1980 feet from the WEST line					
Ground Level Elev. 3816	Producing Formation WOLFCAMP		Pool WILDCAT			Dedicated Acreage: 40 Acres		

1. Outline the acreage dedicated to the subject well by colored pencil or hachure marks on the plat below.
2. If more than one lease is dedicated to the well, outline each and identify the ownership thereof (both as to working interest and royalty).
3. If more than one lease of different ownership is dedicated to the well, have the interests of all owners been consolidated by communitization, unitization, force-pooling, etc?

☐ Yes ☐ No If answer is "yes," type of consolidation na

If answer is "no," list the owners and tract descriptions which have actually been consolidated. (Use reverse side of this form if necessary.) na

No allowable will be assigned to the well until all interests have been consolidated (by communitization, unitization, forced-pooling, or otherwise) or until a non-standard unit, eliminating such interests, has been approved by the Commission.

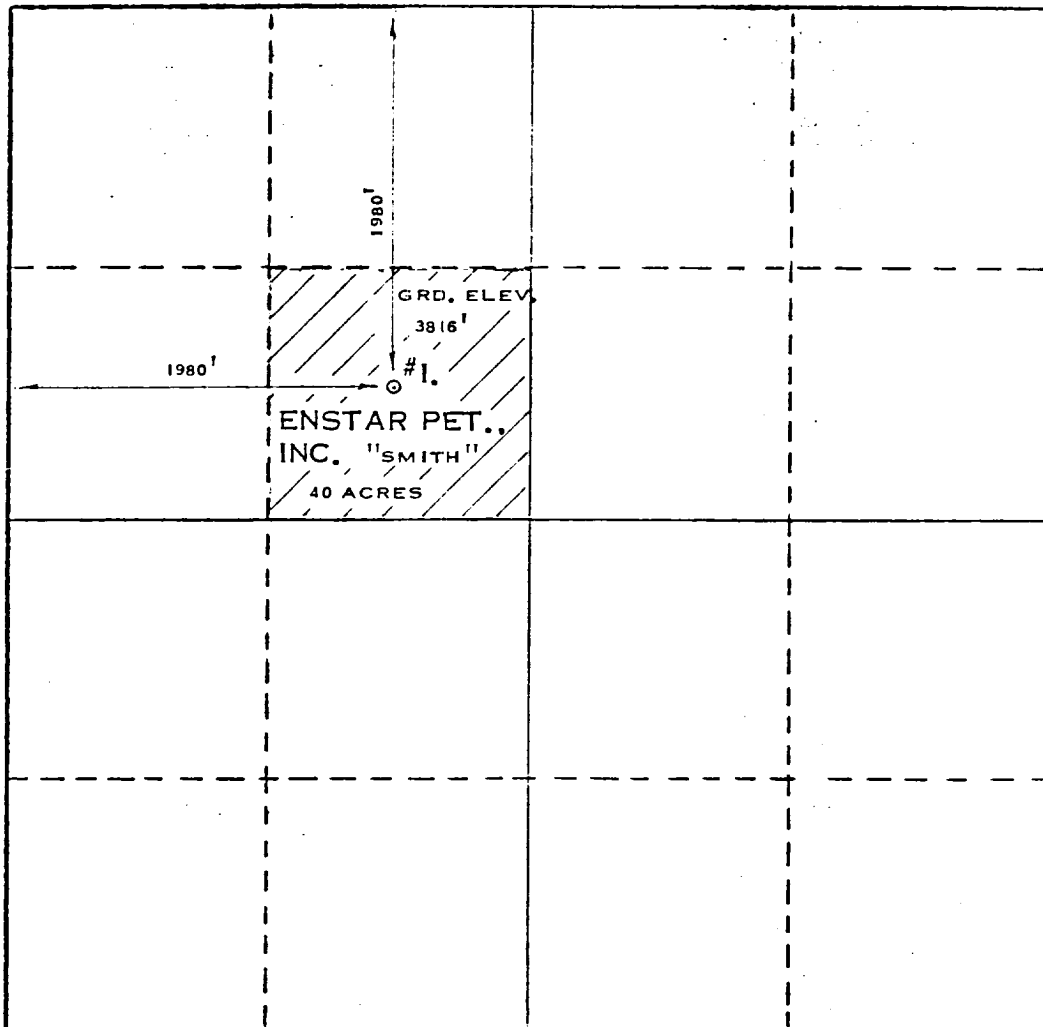

CERTIFICATION

I hereby certify that the information contained herein is true and complete to the best of my knowledge and belief.

Name Bill M. Priddy
Position Operations Manager
Company ENSTAR Petroleum, Inc.
Date November 8, 1983

I hereby certify that the well location shown on this plat was plotted from field notes of actual surveys made by me or under my supervision, and that the same is true and correct to the best of my knowledge and belief.

Date Surveyed
NOVEMBER, 4, 1983
Registered Professional Engineer and/or Land Surveyor
Max A. Schumann, Jr.
Certificate No. 1510

0 330 660 990 1320 1650 1980 2310 2640 2000 1500 1000 500 0