

30-025-28478

NO. OF COPIES RECEIVED	
DISTRIBUTION	
SANTA FE	
FILE	
U.S.G.S.	
LAND OFFICE	
OPERATOR	

NEW MEXICO OIL CONSERVATION COMMISSION

Form C-101
Revised 1-1-65

5A. Indicate Type of Lease	
STATE <input type="checkbox"/>	FEE <input checked="" type="checkbox"/>
5. State Oil & Gas Lease No.	

APPLICATION FOR PERMIT TO DRILL, DEEPEN, OR PLUG BACK

1a. Type of Work		7. Unit Agreement Name	
b. Type of Well OIL WELL <input checked="" type="checkbox"/> GAS WELL <input type="checkbox"/> OTHER <input type="checkbox"/>		8. Name of Lease Name Smith	
2. Name of Operator ENSTAR Petroleum, Inc.		9. Well No. #1	
3. Address of Operator P. O. Drawer 3546, Midland, TX 79702		10. Field and Pool, or Without Wildcat	
4. Location of Well UNIT LETTER <u>F</u> LOCATED <u>1980</u> FEET FROM THE <u>North</u> LINE AND <u>1980</u> FEET FROM THE <u>West</u> LINE OF SEC. <u>13</u> TWP. <u>14-S</u> RGE. <u>37-E</u>		12. County Lea	
19. Proposed Depth 10,800'		15A. Formation Wolfcamp	
21A. Kind & Status Plug. Bond Blanket		20. Rotary or C.T. Rotary	
21. Elevations (Show whether OF, RI, etc.) 3816' GL		22. Approx. Date Work will start 11/15/83	

PROPOSED CASING AND CEMENT PROGRAM

SIZE OF HOLE	SIZE OF CASING	WEIGHT PER FOOT	SETTING DEPTH	SACKS OF CEMENT	EST. TOP
17-1/2"	13-3/8"	48	400	400	Surf.
12-1/4"	8-5/8"	24 & 32	4700	1600	Surf.
7-7/8"	5-1/2"	17 & 20	10800	500	9000

Double Ram and Annular Preventor rated 3000 psig.

APPROVAL VALID FOR 180 DAYS
 PERMIT EXPIRES 5-14-84
 UNLESS DRILLING UNDERWAY

IN ABOVE SPACE DESCRIBE PROPOSED PROGRAM: IF PROPOSAL IS TO DEEPEN OR PLUG BACK, GIVE DATA ON PRESENT PRODUCTIVE ZONE AND PROPOSED NEW PRODUCTIVE ZONE. GIVE BLOWOUT PREVENTER PROGRAM, IF ANY.

I hereby certify that the information above is true and complete to the best of my knowledge and belief.

Signed Bill M. Paul Title Operations Manager Date 11/08/93

(This space for State Use)

ORIGINAL SIGNED BY JERRY SEXTON
 DISTRICT 1 SUPERVISOR

APPROVED BY _____ TITLE _____ DATE NOV 14 1983

CONDITIONS OF APPROVAL, IF ANY:

NEW MEXICO OIL CONSERVATION COMMISSION
WELL LOCATION AND ACREAGE DEDICATION PLAT

Form C-102
Supersedes C-128
Effective 1-1-65

All distances must be from the outer boundaries of the Section.

Operator ENSTAR PETROLEUM, INC.		Lease SMITH		Well No. 1
Unit Letter "F"	Section 13	Township 14 - S	Range 37 - E	County LEA N.MEX.
Actual Footage Location of Well: <div> <div>1980</div> <div>feet from the NORTH</div> <div>line and</div> <div>1980</div> <div>feet from the WEST</div> <div>line</div> </div>				
Ground Level Elev. 3816	Producing Formation WOLFCAMP	Pool WILDCAT	Dedicated Acreage: 40 Acres	

1. Outline the acreage dedicated to the subject well by colored pencil or hachure marks on the plat below.
2. If more than one lease is dedicated to the well, outline each and identify the ownership thereof (both as to working interest and royalty).
3. If more than one lease of different ownership is dedicated to the well, have the interests of all owners been consolidated by communitization, unitization, force-pooling, etc?

☐ Yes ☐ No If answer is "yes," type of consolidation na

If answer is "no," list the owners and tract descriptions which have actually been consolidated. (Use reverse side of this form if necessary.) na

No allowable will be assigned to the well until all interests have been consolidated (by communitization, unitization, forced-pooling, or otherwise) or until a non-standard unit, eliminating such interests, has been approved by the Commission.

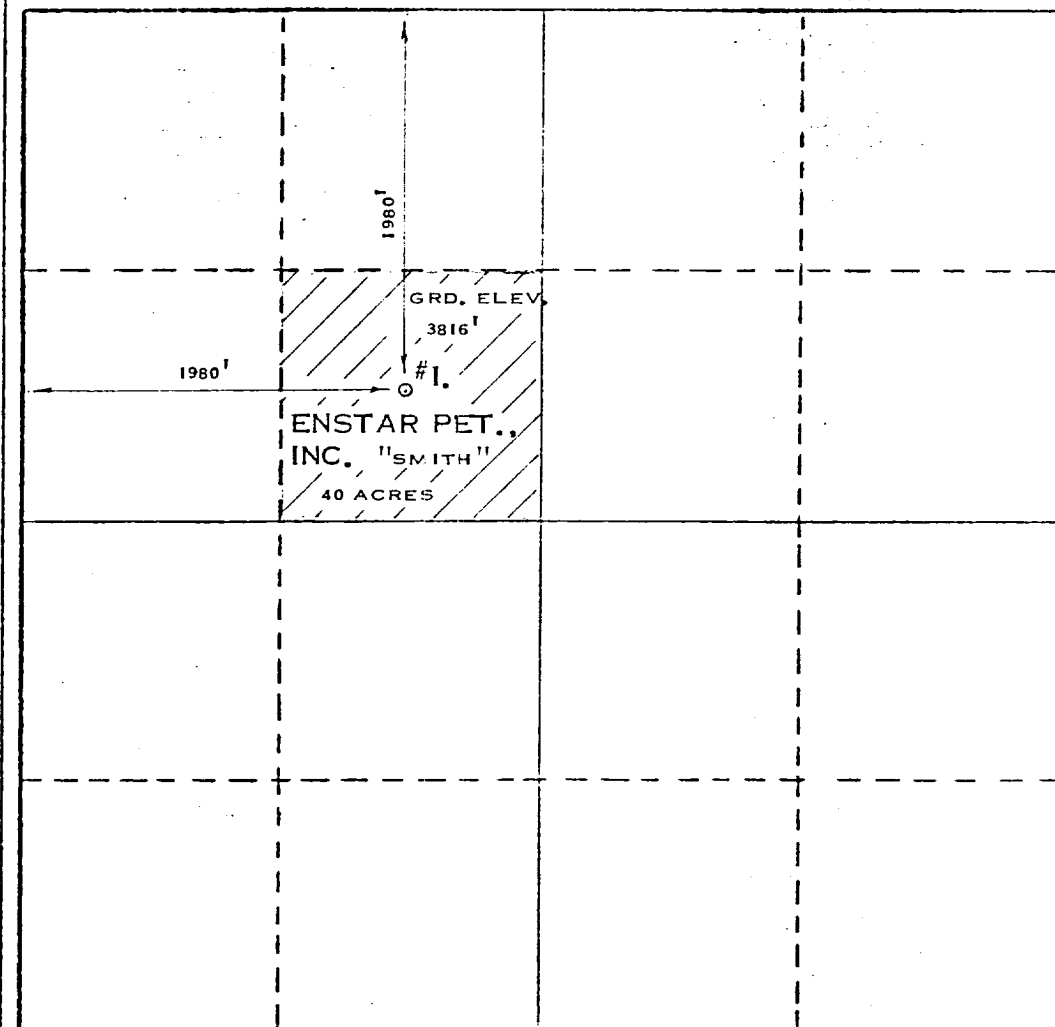

CERTIFICATION

I hereby certify that the information contained herein is true and complete to the best of my knowledge and belief.

Name
Bill M. Pringle
Position
Operations Manager
Company
ENSTAR Petroleum, Inc.
Date
November 8, 1983

I hereby certify that the well location shown on this plat was plotted from field notes of actual surveys made by me or under my supervision, and that the same is true and correct to the best of my knowledge and belief.

Date Surveyed
NOVEMBER, 4, 1983
Registered Professional Engineer and/or Land Surveyor
Max A. Schumann, Jr.
MAX A. SCHUMANN, JR.

Certificate No.

1510