

NO. OF COPIES RECEIVED	
DISTRIBUTION	
SANTA FE	
FILE	
U.S.G.S.	
LAND OFFICE	
OPERATOR	

RECEIVED BY

NOV 14 1983

ARTESIA, OFFICE

PLUG BACK ☐

3A. Indicate Type of Lease

STATE ☒FEE ☐

5. State Oil & Gas Lease No.

LC-1623

7. Well Agreement Name

8. Farm or Lease Name

Raven "YH" State

9. Well No.

1

10. Field and Pool, or Wildcat

Tulsk Penn

11. County

Lea

19. Proposed Depth

appr. 10,200'

19A. Formation

Permo-Penn

19B. Method of C.T.

Rotary

17. Elevation (Show whether DT, RL, etc.)

4315.2' GL

21A. Kind & Status Plug. Bond

Blanket

21B. Drilling Contractor

Ard #6

22. Approx. Date Work will start

ASAP

PROPOSED CASING AND CEMENT PROGRAM

SIZE OF HOLE	SIZE OF CASING	WEIGHT PER FOOT	SETTING DEPTH	SACKS OF CEMENT	EST. TOP
17 1/2"	13 3/8"	48# J-55	450'	400 SX	circ
12 1/4"	8 5/8"	24# J-55	4200'	1300 SX	400'
7 7/8"	5 1/2"	17# N-80-L	TD	450 SX	9200'
		17# K-55-L			
		17# K-55-S			
		17# N-80-L			

We propose to drill a 10,200' well and test the Permo-Penn and intermediate formations. Approximately 450' of surface casing will be set and cement circulated and approximately 4200' of intermediate casing will be set and cement circulated back to about 400'. Production casing will be set to TD and cemented back to approximately 9200'.

MUD PROGRAM: FW gel to 450', Native mud 4200', water/paper to 7500', starch/driskak/KCL to TD.

BOP PROGRAM: BOP's will be installed at the offset and tested daily.

2. ABOVE SPACE DESCRIBE PROPOSED PROGRAM; IF PROPOSAL IS TO DEEPEN OR PLUG BACK, GIVE DATA ON PRESENT PRODUCTIVE ZONE AND PROPOSED NEW PRODUCTIVE ZONE. GIVE BLOWOUT PREVENTER PROGRAM, IF ANY.

I hereby certify that the information above is true and complete to the best of my knowledge and belief.

Signed Jerry Sexton Title Regulatory Agent Date 10/31/83

(This space for State Use)
ORIGINAL SIGNED BY JERRY SEXTON
DISTRICT I SUPERVISOR

APPROVED BY _____ TITLE _____ DATE NOV 16 1983

CONDITIONS OF APPROVAL, IF ANY:

APPROVAL VALID FOR 180 DAYS
PERMIT EXPIRES 5-16-84
UNLESS DRILLING UNDERWAY

**NEW MEXICO OIL CONSERVATION COMMISSION
WELL LOCATION AND ACREAGE DEDICATION PLAT**

Form C-102
Supersedes C-128
Effective 1-1-65

All distances must be from the outer boundaries of the Section.

Operator YATES PETROLEUM CORPORATION			Lease RAVEN "YH" STATE		Well No. 1
Unit Letter	Section 33	Township 14	Range 32	County Lea	
Actual Footage Location of Well:					
560 feet from the South line and		560 feet from the East line			
Ground Level Elev. 4315.2' GL	Producing Formation Permo-Penn		Pool Tulk Penn		Dedicated Acreage: 40 160 Acres

1. Outline the acreage dedicated to the subject well by colored pencil or hatchure marks on the plat below.
2. If more than one lease is dedicated to the well, outline each and identify the ownership thereof (both as to working interest and royalty).
3. If more than one lease of different ownership is dedicated to the well, have the interests of all owners been consolidated by communitization, unitization, force-pooling, etc?

☐ Yes ☐ No If answer is "yes," type of consolidation _____

If answer is "no," list the owners and tract descriptions which have actually been consolidated. (Use reverse side of this form if necessary.) _____

No allowable will be assigned to the well until all interests have been consolidated (by communitization, unitization, forced-pooling, or otherwise) or until a non-standard unit, eliminating such interests, has been approved by the Commission.

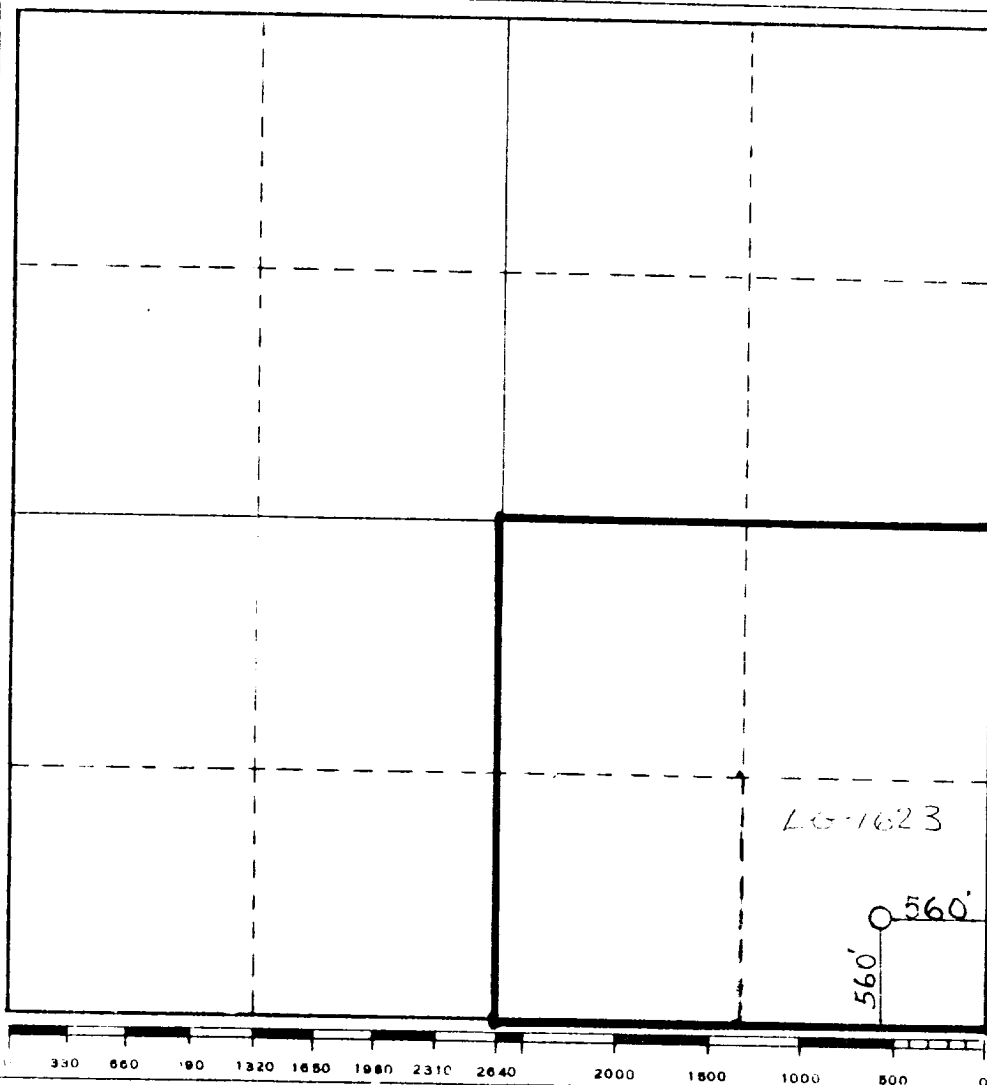

CERTIFICATION

I hereby certify that the information contained herein is true and complete to the best of my knowledge and belief.

[Signature]
Name

Gliserio Rodriguez
Position

Regulatory Agent
Company

Yates Petroleum Corp.
Date

11/9/83

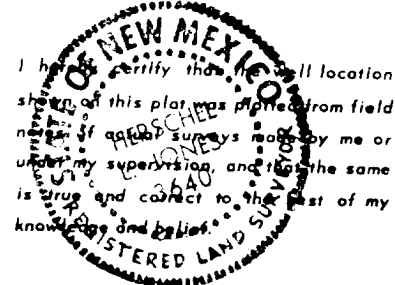

Date Surveyed

11/7/83

Registered Professional Engineer
and/or Land Surveyor

Certificate No.

3640

rotating head if necessary
2" Fill up Line

ROTATING
BOP
2000 psi

Flowline

ANNULAR BOP

(Hydrill)

900

PIPE RAMS

900

Shaffer 10" Series 900

Hydraulically Operated B.O.P.'s

BLIND
RAMS

900

Check Valve

Steel
Valve

2" Inch Kill
Line

4" Inch Line

Choke
Manifold

Choke
Manifold

900

Casinghead or Bradenhead

THE FOLLOWING CONSTITUTE MINIMUM BLOWOUT PREVENTER REQUIREMENTS

1. All preventers to be hydraulically operated with secondary manual controls installed prior to drilling out from under casing.
2. Choke outlet to be a minimum of 4" diameter.
3. Kill line to be of all steel construction of 2" minimum diameter.
4. All connections from operating manifolds to preventers to be all steel. hole or tube a minimum of one inch in diameter.
5. The available closing pressure shall be at least 15% in excess of that required with sufficient volume to operate the B.O.P.'s.
6. All connections to and from preventer to have a pressure rating equivalent to that of the B.O.P.'s.
7. Inside blowout preventer to be available on rig floor.
8. Operating controls located a safe distance from the rig floor.
9. Hole must be kept filled on trips below intermediate casing.
10. D. P. float must be installed and used below zone of first gas intrusion.

RECEIVED

NOV 15 1983

G.C.D.
HOBBS OFFICE

11/15/83
H