

30-025-28553

NO. OF COPIES RECEIVED	
DISTRIBUTION	
SANTA FE	
FILE	
S.G.S.	
LAND OFFICE	
OPERATOR	

NEW MEXICO OIL CONSERVATION COMMISSION

Form C-101
Revised 1-1-65

5A. Indicate Type of Lease	
STATE <input checked="" type="checkbox"/>	FEE <input type="checkbox"/>
5. State Oil & Gas Lease No.	
LG1469	

APPLICATION FOR PERMIT TO DRILL, DEEPEN, OR PLUG BACK

1a. Type of Work		7. Unit Agreement Name	
b. Type of Well DRILL <input type="checkbox"/> DEEPEN <input type="checkbox"/> PLUG BACK <input type="checkbox"/> OIL WELL <input checked="" type="checkbox"/> GAS WELL <input type="checkbox"/> OTHER <input type="checkbox"/> SINGLE ZONE <input checked="" type="checkbox"/> MULTIPLE ZONE <input type="checkbox"/>		8. Farm or Lease Name	
2. Name of Operator		Le Gulf State	
3. Address of Operator		9. Well No.	
P. O. Box 1933, Roswell, New Mexico 88201		1	
4. Location of Well		10. Field, Pool, or Wildcat	
UNIT LETTER <u>L</u> LOCATED <u>1980</u> FEET FROM THE <u>South</u> LINE		Und. <u>Perm</u> Upper Penn	
AND <u>660</u> FEET FROM THE <u>West</u> LINE OF SEC. <u>18</u> TWP. <u>14</u> RGE. <u>33E</u> NMPM		12. County	
		Lea	
		19. Proposed Depth	
		10200'	
		19A. Formation	
		Penn	
		20. Rotary or C.T.	
		C.T.	
21. Elevations (Show whether DF, RT, etc.)		21B. Drilling Contractor	
4267' GR		Cortez	
21A. Kind & Status Plug. Bond		22. Approx. Date Work will start	
\$50,000 Blanket		As soon as possible	

PROPOSED CASING AND CEMENT PROGRAM

SIZE OF HOLE	SIZE OF CASING	WEIGHT PER FOOT	SETTING DEPTH	SACKS OF CEMENT	EST. TOP
17 1/2"	13 3/8"	48#	365'		Circ
11"	8 5/8"	24#, 28#	4000'		Circ
7 7/8"	5 1/2"	17#, 20#	10150'		Suff to cover 600' above pay-zone

Cable tool used until surface casing is set. Continue drilling using rotary (Moranco).

APPROVAL VALID FOR 180 DAYS
PERMIT EXPIRES 7/4/84
UNLESS DRILLING UNDERWAY

IN ABOVE SPACE DESCRIBE PROPOSED PROGRAM: IF PROPOSAL IS TO DEEPEN OR PLUG BACK, GIVE DATA ON PRESENT PRODUCTIVE ZONE AND PROPOSED NEW PRODUCTIVE ZONE. GIVE BLOWOUT PREVENTER PROGRAM, IF ANY.

I hereby certify that the information above is true and complete to the best of my knowledge and belief.

Signed Jerry L. Sexton Title Reservoir Engineer Date December 30, 1983

(This space for Title Use)
ORIGINAL SIGNED BY JERRY SEXTON
DISTRICT 1 SUPERVISOR

APPROVED BY _____ TITLE _____ DATE JAN 3 1984

CONDITIONS OF APPROVAL, IF ANY:

RECEIVED
JAN 8 1984
D.C.O.
MILITARY SERVICE

NEW MEXICO OIL CONSERVATION COMMISSION
WELL LOCATION AND ACREAGE DEDICATION PLAT

Form O-12
Supersedes O-12a
Effective 1/1/83

All distances must be from the water boundaries of the Section

Operator Harvey E. Yates Company		Lease Le Gulf State		Acres 1
Unit Letter L	Section 18	Township 14S	Range 33E	County Lea
Actual Plotting Location of Well				
1980	feet from the South	660	feet from the West	
Ground Level Elevation 4267.0	Formulating Formation Penn	Unit Und. Baum Upper Penn	Section 160	

1. Outline the acreage dedicated to the subject well by colored pencil or hatchure marks on the plat below
2. If more than one lease is dedicated to the well, outline each and identify the ownership thereof (both as to working interest and royalty)
3. If more than one lease of different ownership is dedicated to the well, have the interests of all owners been consolidated by communitization, unitization, force-pooling, etc?

☐ Yes ☐ No If answer is "yes," type of consolidation N/A

If answer is "no," list the owners and tract descriptions which have actually been consolidated (Use reverse side of this form if necessary.)

No allowable will be assigned to the well until all interests have been consolidated (by communitization, unitization, forced-pooling, or otherwise) or until a non-standard unit, eliminating such interests, has been approved by the Commission.

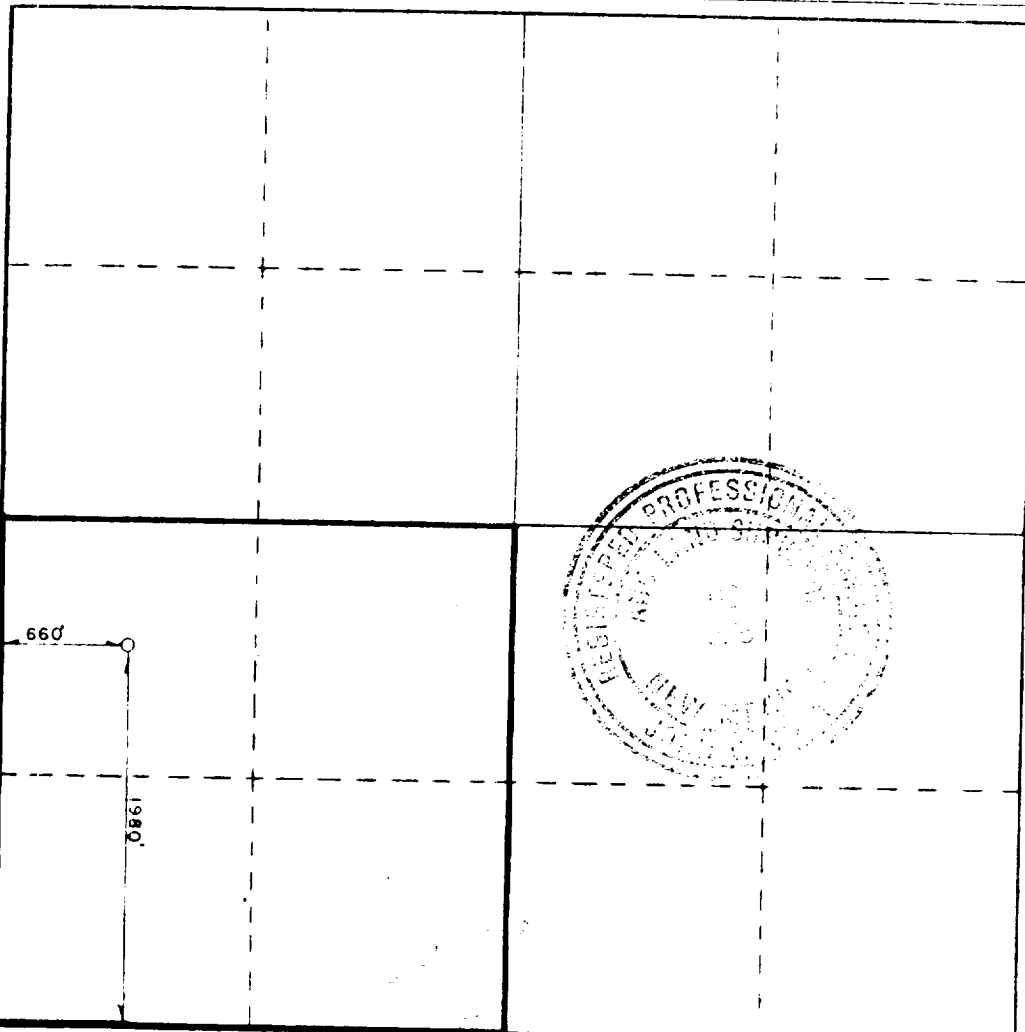

CERTIFICATION

I hereby certify that the information contained herein is true and complete to the best of my knowledge and belief.

Janet L. Dietzler

Janet L. Dietzler

Reservoir Engineer

Harvey E. Yates Company

December 30, 1983

I hereby certify that the well location shown on this plat was plotted from field notes of actual surveys made by me or under my supervision, and that the same is true and correct to the best of my knowledge and belief.

Date Surveyed

12/27/83

Registered Professional Engineer
1 1 1 1 Surveyor

John W. Witt

Certificate No. 00000000000000000000

DRAWWORKS

Brewster N-75

Drum: 1¼" Lebus grooved

Compound: 2-engine oil bath chain drive

Brake: Hydromatic Parkersburg 40"

ENGINES

Two 610-H.P. D379TA Caterpillar Diesel.

DERRICK

Lee C. Moore, 131', 550,000 lb. nominal capacity.

SUBSTRUCTURE

Lee C. Moore, 14½' high, 550,000 lb. nominal capacity.

MUD PUMPS

Pump No. 1: Emsco DB700. 700 H.P. with steel fluid end. 4¾" - 7¾" liners, 16" stroke. Compound-driven.

Pump No. 2: NAT C-250, 350 H.P. Powered by D353 Caterpillar Diesel.

DRILL STRING

3000' 4½" Grade E, 20 lb.

Tool Joints: 4½" H-90, 6½" OD,

11000' 4½" Grade E, 16.60 lb.

Tool Joints: 4" H-90, 6" OD

Thirty Drilco spiral-grooved 6½" OD, 2¼" ID. With 4" H-90 Joints.

Other sized drillpipe & drillcollars available.

BLOWOUT PREVENTERS

One Shaffer LWS hydraulic double 10" x 1500 series. One Hydril 10" x 1500 series.

Choke manifold 4" x 1500 series flanged connections. Payne 4 valve accumulator closing unit.

MUD SYSTEM

3 - 30 x 7½ x 6 steel pits, with 700 Bbl. capacity. Complete low pressure circulating system, consisting of four submerged mud guns and two counter sunk jets in each pit. System utilizes a 6 x 8 centrifugal pump, powered by diesel.

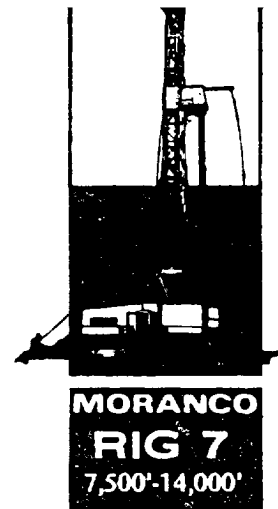

MUD HOUSE

One - 8' x 30' Steel Storage House

COMMUNICATIONS

24-Hour direct telephone interconnection through Hobbs (A.C. 505-397-3291) or Midland - Odessa (A.C. 915-563-0562).

OTHER EQUIPMENT

BLOCKS - Oilwell 350 Ton

HOOK - BJ4300 350 Ton

SWIVEL - NAT N69 350 Ton

LIGHT PLANTS - One 40 KW and one 20 KW AC generators, powered by diesel engines.

LIGHTS - AC fluorescent or mercury - All vapor proof.

SHALE SHAKER - Link belt, single screen.

FRESH WATER STORAGE - two 500 Bbl., horizontal tanks.

HOUSING - 1 - 8' x 36' airconditioned trailer house, with sleeping and cooking facilities.

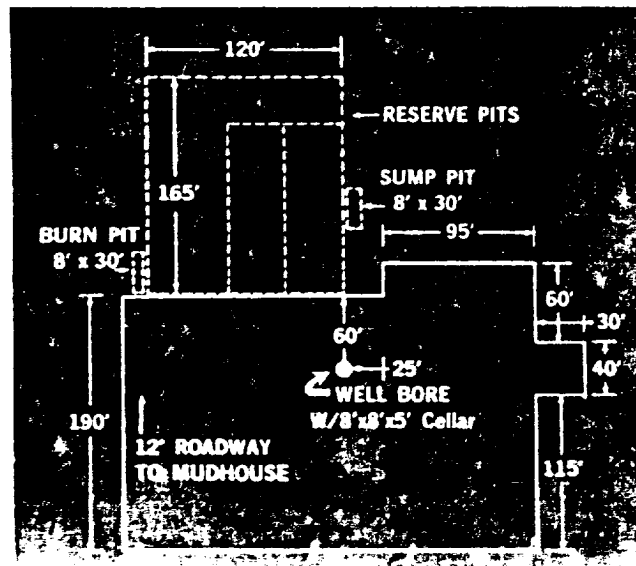
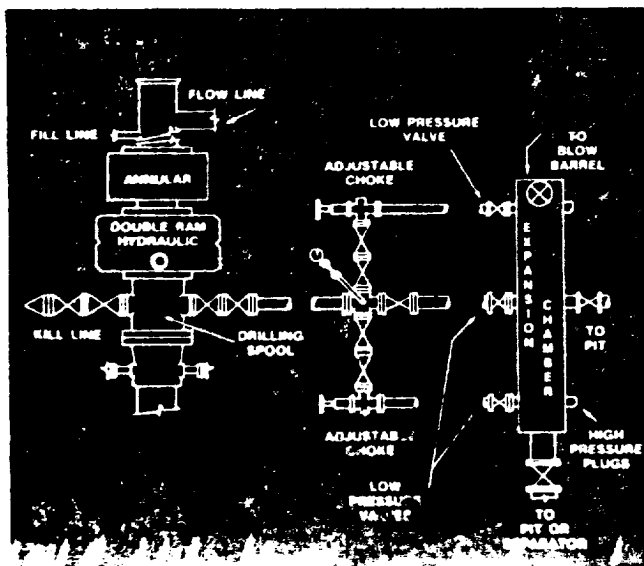

RECEIVED

JAN 3 1984

O.C.D.
HOBBS OFFICE

**NEW MEXICO OIL CONSERVATION COMMISSION
WELL LOCATION AND ACREAGE DEDICATION PLAT**

Form C-102
Supersedes C-128
Effective 1-4-85

All distances must be from the outer boundaries of the Section

Operator Harvey E. Yates Company			Lease Le Gulf State		Well No. 1
Unit Letter L	Section 18	Township 14S	Range 33E	County Lea	
Actual Footage Location of Well:					
1980	feet from the South	line and	660	feet from the West	line
Ground Level Elev.	Producing Formation Penn	Pool	<i>Baum Upper Penn</i> UNDESIGNATED		Estimated Acreage 160

1. Outline the acreage dedicated to the subject well by colored pencil or hachure marks on the plat below.
2. If more than one lease is dedicated to the well, outline each and identify the ownership thereof (both as to working interest and royalty).
3. If more than one lease of different ownership is dedicated to the well, have the interests of all owners been consolidated by communitization, unitization, force-pooling, etc?

☐ Yes ☐ No If answer is "yes," type of consolidation N/A

If answer is "no," list the owners and tract descriptions which have actually been consolidated (Use reverse side of this form if necessary.) _____

No allowable will be assigned to the well until all interests have been consolidated (by communitization, unitization, forced-pooling, or otherwise) or until a non-standard unit, eliminating such interests, has been approved by the Commission.

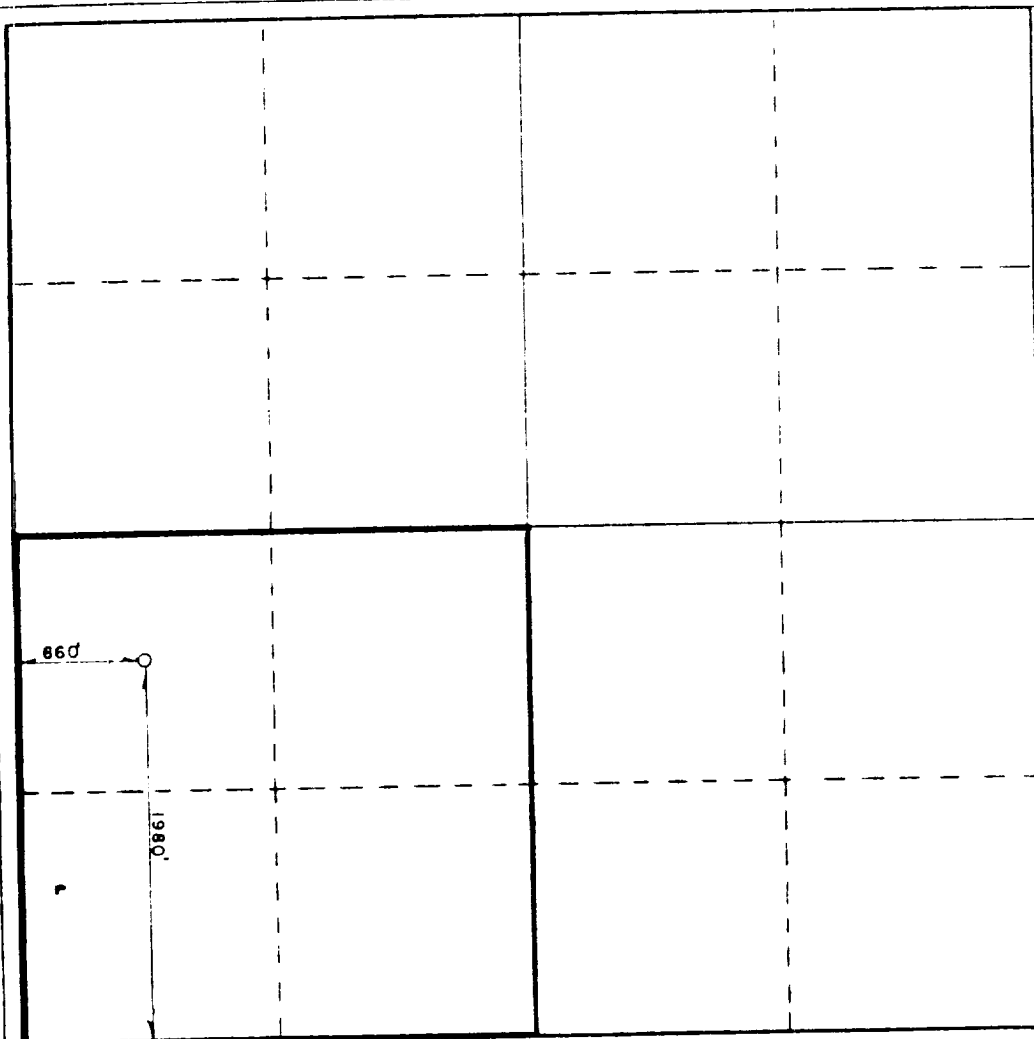

CERTIFICATION

I hereby certify that the information contained herein is true and complete to the best of my knowledge and belief.

Janet L. Dietzler

Janet L. Dietzler

Reservoir Engineer

Harvey E. Yates Company

December 27, 1983

I hereby certify that the well location shown on this plat was plotted from field notes of actual surveys made by me or under my supervision, and that the same is true and correct to the best of my knowledge and belief.

Date Surveyed

12/27/83

Registered Professional Engineer
and/or Land Surveyor

John W. West

Certificate No. **JOHN W. WEST.**

676

RONALD J. ERDSOHN,

323

0 100 200 300 400 500 600 700 800 900 1000 1100 1200 1300 1400 1500 1600 1700 1800 1900 2000

RECEIVED
DEC 30 1983
O.C.D.
HOBBS OFFICE

13