

30-025-28614

NO. OF COPIES RECEIVED	
DISTRIBUTION	
SANTA FE	
FILE	
U.S.G.S.	
LAND OFFICE	
OPERATOR	

NEW MEXICO OIL CONSERVATION COMMISSION

Form C-101
Revised 1-1-65

5A. Indicate Type of Lease
STATE <input checked="" type="checkbox"/> FEE <input type="checkbox"/>
5. State Oil & Gas Lease No.
K-3846

APPLICATION FOR PERMIT TO DRILL, DEEPEN, OR PLUG BACK

1a. Type of Work		7. Unit Agreement Name	
b. Type of Well DRILL <input checked="" type="checkbox"/> DEEPEN <input type="checkbox"/> PLUG BACK <input type="checkbox"/>		8. Farm or Lease Name	
OIL WELL <input checked="" type="checkbox"/> GAS WELL <input type="checkbox"/> OTHER <input type="checkbox"/> SINGLE ZONE <input checked="" type="checkbox"/> MULTIPLE ZONE <input type="checkbox"/>		New Mexico 'U' State	
2. Name of Operator		9. Well No.	
Cabot Petroleum Corporation		2	
3. Address of Operator		10. Field and Pool, or Wildcat	
P. O. Box 5001, Pampa, Texas 79065		Baum Upper Penn	
4. Location of Well		12. County	
UNIT LETTER <u>B</u> LOCATED <u>660</u> FEET FROM THE <u>North</u> LINE		Lea	
AND <u>1980</u> FEET FROM THE <u>East</u> LINE OF SEC. <u>4</u> TWP. <u>14S</u> RGE. <u>33E</u> NMPM			
19. Proposed Depth		19A. Formation	20. Rotary or C.T.
10,300'		Permo-Penn	Rotary
21. Elevations (Show whether DF, RT, etc.)	21A. Kind & Status Plug. Bond	21B. Drilling Contractor	22. Approx. Date Work will start
4237' GR	\$50,000 Blanket in force #749971	Unknown yet	Upon Approval

23. PROPOSED CASING AND CEMENT PROGRAM					
17 1/2"	13 3/8"	48#	400'	450 sxs	Surface
SIZE OF HOLE	SIZE OF CASING	WEIGHT PER FOOT	SETTING DEPTH	SACKS OF CEMENT	EST. TOP
12 1/4"	8 5/8"	28#	4100'	1925	Surface
7 7/8"	5 1/2"	17# & 20#	10,300'	555	3000'

Blowout Preventer Program: Cameron double hydraulic Type SS, 10" 3000# and Hydril Type GK, 12" 3000# with Koomey-Weise 80 gallon accumulator, 3000# 3 station with Hydrill control valve.

The above or type equivalent.

APPROVAL VALID FOR 180 DAYS
PERMIT EXPIRES 8/20/84
UNLESS DRILLING UNDERWAY

IN ABOVE SPACE DESCRIBE PROPOSED PROGRAM: IF PROPOSAL IS TO DEEPEN OR PLUG BACK, GIVE DATA ON PRESENT PRODUCTIVE ZONE AND PROPOSED NEW PRODUCTIVE ZONE. GIVE BLOWOUT PREVENTER PROGRAM, IF ANY.

I hereby certify that the information above is true and complete to the best of my knowledge and belief.

Signed [Signature] Title Agent Date 2/10/84

(This space for State Use)

ORIGINAL SIGNED BY JERRY SEXTON
DISTRICT I SUPERVISOR

APPROVED BY _____ TITLE _____ DATE FEB 20 1984

CONDITIONS OF APPROVAL, IF ANY:

RECEIVED

FEB 20 1984

O.C.D.
HOBBS OFFICE

RECEIVED

FEB 13 1984

O.C.D.
HOBBS OFFICE

NEW MEXICO OIL CONSERVATION COMMISSION
WELL LOCATION AND ACREAGE DEDICATION PLAT

Form C-102
Supersedes C-128
Effective 1-1-65

All distances must be from the outer boundaries of the Section.

Operator CABOT PETROLEUM CORPORATION		Lease New Mexico State "U" <i>State</i>		Well No. 2
Unit Letter <i>B</i>	Section 4	Township T-14-S	Range R-33-E	County Lea County, New Mexico
Actual Footage Location of Well: 660 feet from the North line and 1980 feet from the East line				
Ground Level Elev. 4237'	Producing Formation Permo-Penn	Pool Baum Upper Penn	Dedicated Acreage: 160 Acres	

1. Outline the acreage dedicated to the subject well by colored pencil or hachure marks on the plat below.
2. If more than one lease is dedicated to the well, outline each and identify the ownership thereof (both as to working interest and royalty).
3. If more than one lease of different ownership is dedicated to the well, have the interests of all owners been consolidated by communitization, unitization, force-pooling, etc?

☐ Yes ☐ No If answer is "yes," type of consolidation _____

If answer is "no," list the owners and tract descriptions which have actually been consolidated. (Use reverse side of this form if necessary.) _____

No allowable will be assigned to the well until all interests have been consolidated (by communitization, unitization, forced-pooling, or otherwise) or until a non-standard unit, eliminating such interests, has been approved by the Commission.

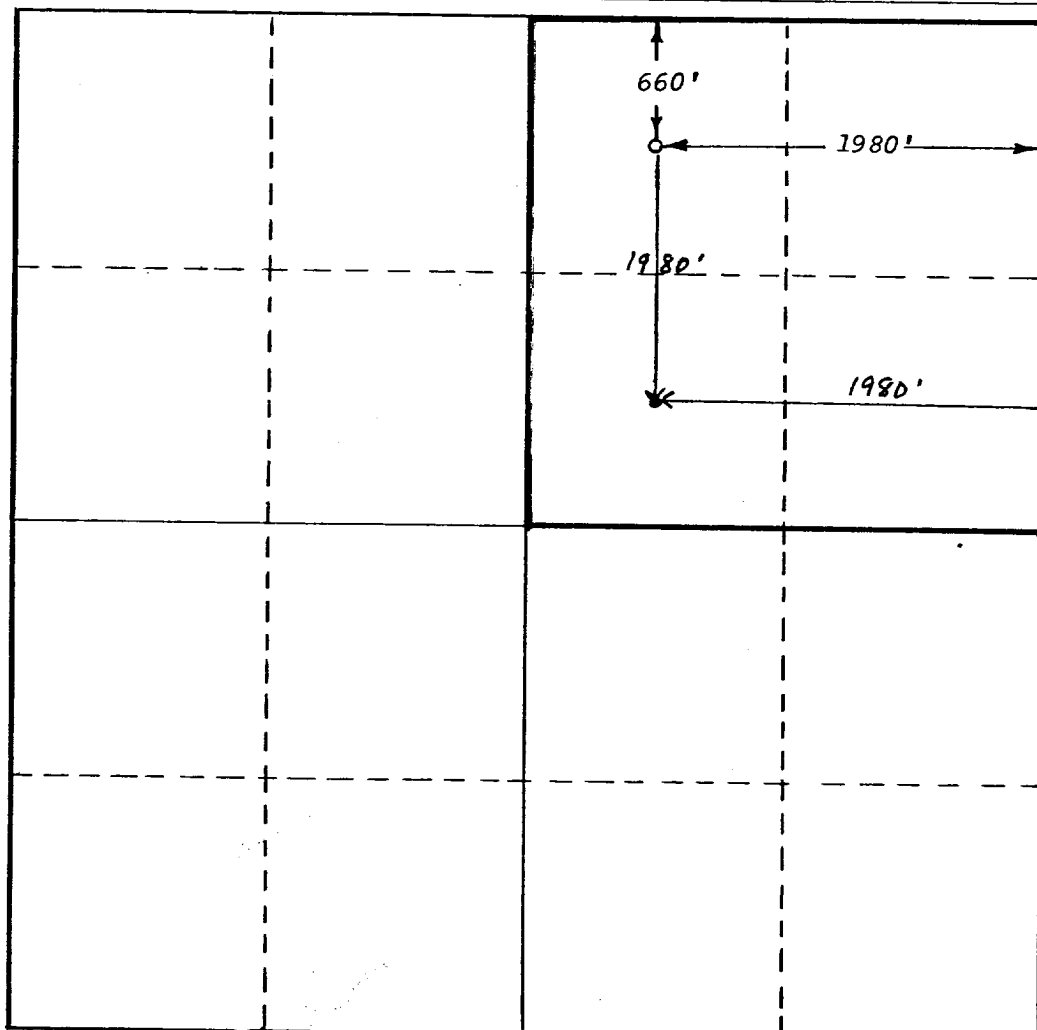

CERTIFICATION

I hereby certify that the information contained herein is true and complete to the best of my knowledge and belief.

Paul Andrew

Name
Paul Andrew

Position
Agent

Company
Cabot Petroleum Corp.

Date
2/10/84

I hereby certify that the well location shown on this plat was plotted from field notes of actual surveys made by me or under my supervision, and that the same is true and correct to the best of my knowledge and belief.

Date Surveyed
Feb. 7, 1984

Registered Professional Engineer and/or Land Surveyor

Gary D. Boswell
Certificate No.

6689

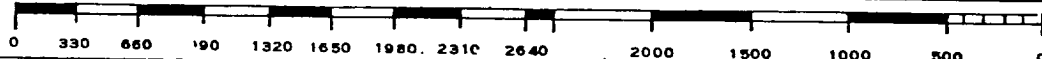

RECEIVED
FEB 13 1984
G. C. D.
HOBBS OFFICE

173