

NO. OF COPIES RECEIVED	
DISTRIBUTION	
SANTA FE	
FILE	
U.S.G.S.	
LAND OFFICE	
OPERATOR	

5A. Indicate Type of Lease STATE <input type="checkbox"/> FEE <input type="checkbox"/>
5. State Oil & Gas Lease No.
7. Unit Agreement Name N/A
8. Farm or Lease Name D. P. Peck Estate
9. Well No. 1
10. Field and Pool, or Wildcat Gladiola, S.W.
12. County Lea

APPLICATION FOR PERMIT TO DRILL, DEEPEN, OR PLUG BACK

1a. Type of Work DRILL <input checked="" type="checkbox"/> DEEPEN <input type="checkbox"/> PLUG BACK <input type="checkbox"/>
b. Type of Well OIL WELL <input checked="" type="checkbox"/> GAS WELL <input type="checkbox"/> OTHER <input type="checkbox"/> SINGLE ZONE <input checked="" type="checkbox"/> MULTIPLE ZONE <input type="checkbox"/>
2. Name of Operator Walter Oil & Gas Corporation
3. Address of Operator 240 Main Bldg., 1212 Main Street, Houston, Texas 77002
4. Location of Well UNIT LETTER F LOCATED 1890 FEET FROM THE North LINE AND 2105 FEET FROM THE West LINE OF SEC. 26 TWP. 12 S RGE. 37 E NMPM

19. Proposed Depth 12,500'	19A. Formation Devonian	20. Rotary or C.T. Rotary
21. Elevations (show whether DF, RT, etc.) 3882.5	21A. Kind & Status Plug. Bond One-Well on File	21B. Drilling Contractor Exeter Drilling Company
		22. Approx. Date Work will start 8/29/84

23.

PROPOSED CASING AND CEMENT PROGRAM

SIZE OF HOLE	SIZE OF CASING	WEIGHT PER FOOT	SETTING DEPTH	SACKS OF CEMENT	EST. TOP
17-1/2"	13-3/8"	54# J-55	400'	425	circ. to surface
12-1/4"	9-5/8"	40# J-55	4500'	1250	circ. to surface
7-7/8"	5-1/2"	17# N-80	12,500'	915	7000'

Proposed Program: Drill development well to proposed depth of $\pm 12,500'$

B.O.P. Program - Shaeffer Double Rim; hydraulic - 900 series - 3000# working pressure

APPROVAL VALID FOR 180 DAYS
PERMIT EXPIRES 2/28/85
UNLESS DRILLING UNDERWAY

IN ABOVE SPACE DESCRIBE PROPOSED PROGRAM; IF PROPOSAL IS TO DEEPEN OR PLUG BACK, GIVE DATA ON PRESENT PRODUCTIVE ZONE AND PROPOSED NEW PRODUCTIVE ZONE. GIVE BLOWOUT PREVENTER PROGRAM, IF ANY.

I hereby certify that the information above is true and complete to the best of my knowledge and belief.

Signed S. Kim Burkett Title Engineering Assistant Date 8/24/84
S. Kim Burkett
(This space for State Use)

Eddie W. Seay

APPROVED BY Gil & Co. Inspector TITLE DATE AUG 28 1984
CONDITIONS OF APPROVAL, IF ANY:

**NEW MEXICO OIL CONSERVATION COMMISSION
WELL LOCATION AND ACREAGE DEDICATION PLAT**

Form C-102
Supersedes C-128
Effective 1-1-65

All distances must be from the outer boundaries of the Section.

Operator Walter Oil and Gas Corporation			Lease Peck		Well No. 1
Unit Letter F	Section 26	Township 12 South	Range 37 East	County Lea County	
Actual Footage Location of Well: 1890 feet from the North line and 2105 feet from the West line					
Ground Level Elev. 3882.5	Producing Formation Devonian		Pool Gladiola, S.W.	Dedicated Acreage: 80 Acres	

1. Outline the acreage dedicated to the subject well by colored pencil or hatchure marks on the plat below.
2. If more than one lease is dedicated to the well, outline each and identify the ownership thereof (both as to working interest and royalty).
3. If more than one lease of different ownership is dedicated to the well, have the interests of all owners been consolidated by communitization, unitization, force-pooling, etc?

☐ Yes ☐ No If answer is "yes," type of consolidation _____

If answer is "no," list the owners and tract descriptions which have actually been consolidated. (Use reverse side of this form if necessary.) _____

No allowable will be assigned to the well until all interests have been consolidated (by communitization, unitization, forced-pooling, or otherwise) or until a non-standard unit, eliminating such interests, has been approved by the Commission.

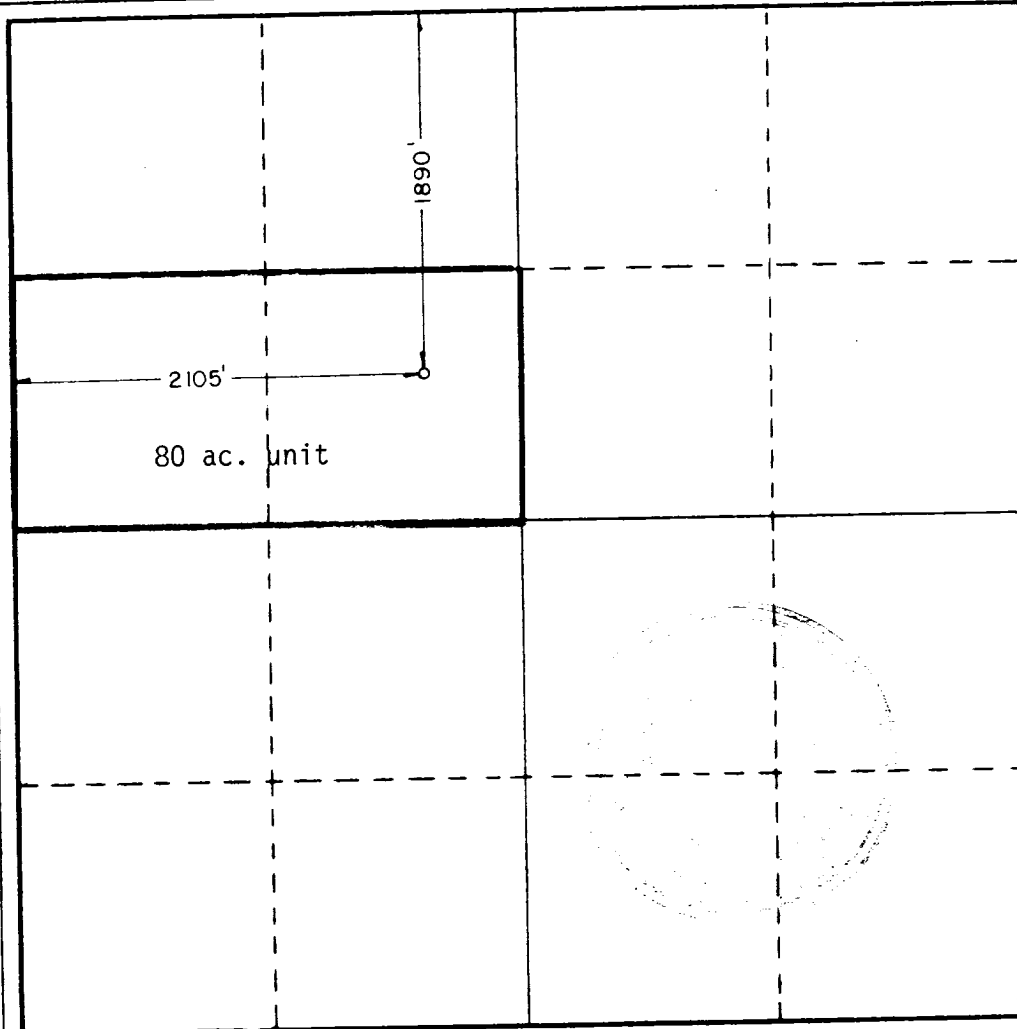

CERTIFICATION

I hereby certify that the information contained herein is true and complete to the best of my knowledge and belief.

S. Kim Burkett

Name

S. Kim Burkett

Position

Engineering Assistant

Company

Walter Oil & Gas Corporation

Date

August 24, 1984

I hereby certify that the well location shown on this plat was plotted from field notes of actual surveys made by me or under my supervision, and that the same is true and correct to the best of my knowledge and belief.

Date Surveyed

August 22, 1984

Registered Professional Engineer
and/or Land Surveyor

John W. West

Certificate No. JOHN W. WEST, 676

RONALD J. EIDSON, 3239

0 330 660 990 1320 1650 1980 2310 2640 2970 3300 3630 3960 4290 4620 4950 5280 5610 5940 6270 6600 6930 7260 7590 7920 8250 8580 8910 9240 9570 9900