

NO. OF COPIES RECEIVED	
DISTRIBUTION	
SANTA FE	
FILE	
U.S.G.S.	
LAND OFFICE	
OPERATOR	

30-025-28913

5a. Indicate Type of Lease	
State <input checked="" type="checkbox"/>	Fee <input type="checkbox"/>
5. State Oil & Gas Lease No.	
B-9505	

SUNDRY NOTICES AND REPORTS ON WELLS

(DO NOT USE THIS FORM FOR PROPOSALS TO DRILL OR TO DEEPEN OR PLUG BACK TO A DIFFERENT RESERVOIR. USE "APPLICATION FOR PERMIT -" (FORM C-101) FOR SUCH PROPOSALS.)

1. <input checked="" type="checkbox"/> OIL WELL <input type="checkbox"/> GAS WELL <input type="checkbox"/> OTHER-	7. Unit Agreement Name
2. Name of Operator	8. Farm or Lease Name
TEXACO, Inc.	New Mexico 'AT' State
3. Address of Operator	9. Well No.
P. O. Box 728, Hobbs, New Mexico 88240	15
4. Location of Well	10. Field and Pool, or Wildcat
UNIT LETTER <u>C</u> <u>660</u> FEET FROM THE <u>North</u> LINE AND <u>1980</u> FEET FROM	Saunders Permo
THE <u>West</u> LINE, SECTION <u>15</u> TOWNSHIP <u>14-S</u> RANGE <u>33-E</u> NMPM.	Upper Penn
15. Elevation (Show whether DF, RT, GR, etc.)	12. County
4208' (GR)	Lea

16. Check Appropriate Box To Indicate Nature of Notice, Report or Other Data
NOTICE OF INTENTION TO: SUBSEQUENT REPORT OF:

PERFORM REMEDIAL WORK <input type="checkbox"/>	PLUG AND ABANDON <input type="checkbox"/>	REMEDIAL WORK <input type="checkbox"/>	ALTERING CASING <input type="checkbox"/>
TEMPORARILY ABANDON <input type="checkbox"/>	CHANGE PLANS <input type="checkbox"/>	COMMENCE DRILLING OPS. <input type="checkbox"/>	PLUG AND ABANDONMENT <input type="checkbox"/>
PULL OR ALTER CASING <input type="checkbox"/>	OTHER <input type="checkbox"/>	CASING TEST AND CEMENT JOB <input checked="" type="checkbox"/>	

17. Describe Proposed or Completed Operations (Clearly state all pertinent details, and give pertinent dates, including estimated date of starting any proposed work) SEE RULE 1703.

TOTAL DEPTH 10,100'
13 3/8" OD 54.5# J-55 CSG SET @ 525'
8 5/8" OD 32# J-55 CSG SET @ 4200'

- 1. RAN 10,085' (245 JTS) 5 1/2" OD 17# N-80 CSG AND SET @ 10,100'.
- 2. CEMENTED 1ST STAGE W/750 SX LW CEMENT CONTAINING 1/4# FLOCELE PER SACK FOLLOWED BY 200 SX 50-50 POZMIX-CLASS H CEMENT CONTAINING .8% HALAD-9, AND 1/4# FLOCELE PER SACK.
- 3. WITH DV TOOL OPEN @ 7003' CEMENTED 2ND STAGE W/1200 SX HLW CEMENT CONTAINING 1/4# FLOCELE PER SACK. CEMENT CIRCULATED. JOB COMPLETE 11:15 AM, 10-19-84. WOC 18 HRS.
- 4. TESTED 5 1/2" CSG TO 1500# FOR 30 MINUTES, 7:00-7:30 AM, 10-26-84. TESTED OK. JOB COMPLETE 7:30 AM, 10-26-84.

18. I hereby certify that the information above is true and complete to the best of my knowledge and belief.

SIGNED WABaker II TITLE Asst. Dist. Mgr. DATE 10-31-84

ORIGINAL SIGNED BY JERRY SEXTON
APPROVED BY DISTRICT 1 SUPERVISOR TITLE DATE NOV - 5 1984

CONDITIONS OF APPROVAL, IF ANY:

CONSERVATION DIVISION

P. O. BOX 2088

SANTA FE, NEW MEXICO 87501

Form C-103
Revised 10-1-83

NO. OF COPIES RECEIVED	
DISTRIBUTION	
SANTA FE	
FILE	
U.S.G.S.	
LAND OFFICE	
OPERATOR	

5a. Indicate Type of Lease	
State <input checked="" type="checkbox"/>	Fee <input type="checkbox"/>
5. State Oil & Gas Lease No.	
B-9505	

30-025-28913

SUNDRY NOTICES AND REPORTS ON WELLS

(DO NOT USE THIS FORM FOR PROPOSALS TO DRILL OR TO DEEPEN OR PLUG BACK TO A DIFFERENT RESERVOIR. USE "APPLICATION FOR PERMIT -" (FORM C-101) FOR SUCH PROPOSALS.)

OIL WELL ☒ GAS WELL ☐ OTHER ☐

1. Name of Operator		7. Unit Agreement Name	
TEXACO, Inc.		-	
2. Address of Operator		8. Farm or Lease Name	
P. O. Box 728, Hobbs, New Mexico 88240		New Mexico 'AT' State	
3. Location of Well		9. Well No.	
UNIT LETTER <u>C</u> <u>660</u> FEET FROM THE <u>North</u> LINE AND <u>1980</u> FEET FROM THE <u>West</u> LINE, SECTION <u>15</u> TOWNSHIP <u>14-S</u> RANGE <u>33-E</u> NMPM.		10. Field and Pool, or Wildcat	
		Saunders Permo Upper Penn	
15. Elevation (Show whether DF, RT, GR, etc.)		12. County	
4208' (GR)		Lea	

Check Appropriate Box To Indicate Nature of Notice, Report or Other Data

NOTICE OF INTENTION TO:

SUBSEQUENT REPORT OF:

PERFORM REMEDIAL WORK <input type="checkbox"/>	PLUG AND ABANDON <input type="checkbox"/>	REMEDIAL WORK <input type="checkbox"/>	ALTERING CASING <input type="checkbox"/>
TEMPORARILY ABANDON <input type="checkbox"/>	CHANGE PLANS <input type="checkbox"/>	COMMENCE DRILLING OPNS. <input type="checkbox"/>	PLUG AND ABANDONMENT <input type="checkbox"/>
PULL OR ALTER CASING <input type="checkbox"/>	OTHER <input type="checkbox"/>	CASING TEST AND CEMENT JOB <input checked="" type="checkbox"/>	

7. Describe Proposed or Completed Operations (Clearly state all pertinent details, and give pertinent dates, including estimated date of starting any proposed work) SEE RULE 1103.

TOTAL DEPTH 4200'
13 3/8" OD 54.5# J-55 CSG SET @ 525'

1. RAN 4185' (94 JTS) 8 5/8" OD 32# J-55 CSG AND SET @ 4200'.
2. CEMENTED W/1800 SX HLW CEMENT CONTAINING 15# SALT, 1/4# FLOCELE PER SACK FOLLOWED W/200 SX CLASS H CEMENT CONTAINING 1/4# FLOCELE PER SACK. CEMENT CIRCULATED. JOB COMPLETE 8:00 P. M., 10-1-84. WOC 18 HRS.
3. TESTED 8 5/8" CSG TO 1000# FOR 30 MINUTES, 3:00-3:30 PM, 10-2-84. TESTED OK. JOB COMPLETE 3:30 PM, 10-2-84.

10. I hereby certify that the information above is true and complete to the best of my knowledge and belief.

SIGNED Jerry Sexton TITLE Asst. Dist. Mgr. DATE 10-4-84

ORIGINAL SIGNED BY JERRY SEXTON
DISTRICT 1 SUPERVISOR

APPROVED BY _____ TITLE _____ DATE OCT 11 1984

CONDITIONS OF APPROVAL, IF ANY:

O CONSERVATION DIVISION

P. O. BOX 2088

SANTA FE, NEW MEXICO 87501

Form C-103
Revised 10-1-7

NO. OF COPIES RECEIVED	
DISTRIBUTION	
SANTA FE	
FILE	
U.S.G.S.	
LAND OFFICE	
OPERATOR	

30-025-28913

5a. Indicate Type of Lease

State ☒Fee ☐

5. State Oil & Gas Lease No.

B-9505

SUNDRY NOTICES AND REPORTS ON WELLS

(DO NOT USE THIS FORM FOR PROPOSALS TO DRILL OR TO DEEPEN OR PLUG BACK TO A DIFFERENT RESERVOIR. USE "APPLICATION FOR PERMIT -" (FORM C-101) FOR SUCH PROPOSALS.)

OIL WELL <input checked="" type="checkbox"/>	GAS WELL <input type="checkbox"/>	OTHER <input type="checkbox"/>	7. Unit Agreement Name -
Name of Operator TEXACO, Inc.			8. Farm or Lease Name New Mexico 'AT' State
Address of Operator P. O. Box 728, Hobbs, New Mexico 88240			9. Well No. 15
Location of Well UNIT LETTER <u>C</u> <u>660</u> FEET FROM THE <u>North</u> LINE AND <u>1980</u> FEET FROM THE <u>West</u> LINE, SECTION <u>15</u> TOWNSHIP <u>14-S</u> RANGE <u>33-E</u> NMPM.			10. Field and Pool, or Wildcat Saunders Permo Upper Penn
15. Elevation (Show whether DF, RT, GR, etc.) 4208' (GR)			12. County Lea

5. Check Appropriate Box To Indicate Nature of Notice, Report or Other Data			
NOTICE OF INTENTION TO:		SUBSEQUENT REPORT OF:	
PERFORM REMEDIAL WORK <input type="checkbox"/>	PLUG AND ABANDON <input type="checkbox"/>	REMEDIAL WORK <input type="checkbox"/>	ALTERING CASING <input type="checkbox"/>
TEMPORARILY ABANDON <input type="checkbox"/>	CHANGE PLANS <input type="checkbox"/>	COMMENCE DRILLING OPNS. <input checked="" type="checkbox"/>	PLUG AND ABANDONMENT <input type="checkbox"/>
FULL OR ALTER CASING <input type="checkbox"/>	OTHER <input type="checkbox"/>	CASING TEST AND CEMENT JOB <input checked="" type="checkbox"/>	OTHER <input type="checkbox"/>

7. Describe Proposed or Completed Operations (Clearly state all pertinent details, and give pertinent dates, including estimated date of starting any proposed work) SEE RULE 1103.

SPUD 17 1/2" HOLE, 9:00 AM, 9-22-84
TOTAL DEPTH 525'

1. RAN 514' (12 JTS) 13 3/8" OD 54.5# J-55 CASING AND SET @ 525'.
2. CEMENTED W/725 SX CLASS H CEMENT CONTAINING 2% CACL. CEMENT CIRCULATED. JOB COMPLETE 3:00 PM, 9-23-84. WOC 18 HRS.
3. TESTED 13 3/8" CASING TO 600# FOR 30 MINUTES, 9:00-9:30 AM, 9-24-84. TESTED OK. JOB COMPLETE 9:30 AM, 9-24-84.

8. I hereby certify that the information above is true and complete to the best of my knowledge and belief.

CHD Jerry Sexton TITLE Asst. Dist. Mgr. DATE 9-25-84APPROVED BY JERRY SEXTON DISTRICT 1 SUPERVISOR TITLE _____ DATE SEP 27 1984CONDITIONS OF APPROVAL, IF ANY:
ORIGINAL SIGNED BY JERRY SEXTON
DISTRICT 1 SUPERVISOR

NO. OF COPIES RECEIVED	
DISTRIBUTION	
SANTA FE	
FILE	
U.S.G.S.	
LAND OFFICE	
OPERATOR	

5A. Indicate Type of Lease
STATE ☒ FEE ☐
5. State Oil & Gas Lease No.
B-9505

APPLICATION FOR PERMIT TO DRILL, DEEPEN, OR PLUG BACK

1a. Type of Work DRILL <input checked="" type="checkbox"/> DEEPEN <input type="checkbox"/> PLUG BACK <input type="checkbox"/>		7. Unit Agreement Name
b. Type of Well OIL WELL <input checked="" type="checkbox"/> GAS WELL <input type="checkbox"/> OTHER <input type="checkbox"/> SINGLE ZONE <input checked="" type="checkbox"/> MULTIPLE ZONE <input type="checkbox"/>		8. Farm or Lease Name New Mexico "AT" State
2. Name of Operator Texaco Inc.		9. Well No. 15
3. Address of Operator P. O. Box 3109, Midland, Texas 79702		10. Field and Pool, or Wildcat Saunders Permo U. Penn
4. Location of Well UNIT LETTER C LOCATED 660 FEET FROM THE North LINE AND 1980 FEET FROM THE West LINE OF SEC. 15 TWP. 14-S REG. 33-E NMPM		12. County Lea
19. Proposed Depth 10,100'		19A. Formation Permo Upper Penn
20. Rotary or C.T. Rotary		
21. Elevations (Show whether DF, KT, etc.) 4208' GR	21A. Kind & Status Plug. Bond -	21B. Drilling Contractor -
22. Approx. Date Work will start October 1, 1984		

23.

PROPOSED CASING AND CEMENT PROGRAM

SIZE OF HOLE	SIZE OF CASING	WEIGHT PER FOOT	SETTING DEPTH	SACKS OF CEMENT	EST. TOP
17 1/2"	13 3/8"	48#, H-40	525'	600	Circulate
12 1/4"	8 5/8"	24#, K-55	4200'	2000	Circulate
		24#, S-80			
		28#, S-80			
7 7/8"	5 1/2"	17#, N-80	10,100'	2150	Circulate
		17#, K-55			

CEMENT PROGRAM

- SURFACE CASING: 600 sacks Class "H" w/2% CaCl (15.6 ppg, 1.18 ft³/sack).
- INTERMEDIATE CASING: 1800 sacks Light Weight w/15# salt and 1/4# flocele (12.7 ppg, 2.10 ft³/sack) followed by 200 sacks Class "H" w/1/4# flocele (15.6 ppg, 1.18 ft³/sack).
- PRODUCTION CASING: 1st Stage: 750 sacks Light Weight w/1/4# flocele, (12.3 ppg, 2.00 ft³/sack) followed by 200 sacks 50-50 Pozmix Class "H" w/1/4# flocele and 0.8% HALAD-9 (13.6 ppg, 1.40 ft³/sack. DV Tool at 7000' (Displacement type). 2nd Stage: 1200 sacks Light Weight w/1/4# flocele (12.3 ppg, 2.00 ft³/sack).

IN ABOVE SPACE DESCRIBE PROPOSED PROGRAM; IF PROPOSAL IS TO DEEPEN OR PLUG BACK, GIVE DATA ON PRESENT PRODUCTIVE ZONE AND PROPOSED NEW PRODUCTIVE ZONE. GIVE BLOWOUT PREVENTER PROGRAM, IF ANY.

I hereby certify that the information above is true and complete to the best of my knowledge and belief.

Signed Russell E. Sexton Russell E. Sexton Title Engineer's Asst. Date 9-14-84

(This space for State Use)

ORIGINAL SIGNED BY JERRY SEXTON

APPROVED BY DISTRICT 1 SUPERVISOR

TITLE

DATE

SEP 18 1984

CONDITIONS OF APPROVAL, IF ANY:

APPROVAL VALID FOR 180 DAYS
PERMIT EXPIRES 3/18/85
UNLESS DRILLING UNDERWAY

MEXICO OIL CONSERVATION COMMISSION
WELL LOCATION AND ACREAGE DEDICATION PLAT

Form C-102
Supersedes C-128
Effective 1-1-65

All distances must be from the outer boundaries of the Section.

Operator Texaco Inc.			Lease New Mexico "AT" State		Well No. 15
Unit Letter C	Section 15	Township 14-S	Range 33-E	County Lea	
Actual Footage Location of Well: 660 feet from the North line and 1980 feet from the West line					
Ground Level Elev. 4208'	Producing Formation Permo Upper Penn		Pool Saunders Permo Upper Penn		Dedicated Acreage: 40 Acres

1. Outline the acreage dedicated to the subject well by colored pencil or hachure marks on the plat below.

2. If more than one lease is dedicated to the well, outline each and identify the ownership thereof (both as to working interest and royalty).

3. If more than one lease of different ownership is dedicated to the well, have the interests of all owners been consolidated by communitization, unitization, force-pooling, etc?

☐ Yes ☐ No If answer is "yes," type of consolidation _____

If answer is "no," list the owners and tract descriptions which have actually been consolidated. (Use reverse side of this form if necessary.) _____

No allowable will be assigned to the well until all interests have been consolidated (by communitization, unitization, forced-pooling, or otherwise) or until a non-standard unit, eliminating such interests, has been approved by the Commission.

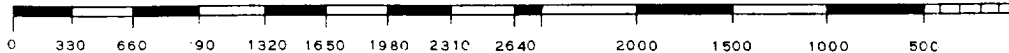
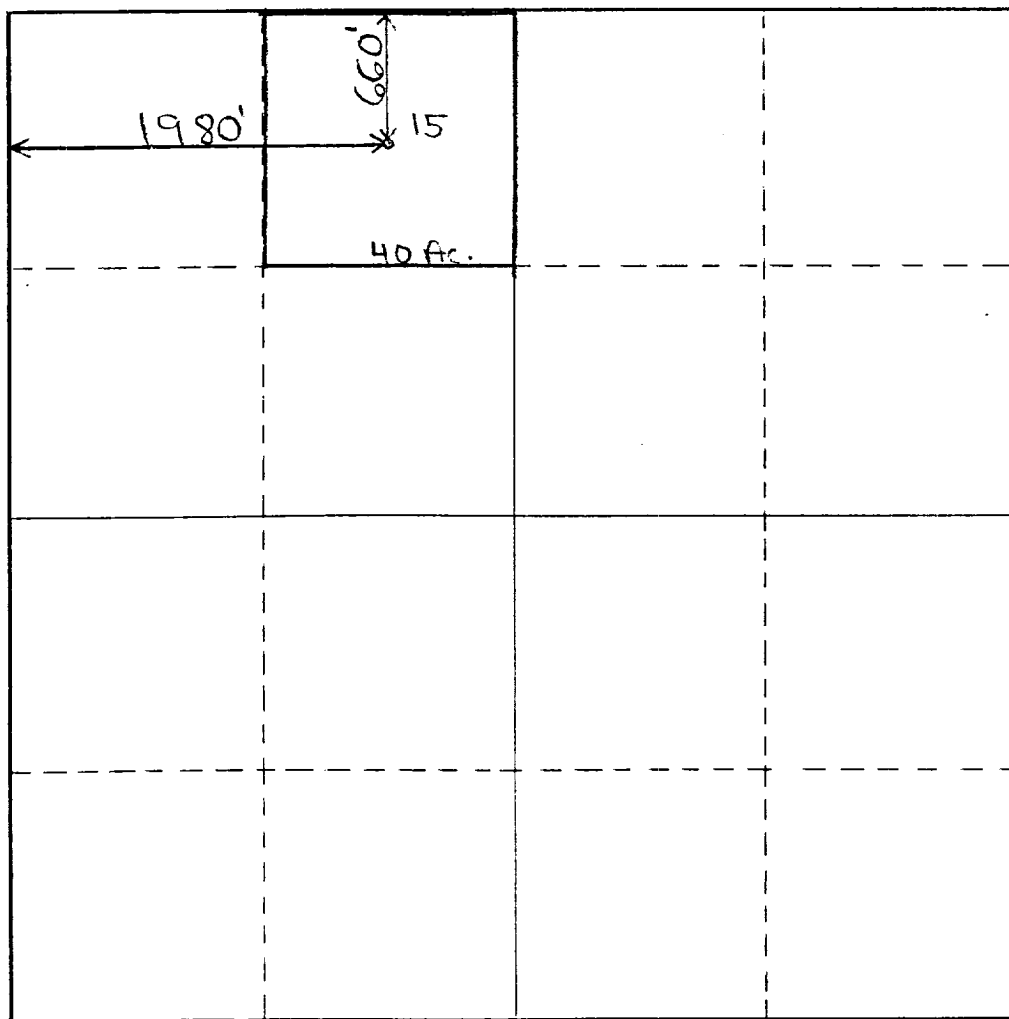

CERTIFICATION	
I hereby certify that the information contained herein is true and complete to the best of my knowledge and belief.	
<i>Russell E. Sexton</i>	
Name Russell E. Sexton	
Position Engineer's Asst.	
Company Texaco Inc.	
Date 9-14-84	
I hereby certify that the well location shown on this plat was plotted from field notes of actual surveys made by me or under my supervision, and that the same is true and correct to the best of my knowledge and belief.	
Registered Professional Engineer and/or Land Surveyor B. A. Eiland State of New Mexico Certificate No. 8317-84	