

NO. OF COPIES RECEIVED	
DISTRIBUTION	
SANTA FE	
FILE	
U.S.G.S.	
LAND OFFICE	
OPERATOR	

5A. Indicate Type of Lease STATE <input checked="" type="checkbox"/> FEE <input type="checkbox"/>
5. State Oil & Gas Lease No. LG-3818
7. Unit Agreement Name
8. Farm or Lease Name Pyro "ABK" State
9. Well No. 1
10. Field and Pool, or Wildcat Lazy J
12. County Lea

APPLICATION FOR PERMIT TO DRILL, DEEPEN, OR PLUG BACK

Type of Work

Type of Well DRILL ☒ DEEPEN ☐ PLUG BACK ☐  
OIL WELL ☒ GAS WELL ☐ OTHER ☐ SINGLE ZONE ☐ MULTIPLE ZONE ☐

Name of Operator  
YATES PETROLEUM CORPORATION

Address of Operator  
207 South 4th Street, Artesia, New Mexico 88210

Location of Well UNIT LETTER B LOCATED 660 FEET FROM THE North LINE

1980 FEET FROM THE East LINE OF SEC. 33 TWP. 13S RGE. 33E NMPM

19. Proposed Depth 10,000'	19A. Formation Bough D	20. Rotary or C.T. Rotary
-------------------------------	---------------------------	------------------------------

21A. Kind & Status Plug. Bond Blanket	21B. Drilling Contractor Undes.	22. Approx. Date Work will start ASAP
--	------------------------------------	--

PROPOSED CASING AND CEMENT PROGRAM

SIZE OF HOLE	SIZE OF CASING	WEIGHT PER FOOT	SETTING DEPTH	SACKS OF CEMENT	EST. TOP
17 3/4"	13 3/8"	48# H-40	350'	350 sx	circ.
12 1/4"	8 5/8"	32# K-55	4100'	1200 sx	circ.
7 7/8"	5 1/2"	17# K-55	10,000'	450 sx	

We propose to drill and test the Bough "D" and intermediate formations. Approximately 450' of surface casing will be set and cement circulated to shut off gravel and caving. If commercial, production casing will be run and cemented with adequate cover, perforated and stimulated as needed for production.

MUD PROGRAM: FW gel/LCM surface to 350', FW to 4250', SW gel/starch to TD.

BOP PROGRAM: BOP's will be installed at the offset and tested daily.

Permit Expires 6 Months From Approval  
Date Unless Drilling Underway.

ABOVE SPACE DESCRIBE PROPOSED PROGRAM; IF PROPOSAL IS TO DEEPEN OR PLUG BACK, GIVE DATA ON PRESENT PRODUCTIVE ZONE AND PROPOSED NEW PRODUCTION ZONE. GIVE BLOWOUT PREVENTER PROGRAM, IF ANY.

I hereby certify that the information above is true and complete to the best of my knowledge and belief.

Signed [Signature] Title Regulatory Agent Date 12/18/84

(This space for State Use)

ORIGINAL SIGNED BY JERRY SEXTON  
DISTRICT 1 SUPERVISOR

PROVED BY \_\_\_\_\_ TITLE \_\_\_\_\_ DATE DEC 27 1984

ADDITIONS OF APPROVAL, IF ANY:

**NEW MEXICO OIL CONSERVATION COMMISSION  
WELL LOCATION AND ACREAGE DEDICATION PLAT**

Form C-102  
Supersedes C-128  
Effective 1-1-65

All distances must be from the outer boundaries of the Section.

Operator <b>YATES PETROLEUM CORPORATION</b>			Lease <b>Pyro "ABK" State</b>		Well No. <b>1</b>
Unit Letter <b>B</b>	Section <b>33</b>	Township <b>13 South</b>	Range <b>33 East</b>	County <b>Lea</b>	
Actual Footage Location of Well: <b>660</b> feet from the <b>North</b> line and <b>1980</b> feet from the <b>East</b> line					
Ground Level Elev. <b>4243.5</b>	Producing Formation <b>Bough D</b>		Pool <b>LAZY J</b>		Dedicated Acreage: <b>40</b> Acres

1. Outline the acreage dedicated to the subject well by colored pencil or hachure marks on the plat below.
2. If more than one lease is dedicated to the well, outline each and identify the ownership thereof (both as to working interest and royalty).
3. If more than one lease of different ownership is dedicated to the well, have the interests of all owners been consolidated by communitization, unitization, force-pooling, etc?

☐ Yes    ☒ No    If answer is "yes," type of consolidation \_\_\_\_\_

If answer is "no," list the owners and tract descriptions which have actually been consolidated. (Use reverse side of this form if necessary.) \_\_\_\_\_

No allowable will be assigned to the well until all interests have been consolidated (by communitization, unitization, forced-pooling, or otherwise) or until a non-standard unit, eliminating such interests, has been approved by the Commission.

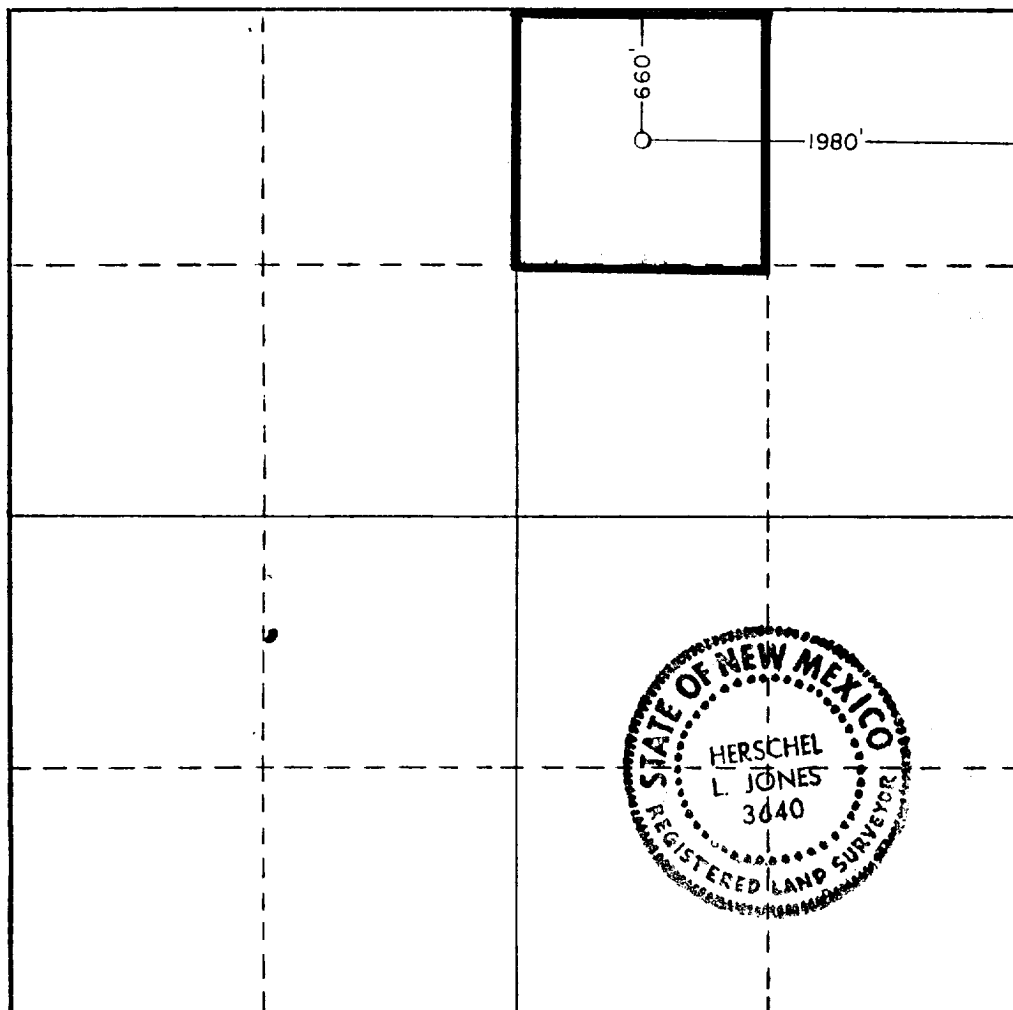

**CERTIFICATION**

*I hereby certify that the information contained herein is true and complete to the best of my knowledge and belief.*

*Cy Cowan*  
Name **Cy Cowan**

Position **Regulatory Agent**

Company **Yates Petroleum Corporation**

Date **12/18/84**

*I hereby certify that the well location shown on this plat was plotted from field notes of actual surveys made by me or under my supervision, and that the same is true and correct to the best of my knowledge and belief.*

Date Surveyed **12-5-84**

Registered Professional Engineer and/or Land Surveyor  
*Herschel L. Jones*  
**3640**

Certificate No. \_\_\_\_\_

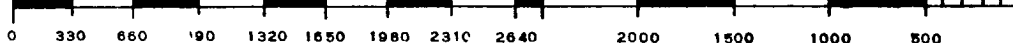

Rotating head if necessary.  
2" Fill up Line

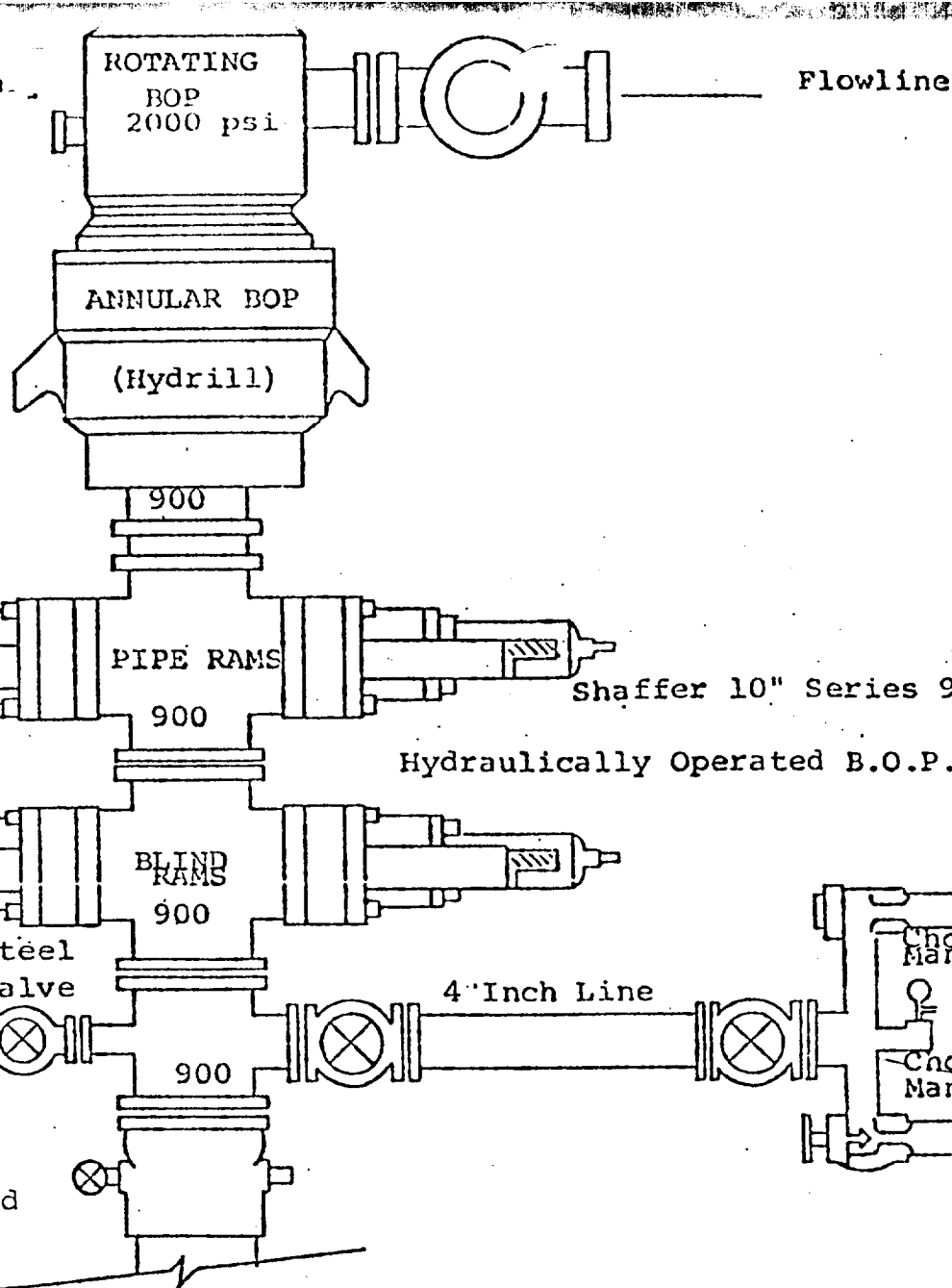

#### THE FOLLOWING CONSTITUTE MINIMUM BLOWOUT PREVENTER REQUIREMENTS

1. All preventers to be hydraulically operated with secondary manual control installed prior to drilling out from under casing.
2. Choke outlet to be a minimum of 4" diameter.
3. Kill line to be of all steel construction of 2" minimum diameter.
4. All connections from operating manifolds to preventers to be all steel. hole or tube a minimum of one inch in diameter.
5. The available closing pressure shall be at least 15% in excess of that required with sufficient volume to operate the B.O.P.'s.
6. All connections to and from preventer to have a pressure rating equivalent to that of the B.O.P.'s.
7. Inside blowout preventer to be available on rig floor.
8. Operating controls located a safe distance from the rig floor.
9. Hole must be kept filled on trips below intermediate casing.
10. D. P. float must be installed and used below zone of first gas intrusion.