

**NEW MEXICO OIL CONSERVATION COMMISSION
WELL LOCATION AND ACREAGE DEDICATION PLAT**

Form C-102
Supersedes C-120
Effective 1-1-85

All distances must be from the outer boundaries of the Section

Operator READ AND STEVENS, INC.			Lease North Baum		Well No. 4
Init Letter D	Section 24	Township 13 South	Range 32 East	County Lea	
Actual Footage Location of Well:					
554.0 feet from the North line and		554.0 feet from the West line			
Ground Level Elev. 4307.0	Producing Formation Pennsylvanian	Pool Und. Baum Upper Penn		Dedicated Acreage: 160 Acres	

1. Outline the acreage dedicated to the subject well by colored pencil or hatchure marks on the plat below.
2. If more than one lease is dedicated to the well, outline each and identify the ownership thereof (both as to working interest and royalty).
3. If more than one lease of different ownership is dedicated to the well, have the interests of all owners been consolidated by communitization, unitization, force-pooling, etc?

☐ Yes ☐ No If answer is "yes," type of consolidation N/A

If answer is "no," list the owners and tract descriptions which have actually been consolidated. (Use reverse side of this form if necessary.) _____

No allowable will be assigned to the well until all interests have been consolidated (by communitization, unitization, forced-pooling, or otherwise) or until a non-standard unit, eliminating such interests, has been approved by the Commission.

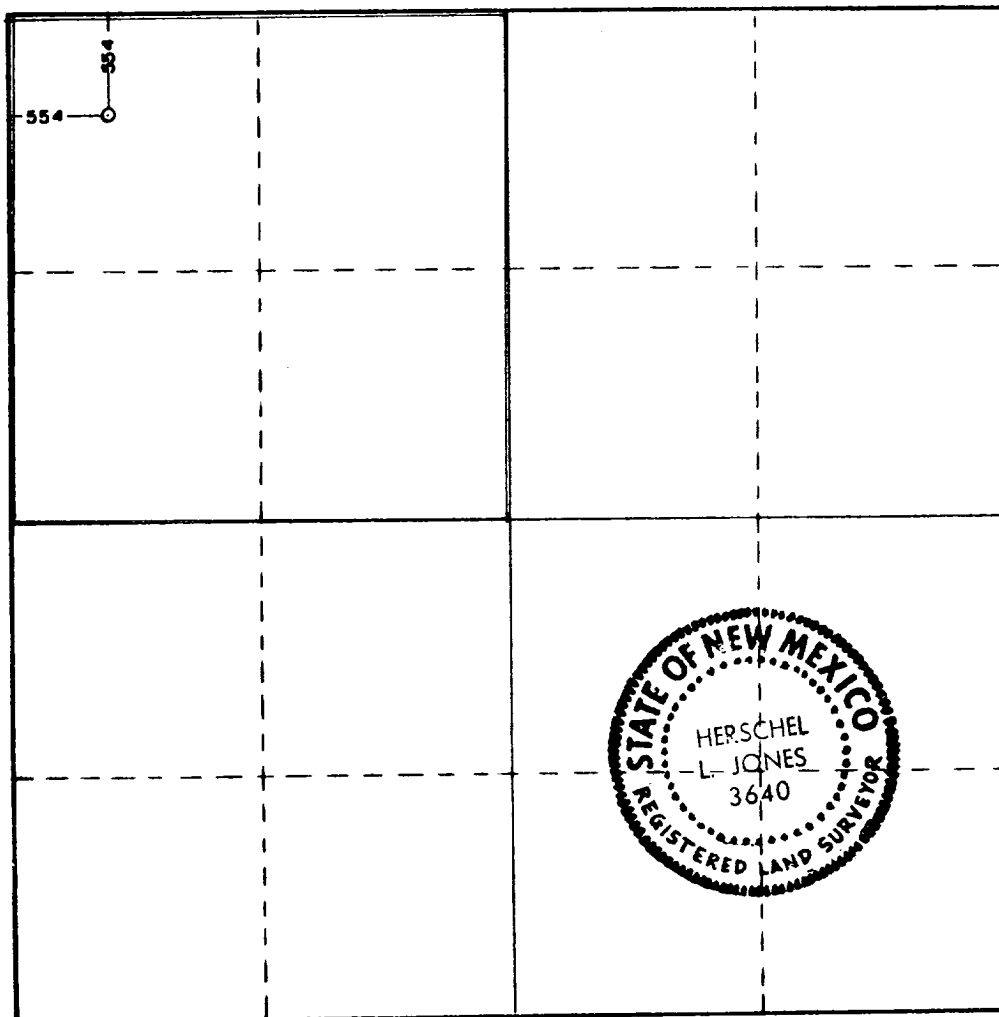

CERTIFICATION

I hereby certify that the information contained herein is true and complete to the best of my knowledge and belief.

Debra Butcher
Name

Debra Butcher
Position

Authorized Agent
Company

Read & Stevens, Inc.
Date

April 19, 1985

I hereby certify that the well location shown on this plat was plotted from field notes of actual surveys made by me or under my supervision, and that the same is true and correct to the best of my knowledge and belief.

Date Surveyed
April 15, 1985

Registered Professional Engineer and/or Land Surveyor

Herschel L. Jones
Certificate No. 3640

1-10

RECEIVED

APR 22 1985

O.C.D.
HOBBBS OFFICE