

Submit to Appropriate
District Office
State Lease - 4 copies
Fee Lease - 3 copies

State of New Mexico
Energy, Minerals and Natural Resources Department

Form C-102
Revised 1-1-89

OIL CONSERVATION DIVISION

P.O. Box 2088
Santa Fe, New Mexico 87504-2088

DISTRICT I
P.O. Box 1980, Hobbs, NM 88240

DISTRICT II
P.O. Drawer DD, Artesia, NM 88210

DISTRICT III
1000 Rio Brazos Rd., Aztec, NM 87410

WELL LOCATION AND ACREAGE DEDICATION PLAT

All Distances must be from the outer boundaries of the section

Operator OXY USA Inc.			Lease Elkan A		Well No. 1
Unit Letter L	Section 25	Township 13S	Range 34E	County NMPM	Lea
Actual Footage Location of Well: 1650 feet from the South line and 990 feet from the West line					
Ground level Elev. 4110.5'	Producing Formation Wolfcamp		Pool Wildcat	Dedicated Acreage: 40 Acres	

1. Outline the acreage dedicated to the subject well by colored pencil or hatchure marks on the plat below.

2. If more than one lease is dedicated to the well, outline each and identify the ownership thereof (both as to working interest and royalty).

3. If more than one lease of different ownership is dedicated to the well, have the interest of all owners been consolidated by communitization, unitization, force-pooling, etc.?

☐ Yes ☐ No If answer is "yes" type of consolidation _____

If answer is "no" list the owners and tract descriptions which have actually been consolidated. (Use reverse side of this form if necessary.) _____

No allowable will be assigned to the well until all interests have been consolidated (by communitization, unitization, forced-pooling, or otherwise) or until a non-standard unit, eliminating such interest, has been approved by the Division.

OPERATOR CERTIFICATION

I hereby certify that the information contained herein is true and complete to the best of my knowledge and belief.

Signature

Printed Name

David Stewart

Position

Production Accountant

Company

OXY USA Inc.

Date

5/8/91

SURVEYOR CERTIFICATION

I hereby certify that the well location shown on this plat was plotted from field notes of actual surveys made by me or under my supervision, and that the same is true and correct to the best of my knowledge and belief.

Date Surveyed

Signature & Seal of
Professional Surveyor

Certificate No.

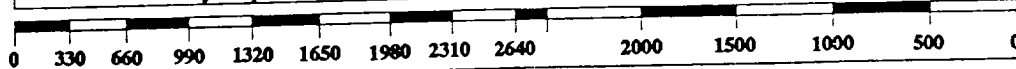
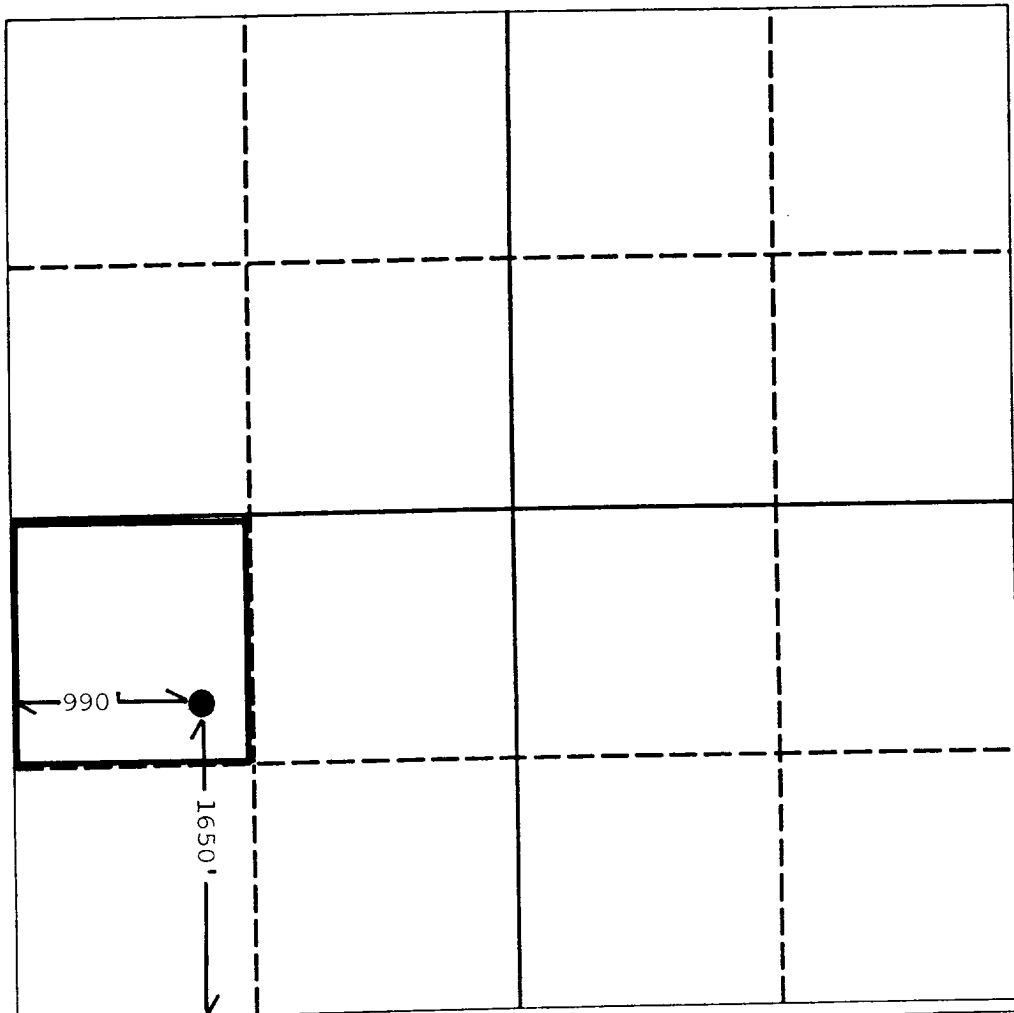

NO. OF COPIES RECEIVED	
DISTRIBUTION	
SANTA FE	
FILE	
U.S.G.S.	
LAND OFFICE	
OPERATOR	

NEW MEXICO OIL CONSERVATION COMMISSION

Form C-103
Supersedes Old
C-102 and C-103
Effective 1-1-65

5a. Indicate Type of Lease	
State <input type="checkbox"/>	Per <input checked="" type="checkbox"/>
5. State Oil & Gas Lease No.	

SUNDRY NOTICES AND REPORTS ON WELLS

(DO NOT USE THIS FORM FOR PROPOSALS TO DRILL OR TO DEEPEN OR PLUG BACK TO A DIFFERENT RESERVOIR. USE APPLICATION FOR PERMIT TO DRILL (FORM C-101) FOR SUCH PROPOSALS.)

1. OIL WELL <input checked="" type="checkbox"/> GAS WELL <input type="checkbox"/> OTHER <input type="checkbox"/>		7. Unit Agreement Name
2. Name of Operator OXY USA Inc.		8. Term of Lease Name Elkan A
3. Address of Operator P.O. Box 50250 - Midland, Texas 79710		9. Well No. 1
4. Location of Well UNIT LETTER <u>L</u> <u>1650</u> FEET FROM THE <u>South</u> LINE AND <u>990</u> FEET FROM THE <u>West</u> LINE, SECTION <u>25</u> TOWNSHIP <u>13S</u> RANGE <u>34E</u> NMPM.		10. Field and Pool, or Mineral Alston Ranch (Upper Pann)
11. Elevation (Show whether DF, RT, GK, etc.) 4111' GR		12. County Lea

Check Appropriate Box To Indicate Nature of Notice, Report or Other Data
NOTICE OF INTENTION TO: SUBSEQUENT REPORT OF:

PERFORM REMEDIAL WORK <input type="checkbox"/>	PLUG AND ABANDON <input type="checkbox"/>	REMEDIAL WORK <input type="checkbox"/>	ALTERING CASING <input type="checkbox"/>
TEMPORARILY ABANDON <input type="checkbox"/>	CHANGE PLANS <input type="checkbox"/>	COMMENCE DRILLING OPNS. <input type="checkbox"/>	PLUG AND ABANDONMENT <input type="checkbox"/>
PULL OR ALTER CASING <input type="checkbox"/>	OTHER <input type="checkbox"/>	CASING TEST AND CEMENT JOBS <input type="checkbox"/>	
		OTHER <u>Cancellation of cementing the 5-1/2" casing across the problem zone</u> <input checked="" type="checkbox"/>	

7. Describe Proposed or Completed Operations (Clearly state all pertinent details, and give pertinent dates, including estimated date of starting any proposed work) SEE RULE 1103.

O.T.D. 10800' Lime & Dolomite, PBTD 10700'. The proposed cementing of the 5-1/2" casing across the troubled zone, around 7650', was not necessary due to the running of a casing inspection log from 10300' - surface which found the casing to be in good condition with no corrosion pits in the casing. The tubing, rods and BHP were run and the well is now back on production.

I hereby certify that the information above is true and complete to the best of my knowledge and belief.

SIGNED <u>Jd Veltrano</u>	TITLE <u>Dist. Opr. Mgr. - Prod.</u>	DATE <u>10-04-88</u>
ORIGINAL SIGNED BY JERRY SEXTON DISTRICT 1 SUPERVISOR		
APPROVED BY _____	TITLE _____	DATE <u>10-06-1988</u>
CONDITIONS OF APPROVAL, IF ANY:		