

DISTRICT I
1625 N. French Dr., Hobbs, NM 88240

State of New Mexico
Energy, Minerals and Natural Resources Department

Form C-101
Revised March 17, 1999
Instructions on back
Submit to appropriate District Office
State Lease - 6 Copies
Fee Lease - 5 Copies

DISTRICT II
811 South First, Artesia, NM 88210

OIL CONSERVATION DIVISION
PO BOX 2088
Santa Fe, NM 87504-2088

DISTRICT III
1000 Rio Brazos Rd., Aztec, NM 87410

DISTRICT IV
2040 South Pacheco, Santa Fe, NM 87501

☐ AMENDED REPORT

APPLICATION FOR PERMIT TO DRILL, RE-ENTER, DEEPEN, PLUGBACK, OR ADD A ZONE

¹ Operator Name and Address Yates Petroleum Corporation 105 South Fourth Street Artesia, New Mexico 88210		² OGRID Number 025575
		³ API Number 30-025-29496
⁴ Property Code 27435	⁵ Property Name Yam "AYQ" State	⁶ Well No. 1

⁷ Surface Location

UL or lot no.	Section	Township	Range	Lot Idn	Feet from the	North/South Line	Feet from the	East/West Line	County
N	26	12S	36E		990	South	2310	West	Lea

⁸ Proposed Bottom Hole Location If Different From Surface

UL or lot no.	Section	Township	Range	Lot Idn	Feet from the	North/South Line	Feet from the	East/West Line	County
⁹ Proposed Pool 1 Tatum Morrow					¹⁰ Proposed Pool 2				

¹¹ Work Type Code E	¹² Well Type Code G	¹³ Cable/Rotary R	¹⁴ Lease Type Code S	¹⁵ Ground Level Elevation 3961.8'
¹⁶ Multiple No	¹⁷ Proposed Depth 12830'	¹⁸ Formation Morrow	¹⁹ Contractor Not Determined	²⁰ Spud Date 5/1/01

²¹ Proposed Casing and Cement Program

Hole Size	Casing Size	Casing weight/feet	Setting Depth	Sacks of Cement	Estimated TOC
17 1/2"	13 3/8	36#	525'-in place	450sx	Circulate
11"	8 5/8"	24# & 32#	4945'-in place	1400 sx	Circulate
7 7/8"	5 1/2"	17#--in place	5997-14104'	1570 sx	TOC-7000'
	5 1/2"	17#	0-5997'-tie-in	500 sx	TOC-4000' +/-

²² Describe the proposed program. If this application is to DEEPEN or PLUG BACK give the data on the present productive zone and proposed new productive zone. Describe the blowout prevention program, if any. Use additional sheets if necessary.

See Attached Sheet

Permit Expires 1 Year From Approval
Date Unless Drilling Underway

Re-Entry

23 I hereby certify that the information given above is true and complete to the best of

my knowledge and belief.

Signature:

Printed name:

Title: Regulatory Agent

Date:

04/16/01

Phone:

(505) 748-1471

OIL CONSERVATION DIVISION

Approved by:

Title:

Approval Date:

Expiration Date:

Conditions of Approval

Attached ☐

Do not post
if re-enter

YATES PETROLEUM CORPORATION

Yam "AYQ" State #1 Re-entry

990' FSL & 2310' FWL

Section 26-T12S-R36E

Lea County, New Mexico

Drilling Prognosis: Yates Petroleum Corporation plans to re-enter the well with a pulling unit and a reverse unit to drill out the plugs in the 8 5/8" casing to 4,945'. Then drillout the cement plugs in the 7 7/8" open hole down to the top of the 5 1/2" casing that was cutoff at 5,997'. After the 5 1/2" casing has been repaired, cemented, and tested, the plugs in the 5 1/2" casing will be cleaned out to 12,694'. The zone will be re-perforated and tested to see if production from the Morrow zone can be restored.

Mud Program: Cut brine and existing mud will be used to drill out the plugs.

BOPE Program: A 5000# BOP system will be installed on the 8 5/8" casing and tested daily for operational.

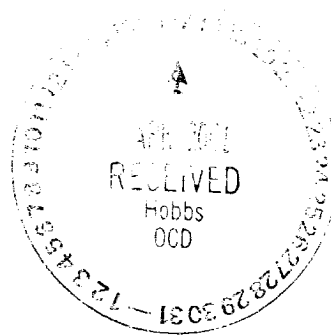

DISTRICT IV
2048 South Pacheco, Santa Fe, NM 87505

Form C-102
Revised March 17, 1999
Instruction on back
appropriate District Office
State Lease - 4 Copies
Fee Lease - 3 Copies

Santa Fe, New Mexico 87504-2088

☐ AMENDED REPORT

API Number 30-025-29496		Pool Code	Pool Name Tatum Morrow
Property Code 27935	Property Name Yam "AYQ" State		Well Number #1
OCED No. 025575	Operator Name YATES PETROLEUM CORPORATION		Elevation 3961.8'

UL or Lot No.	Section	Township	Range	Lot Idn	Feet from the	North/South line	Feet from the	East/West line	County
N	26	12S	36E		990'	South	2310'	West	Lea

UL or lot No.	Section	Township	Range	Lot kin	Feet from the	North/South line	Feet from the	East/West line	County
Dedicated Acres	Joint or Infill	Consolidation Code			Order No.				
360.00									

GENERAL SURVEYING COMPANY

MEXICO OIL CONSERVATION COMMISSION
WELL LOCATION AND ACREAGE DEDICATION PLATForm C-102
Supersedes C-128
Effective 1-1-65

All distances must be from the outer boundaries of the Section.

Operator John L. Cox		Lease State 26		Well No. 1
Unit Letter N	Section 26	Township 12 South	Range 36 East	County Lea
Actual Footage Location of Well: 990 feet from the South line and 2310 feet from the West line				
Ground Level Elev. 3961.8	Producing Formation MORROW	Pool	Dedicated Acreage: 320 Acres	

1. Outline the acreage dedicated to the subject well by colored pencil or hatchure marks on the plat below.
2. If more than one lease is dedicated to the well, outline each and identify the ownership thereof (both as to working interest and royalty).
3. If more than one lease of different ownership is dedicated to the well, have the interests of all owners been consolidated by communitization, unitization, force-pooling, etc?

☒ Yes ☐ No If answer is "yes," type of consolidation Communitization

If answer is "no," list the owners and tract descriptions which have actually been consolidated. (Use reverse side of this form if necessary.)

No allowable will be assigned to the well until all interests have been consolidated (by communitization, unitization, forced-pooling, or otherwise) or until a non-standard unit, eliminating such interests, has been approved by the Commission.

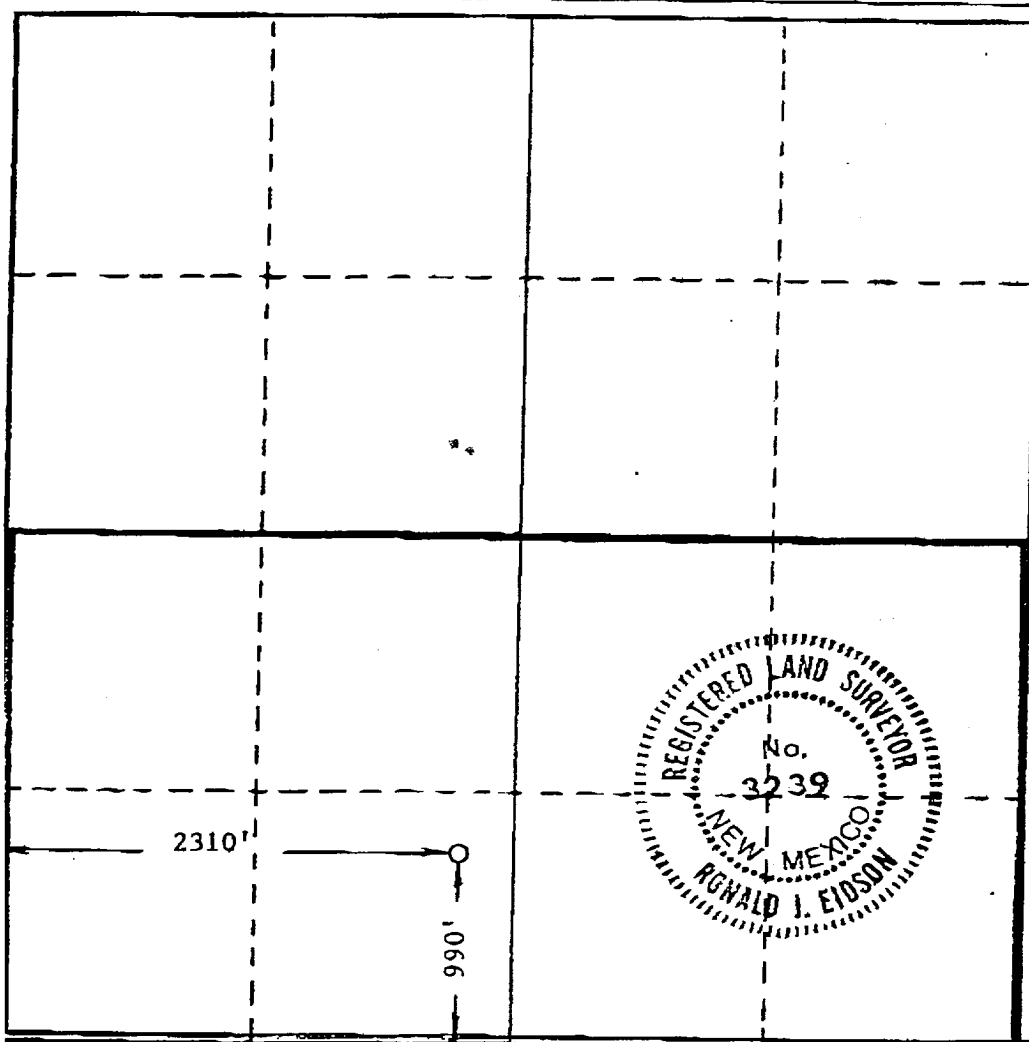

CERTIFICATION

I hereby certify that the information contained herein is true and complete to the best of my knowledge and belief.

MARTHA WITTENBACH

Name
PRODUCTION MANAGERPosition
JOHN L. COXCompany
JULY 16, 1986Date
Martha Wittenbach

I hereby certify that the well location shown on this plat was plotted from field notes of actual surveys made by me or under my supervision, and that the same is true and correct to the best of my knowledge and belief.

Date Surveyed
11-5-85Registered Professional Engineer
and a Land Surveyor*Ronald J. Eidson*

Certificate No. JOHN W. WEST.

676

WELLNAME: State 26 #1 FIELD: Tatum (Morrow)
 LOCATION: 990' FSL, 2310' FWL of Section 26-12S-36E, Lea Co.
 GL: 3970' ZERO: _____ AGL: _____ KB: 3,988'
 SPUD DATE: 12-2-85 COMPLETION DATE: 3-15-86
 COMMENTS: P&A 6/25/88

CASING PROGRAM		
SIZE/WT/GR/CONN		DEPTH SET
13 ³ / ₈ "	36#	525'
8 ⁵ / ₈ "	24#	1945'
5 ¹ / ₂ "	17#	14,104'
27/8 tbg.		12,501'

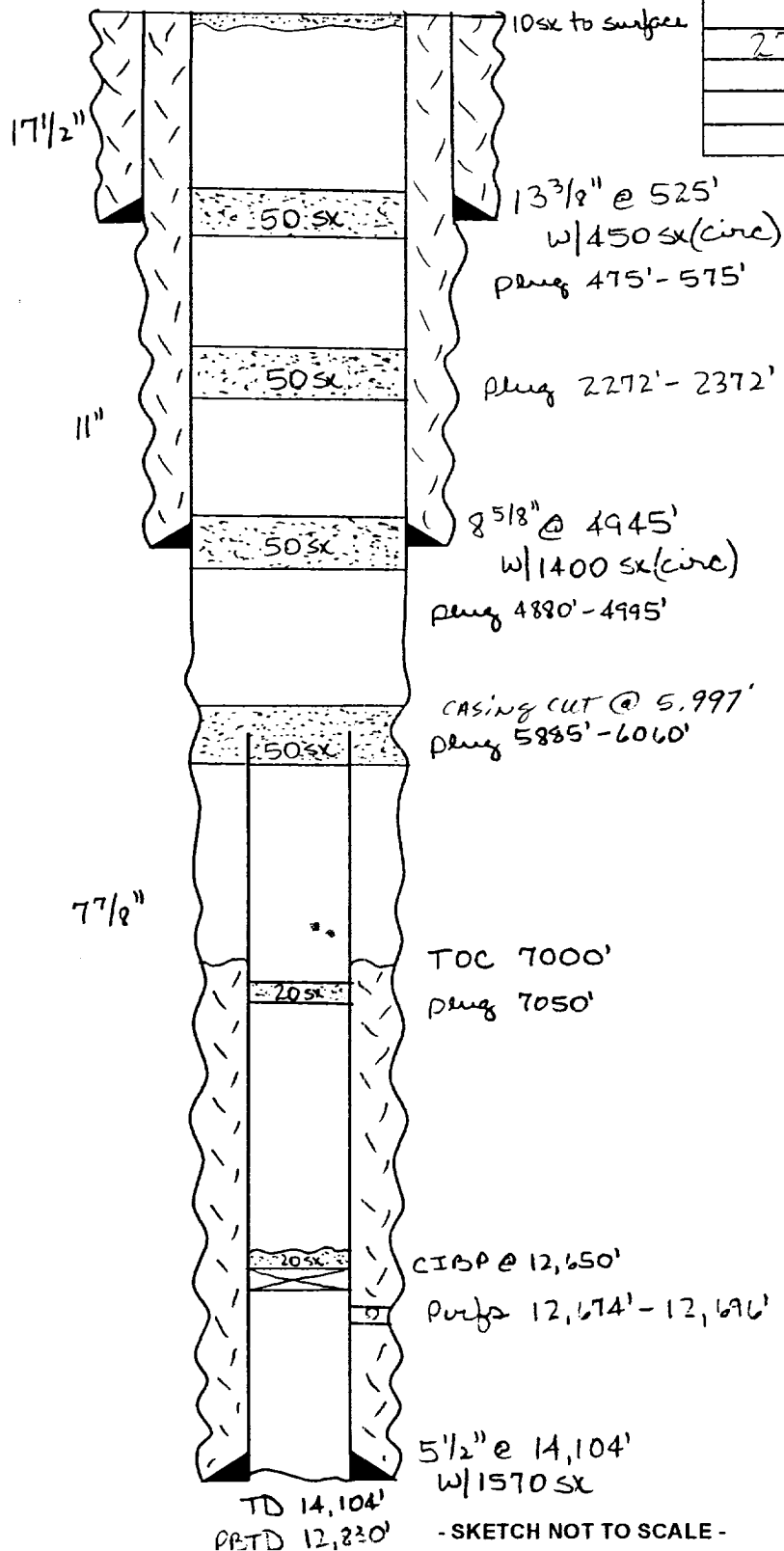

8⁵/₈" DV @ 2272'
5¹/₂" DV @ 12,877'

before

Tops	
San Andres	4503'
Chubb	7392'
Wolfcamp	9612'
Canyon	10,901'
Straun	11,240'
Atoka	12,046'
Miss.	13,091'
Duonian	13,883'

DATE: 4-5-01 TH

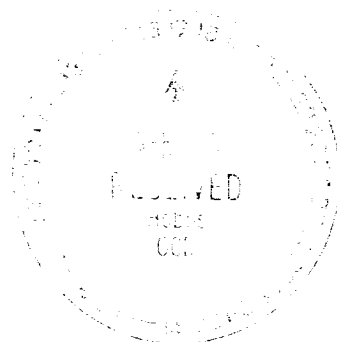

WELLNAME: Yam "AYQ" State #1 FIELD: Tatum (Morrow)
 LOCATION: 990' FSL, 2310' FWL of Section 26-125-36E, Lea Co.
 GL: 3970' ZERO: _____ AGL: _____ KB: 3,988'
 SPUD DATE: 12-2-85 COMPLETION DATE: 3-15-86
 COMMENTS: PJA 6/25/88

CASING PROGRAM	
SIZE/WT/GR/CONN	DEPTH SET
13 ³ / ₈ " 36#	525'
8 ⁵ / ₈ " 21# , 32#	1945'
5 ¹ / ₂ " 17#	14,104'
2 ⁷ / ₈ tbq.	12,501'

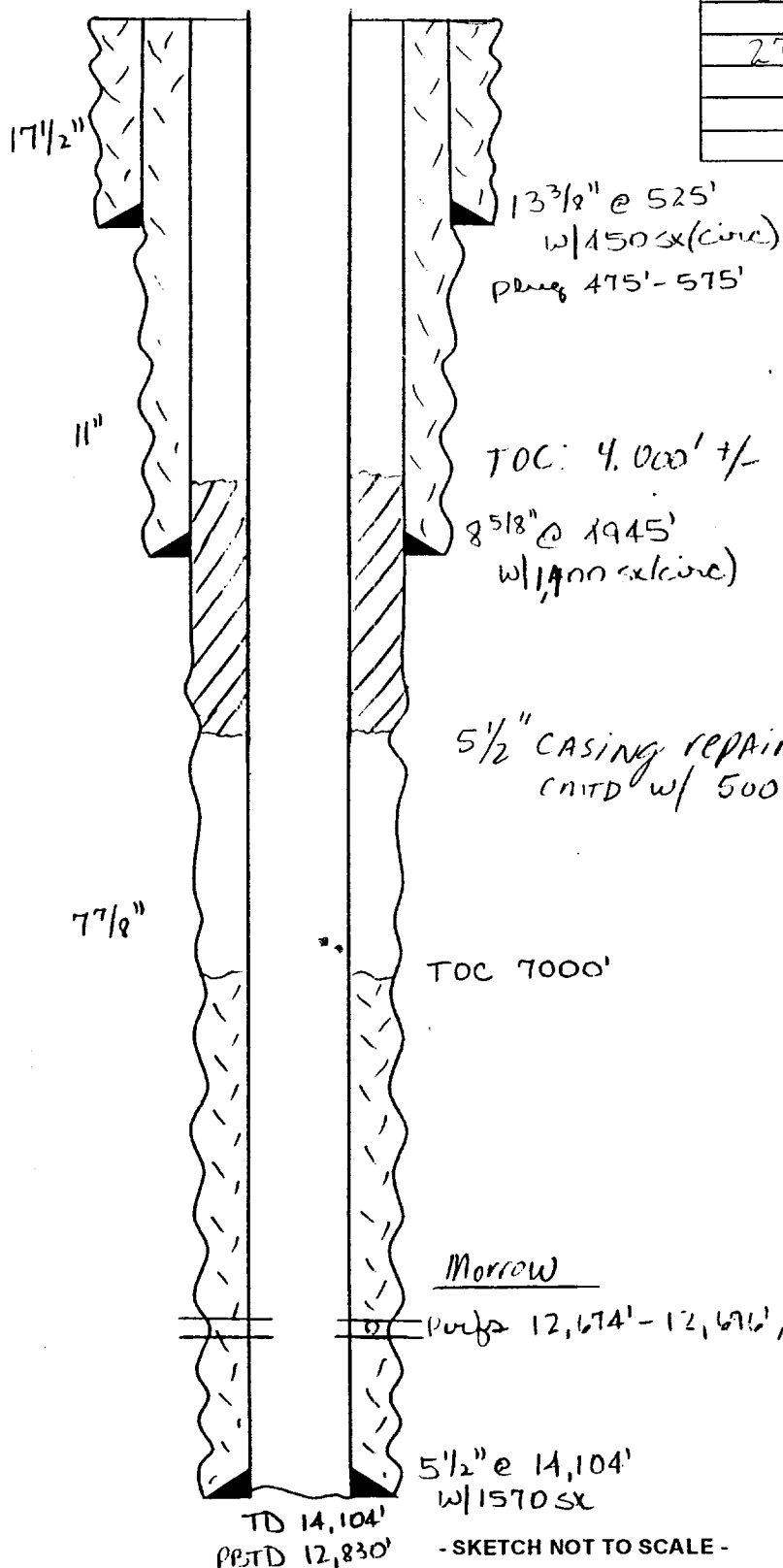

8⁷/₈" DV @ 2272'
5¹/₂" DV @ 12,877'

After

Tops	
San Andres	4503'
Chubb	7392'
Wolfcamp	9612'
Canyon	10,901'
Strauss	11,240'
Atoka	12,046'
Miss.	13,091'
Duonian	13,883'

Morrow

perfs 12,674'-12,676', perforated w/ 6 jets & fraced

5¹/₂" @ 14,104'
w/1570 lb/ft

TD 14,104'
PSTD 12,830'

- SKETCH NOT TO SCALE -

DATE: 4-5-01 TH

YATES PETROLEUM CORPORATION

TYPICAL 5,000 p.s.i. BLOWOUT PREVENTER & CHOKE MANIFOLD SCHEMATIC

