

30-020-29212

STATE OF NEW MEXICO
ENERGY AND MINERALS DEPARTMENT

OIL CONSERVATION DIVISION

Form C-101
Revised 10-1-78

NO. OF COPIES RECEIVED	
DISTRIBUTION	
SANTA FE	
FILE	
U.S.G.S.	
LAND OFFICE	
OPERATOR	

P. O. BOX 2088
SANTA FE, NEW MEXICO 87501

5A. Indicate Type of Lease
STATE <input checked="" type="checkbox"/> FEE <input type="checkbox"/>
5. State Oil & Gas Lease No.
V-1412 V-1386

APPLICATION FOR PERMIT TO DRILL, DEEPEN, OR PLUG BACK

1a. Type of Work		7. Unit Agreement Name	
DRILL <input checked="" type="checkbox"/> DEEPEN <input type="checkbox"/> PLUG BACK <input type="checkbox"/>		East Bagley Unit	
b. Type of Well		8. Farm or Lease Name	
OIL WELL <input checked="" type="checkbox"/> GAS WELL <input type="checkbox"/> OTHER <input type="checkbox"/> SINGLE ZONE <input type="checkbox"/> MULTIPLE ZONE <input type="checkbox"/>			
2. Name of Operator		9. Well No.	
Yates Petroleum Corporation		1	
3. Address of Operator		10. Field and Pool, or Wildcat	
207 South Fourth Street - Artesia, NM 88210		East Bagley Penn	
4. Location of Well		12. County	
UNIT LETTER G LOCATED 1980 FEET FROM THE North LINE		Lea	
AND 1980 FEET FROM THE East LINE OF SEC. 6 TWP. 12S RGE. 34E NMPM			
19. Proposed Depth		19A. Formation	20. Rotary or C.T.
10400'		Bough	Rotary
21. Elevations (Show whether DF, KT, etc.)	21A. Kind & Status Plug. Bond	21B. Drilling Contractor	22. Approx. Date Work will start
4204.6' GR	Blanket	Undesignated	ASAP

PROPOSED CASING AND CEMENT PROGRAM

SIZE OF HOLE	SIZE OF CASING	WEIGHT PER FOOT	SETTING DEPTH	SACKS OF CEMENT	EST. TOP
17-1/2"	13-3/8"	48# H-40	Approx. 375'	400 sacks	Circulate
12-1/4"	8-5/8"	24# K-55 & S-80	4100'	1300 sacks	Circulate
8-3/4"	5-1/2"	28# S-80 & 17# N-80 & S-95	TD	450 sacks	

We propose to drill and test the Bough formation and intermediate zones. Approximately 375' of surface casing will be set and cement circulated. Intermediate casing will be set to approximately 4100' and cement circulated. If productive, 5-1/2" casing will be run and cemented with adequate cover, perforated and stimulated as needed for production.

MUD PROGRAM: FW Gel to 375'; native mud to 4100'; water/paper to 7500'; starch/driskak/KCL to TD

BOP PROGRAM: BOP's to be installed at the offset and tested daily.

Permit Expires 6 Months From Approval
Date Unless Drilling Underway.

IN ABOVE SPACE DESCRIBE PROPOSED PROGRAM; IF PROPOSAL IS TO DEEPEN OR PLUG BACK, GIVE DATA ON PRESENT PRODUCTIVE ZONE AND PROPOSED NEW PRODUCTIVE ZONE. GIVE BLOWOUT PREVENTER PROGRAM, IF ANY.

I hereby certify that the information above is true and complete to the best of my knowledge and belief.

Signed Clifton R. May Title Regulatory Agent Date Nov. 19, 1985

(This space for State Use)
Eddie W. Seay

APPROVED BY Oil & Gas Inspector TITLE DATE NOV 21 1985

CONDITIONS OF APPROVAL, IF ANY:

RECEIVED

NOV 21 1985

G.C.D.
HOBBS OFFICE

42946

STATE OF NEW MEXICO
ENERGY AND MINERALS DEPARTMENT

OIL CONSERVATION DIVISION

P. O. BOX 2088

SANTA FE, NEW MEXICO 87501

Form C-102
Revised 10-1-78

All distances must be from the outer boundaries of the Section.

Operator YATES PETROLEUM CORPORATION			Lease EAST BAGLEY UNIT		Well No. 1
Unit Letter G	Section 6	Township 12 South	Range 34 East	County Lea	
Actual Footage Location of Well: 1980 feet from the North line and 1980 feet from the East line					
Ground Level Elev. 4204.6	Producing Formation BOUGH	Pool EAST BAGLEY PENN	Dedicated Acreage: 40 Acres		

1. Outline the acreage dedicated to the subject well by colored pencil or hatchure marks on the plat below.
2. If more than one lease is dedicated to the well, outline each and identify the ownership thereof (both as to working interest and royalty).
3. If more than one lease of different ownership is dedicated to the well, have the interests of all owners been consolidated by communitization, unitization, force-pooling, etc?

☐ Yes ☐ No If answer is "yes," type of consolidation _____

If answer is "no," list the owners and tract descriptions which have actually been consolidated. (Use reverse side of this form if necessary.) _____

No allowable will be assigned to the well until all interests have been consolidated (by communitization, unitization, forced-pooling, or otherwise) or until a non-standard unit, eliminating such interests, has been approved by the Division.

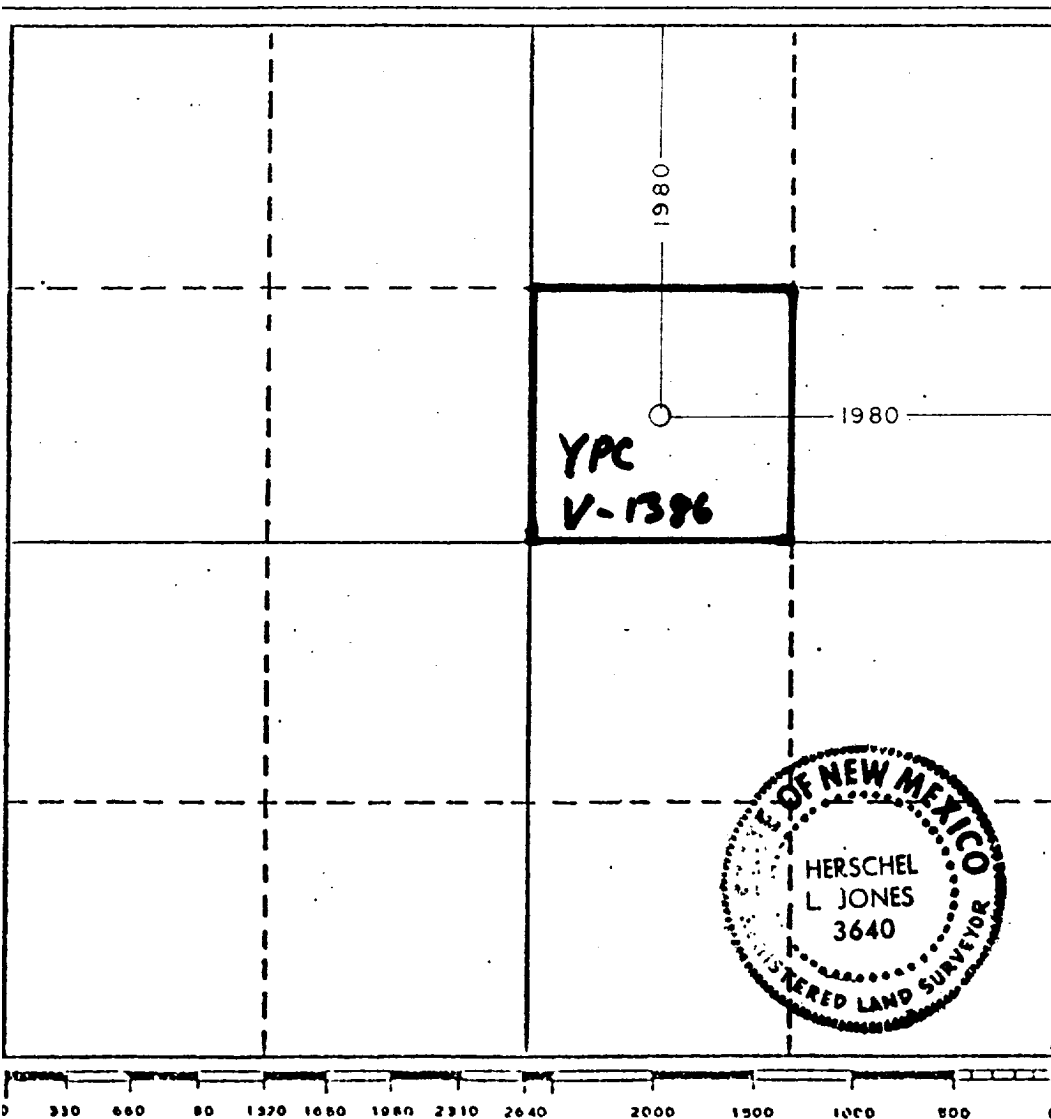

CERTIFICATION

I hereby certify that the information contained herein is true and complete to the best of my knowledge and belief.

Name

Clifton R. May

Position

Regulatory Agent

Company

Yates Petroleum Corporation

Date

Nov. 21, 1985

I hereby certify that the well location shown on this plat was plotted from field notes of actual surveys made by me or under my supervision, and that the same is true and correct to the best of my knowledge and belief.

Date Surveyed

11/15/85

Registered Professional Engineer
and/or Land Surveyor

Certificate No.

3640

RECEIVED

NOV 21 1985

O.C.B.
HODGES OFFICE

Rotating head if necessary
" Fill up Line

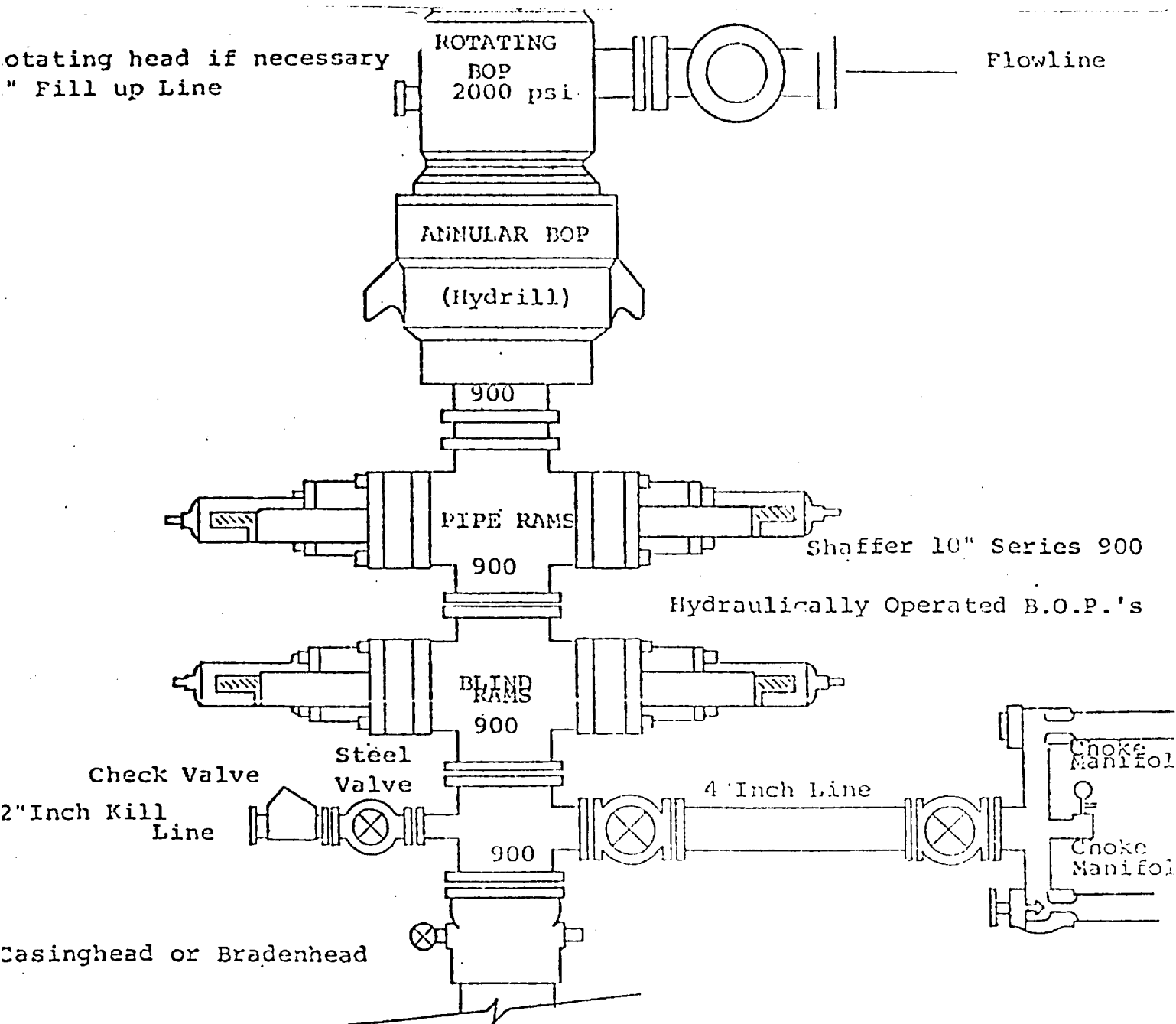

THE FOLLOWING CONSTITUTE MINIMUM BLOWOUT PREVENTER REQUIREMENTS

1. All preventers to be hydraulically operated with secondary manual control installed prior to drilling out from under casing.
2. Choke outlet to be a minimum of 4" diameter.
3. Kill line to be of all steel construction of 2" minimum diameter.
4. All connections from operating manifolds to preventers to be all steel. hole or tube a minimum of one inch in diameter.
5. The available closing pressure shall be at least 15% in excess of that required with sufficient volume to operate the B.O.P.'s.
6. All connections to and from preventer to have a pressure rating equivalent to that of the B.O.P.'s.
7. Inside blowout preventer to be available on rig floor.
8. Operating controls located a safe distance from the rig floor.
9. Hole must be kept filled on trips below intermediate casing.
10. D. P. float must be installed and used below zone of first gas intrusion.

78-00-9 F.A

173

78-00-6

21

RECEIVED

NOV 21 1985

O.C.D.
HODGES OFFICE