

NEW MEXICO OIL CONSERVATION COMMISSION  
WELL LOCATION AND ACREAGE DEDICATION PLAT

Form C-102  
Supersedes C-128  
Effective 1-1-65

All distances must be from the outer boundaries of the Section.

Operator TEXACO Inc.			Lease New Mexico "BG" State NCT-1		Well No. 10
Unit Letter 0	Section 14	Township 14 South	Range 33 East	County Lea	
Actual Footage Location of Well: 990 feet from the South line and 1980 feet from the East line Sec. 14					
Ground Level Elev: 4187'	Producing Formation Bough "A" "B" "C"		Pool Saunders Permo Upper Penn		Dedicated Acreage: 40 Acres

1. Outline the acreage dedicated to the subject well by colored pencil or hachure marks on the plat below.
2. If more than one lease is dedicated to the well, outline each and identify the ownership thereof (both as to working interest and royalty).
3. If more than one lease of different ownership is dedicated to the well, have the interests of all owners been consolidated by communitization, unitization, force-pooling, etc?

☐ Yes ☐ No If answer is "yes," type of consolidation \_\_\_\_\_

If answer is "no," list the owners and tract descriptions which have actually been consolidated. (Use reverse side of this form if necessary.) \_\_\_\_\_

No allowable will be assigned to the well until all interests have been consolidated (by communitization, unitization, forced-pooling, or otherwise) or until a non-standard unit, eliminating such interests, has been approved by the Commission.

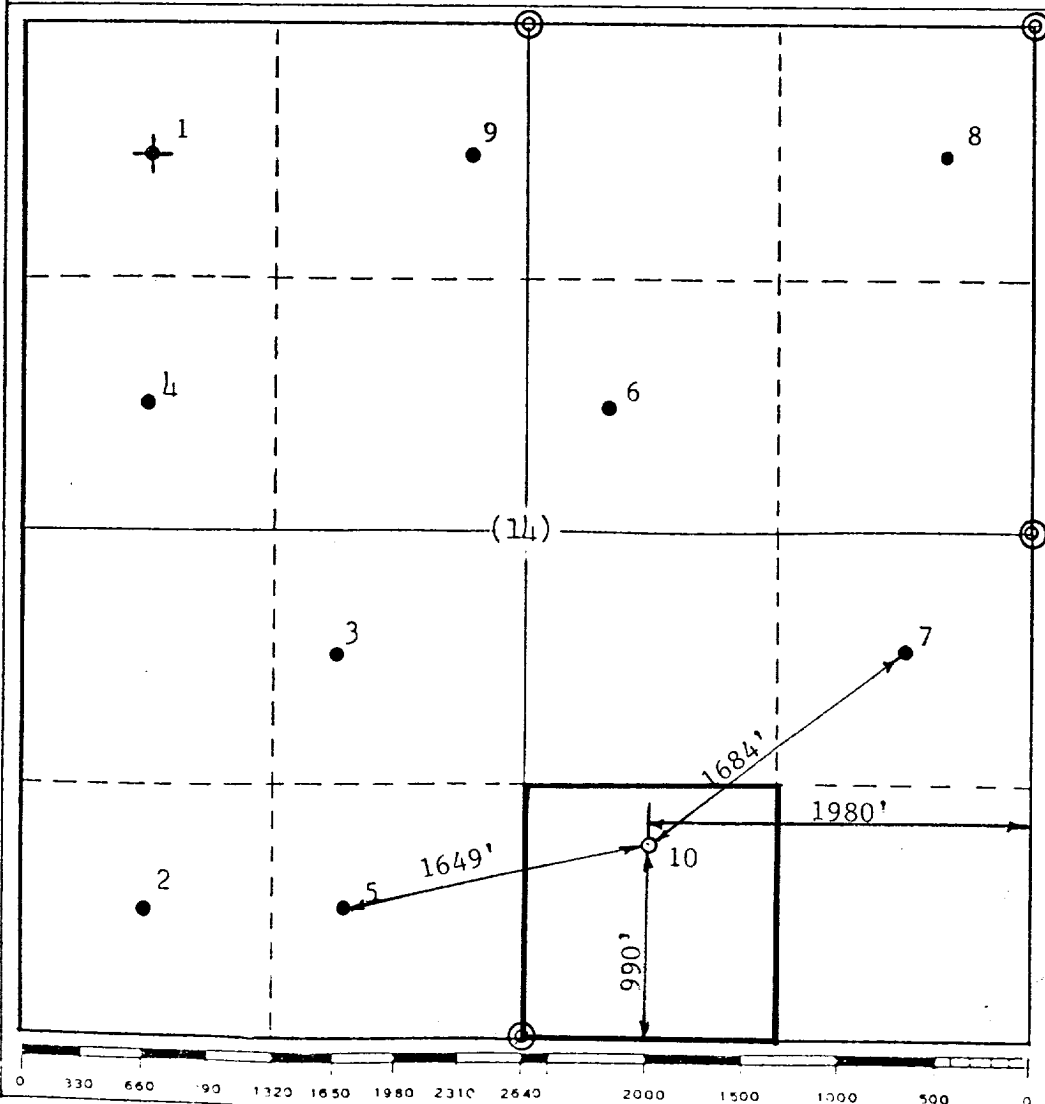

CERTIFICATION

I hereby certify that the information contained herein is true and complete to the best of my knowledge and belief.

*B. L. Eiland*  
Name

B. L. Eiland

Position

Division Surveyor

Company

TEXACO Inc.

Date

February 27, 1987

I hereby certify that the well location shown on this plat was plotted from field notes of actual surveys made by me or under my supervision, and that the same is true and correct to the best of my knowledge and belief.

Date

February 26, 1987

Professional Engineer

State of New Mexico

4398

B. L. Eiland

Surveyor

⊙ - Denotes USGLO Markers

RECEIVED  
MAY 13 1987  
HONORARY OFFICE