

NO. OF COPIES RECEIVED	
DISTRIBUTION	
SANTA FE	
FILE	
U.S.G.S.	
LAND OFFICE	
OPERATOR	

5A. Indicate Type of Lease STATE <input type="checkbox"/> FEE <input checked="" type="checkbox"/>
5. State Oil & Gas Lease No.
7. Unit Agreement Name
8. Farm or Lease Name Coy Lowe
9. Well No. 1
10. Field and Pool, or Wildcat King Wolfcamp
12. County Lea

APPLICATION FOR PERMIT TO DRILL, DEEPEN, OR PLUG BACK

1a. Type of Work DRILL <input checked="" type="checkbox"/> DEEPEN <input type="checkbox"/> PLUG BACK <input type="checkbox"/>		7. Unit Agreement Name
b. Type of Well OIL WELL <input checked="" type="checkbox"/> GAS WELL <input type="checkbox"/> OTHER <input type="checkbox"/> SINGLE ZONE <input checked="" type="checkbox"/> MULTIPLE ZONE <input type="checkbox"/>		8. Farm or Lease Name Coy Lowe
2. Name of Operator Mañalo, Inc.		9. Well No. 1
3. Address of Operator P. O. Box 832, Midland, Texas 79702 0832		10. Field and Pool, or Wildcat King Wolfcamp
4. Location of Well UNIT LETTER <u>E</u> LOCATED <u>1980</u> FEET FROM THE <u>North</u> LINE AND <u>660</u> FEET FROM THE <u>West</u> LINE OF SEC. <u>20</u> TWP. <u>13-S</u> RGE. <u>38-E</u> NMPM		12. County Lea
19. Proposed Depth 10,000		19A. Formation Wolfcamp
20. Rotary or C.T. Rotary		
21. Elevations (Show whether DE, RT, etc.) 3828.7 GR	21A. Kind & Status Plug. Bond Blanket	21B. Drilling Contractor unknown
22. Approx. Date Work will start October 5		

23.

PROPOSED CASING AND CEMENT PROGRAM

SIZE OF HOLE	SIZE OF CASING	WEIGHT PER FOOT	SETTING DEPTH	SACKS OF CEMENT	EST. TOP
17 1/2	13 3/8	54	450	500sx	Surface
12 1/4	8 5/8	24 & 32#	4650	1650 sx	-

IN ABOVE SPACE DESCRIBE PROPOSED PROGRAM; IF PROPOSAL IS TO DEEPEN OR PLUG BACK, GIVE DATA ON PRESENT PRODUCTIVE ZONE AND PROPOSED NEW PRODUCTIVE ZONE. GIVE BLOWOUT PREVENTER PROGRAM, IF ANY.

I hereby certify that the information above is true and complete to the best of my knowledge and belief.

Signed Brenda Coffman Title Agent Date 9-21-88

(This space for State Use)

Orig. Signed by  
Paul Kautz  
Geologist

APPROVED BY \_\_\_\_\_ TITLE \_\_\_\_\_ DATE SEP 23 1988

CONDITIONS OF APPROVAL, IF ANY:

Permit Expires 6 Months From Approval  
Date Unless Drilling Underway.

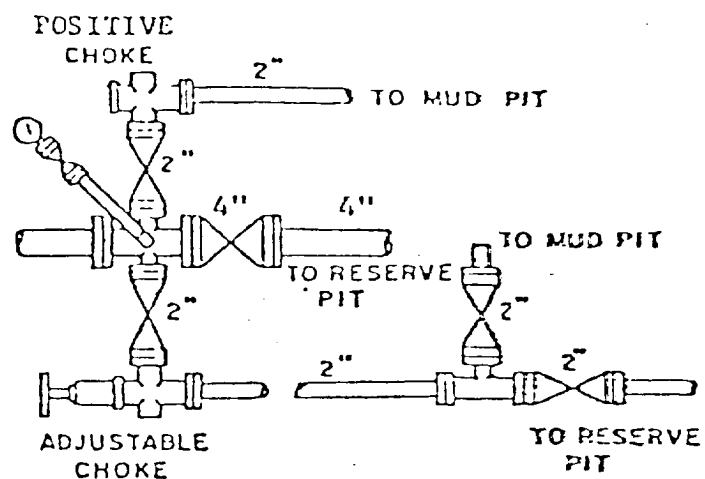
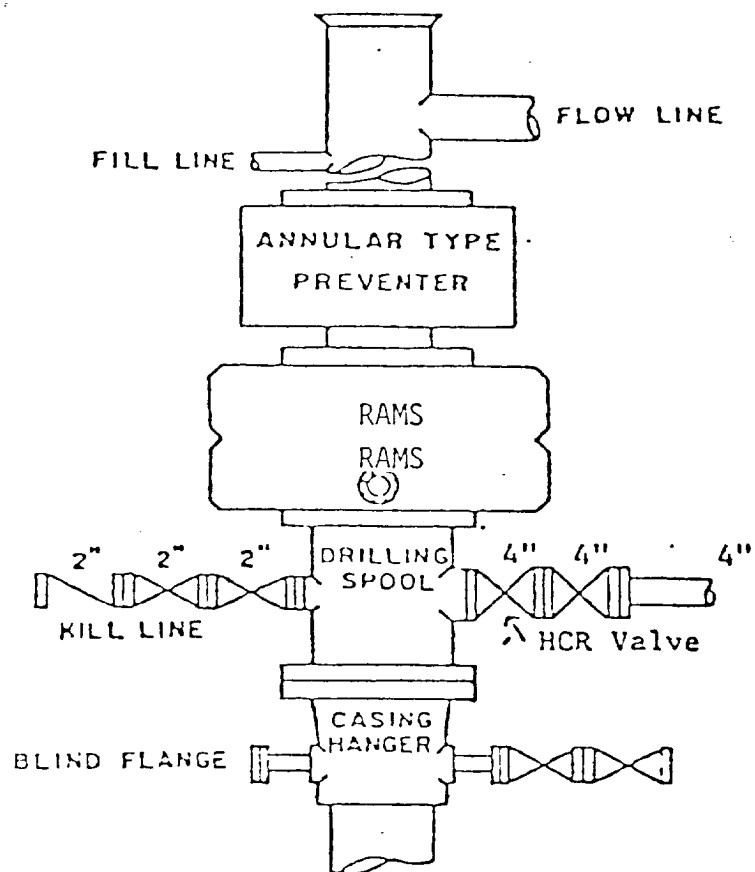

# BOP STACK

3000 PSI WORKING PRESSURE

BOP ARRANGEMENT

NEW MEXICO OIL CONSERVATION COMMISSION  
WELL LOCATION AND ACREAGE DEDICATION PLAT

Form C-102  
Supersedes C-128  
Effective 1-1-65

All distances must be from the outer boundaries of the Section

Operator Maraloy, Inc.			Lease Coy Lowe			Well No. 1		
Tract Letter E	Section 20	Township 13 South	Range 38 East	County Lea				
Actual Footage Location of Well: 1150 feet from the north line and 660 feet from the west line								
Ground Level Elev. 3828.7	Producing Formation Wolfcamp		Pool King			Dedicated Acreage: 40 Acres		

1. Outline the acreage dedicated to the subject well by colored pencil or hatchure marks on the plat below.
2. If more than one lease is dedicated to the well, outline each and identify the ownership thereof (both as to working interest and royalty).
3. If more than one lease of different ownership is dedicated to the well, have the interests of all owners been consolidated by communitization, unitization, force-pooling, etc?

☐ Yes ☐ No If answer is "yes!" type of consolidation \_\_\_\_\_

If answer is "no!" list the owners and tract descriptions which have actually been consolidated. (Use reverse side of this form if necessary.) \_\_\_\_\_

No allowable will be assigned to the well until all interests have been consolidated (by communitization, unitization, forced-pooling, or otherwise) or until a non-standard unit, eliminating such interests, has been approved by the Commission.

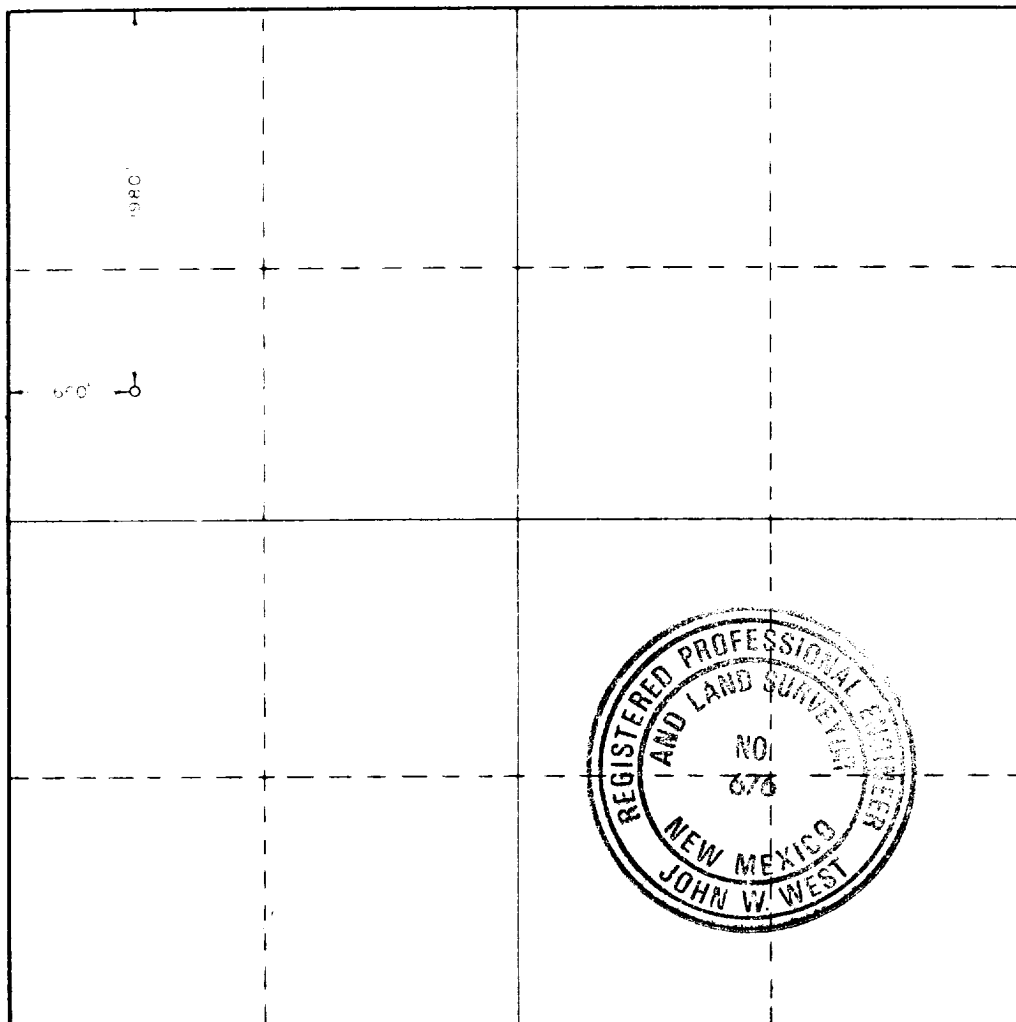

CERTIFICATION

I hereby certify that the information contained herein is true and complete to the best of my knowledge and belief.

*Brenda Coffman*

Name

Brenda Coffman

Position

Agent

Company

Maraloy, Inc.

Date

September 21, 1988

I hereby certify that the well location shown on this plat was plotted from field notes of actual surveys made by me or under my supervision, and that the same is true and correct to the best of my knowledge and belief.

Date Surveyed

September 7, 1988

Registered Professional Engineer and/or Land Surveyor

*John W. West*

Certificate No. JOHN W. WEST, 676  
RONALD J. EIDSON, 3239

330 660 990 1320 1650 1980 2310 2640 2000 1500 1000 500 0

68-9-6 8221  
173

RECEIVED  
SEP 22 1988  
OCD  
HOBBS OFFICE



**LTR**



**Job separation sheet**



**WRS COMPLETION REPORT**REISSUES  
PI# 30-T-0005 03/13/89 SEC 20 TWP 13S RGE 38E  
30-025-30477-0000 PAGE 1NMEX LEA \* 1980FNL 660FWL SEC SW NW  
STATE COUNTY FOOTAGE SPOT  
MARALO INC  
OPERATOR D D  
1 LOWE COY WELL CLASS INIT FINWELL NO. LEASE NAME  
3845KB 3829GR KING  
OPER ELEV FIELD/POOL/AREA  
API 30-025-30477-0000LEASE TYPE NO. PERMIT OR WELL I.D. NO.  
10/13/1988 01/27/1989 ROTARY D&A  
SPUD DATE COMP. DATE TYPE TOOL STATUS  
10000 WOLFCAMP PATTERSON DRLG 5 RIG SUB 15  
PROJ. DEPTH PROJ. FORM CONTRACTOR  
DTD 10107 FM/TD BOUGH A  
DRILLERS T.D. LOG T.D. PLUG BACK TD OLD T.D. FORM T.D.**LOCATION DESCRIPTION**

6 MI SE GLADIOLA, NM

**CASING/LINER DATA**CSG 13 3/8 @ 471 W/ 500 SACKS  
CSG 8 5/8 @ 4673 W/ 2555 SACKS  
CSG 5 1/2 @10107 W/ 275 SACKS

TYPE	FORMATION	LTH	TOP	DEPTH/SUB	BSE	DEPTH/SUB
LOG	RUSTLER		2262	1583		
LOG	YATES		3100	745		
LOG	SN ANDRS		4559	-714		
LOG	GLORIETA		6093	-2248		
LOG	TUBB		7371	-3526		
LOG	ABO		8043	-4198		
LOG	WFCMP LM		9392	-5547		
LOG	THR BROS		9824	-5979		
LOG	BOUGH A		9981	-6136		

SUBSEA MEASUREMENTS FROM KB

**CORES**CORE 1 9580- 9638 REC . FT WFCMP LM CONV D  
NO DESCRIPTION AVAILABLE**FORMATION TEST DATA**

DST 1 9594- 9638 WFCMP LM

CONTINUED IC# 300257037688

Copyrighted 1989  
Petroleum  
Information Corporation**Petroleum Information****BB** a company of  
The Dun & Bradstreet CorporationPI-WRS-GE1  
Form No 167

REISSUES SEC 20 TWP 13S RGE 38E  
PI# 30-T-0005 03/13/89 30-025-30477-0000 PAGE 2

MARALO INC  
1

LOWE COY

D D

FORMATION TEST DATA

REC 140.0 FT MUD 1500.0 CC MUD  
INIT OP 20M IFP 82 FFP 82  
FINAL OP 3H IFP 103 FFP 103 BHT 140F  
ISIP 267 1H30M FSIP 2842 6H IHP 4586 FHP 4586  
WS 5000 PPM CL  
PIPE REC - 140 FT MUD W/SLI TR OIL & FWTR  
SPL REC - 1500 CC MUD W/TR OCFWTR  
SPL CHAMBER - 12000 PPM CHL

PRODUCTION TEST DATA

PTS 200BW 9HRS  
WFCMP LM PERF W/ 15/IT 9637- 9701  
PERF 9637- 9701  
ACID 9637- 9701 6200GALS  
15%  
SQZD W/ 150S 9637- 9701  
RE-SQZ W/50 SX  
DOC  
BRPG @ 9696

PTS 48BW 2HRS  
WFCMP LM PERF W/ 15/IT 9637- 9689  
PERF 9637- 9689  
ACID 9637- 9689 3000GALS  
15%  
SQZD W/ 50S 9637- 9689  
SQZD W/50 SX + 5000 GALS INJECTROL  
DOC & LEAKED  
RE-SQZ W/75 SX & DOC

PTS 42BW 4HRS  
WFCMP LM PERF W/ 22/IT 9679- 9688  
PERF 9679- 9688  
BRPG @ 9600 9679- 9688

LOGS AND SURVEYS /INTERVAL,TYPE/

LOGS DILL SONL ML  
LOGS LDT

CONTINUED



REISSUES SEC 20 TWP 13S RGE 38E  
PI# 30-T-0005 03/13/89 30-025-30477-0000 PAGE 3

MARALO INC  
1

LOWE COY

D D

-----  
DRILLING PROGRESS DETAILS  
-----

MARALO INC  
BOX 832  
MIDLAND, TX 79702  
915-684-7441  
09/22 LOC/1988/  
10/19 DRLG, 4235  
10/25 DRLG 6900  
11/02 DRLG 9606  
11/08 10100 TD, CIRC  
11/17 10107 TD, SI WOO  
01/30 10107 TD, PB 9696, WO D&A PROCEDURES  
02/08 RIG REL 11/10/88  
10107 TD  
COMP 1/27/89, D&A  
ONE CORE, ONE DST RPTD  
03/09 REISSUED TO CORRECT FM @ TD, COMP DATE, KB  
ELEV, RIG SUB & ADD CSGS, PROD TESTS, LOG  
TOPS, LOGS RUN, CORE, DST & CORES STMT  
REPLACEMENT FOR CT ISSUED 2/13/89