

DISTRICT I
1625 N. French Dr., Hobbs, NM 88240

State of New Mexico
Energy, Minerals and Natural Resources Department

Form C-101
Revised March 17, 1999
Instructions on back
Submit to appropriate District Office

DISTRICT II
811 South First, Artesia, NM 88210

OIL CONSERVATION DIVISION

State Lease - 6 Copies
Fee Lease - 5 Copies

DISTRICT III
1000 Rio Brazos Rd., Aztec, NM 87410

PO BOX 2088
Santa Fe, NM 87504-2088

DISTRICT IV
2040 South Pacheco, Santa Re, NM 8750:

☐ AMENDED REPORT

APPLICATION FOR PERMIT TO DRILL, RE-ENTER, DEEPEN, PLUGBACK, OR ADD A ZONE

¹ Operator Name and Address Yates Petroleum Corporation 105 South Fourth Street Artesia, New Mexico 88210		² OGRID Number 025575
		³ API Number 30-025-35761
⁴ Property Code 29060	⁵ Property Name Mocha State Unit	⁶ Well No. 1

⁷ Surface Location

UL or lot no.	Section	Township	Range	Lot Idn	Feet from the	North/South Line	Feet from the	East/West Line	County
C	2	13S	34E		1100'	North	1980'	West	Lea

⁸ Proposed Bottom Hole Location If Different From Surface

UL or lot no.	Section	Township	Range	Lot Idn	Feet from the	North/South Line	Feet from the	East/West Line	County
⁹ Proposed Pool 1 Wildcat Mississippian					¹⁰ Proposed Pool 2				

¹¹ Work Type Code N	¹² Well Type Code G	¹³ Cable/Rotary R	¹⁴ Lease Type Code P	¹⁵ Ground Level Elevation 4144'
¹⁶ Multiple N	¹⁷ Proposed Depth 12,800	¹⁸ Formation Mississippian	¹⁹ Contractor Not Determined	²⁰ Spud Date ASAP

²¹ Proposed Casing and Cement Program

Hole Size	Casing Size	Casing weight/feet	Setting Depth	Sacks of Cement	Estimated TOC
14 3/4"	11 3/4"	42#	400'	400 sx	Surface
11"	8 5/8"	32#	4300'	1400 sx	Surface
7 7/8"	5 1/2"	17# & 20#	12,800	700 sx	TOC - 8900'

²² Describe the proposed program. If this application is to DEEPEN or PLUG BACK give the data on the present productive zone and proposed new productive zone. Describe the blowout prevention program, if any. Use additional sheets if necessary.

Yates Petroleum Corporation proposes to drill and test the Mississippian and intermediate formations. Approximately 400' of surface casing will be set and cement circulated. Intermediate casing will be set at 4300' and cement circulated to surface. If commercial, production casing will be run and cemented, will perforate and stimulate as needed for production.

MUD PROGRAM: 0-400' FWGel; 400-4300' Cut Brine to Brine; 4300-11700' Cut Brine; 11700'-TD Salt Gel/Starch/Driscap.

BOPE PROGRAM: A 5000# BOPE will be installed on the 8 5/8" casing and tested daily.

²³ I hereby certify that the information given above is true and complete to the best of my knowledge and belief.

Signature:

Clifton R. May

Printed name:

Clifton R. May

Title:

Regulatory Agent

Date:

11/13/01

Phone:

(505) 748-1471

OIL CONSERVATION DIVISION

Approved by:

Title:

Approval Date:

Conditions of Approval

Attached ☐

Expiration Date:

Permit Expires 1 Year From Approval
Date Unless Drilling Underway

DISTRICT I
1625 N. French Dr., Hobbs, NM 88240

DISTRICT II
811 South First, Artesia, NM 88210

DISTRICT III
1000 Rio Brazos Rd., Aztec, NM 87410

DISTRICT IV
2040 South Pacheco, Santa Fe, NM 87505

State of New Mexico
Energy, Minerals and Natural Resources Department

Form C-102
Revised March 17, 1999
Instruction on back
Submit to Appropriate District Office
State Lease - 4 Copies
Fee Lease - 3 Copies

OIL CONSERVATION DIVISION
P.O. Box 2088
Santa Fe, New Mexico 87504-2088

☐ AMENDED REPORT

WELL LOCATION AND ACREAGE DEDICATION PLAT

API Number 30-025-35761	Pool Code ↪	Pool Name Wildcat Mississippian
Property Code 29060	Property Name MOCHA STATE UNIT	Well Number 1
OGRID No. 025575	Operator Name YATES PETROLEUM CORPORATION	Elevation 4144

Surface Location

UL or lot No.	Section	Township	Range	Lot Idn	Feet from the	North/South line	Feet from the	East/West line	County
C	2	13S	34E		1100	NORTH	1980	WEST	LEA

Bottom Hole Location If Different From Surface

UL or lot No.	Section	Township	Range	Lot Idn	Feet from the	North/South line	Feet from the	East/West line	County
Dedicated Acres 320	Joint or Infill	Consolidation Code	Order No.						

NO ALLOWABLE WILL BE ASSIGNED TO THIS COMPLETION UNTIL ALL INTERESTS HAVE BEEN CONSOLIDATED
OR A NON-STANDARD UNIT HAS BEEN APPROVED BY THE DIVISION

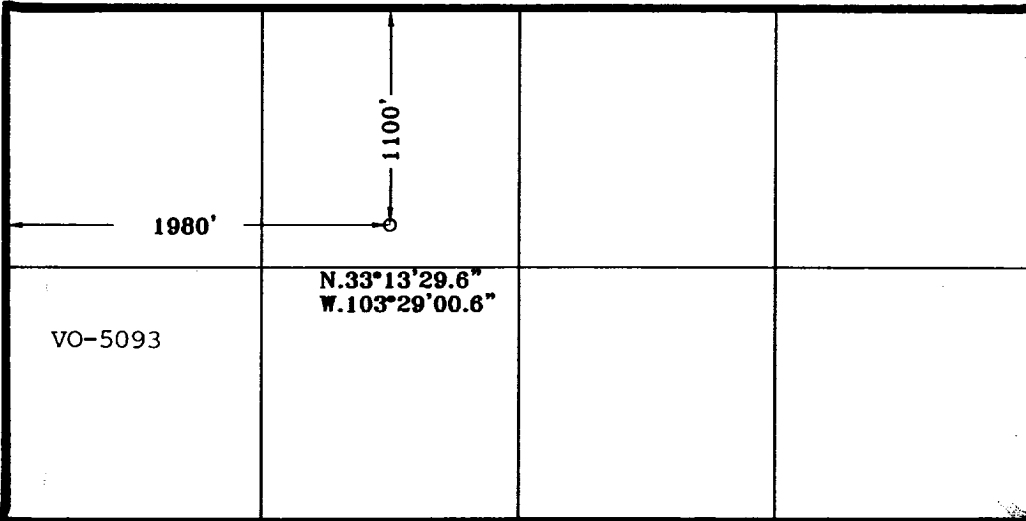
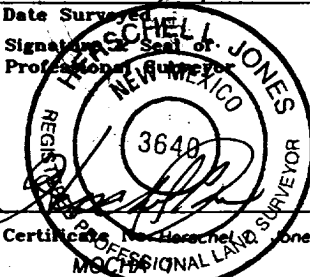
	OPERATOR CERTIFICATION I hereby certify the the information contained herein is true and complete to the best of my knowledge and belief. Clifton R. May Signature Clifton R. May Printed Name Regulatory Agent Title November 13, 2001 Date
VO-5093 N.33°13'29.6" W.103°29'00.6"	SURVEYOR CERTIFICATION I hereby certify that the well location shown on this plat was plotted from field notes of actual surveys made by me or under my supervision, and that the same is true and correct to the best of my belief. 11/12/2001 Date Surveyed Signature and Seal of Professional Surveyor  Certificate No. HSC-000001 Jones RLS 3640 MOCHA STATE UNIT GENERAL SURVEYING COMPANY



Yates Petroleum Corporation

BOP-4

Typical 5,000 psi Pressure System Schematic Annular with Double Ram Preventer Stack

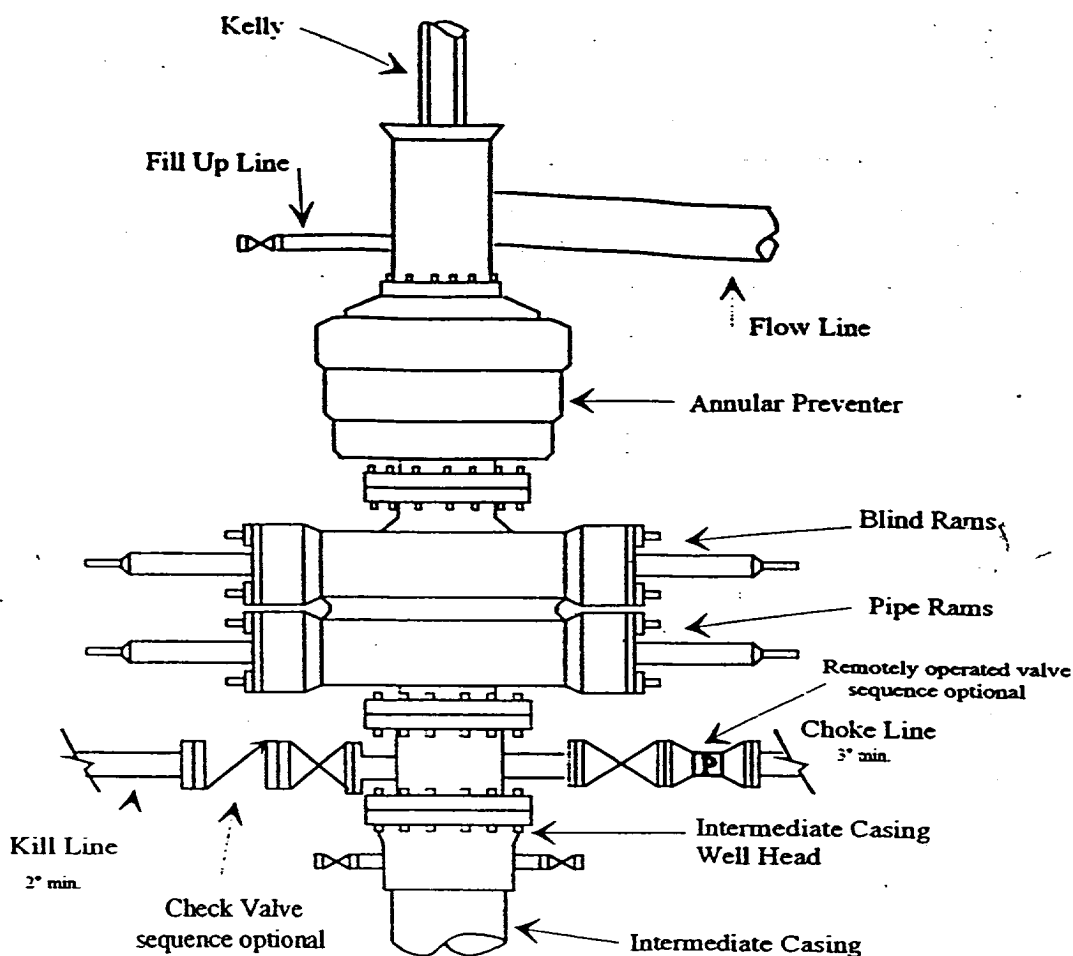

Typical 5,000 psi choke manifold assembly with at least these minimum features

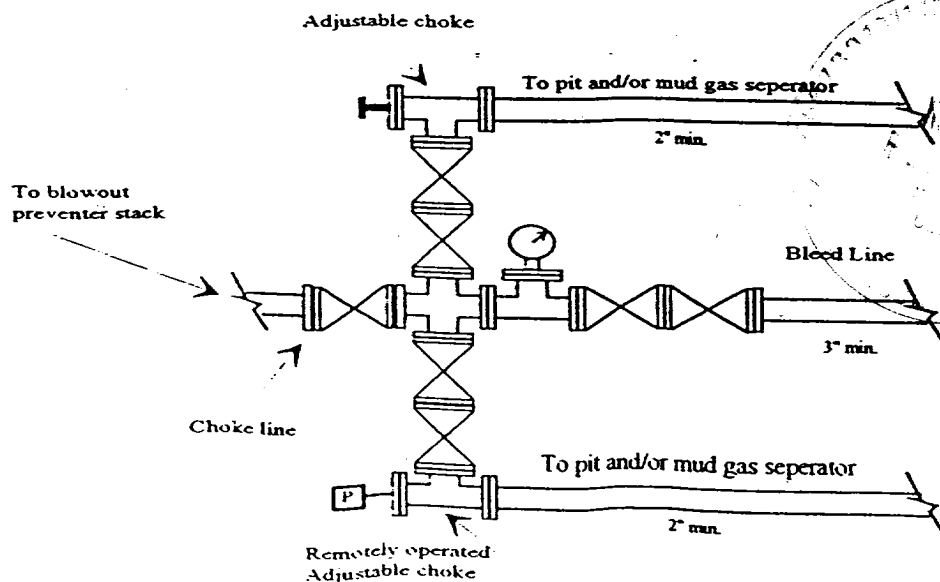

ELF 8/5/02
ABOVE DATE DOES NOT
INDICATE WHEN
CONFIDENTIAL LOGS
WILL BE RELEASED