

District I
1625 N. French Dr., Hobbs, NM 88240
District II
1301 W. Grand Avenue, Artesia, NM 88210
District III
1000 Rio Brazos Road, Aztec, NM 87410
District IV
1220 S. St. Francis Dr., Santa Fe, NM 87505

State of New Mexico
Energy Minerals and Natural Resources

Form C-101
Revised March 17, 1999

Oil Conservation Division
1220 South St. Francis Dr.
Santa Fe, NM 87505

Submit to appropriate District Office
State Lease - 6 Copies
Fee Lease - 5 Copies

AMENDED REPORT

APPLICATION FOR PERMIT TO DRILL, RE-ENTER, DEEPEN, PLUGBACK, OR ADD A ZONE

¹ Operator Name and Address Ricks Exploration, Inc. 110 W. Louisiana, Suite 410 Midland, TX 79701		² OGRID Number 168489
		³ API Number 30 -025-35985
³ Property Code 25306	⁵ Property Name Burrus	⁶ Well No. 5

⁷ Surface Location

UL or lot no.	Section	Township	Range	Lot Idn	Feet from the	North/South line	Feet from the	East/West line	County
B	27	12S	38E		330	NORTH	2000	EAST	LEA

⁸ Proposed Bottom Hole Location If Different From Surface

UL or lot no.	Section	Township	Range	Lot Idn	Feet from the	North/South line	Feet from the	East/West line	County

⁹ Proposed Pool 1

¹⁰ Proposed Pool 2

¹¹ Work Type Code N	¹² Well Type Code O/ G	¹³ Cable/Rotary R	¹⁴ Lease Type Code P	¹⁵ Ground Level Elevation 3797
¹⁶ Multiple	¹⁷ Proposed Depth 9300	¹⁸ Formation WOLFCAMP	¹⁹ Contractor N/A	²⁰ Spud Date ASAP

²¹ Proposed Casing and Cement Program

Hole Size	Casing Size	Casing weight/foot	Setting Depth	Sacks of Cement	Estimated TOC
25"	20		40'		Surf
17-1/2"	13-3/8"	48#	400'	350	Surf
12-1/4"			2500'		
11"	8-5/8"	32#	4500'	1500	1500
7-7/8"	5-1/2"	17#	9300'	800	4000

²² Describe the proposed program. If this application is to DEEPEN or PLUG BACK, give the data on the present productive zone and proposed new productive zone.

Describe the blowout prevention program, if any. Use additional sheets if necessary.

- Drill 25" hole to 40'. Set 40' of 20" conductor pipe & redi-mix to surface.
- Drill 17-1/2" hole w/ fresh water mud to 400'. Set 400', 13-3/8" 48# csg & cmt to surf w/ 350#x Cl C + additives.
- NU annular preventor. Test annular & csg to 1000#.
- Drill 12-1/4" hole to +/- 2500'.

Permit Expires 1 Year From Approval
Data Unless Drilling Underway

²³ I hereby certify that the information given above is true and complete to the best of my knowledge and belief.		OIL CONSERVATION DIVISION	
Signature:		Approved by: ORIGINAL SIGNED BY PAUL F. KAUTZ	
Printed name: Erick Nelson		Title: PETROLEUM ENGINEER	
Title: Operations Engineer		Approval Date: SEP 18 2002	Expiration Date:
Date: 9/11/02	Phone: 915/ 683-7443	Conditions of Approval: Attached <input type="checkbox"/>	

S
C
A

5. Drill 11" hole w/ fresh / brine water mud containing 6% oil to 4500'. Set 4500', 8-5/8" 32# csg & cmt w/ 1500 sx Cl C + additives.
6. NU 3000# BOP. Test BOP to 3000#.
7. Drill 7-7/8" hole w/ cut brine to 8500'. Mud up w/ starch & salt gel & oil @ 8500' & drill to 9300'. Set 9300' of 5-1/2" 17# csg & cmt to + / - 4000# w/ 800 sx H + additives.

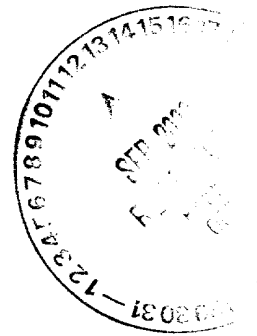

DISTRICT I
P. O. Box 1980
Hobbs, NM 88241-1980

State of New Mexico
Energy, Minerals, and Natural Resources Department

Form C-102
Revised 02-10-94

Instructions on back

DISTRICT II
P. O. Drawer DD
Artesia, NM 88211-0719

DISTRICT III
1000 Rio Brazos Rd.
Aztec, NM 87410

DISTRICT IV
P. O. Box 2088
Santa Fe, NM 87507-2088

OIL CONSERVATION DIVISION
P. O. Box 2088
Santa Fe, New Mexico 87504-2088

Submit to the Appropriate
District Office
State Lease - 4 copies
Fee Lease - 3 copies

☐ AMENDED REPORT

WELL LOCATION AND ACREAGE DEDICATION PLAT

1 API Number 30-025-35985	2 Pool Code 59890	3 Pool Name Trinity Wolfcamp
4 Property Code 25306	5 Property Name BURRUS	6 Well Number 5
7 OGRID No. 168489	8 Operator Name RICKS EXPLORATION, INC.	9 Elevation 3797'

10 SURFACE LOCATION

UL or lot no. B	Section 27	Township 12 SOUTH	Range 38 EAST, N.M.P.M.	Lot Ida	Feet from the 330'	North/South line NORTH	Feet from the 2000'	East/West line EAST	County LEA
--------------------	---------------	----------------------	----------------------------	---------	-----------------------	---------------------------	------------------------	------------------------	---------------

11 BOTTOM HOLE LOCATION IF DIFFERENT FROM SURFACE

UL or lot no.	Section	Township	Range	Lot Ida	Feet from the	North/South line	Feet from the	East/West line	County
---------------	---------	----------	-------	---------	---------------	------------------	---------------	----------------	--------

12 Dedicated Acres 40	13 Joint or Infill	14 Consolidation Code	15 Order No.
--------------------------	--------------------	-----------------------	--------------

NO ALLOWABLE WELL BE ASSIGNED TO THIS COMPLETION UNTIL ALL INTERESTS HAVE BEEN CONSOLIDATED OR A NON-STANDARD UNIT HAS BEEN APPROVED BY THE DIVISION

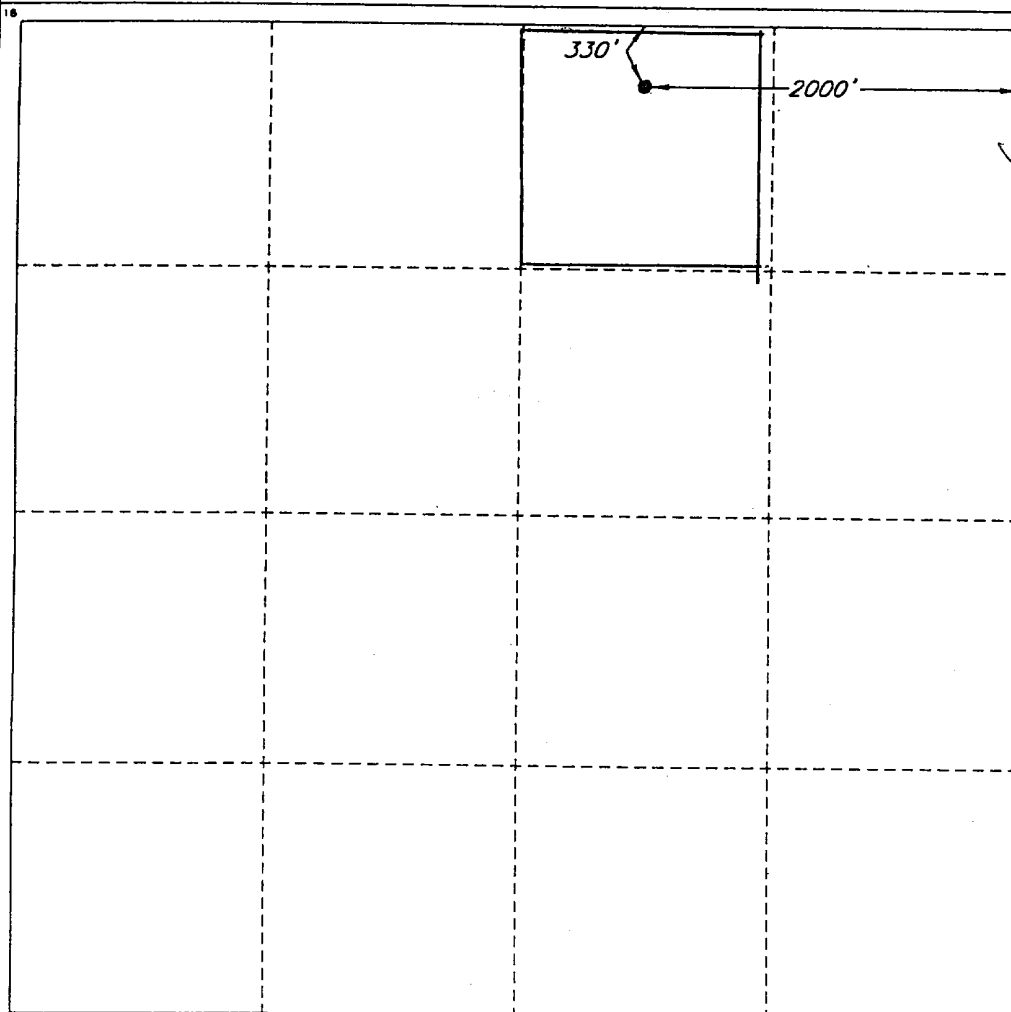

OPERATOR CERTIFICATION

I hereby certify that the information contained herein is true and complete to the best of my knowledge and belief.

Signature
Printed Name
Phyllis A. Edwards
Title
Operations Secretary
Date
9/11/02

SURVEYOR CERTIFICATION

I hereby certify that the well location shown on this plat was plotted from field notes of actual surveys made by me or under my supervision, and that the same is true and correct to the best of my belief.

Date of Survey
JANUARY 8, 2002

Signature and Seal of Professional Surveyor
V. LYNN BEZNER
NO. 7920
Certification No. 7920
V. L. BEZNER LAND R.P.S. #7920
JOB #79867 / 445 SE / J.C.P.

LOCATION & ELEVATION VERIFICATION MAP

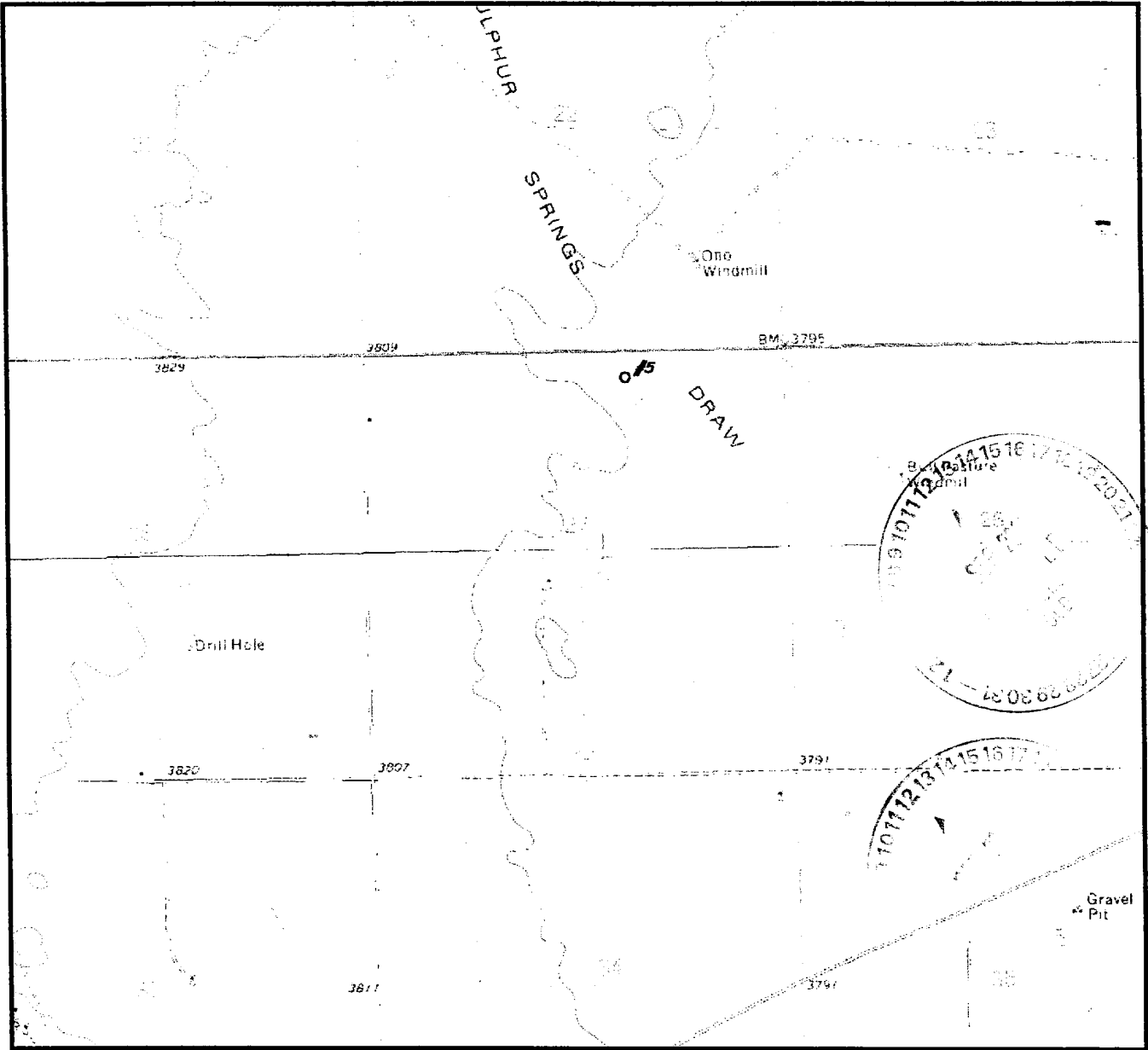

SCALE : 1" = 2000' CONTOUR INTERVAL 5'

SECTION 27 TWP 12-S RGE 38-E
SURVEY NEW MEXICO PRINCIPAL MERIDIAN
COUNTY LEA STATE NM
DESCRIPTION 330' FNL & 2000' FEL
ELEVATION 3797'

OPERATOR RICKS EXPLORATION, INC.
LEASE BURRUS #5

U.S.G.S. TOPOGRAPHIC MAP
BRONCO, NEW MEXICO - TEXAS

LAT. N 33°15'21"
LONG. W 103°04'56"



This location has been very carefully staked on the ground according to the best official survey records, maps, and other data available to us.
Review this plat and notify us immediately of any possible discrepancy.

TOPOGRAPHIC LAND SURVEYORS
Surveying & Mapping for the Oil & Gas Industry

1307 N. HOBART
PAMPA, TX. 79065
(800) 555-8388

6709 N. CLASSEN BLVD.
OKLAHOMA CITY, OK. 73116
(800) 554-3010

2903 N. BIG SPRING
MIDLAND, TX. 79705
(800) 767-1657

VICINITY MAP

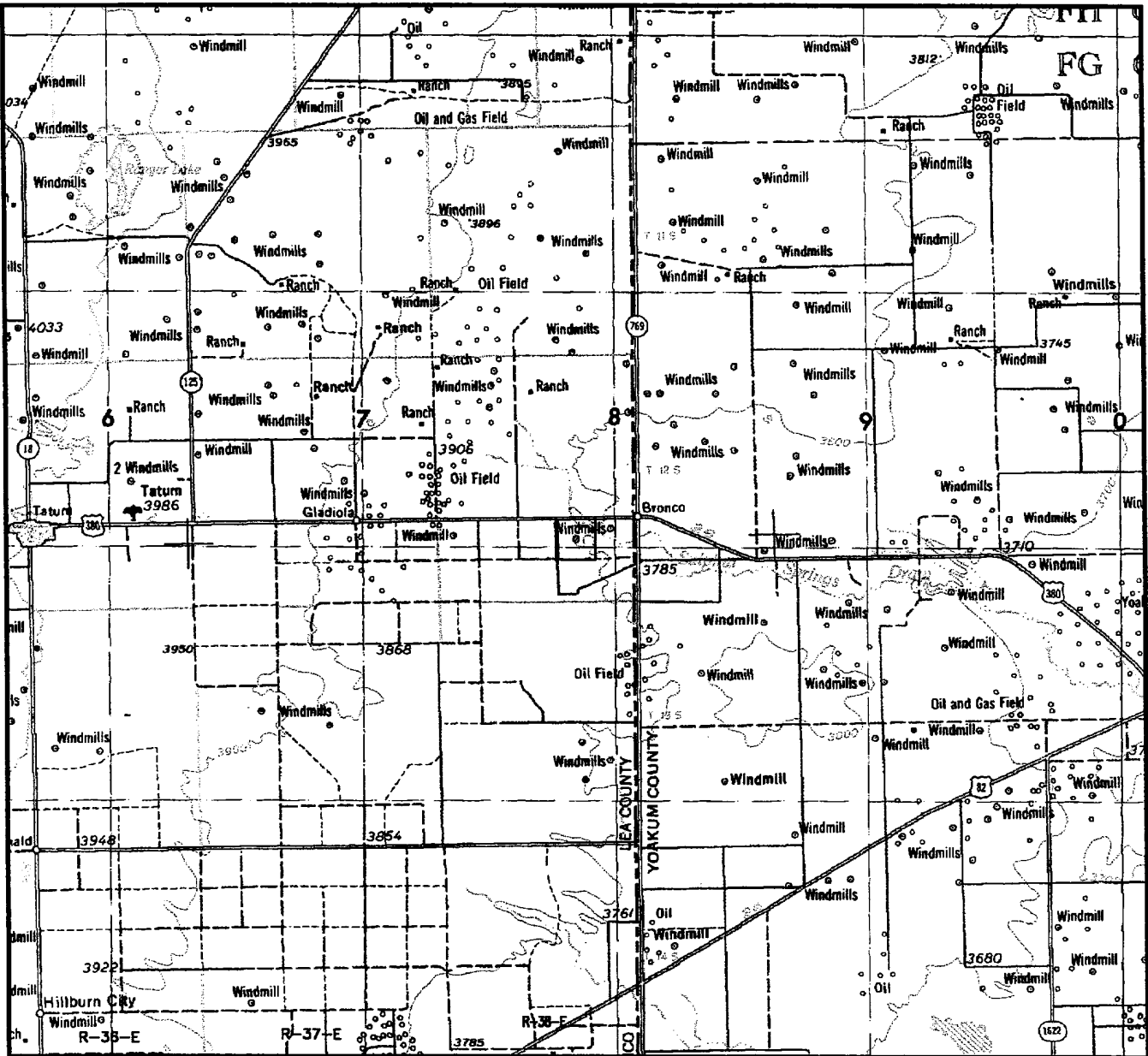

SECTION 27 TWP 12-S RGE 38-E
SURVEY NEW MEXICO PRINCIPAL MERIDIAN
COUNTY LEA STATE NM
DESCRIPTION 330' FNL & 2000' FEL

OPERATOR RICKS EXPLORATION, INC.
LEASE BURRUS #5

DISTANCE & DIRECTION FROM JCT. OF U.S. 380 &
F.M. 769 @ BRONCO, GO WEST 1.4 MILE ON U.S. 380
TO A POINT ±300' NORTH OF THE LOCATION.

This location has been very carefully staked on the ground according to the best official survey records, maps, and other data available to us.
Review this plat and notify us immediately of any possible discrepancy.

TOPOGRAPHIC LAND SURVEYORS
Surveying & Mapping for the Oil & Gas Industry

1307 N. HOBART
PAMPA, TX. 79065

6709 N. CLASSEN BLVD.
OKLAHOMA CITY, OK. 73116

2903 N. BIG SPRING
MIDLAND, TX. 79705