

District II

811 South First, Artesia, NM 88210

District III

1000 Rio Brazos Road, Aztec, NM 87410

District IV

2040 South Pacheco, Santa Fe, NM 87505

Energy Minerals and Natural Resources

Oil Conservation Division

2040 South Pacheco

Santa Fe, NM 87505

Submit to appropriate District Office

State Lease - 6 Copies

Fee Lease - 5 Copies

☐ AMENDED REPORT**APPLICATION FOR PERMIT TO DRILL, RE-ENTER, DEEPEN, PLUGBACK, OR ADD A ZONE**

¹ Operator Name and Address CONCHO OIL & GAS CORP. 110 W. LOUISIAN STE 410 MIDLAND, TX 79701		² OGRID Number 193407
³ Property Code 30462		³ API Number 30-025-35985
⁵ Property Name Burrus		⁶ Well No. 5

⁷ Surface Location

UL or lot no.	Section	Township	Range	Lot Idn	Feet from the	North/South line	Feet from the	East/West line	County
B	27	12S	38E		330	NORTH	2000	EAST	LEA

⁸ Proposed Bottom Hole Location If Different From Surface

UL or lot no.	Section	Township	Range	Lot Idn	Feet from the	North/South line	Feet from the	East/West line	County
⁹ Proposed Pool 1 Trinity Wolfcamp					¹⁰ Proposed Pool 2				

¹¹ Work Type Code N	¹² Well Type Code O / G	¹³ Cable/Rotary R	¹⁴ Lease Type Code P	¹⁵ Ground Level Elevation 3797
¹⁶ Multiple	¹⁷ Proposed Depth 9,300	¹⁸ Formation Wolfcamp	¹⁹ Contractor N/A	²⁰ Spud Date ASAP

²¹ Proposed Casing and Cement Program

Hole Size	Casing Size	Casing weight/foot	Setting Depth	Sacks of Cement	Estimated TOC
25"	20"		40'		SURF
17-1/2"	13-3/8"	48#	400'	350	SURF
11"	8-5/8"	32#	4500'	1500	1500'
7-7/8"	5-1/2"	17#	9300'	800	4000'

22 Describe the proposed program. If this application is to DEEPEN or PLUG BACK, give the data on the present productive zone and proposed new productive zone. Describe the blowout prevention program, if any. Use additional sheets if necessary.

- Drill 25" hole to 40'. Set 40' of 20" conductor pipe & redi-mix to surface.
- Drill 17-1/2" hole w/ fresh water mud to 400'. Set 400', 13-3/8", 48# csg & cmt to surface w/ 350 sx Cl C + additives.
- NU annular preventor. Test annular & csg to 1000#.
- Drill 11" hole w/ fresh / brine water mud containing 6% oil to 4500'. Set 4500', 8-5/8", 32# csg & cmt w/ 1500 sx Cl C + additives.
- NU 3000# BOP. Test BOP to 3000#.
- Drill 7-7/8" hole w/ cut brine to 8500'. Mud up w/ starch & salt gel & oil @ 8500' & drill to 9300'. Set 9300' of 5-1/2" 17# csg & cmt to ± 4000' w/ 800 sx Cl H + additives.

Permit Expires 1 Year From Approval Date Unless Drilling Underway

²³ I hereby certify that the information given above is true and complete to the best of my knowledge and belief.		OIL CONSERVATION DIVISION	
Signature: 		Approved by: ORIGINAL SIGNED BY	
Printed name: Erick Nelson		PAUL F. KAUTZ	
Title: Operations Engineer		PETROLEUM ENGINEER	
Date: 8/26/02	Phone: (915) 683-7443	Approval Date: AUG 29 2002	Expiration Date:
		Conditions of Approval:	
		Attached <input type="checkbox"/>	

504

y mp

P. O. Box 1980
Hobbs, NM 88241-1980

State of New Mexico
Energy, Minerals, and Natural Resources Department

Form O-102
Revised 02-10-94

Instructions on back

DISTRICT II

P. O. Drawer DD
Artesia, NM 88211-0719

DISTRICT III

1000 Rio Brazos Rd.
Aztec, NM 87410

DISTRICT IV

P. O. Box 2088
Santa Fe, NM 87507-2088

OIL CONSERVATION DIVISION

P. O. Box 2088
Santa Fe, New Mexico 87504-2088

Submit to the Appropriate
District Office
State Lease - 4 copies
Fee Lease - 3 copies

☐ AMENDED REPORT

WELL LOCATION AND ACREAGE DEDICATION PLAT

1 API Number 30-025-35985		2 Pool Code 59890		3 Pool Name Trinity Wolfcamp	
4 Property Code 30462		5 Property Name BURRUS			6 Well Number 5
7 OGRID No. 193407		8 Operator Name RICKS EXPLORATION, INC.			9 Elevation 3797'

10 SURFACE LOCATION

UL or lot no.	Section	Township	Range	Lot Ida	Feet from the	North/South line	Feet from the	East/West line	County
B	27	12 SOUTH	38 EAST, N.M.P.M.		330'	NORTH	2000'	EAST	LEA

11 BOTTOM HOLE LOCATION IF DIFFERENT FROM SURFACE

UL or lot no.	Section	Township	Range	Lot Ida	Feet from the	North/South line	Feet from the	East/West line	County

12 Dedicated Acres 40	13 Joint or Infill	14 Consolidation Code	15 Order No.
---------------------------------	--------------------	-----------------------	--------------

NO ALLOWABLE WELL BE ASSIGNED TO THIS COMPLETION UNTIL ALL INTERESTS HAVE BEEN CONSOLIDATED OR A NON-STANDARD UNIT HAS BEEN APPROVED BY THE DIVISION

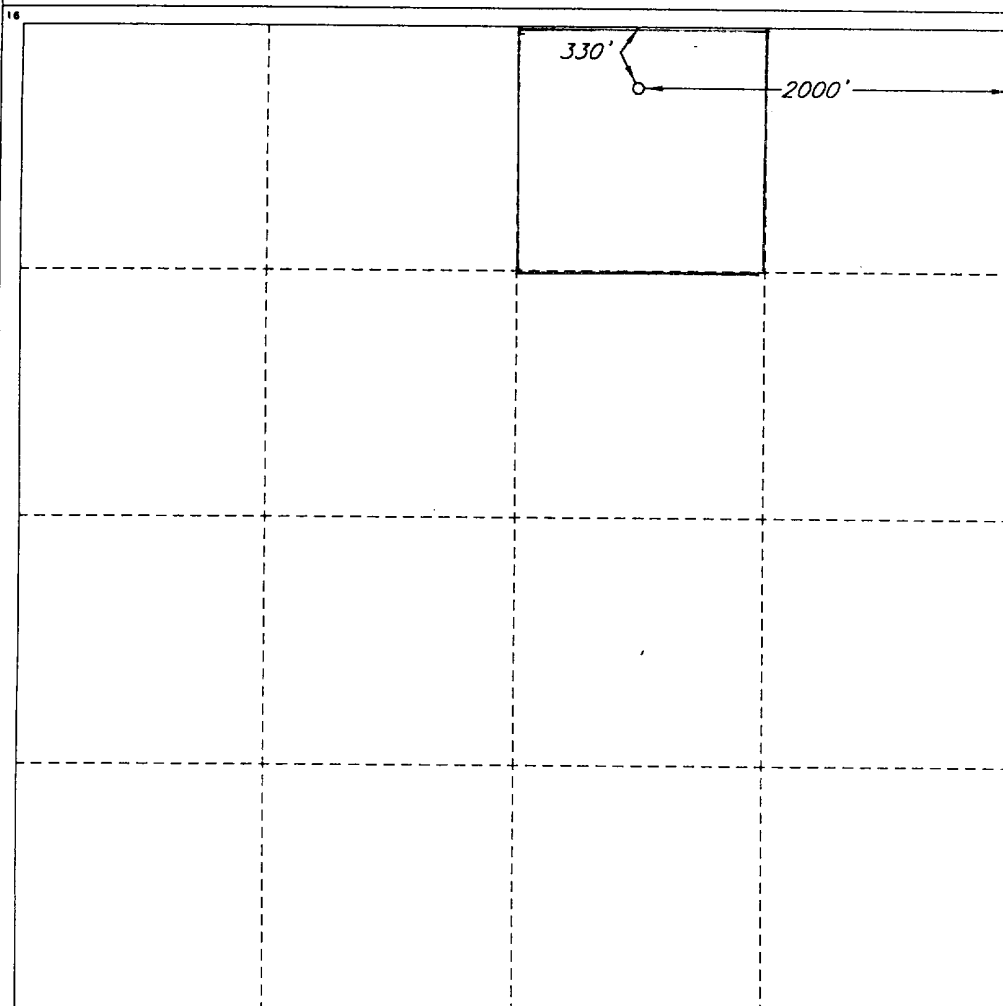

OPERATOR CERTIFICATION

I hereby certify that the information contained herein is true and complete to the best of my knowledge and belief.

Signature

Printed Name

Phyllis A. Edwards

Title

Operations Secretary

Date

8/27/02

SURVEYOR CERTIFICATION

I hereby certify that the well location shown on this plat was plotted from field notes of actual surveys made by me or under my supervision, and that the same is true and correct to the best of my belief.

Date of Survey

JANUARY 8, 2002

Signature and Seal of Professional Surveyor

Certificate No.

V. L. BEZNER R.P.S. #7920

JOB #79867 / 145 SE / J.C.P.

LOCATION & ELEVATION VERIFICATION MAP

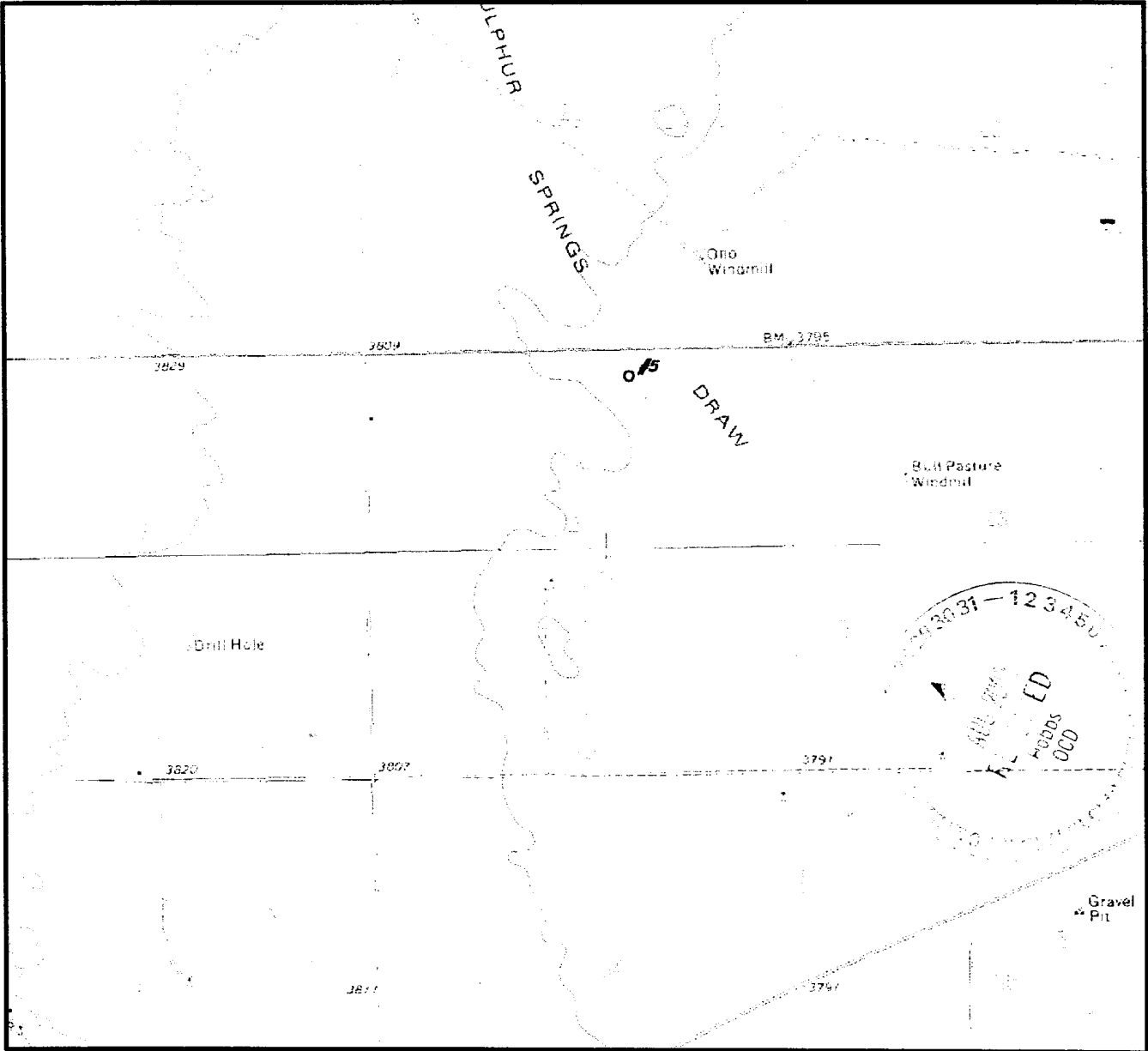

SCALE : 1" = 2000' CONTOUR INTERVAL 5'

SECTION 27 TWP 12-S RGE 38-E
SURVEY NEW MEXICO PRINCIPAL MERIDIAN
COUNTY LEA STATE NM
DESCRIPTION 330' FNL & 2000' FEL
ELEVATION 3797'

OPERATOR RICKS EXPLORATION, INC.
LEASE BURRUS #5

U.S.G.S. TOPOGRAPHIC MAP
BRONCO, NEW MEXICO - TEXAS

LAT. N 33°15'21"
LONG. W 103°04'56"



This location has been very carefully staked on the ground according to the best official survey records, maps, and other data available to us.
Review this plat and notify us immediately of any possible discrepancy.

TOPOGRAPHIC LAND SURVEYORS

Surveying & Mapping for the Oil & Gas Industry

1307 N. HOBART
PAMPA, TX. 79065
(800) 658-6300

6709 N. CLASSEN BLVD.
OKLAHOMA CITY, OK. 73116
(800) 654-3210

2903 N. BIG SPRING
MIDLAND, TX. 79705
(800) 757-1653

This location has been very carefully staked on the ground according to the best official survey records, maps, and other data available to us.

Review this plat and notify us immediately of any possible discrepancy.

2903 N. BIG SPRING
MIDLAND, TX. 79705

ELF - 11/26/92
ABOVE DATE DOES NOT
INDICATE WHEN
CONFIDENTIAL LOGS
WILL BE RELEASED