

NEW MEXICO OIL CONSERVATION COMMISSION
Santa Fe, New Mexico

HOBBS OFFICE OCC
AUG 24 1955

NOTICE OF INTENTION TO DRILL OR RECOMPLETE

Notice must be given to the District Office of the Oil Conservation Commission and approval obtained before drilling or recompletion begins. If changes in the proposed plan are considered advisable, a copy of this notice showing such changes will be returned to the sender. Submit this notice in **QUINTUPLICATE**. One copy will be returned following approval. See additional instructions in Rules and Regulations of the Commission.

DALLAS, TEXAS

AUGUST 19, 1955

(Place)

(Date)

OIL CONSERVATION COMMISSION
SANTA FE, NEW MEXICO

Gentlemen:

You are hereby notified that it is our intention to commence the (Drilling) (Recompletion) of a well to be known as

MAGNOLIA PETROLEUM COMPANY

(Company or Operator)

Mary M. Martin

(Lease)

, Well No. **1**, in **SE 1/4 SE 1/4** (Unit) The well is

located **660** feet from the **South** line and **660** feet from the

East line of Section **29**, T. **68**, R. **34E**, NMPM.

(GIVE LOCATION FROM SECTION LINE) **WILDCAT** Pool, **Roosevelt** County

If State Land the Oil and Gas Lease is No.

If patented land the owner is **Mary M. Martin**

Address **East Star Route, Elida, New Mexico**

We propose to drill well with drilling equipment as follows: **Rotary Tools**

The status of plugging bond is **On File**

Drilling Contractor **Sabine Drilling Company**
310 Commercial National Bank Building
Shreveport, Louisiana

We intend to complete this well in the **Wolfcamp** formation at an approximate depth of **9000** feet.

CASING PROGRAM

We propose to use the following strings of Casing and to cement them as indicated:

Size of Hole	Size of Casing	Weight per Foot	New or Second Hand	Depth	Sacks Cement
15"	13 3/8"	48#	New	450'	475
12 1/4"	9 5/8"	36 & 40#	New	4600'	2375
8 3/4"	7"	26 & 29#	New	9000'	750

If changes in the above plans become advisable we will notify you immediately.

ADDITIONAL INFORMATION (If recompletion give full details of proposed plan of work.)

Approved W **AUG 25 1955**, 19.....
Except as follows:

OIL CONSERVATION COMMISSION

By W. H. Martin

Title Engineer District 1

Sincerely yours,

MAGNOLIA PETROLEUM COMPANY

(Company or Operator)

By E. B. Blundell

Position **Field Superintendent**

Send Communications regarding well to

Name **Marguerite Shaffer**

Address **Box 900**

Dallas 21, Texas

"WILDCAT"
Magnolia Petroleum Company
PRODUCING DEPARTMENT

HOBBS OFFICE OCC
1955 AUG 24 PM 1:18

Location made Aug. 19th. 19 55

Mary M. Martin Well No. 1

Lea (Kermit) District

Lease NM-1642 acres 320 Sec. 29, T6S, R34E { District Township

Roosevelt County, New Mexico

Scale 1" = 1000' N S E W

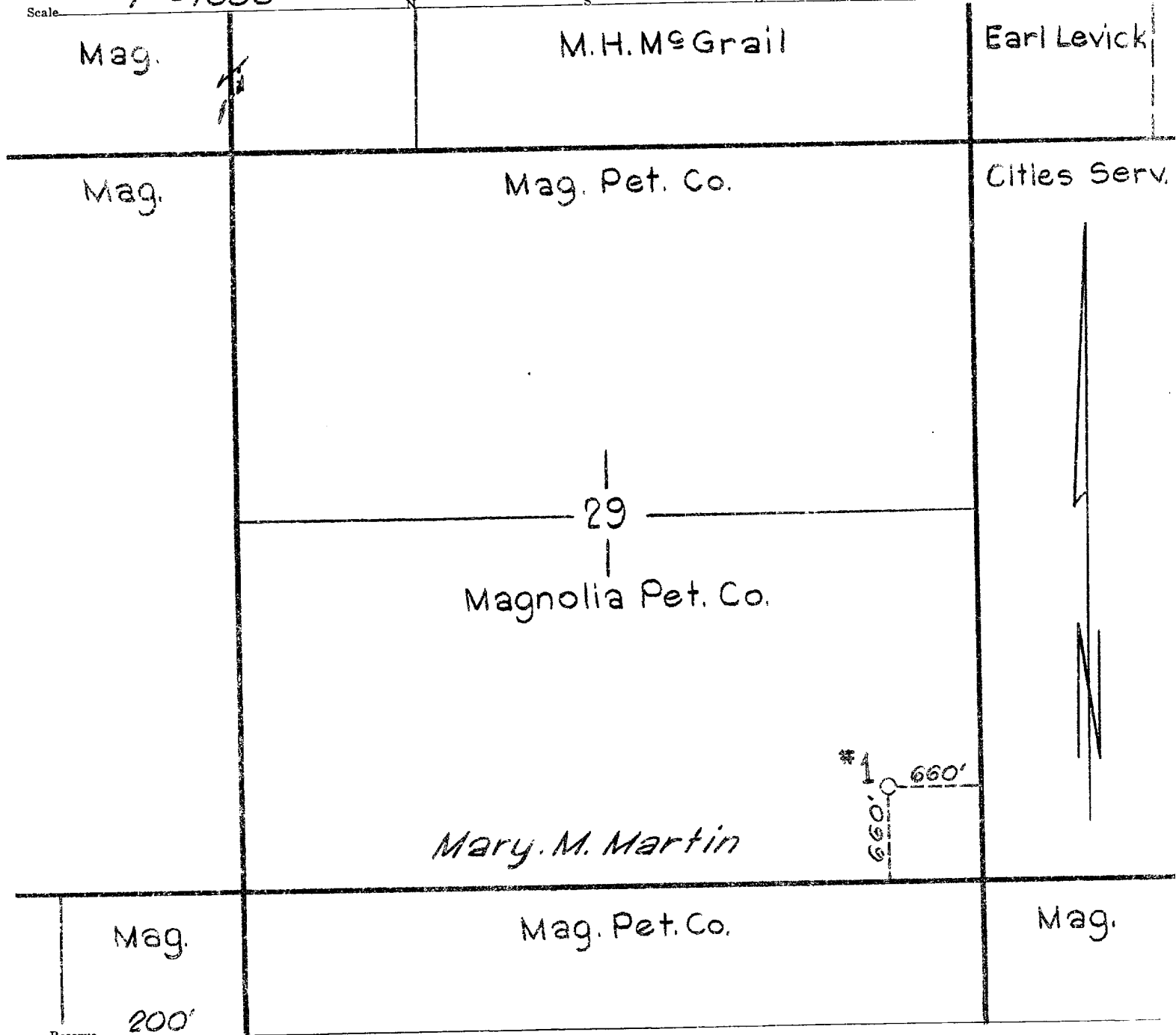

Reserve 200'
Special instructions Permit depth - 9000 ft.

Location changed on account of _____

Date work is commenced _____, 19 _____ Supt.

Location approved by _____ Plat made by A. D. Bond

Magnolia Petroleum Company
PRODUCING DEPARTMENT

Location for Well No. _____

File No. _____

11