

INCLINATION REPORT

ONE COPY MUST BE FILED WITH EACH COMPLETION REPORT

Lease Name & No. Schuman Well No. 1 Survey

[illegible]

Approved By: _____
Title: _____
Date: _____

INFORMATION AND INSTRUCTIONS AS PER
STATEWIDE RULE 54

II. INCLINATION SURVEYS

A. Requirement of

1. An inclination survey made by persons or concerns approved by the Commission shall be filed on a form prescribed by the Commission for each well drilled or deepened with rotary tools or when as a result of any operation the course of the well is changed.

a. The first shot point of such inclination survey shall be made at a depth not greater than 500 feet below the surface of the ground and succeeding shot points shall be made either at 500 foot intervals or at the nearest drill bit change thereto; but not to exceed 1000 feet apart.

2. Inclination surveys conforming to these requirements may be made either during the normal course of drilling or after the well has reached total depth. Acceptable directional surveys may be filed in lieu of inclination surveys.

3. Copies of all directional or inclination surveys, regardless of the reason for which they are run, shall be filed as a part of or in addition to the inclination surveys otherwise required by this rule.

B. Reports

1. The report form prescribed by the Commission shall require that it be signed and certified by a party having personal knowledge of the facts therein contained.

a. The report shall include a tabulation of the maximum drifts which could occur between the surface and the first shot point and each two successive shot points, assuming that all of the unsurveyed hole between any two shot points has the same inclination as that measured at the lowest shot point, and the total possible accumulative drift, assuming that all measured angles of inclination are in the same direction.

2. In addition, the report shall be accompanied by a sworn statement of the operator, or of someone acting at his direction on his behalf either, (1) that the well was not intentionally deviated from vertical whatsoever or, (2) that the well was deviated at random, with an explanation of the circumstances.

3. The report shall be filed in the District Office of the Commission for the district in which the well is drilled, by attaching one copy to each appropriate completion form for the well.

4. The Commission may require the submittal of the original charts, graphs, or discs resulting from the surveys.

NO. OF COPIES RECEIVED	
DISTRIBUTION	
SANTA FE	
FILE	
U.S.G.S.	
LAND OFFICE	
OPERATOR	

NEW MEXICO OIL COMMISSION

APR 12 10 36 AM '66

Form C-101
Revised 1-1-65

5A. Indicate Type of Lease
STATE ☐ FEE ☒

5. State Oil & Gas Lease No.

APPLICATION FOR PERMIT TO DRILL, DEEPEN, OR PLUG BACK

1a. Type of Work DRILL <input checked="" type="checkbox"/> DEEPEN <input type="checkbox"/> PLUG BACK <input type="checkbox"/>		7. Unit Agreement Name
b. Type of Well OIL WELL <input checked="" type="checkbox"/> GAS WELL <input type="checkbox"/> OTHER <input type="checkbox"/> SINGLE ZONE <input checked="" type="checkbox"/> MULTIPLE ZONE <input type="checkbox"/>		8. Farm or Lease Name Schuman
2. Name of Operator Midwest Oil Corporation		9. Well No. 1
3. Address of Operator 1500 Wilco Building Midland, Texas		10. Field and Pool, or Wildcat Undesignated
4. Location of Well UNIT LETTER M LOCATED 660 FEET FROM THE South LINE AND 660 FEET FROM THE West LINE OF SEC. 10 TWP. 7-S RGE. 32-E NMPM		12. County Roosevelt
19. Proposed Depth 4700		19A. Formation San Andres
20. Rotary or C.T. Rotary		
21. Elevations (Show whether DF, RT, etc.)	21A. Kind & Status Plug. Bond Active	21B. Drilling Contractor Cactus
22. Approx. Date Work will start Upon Approval		

23.

PROPOSED CASING AND CEMENT PROGRAM

SIZE OF HOLE	SIZE OF CASING	WEIGHT PER FOOT	SETTING DEPTH	SACKS OF CEMENT	EST. TOP
11"	8 5/8"	24#	370	300	Circ
7 7/8"	4 1/2"	9.5#	4700	350	

IN ABOVE SPACE DESCRIBE PROPOSED PROGRAM: IF PROPOSAL IS TO DEEPEN OR PLUG BACK, GIVE DATA ON PRESENT PRODUCTIVE ZONE AND PROPOSED NEW PRODUCTIVE ZONE. GIVE BLOWOUT PREVENTER PROGRAM, IF ANY.

I hereby certify that the information above is true and complete to the best of my knowledge and belief.

Signed *John Smith* Title Engineer Date April 11, 1966

(This space for State Use)

APPROVED BY *John Smith* TITLE _____ DATE _____

CONDITIONS OF APPROVAL, IF ANY:

NEW MEXICO OIL CONSERVATION COMMISSION
WELL LOCATION AND ACREAGE DEDICATION PLAT

Form 1-127
Supersedes 1-128
Effective 1-1-65

HOBBS OFFICE O.C.C.

All distances must be from the outer boundaries of the Section

Operator MIDWEST OIL CORP.		Lease SCHUMAN		Date APR 12 3 31 PM '66		Section 1	
Unit Letter M	Section 10	Range 7 SOUTH	Range 32 EAST	County ROOSEVELT			
Actual Well Location of Well: 560 feet from the SOUTH line and 560 feet from the WEST line.							
Ground Level Elev. 4464.6	Section 10		Range 7 SOUTH	Range 32 EAST	County ROOSEVELT		

1. Outline the acreage dedicated to the subject well by colored pencil or hachure marks on the plat below.
2. If more than one lease is dedicated to the well, outline each and identify the ownership thereof (both as to working interest and royalty).
3. If more than one lease of different ownership is dedicated to the well, have the interests of all owners been consolidated by communitization, unitization, force-pooling, etc?

☐ Yes ☐ No If answer is "yes," type of consolidation _____

If answer is "no," list the owners and tract descriptions which have actually been consolidated (Use reverse side of this form if necessary) _____

No allowable will be assigned to the well until all interests have been consolidated (by communitization, unitization, forced-pooling, or otherwise) or until a non-standard unit, eliminating such interests, has been approved by the Commission.

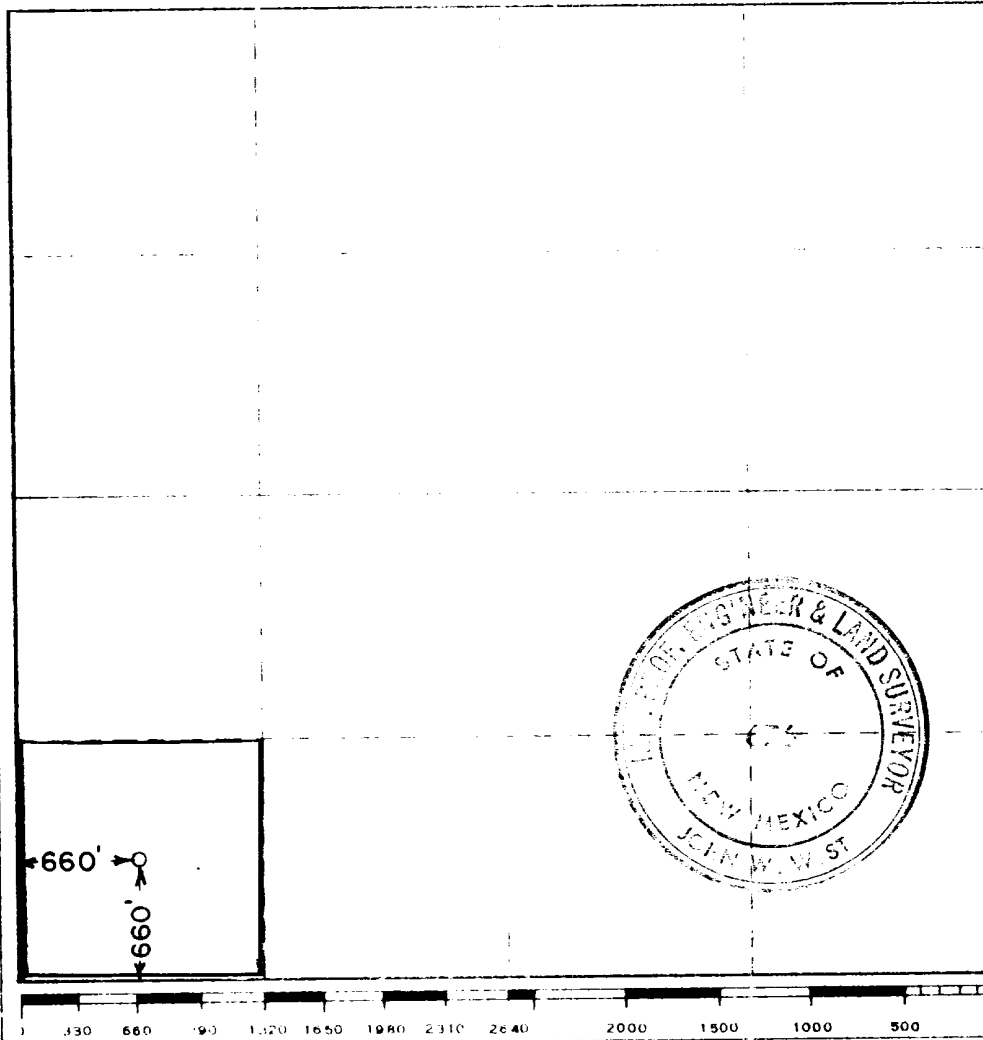

CERTIFICATION

I hereby certify that the information contained herein is true and complete to the best of my knowledge and belief.

John W. West
AGENT

MIDWEST OIL CORP.

APRIL 11, 1966

I hereby certify that the well location shown on this plat was plotted from field notes of actual surveys made by me or under my supervision, and that the same is true and correct to the best of my knowledge and belief.

Date Surveyed

APRIL 8, 1966

Registered Professional Engineer and/or Land Surveyor

John W. West
Certificate No. NM FE & LS No. 676

