

NO. OF COPIES RECEIVED	
DISTRIBUTION	
SANTA FE	
FILE	
U.S.G.S.	
LAND OFFICE	
OPERATOR	

NEW MEXICO OIL CONSERVATION COMMISSION

Form C-101
Revised 1-4-65

5A. Indicate Type of Lease	
STATE <input type="checkbox"/>	FEE <input checked="" type="checkbox"/>
5. State Oil & Gas Lease No.	

APPLICATION FOR PERMIT TO DRILL, DEEPEN, OR PLUG BACK

1a. Type of Work DRILL <input checked="" type="checkbox"/> DEEPEN <input type="checkbox"/> PLUG BACK <input type="checkbox"/>		7. Unit Agreement Name
b. Type of Well OIL WELL <input checked="" type="checkbox"/> GAS WELL <input type="checkbox"/> OTHER <input type="checkbox"/> SINGLE ZONE <input checked="" type="checkbox"/> MULTIPLE ZONE <input type="checkbox"/>		8. Farm or Lease Name METHODIST HOME FOUNDATION
2. Name of Operator PAN AMERICAN PETROLEUM CORPORATION		9. Well No. 1
3. Address of Operator BOX 68, HOBBS, N. M. 88240		10. Field and Pool, or Wildcat WILDCAT
4. Location of Well UNIT LETTER B LOCATED 660' FEET FROM THE NORTH LINE AND 1980' FEET FROM THE EAST LINE OF SEC. 30 TWP. 5-S RGE. 34-E NMPM		12. County ROOSEVELT
19. Proposed Depth 4500'		19A. Formation SAN ANDRES
20. Rotary or C.T. ROTARY		
21. Elevations (Show whether DF, RT, etc.) NYA	21A. Kind & Status Plug. Bond BLANKET-ON FILE	21B. Drilling Contractor CACTUS DRILG CORP
22. Approx. Date Work will start 11-5-70		

PROPOSED CASING AND CEMENT PROGRAM

SIZE OF HOLE	SIZE OF CASING	WEIGHT PER FOOT	SETTING DEPTH	SACKS OF CEMENT	EST. TOP
12 1/4" - 11	8 5/8"	24#	300'	circulate	
7 7/8"	4 1/2"	9.3#	4500'	250sx	

IN ABOVE SPACE DESCRIBE PROPOSED PROGRAM; IF PROPOSAL IS TO DEEPEN OR PLUG BACK, GIVE DATA ON PRESENT PRODUCTIVE ZONE AND PROPOSED NEW PRODUCTIVE ZONE. GIVE BLOWOUT PREVENTER PROGRAM, IF ANY.

I hereby certify that the information above is true and complete to the best of my knowledge and belief.

Signed _____ Title AREA SUPERINTENDENT Date DEC 4 1970

(This space for State Use)
ON 4 - NMOC - H
1 - AC J
APPROVED BY _____ TITLE _____ DATE _____

CONDITIONS OF APPROVAL, IF ANY:

1- SUSP
1- RRY

RECEIVED

1970
OH CONSERVATION COM.
COLUMBUS, OH

NEW MEXICO OIL CONSERVATION COMMISSION
WELL LOCATION AND ACREAGE DEDICATION PLAT

Form C-102
Supersedes C-128
Effective 1-1-65

All distances must be from the outer boundaries of the Section

Operator PAN AMERICAN PETROLEUM CORP.			Lease METHODIST HOME FOUNDATION		Well No. 1
Unit Letter B	Section 30	Township 5 SOUTH	Range 34 EAST	County ROOSEVELT	
Actual Footage Location of Well: 660 feet from the NORTH line and 1980 feet from the EAST line					
Ground Level Elev.	Producing Formation San Andres		Pool Wildcat	Dedicated Acreage: 40 Acres	

1. Outline the acreage dedicated to the subject well by colored pencil or hatchure marks on the plat below.
2. If more than one lease is dedicated to the well, outline each and identify the ownership thereof (both as to working interest and royalty).
3. If more than one lease of different ownership is dedicated to the well, have the interests of all owners been consolidated by communitization, unitization, force-pooling, etc?

☐ Yes ☐ No If answer is "yes," type of consolidation _____

If answer is "no," list the owners and tract descriptions which have actually been consolidated. (Use reverse side of this form if necessary.) _____

No allowable will be assigned to the well until all interests have been consolidated (by communitization, unitization, forced-pooling, or otherwise) or until a non-standard unit, eliminating such interests, has been approved by the Commission.

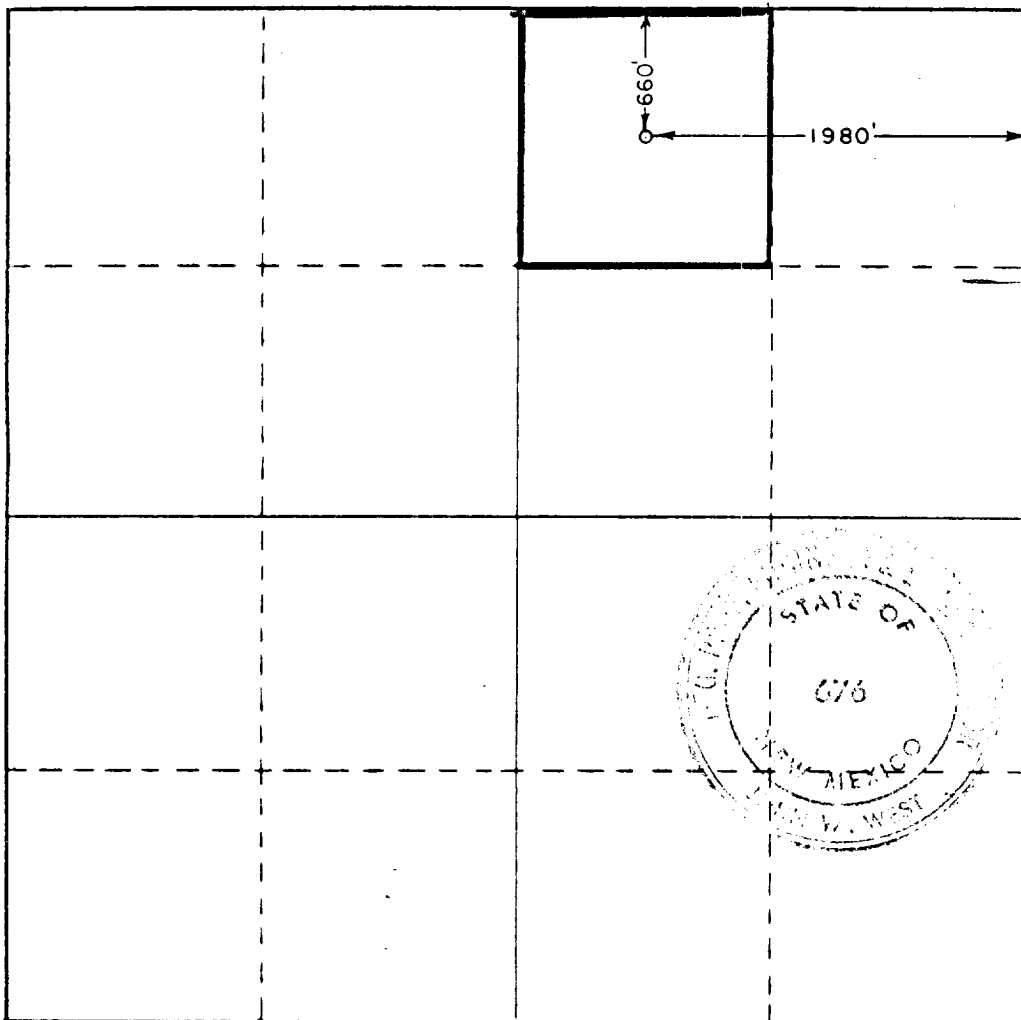

CERTIFICATION

I hereby certify that the information contained herein is true and complete to the best of my knowledge and belief.

Name _____

Position _____

Area Superintendent

Company _____

Pan American Petroleum Corp.

Date _____

December 3, 1970

I hereby certify that the well location shown on this plat was plotted from field notes of actual surveys made by me or under my supervision, and that the same is true and correct to the best of my knowledge and belief.

Date Surveyed _____

DECEMBER 1, 1970

Registered Professional Engineer
and/or Land Surveyor

John W. West

Certificate No. _____

676

0 330 660 990 1320 1650 1980 2310 2640 2970 3300 3630 3960 4290 4620 4950 5280 5610 5940 6270 6600

RECEIVED

JUL 1 1970

OIL CONSERVATION COMM.
HOUSTON, TEX.

11