

NO. OF COPIES RECEIVED	
DISTRIBUTION	
SANTA FE	
FILE	
U.S.G.S.	
LAND OFFICE	
OPERATOR	

# NEW MEXICO OIL CONSERVATION COMMISSION

Form C-101  
Revised 1-1-65

5A. Indicate Type of Lease	
STATE <input type="checkbox"/>	FEE <input checked="" type="checkbox"/>
5. State Oil & Gas Lease No.	

## APPLICATION FOR PERMIT TO DRILL, DEEPEN, OR PLUG BACK

1a. Type of Work DRILL <input checked="" type="checkbox"/> DEEPEN <input type="checkbox"/> PLUG BACK <input type="checkbox"/>		7. Unit Agreement Name	
b. Type of Well OIL WELL <input checked="" type="checkbox"/> GAS WELL <input type="checkbox"/> OTHER <input type="checkbox"/>		8. Farm or Lease Name <b>Jeffries-Rollow</b>	
2. Name of Operator <b>Robinson Bros. Drilling Co.</b>		9. Well No. <b>1</b>	
3. Address of Operator <b>c/o Oil Reports &amp; Gas Services, Inc., Box 763, Hobbs, New Mexico 88240</b>		10. Field and Pool, or Wildcat <b>Wildcat</b>	
4. Location of Well UNIT LETTER <b>P</b> LOCATED <b>660</b> FEET FROM THE <b>South</b> LINE AND <b>660</b> FEET FROM THE <b>East</b> LINE OF SEC. <b>26</b> TWP. <b>6S</b> RGE. <b>35E</b> NMPM		12. County <b>Roosevelt</b>	
19. Proposed Depth <b>7000'</b>		19A. Formation <b>Clearfork</b>	
20. Rotary or C.T. <b>Rotary</b>		21. Elevations (Show whether DF, RT, etc.) <b>4204.9 GR</b>	
21A. Kind & Status Plug. Bond <b>Blanket</b>		21B. Drilling Contractor <b>Company Tools</b>	
22. Approx. Date Work will start <b>9/8/71</b>			

## PROPOSED CASING AND CEMENT PROGRAM

SIZE OF HOLE	SIZE OF CASING	WEIGHT PER FOOT	SETTING DEPTH	SACKS OF CEMENT	EST. TOP
15	11 3/4	38#	365	350	circ
7 7/8	5 1/2	14# & 15.5#	7000	250	5560

APPROVED FOR  
FOR 90 DAYS FROM  
DRILLING COMMENCED.  
EXPIRES 12-8-71

11/3/4

IN ABOVE SPACE DESCRIBE PROPOSED PROGRAM: IF PROPOSAL IS TO DEEPEN OR PLUG BACK, GIVE DATA ON PRESENT PRODUCTIVE ZONE AND PROPOSED NEW PRODUCTIVE ZONE. GIVE BLOWOUT PREVENTER PROGRAM, IF ANY.

I hereby certify that the information above is true and complete to the best of my knowledge and belief.

Signed Wesley Holles Title Agent Date 9/7/71

APPROVED BY [Signature] TITLE SUPERVISOR DISTRICT I DATE SEP 8 1971

CONDITIONS OF APPROVAL, IF ANY:

RECEIVED

SEP - 6 1971

OIL CONSERVATION COMM.  
HOBBS, N. M.

## NEW MEXICO OIL CONSERVATION COMMISSION

Form C-102

## WELL LOCATION AND ACREAGE DEDICATION PLAT

Effective 1-1-65

All distances must be from the outer boundaries of the Section.

Operator <b>ROBINSON BROTHERS DRILLING CO.</b>		Lease <b>JEFFRIES-ROLLOW</b>		Well No. <b>1</b>
Unit Letter <b>P</b>	Section <b>26</b>	Township <b>6 SOUTH</b>	Range <b>35 EAST</b>	County <b>ROOSEVELT</b>

Actual Footage Location of Well:

<b>660</b> feet from the <b>SOUTH</b> line and <b>660</b> feet from the <b>EAST</b> line			
Ground Level Elev. <b>4204.9</b>	Producing Formation <b>Clearfork</b>	Pool <b>Wildcat</b>	Dedicated Acreage: <b>80 40</b> Acres

1. Outline the acreage dedicated to the subject well by colored pencil or hachure marks on the plat below.
2. If more than one lease is dedicated to the well, outline each and identify the ownership thereof (both as to working interest and royalty).
3. If more than one lease of different ownership is dedicated to the well, have the interests of all owners been consolidated by communitization, unitization, force-pooling, etc?

☐ Yes ☐ No If answer is "yes," type of consolidation \_\_\_\_\_

If answer is "no," list the owners and tract descriptions which have actually been consolidated. (Use reverse side of this form if necessary.) \_\_\_\_\_

No allowable will be assigned to the well until all interests have been consolidated (by communitization, unitization, forced-pooling, or otherwise) or until a non-standard unit, eliminating such interests, has been approved by the Commission.

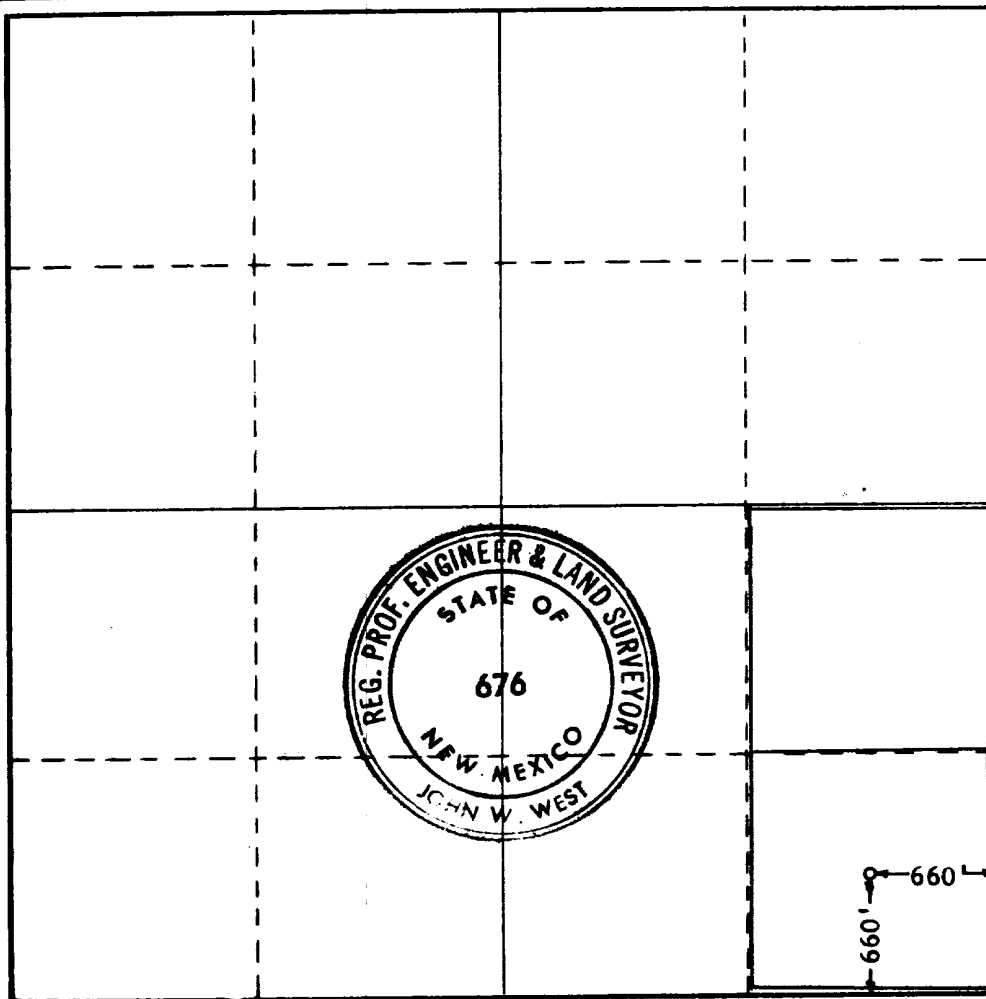

## CERTIFICATION

I hereby certify that the information contained herein is true and complete to the best of my knowledge and belief.

Name Donna Holles  
Position Agent  
Company Robinson Bros. Drilling Co.  
Date September 8, 1971

I hereby certify that the well location shown on this plat was plotted from field notes of actual surveys made by me or under my supervision, and that the same is true and correct to the best of my knowledge and belief.

Date Surveyed SEPTEMBER 4, 1971  
Registered Professional Engineer and/or Land Surveyor

John W. West  
Certificate No. 676

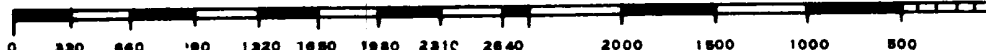

173

RECEIVED

SEP 8 1971

OIL CONSERVATION COMM.  
HOBBS, N. M.