

NO. OF COPIES RECEIVED		
DISTRIBUTION		
SANTA FE		
FILE		
U.S.G.S.		
LAND OFFICE		
OPERATOR		

# NEW MEXICO OIL CONSERVATION COMMISSION

Form C-101  
Revised 1-1-65 *32 41-22-1*

5A. Indicate Type of Lease	
STATE <input type="checkbox"/>	FEE <input type="checkbox"/>
5. State Oil & Gas Lease No.	

## APPLICATION FOR PERMIT TO DRILL, DEEPEN, OR PLUG BACK

1a. Type of Work		7. Unit Agreement Name	
b. Type of Well OIL WELL <input type="checkbox"/> GAS WELL <input checked="" type="checkbox"/> OTHER <input type="checkbox"/> DRILL <input checked="" type="checkbox"/> DEEPEN <input type="checkbox"/> PLUG BACK <input type="checkbox"/>		8. Farm or Lease Name <i>SWEARINGEN</i>	
2. Name of Operator <i>Amoco Production Company</i>		9. Well No. <i>1</i>	
3. Address of Operator <i>BOX 60, HOBBS, N. M. 88240</i>		10. Field and Pool, or Wildcat <i>UNDESIGNATED</i>	
4. Location of Well UNIT LETTER <i>J</i> LOCATED <i>1650</i> FEET FROM THE <i>SOUTH</i> LINE AND <i>1920</i> FEET FROM THE <i>EAST</i> LINE OF SEC. <i>19</i> TWP. <i>5-S</i> RGE. <i>33-E</i> NMPM		12. County <i>ROOSEVELT</i>	
19. Proposed Depth <i>7900'</i>		19A. Formation <i>PENNY-ISCO</i>	
20. Rotary or C.T. <i>ROTARY</i>		21. Elevations (Show whether DF, RT, etc.)	
21A. Kind & Status Plug Bond <i>BLANKET - ON FILE</i>		21B. Drilling Contractor <i>NVA</i>	
22. Approx. Date Work will start <i>1-7-72</i>			

23.

### PROPOSED CASING AND CEMENT PROGRAM

SIZE OF HOLE	SIZE OF CASING	WEIGHT PER FOOT	SETTING DEPTH	SACKS OF CEMENT	EST. TOP
<i>17 1/2"</i>	<i>13 3/8"</i>	<i>48 #</i>	<i>350'</i>	<i>Circulate</i>	
<i>12 1/4"</i>	<i>8 5/8"</i>	<i>24-32 #</i>	<i>3450'</i>	<i>700 Sx</i>	
<i>7 7/8"</i>	<i>5 1/2"</i>	<i>14-17 #</i>	<i>7900'</i>	<i>200 Sx</i>	

THE COMMISSION MUST BE NOTIFIED  
24 HOURS PRIOR TO RUNNING *13 3/8*  
CASING.

APPROVAL VALID  
FOR 90 DAYS UNLESS  
DRILLING COMMENCED,  
EXPIRES *4-6-72*

IN ABOVE SPACE DESCRIBE PROPOSED PROGRAM: IF PROPOSAL IS TO DEEPEN OR PLUG BACK, GIVE DATA ON PRESENT PRODUCTIVE ZONE AND PROPOSED NEW PRODUCTIVE ZONE, GIVE BLOWOUT PREVENTER PROGRAM, IF ANY.

I hereby certify that the information above is true and complete to the best of my knowledge and belief.

Signed \_\_\_\_\_ Title *AREA SUPERINTENDENT* Date *JAN 3 1972*

(This space for State Use)

APPROVED BY *[Signature]* TITLE *SUPERVISOR DISTRICT I* DATE *JAN - 6 1972*

CONDITIONS OF APPROVAL, IF ANY:

*24-4-110000-H*  
*1- DIV.*  
*1- SUSP*  
*1- 224*  
*1- 224 - BOX 1861 - MIDLAND - 79601*

RECEIVED

JAN 5 1972

OIL CONSERVATION COMM.  
HOBBBS, N. M.

NEW 1 TO OIL CONSERVATION COMMISSION  
WELL LOCATION AND ACREAGE DEDICATION PLAT

Form C-102  
Supersedes C-128  
Effective 1-1-65

All distances must be from the outer boundaries of the Section.

Operator <b>AMOCO PRODUCTION COMPANY</b>				Lease <b>SWEARINGEN</b>		Well No. <b>1</b>	
Section <b>19</b>	Township <b>5 SOUTH</b>	Range <b>33 EAST</b>	County <b>ROOSEVELT</b>				
Actual Surface Location of well: <b>1650</b> feet from the <b>SOUTH</b> line and <b>1980</b> feet from the <b>EAST</b> line							
Ground Level Elev. <b>3150</b>	Producing Formation <b>OSCO</b>		Pool <b>UNDESIGNATED</b>		Dedicated Acreage: <b>3.30</b>		

1. Outline the acreage dedicated to the subject well by colored pencil or hachure marks on the plat below.
2. If more than one lease is dedicated to the well, outline each and identify the ownership thereof (both as to working interest and royalty).
3. If more than one lease of different ownership is dedicated to the well, have the interests of all owners been consolidated by communitization, unitization, force-pooling, etc?

☐ Yes ☐ No If answer is "yes," type of consolidation \_\_\_\_\_

If answer is "no," list the owners and tract descriptions which have actually been consolidated. (Use reverse side of this form if necessary.) \_\_\_\_\_

No allowable will be assigned to the well until all interests have been consolidated (by communitization, unitization, forced-pooling, or otherwise) or until a non-standard unit, eliminating such interests, has been approved by the Commission.

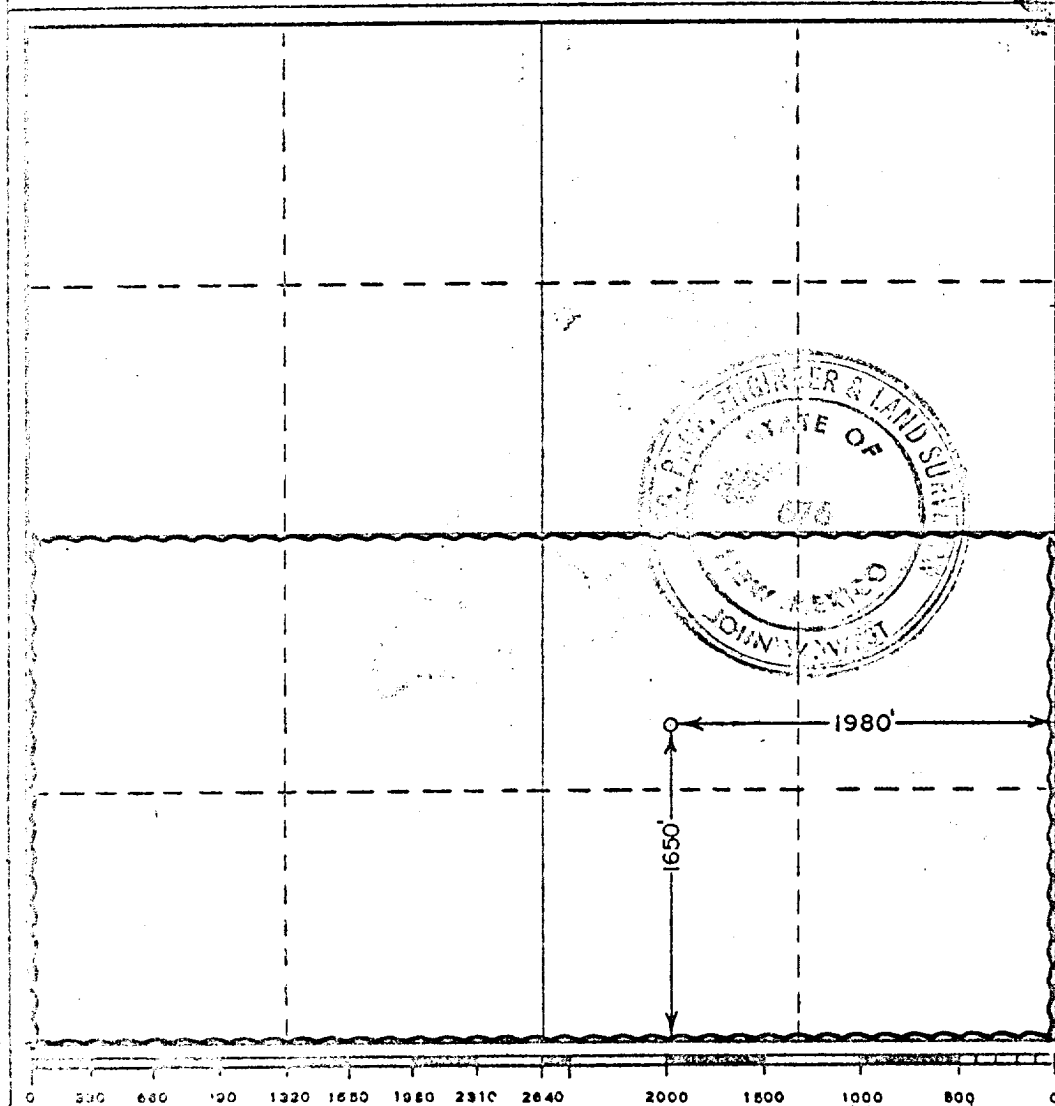

CERTIFICATION

I hereby certify that the information contained herein is true and complete to the best of my knowledge and belief.

Name \_\_\_\_\_

Position \_\_\_\_\_

**AREA SUPERINTENDENT**

Company \_\_\_\_\_

**Amoco Production Company**

Date \_\_\_\_\_

**JAN 3 1972**

I hereby certify that the well location shown on this plat was plotted from field notes of actual surveys made by me or under my supervision, and that the same is true and correct to the best of my knowledge and belief.

Date Surveyed \_\_\_\_\_

**DECEMBER 30, 1971**

Registered Professional Engineer and/or Land Surveyor

*John W. West*  
Certificate No. **676**

RECEIVED

JAN 5 1972

U.S. CONSERVATION COMM.  
HOBBS, N. M.