

NO. OF COPIES RECEIVED	
DISTRIBUTION	
SANTA FE	
FILE	
U.S.G.S.	
LAND OFFICE	
OPERATOR	

NEW MEXICO OIL CONSERVATION COMMISSION

Form 12-1
Revised 1-1-65

5A. Indicate Type

STATE ☐

5. State Oil & Gas Conservation Commission

APPLICATION FOR PERMIT TO DRILL, DEEPEN, OR PLUG BACK

1a. Type of Work

DRILL ☒

DEEPEN ☐

PLUG BACK ☐

b. Type of Well

OIL WELL ☐

GAS WELL ☒

OTHER

SINGLE ZONE ☒

MULTIPLE ZONE ☐

2. Name of Operator
Amoco Production Company

3. Address of Operator
BOX 68, HOBBS, N. M. 88240

4. Location of Well
UNIT LETTER I LOCATED 1980 FEET FROM THE SOUTH LINE
AND 660 FEET FROM THE EAST LINE OF SEC. 18 TWP. 5-S RGE. 33-E NMPM

7. Unit Agreement Name

8. Farm or Lease Name

PETERSON "C" GAS CON

9. Well No.

10. Township & Range
PETERSON PENN

12. County

ROOSEVELT

19. Proposed Depth

7900'

19A. Formation

CISCO-PENN

20. Rotary or C.T.

ROTARY

21. Elevations (Show whether DF, RT, etc.)

21A. Kind & Status Plug, Bond

BLANKET- ON FILE

21B. Drilling Contractor

CHICO DRAG CO.

22. Approx. Date Work will start

10-15-72

23.

PROPOSED CASING AND CEMENT PROGRAM

SIZE OF HOLE	SIZE OF CASING	WEIGHT PER FOOT	SETTING DEPTH	SACKS OF CEMENT	EST. TOP
12 1/4 - 11"	8 5/8"	24-32 #	2000'	CIRC	SURFACE
7 7/8"	5 1/2"	14-17 #	7900'	SUFF TO FILL 600'	
				ABOVE PAY.	

NSL-R-4415

Expires 1-13-73

IN ABOVE SPACE DESCRIBE PROPOSED PROGRAM: IF PROPOSAL IS TO DEEPEN OR PLUG BACK, GIVE DATA ON PRESENT PRODUCTIVE ZONE AND PROPOSED NEW PRODUCTIVE ZONE. GIVE BLOWOUT PREVENTER PROGRAM, IF ANY.

I hereby certify that the information above is true and complete to the best of my knowledge and belief.

Signed _____ Title AREA SUPERINTENDENT Date OCT 19 1972

(This space for State Use)

014. NMOC-C-N

1- DIV

1- SUSP

1- RRY

1- PHILLIPS- ODESSA

SUPERVISOR DISTRICT I

TITLE

DATE

OCT 13 1972

RECEIVED

11 1972

OIL CONSERVATION COMM.
HOOVER, N. M.

NEW KICO OIL COMPANY SURVEY OF LANDS
WELL LOCATION AND SURVEY DATA

All distances must be from the corner or center of the section.

AMOCO PRODUCTION CO.			PETERSON "C" Gas CCX		1
Section	Township	Range	County		
I	18	5 SOUTH	33 EAST	ROOSEVELT	
A true location of well					
1980	Section	Township	Range	County	
		SOUTH	660	EAST	
Ground Level Elev.	Producing Formation	PETERSON PENN		320	
PENN (CISCO)					

1. Outline the acreage dedicated to the subject well by colored pencil or hachure marks on the plat below.
2. If more than one lease is dedicated to the well, outline each and identify the ownership thereof (both as to working interest and royalty).
3. If more than one lease of different ownership is dedicated to the well, have the interests of all owners been consolidated by communitization, unitization, force-pooling, etc?

☒ Yes ☐ No If answer is "yes," type of consolidation _____

If answer is "no," list the owners and tract descriptions which have actually been consolidated. (Use reverse side of this form if necessary.) _____

No allowable will be assigned to the well until all interests have been consolidated (by communitization, unitization, forced-pooling, or otherwise) or until a non-standard unit, eliminating such interests, has been approved by the Commission.

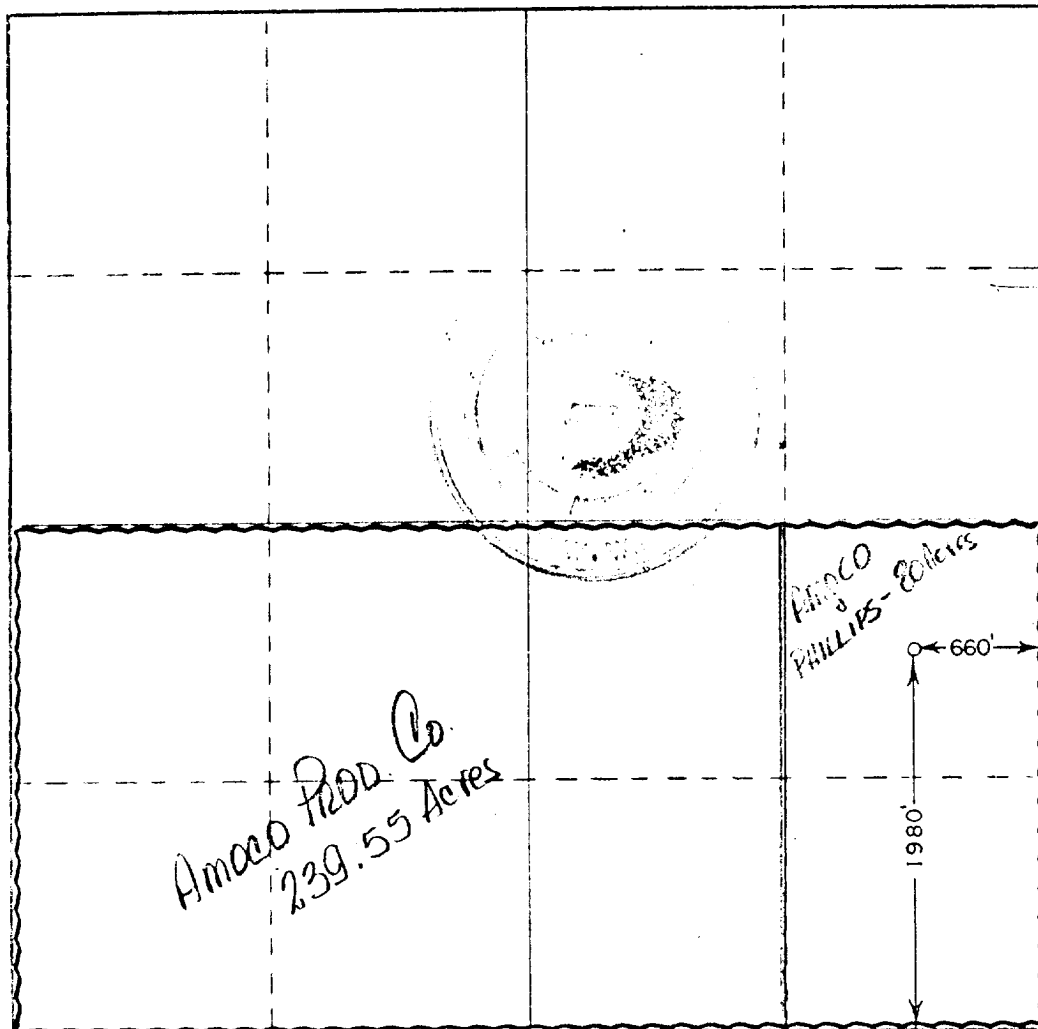

CERTIFICATION

I hereby certify that the information contained herein is true and complete to the best of my knowledge and belief.

AREA SUPERINTENDENT

Amoco Production Company

Date

OCT 12 1972

I hereby certify that the well location shown on this plat was plotted from field notes of actual surveys made by me or under my supervision, and that the same is true and correct to the best of my knowledge and belief.

Date

SEPTEMBER 12, 1972

Registered in the name of the State of Oklahoma

Certification

075

330 660 990 1320 1650 1980 2310 2640 2970 3300 3630 3960 4290 4620 4950 5280 5610 5940 6270 6600

RECEIVED

OCT 11 1972

OIL CONSERVATION COMM.
HOUSTON, TX

11