

NO. OF COPIES RECEIVED	
DISTRIBUTION	
SANTA FE	
FILE	
U.S.G.S.	
LAND OFFICE	
OPERATOR	

NEW MEXICO OIL CONSERVATION COMMISSION

31-141-21419
Form C-101
Revised 1-1-65

5A. Indicate Type of Lease	
STATE <input type="checkbox"/>	FEE <input checked="" type="checkbox"/>
5. State Oil & Gas Lease No.	

APPLICATION FOR PERMIT TO DRILL, DEEPEN, OR PLUG BACK

1a. Type of Work		7. Unit Agreement Name	
b. Type of Well OIL WELL <input checked="" type="checkbox"/> GAS WELL <input type="checkbox"/> OTHER <input type="checkbox"/>		8. Farm or Lease Name RADCLIFF	
2. Name of Operator AMOCO PRODUCTION COMPANY		9. Well No. 1	
3. Address of Operator BOX 367, ANDREWS, TEXAS 79714		10. Field and Pool, or Wildcat PETERSON PENN ASSOC	
4. Location of Well UNIT LETTER M LOCATED 554 FEET FROM THE SOUTH LINE AND 554 FEET FROM THE WEST LINE OF SEC. 17 TWP. 5-5 RGE. 33-E NMPM		11. County ROOSEVELT	
19. Proposed Depth 8000'		19A. Formation GLSD-PENN	
20. Rotary or C.T. ROTARY		21. Elevations (Show whether DF, RT, etc.) 4422.3 GL	
21A. Kind & Status Plug. Bond BLANKET-ON FILE		21B. Drilling Contractor NY17	
22. Approx. Date Work will start 12-15-75			

PROPOSED CASING AND CEMENT PROGRAM

SIZE OF HOLE	SIZE OF CASING	WEIGHT PER FOOT	SETTING DEPTH	SACKS OF CEMENT	EST. TOP
12 1/4"	8 5/8"	24#	2000'	Circulate	
7 7/8"	5 1/2"	14-17#	8000'	Supp. to fill 600' above uppermost pay.	

B-O-P PROGRAM ATTACHED.

APPROVAL VALID
FOR 30 DAYS UNLESS
REVOKED

3-3-76

IN ABOVE SPACE DESCRIBE PROPOSED PROGRAM: IF PROPOSAL IS TO DEEPEN OR PLUG BACK, GIVE DATA ON PRESENT PRODUCTIVE ZONE AND PROPOSED NEW PRODUCTIVE ZONE. GIVE BLOWOUT PREVENTER PROGRAM, IF ANY.

I hereby certify that the information above is true and complete to the best of my knowledge and belief.

Signed *Lois P. Yoakum* Title ADMINISTRATIVE ASSISTANT Date DEC 1 1975

04- NMOC-111 (This space for State Use)

1-DIV
APPROVED BY *Jerry L. Lyle* TITLE _____ DATE _____
1-5430
CONDITIONS OF APPROVAL, IF ANY:
1-REY

NEW MEXICO OIL CONSERVATION COMMISSION
WELL LOCATION AND ACREAGE DEDICATION PLAT

Form C-102
Supersedes C-128
Effective 1-1-65

All distances must be from the outer boundaries of the Section.

Operator Amoco Production Company			Lease Ratcliff		Well No. 1
Unit Letter M	Section 17	Township 5 South	Range 33 East	County Roosevelt	
Actual Footage Location of Well: 554 feet from the South line and 554 feet from the West line					
Ground Level Elev. 4422.3	Producing Formation CISCO (PENN)		Pool PETERSON PENN - ASSOC.		Dedicated Acreage: 160 Acres

1. Outline the acreage dedicated to the subject well by colored pencil or hatchure marks on the plat below.
2. If more than one lease is dedicated to the well, outline each and identify the ownership thereof (both as to working interest and royalty).
3. If more than one lease of different ownership is dedicated to the well, have the interests of all owners been consolidated by communitization, unitization, force-pooling, etc?

☐ Yes ☐ No If answer is "yes," type of consolidation _____

If answer is "no," list the owners and tract descriptions which have actually been consolidated. (Use reverse side of this form if necessary.) _____

No allowable will be assigned to the well until all interests have been consolidated (by communitization, unitization, forced-pooling, or otherwise) or until a non-standard unit, eliminating such interests, has been approved by the Commission.

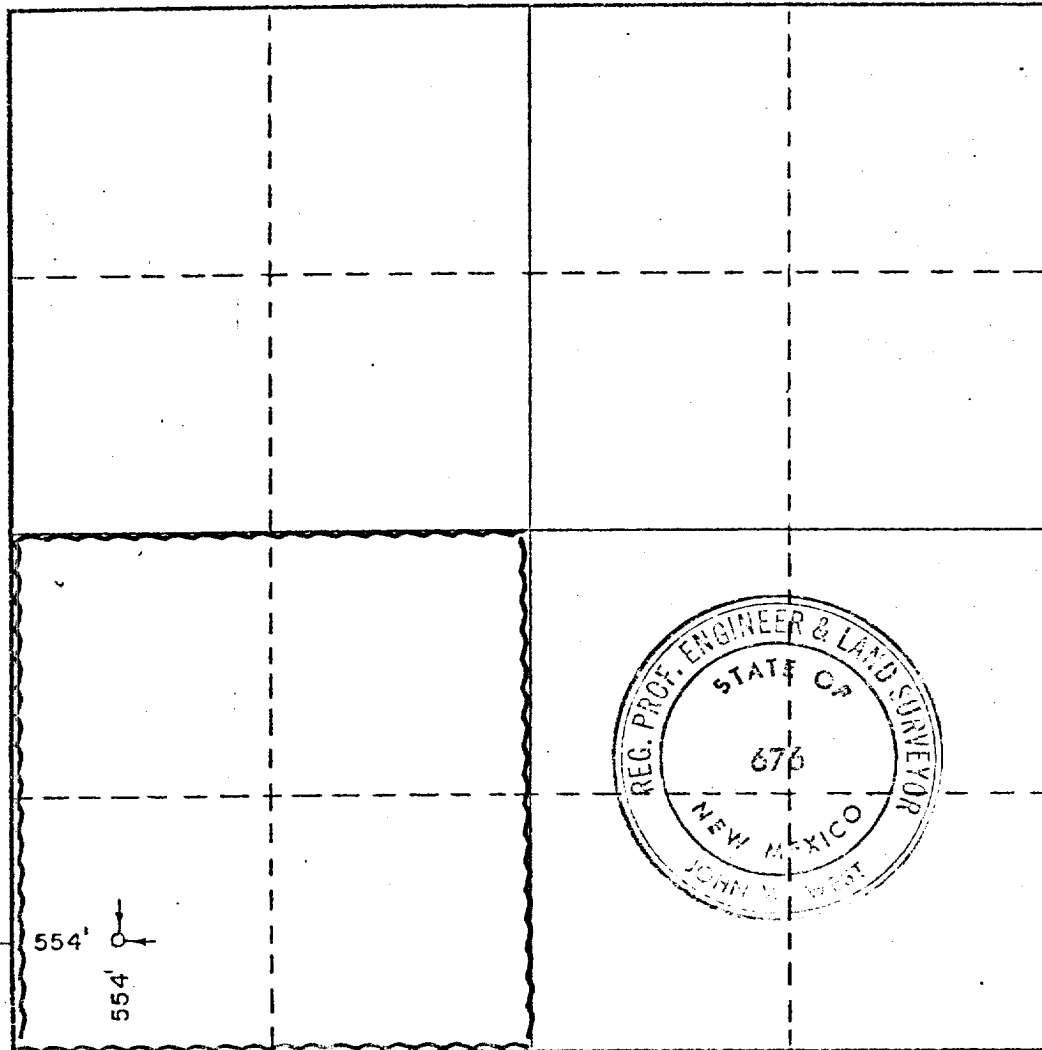

CERTIFICATION

I hereby certify that the information contained herein is true and complete to the best of my knowledge and belief.

Name
Ray Rybakum
Position
ADMINISTRATIVE ASSISTANT

Company
AMOCO PRODUCTION COMPANY.

Date
DEC 1 1975

I hereby certify that the well location shown on this plat was plotted from field notes of actual surveys made by me or under my supervision, and that the same is true and correct to the best of my knowledge and belief.

Date Surveyed
November 25, 1975

Registered Professional Engineer and/or Land Surveyor

John W. West
Certificate No. **676**

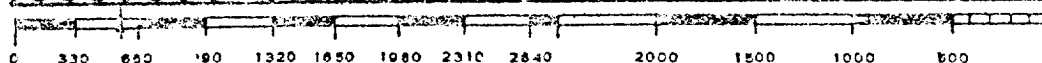

1. BLOW PREVENTERS AND MASTER VALVE TO BE FLARED AND ALL FITTINGS MUST BE IN GOOD CONDITION (MINIMUM: WP - 3000 PSI, TEST - 6000 PSI).
2. EQUIPMENT THROUGH WHICH BIT MUST PASS SHALL BE AS LARGE AS THE INSIDE DIAMETER OF CASING THAT IS BEING DRILLED THROUGH.
3. KELLY COCK REQUIRED (MINIMUM: 3000 PSI WP, 6000 PSI TEST)
4. OMSCO OR COMPARABLE SAFETY VALVE MUST BE AVAILABLE ON RIG FLOOR AT ALL TIMES WITH PROPER CONNECTION OR SUB. (MINIMUM: 3000 PSI WP, 6000 PSI TEST)

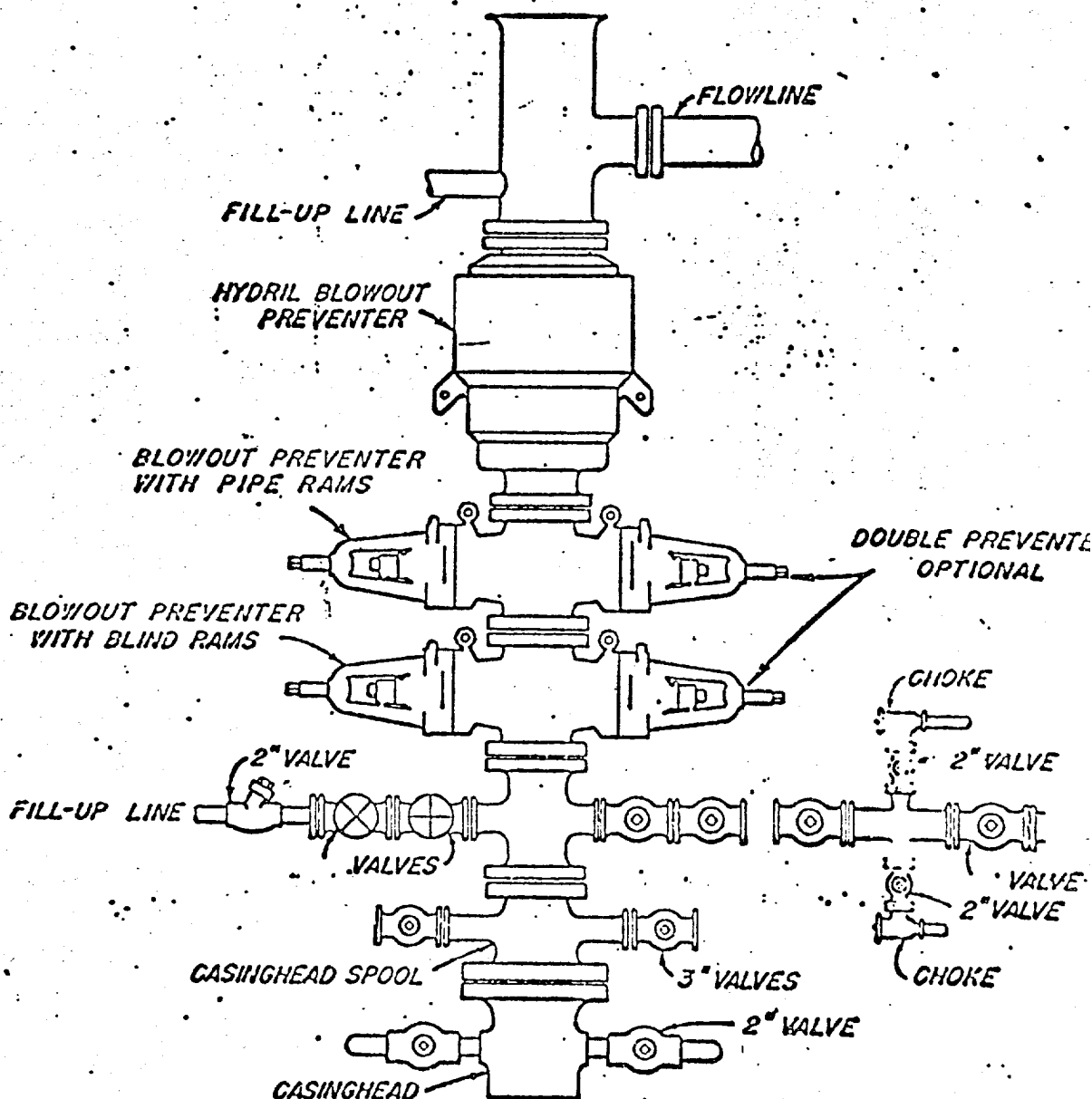

AMOCO PRODUCTION COMPANY

APRIL 13, 1973

AMOCO PRODUCTION COMPANY

RADCLIFF Well No. 1

M-17-5-33

PETERSON PENN. ASSOC

ROOSEVELT Co. N.M.