

NO. OF COPIES RECEIVED		
DISTRIBUTION		
SANTA FE		
FILE		
U.S.G.S.		
LAND OFFICE		
OPERATOR		

NEW MEXICO OIL CONSERVATION COMMISSION

Form C-101  
Revised 1-1-65

5A. Indicate Type of Lease	
STATE <input type="checkbox"/>	FEE <input checked="" type="checkbox"/>

5. State Oil & Gas Lease No.

APPLICATION FOR PERMIT TO DRILL, DEEPEN, OR PLUG BACK

1a. Type of Work		7. Unit Agreement Name	
b. Type of Well DRILL <input type="checkbox"/> DEEPEN <input type="checkbox"/> PLUG BACK <input checked="" type="checkbox"/> OIL WELL <input checked="" type="checkbox"/> GAS WELL <input type="checkbox"/> OTHER <input type="checkbox"/> SINGLE ZONE <input checked="" type="checkbox"/> MULTIPLE ZONE <input type="checkbox"/>		8. Farm or Lease Name Lambirth	
2. Name of Operator Enserch Exploration, Inc.		9. Well No. 3	
3. Address of Operator P. O. Box 4815, Midland, Texas 79701		10. Field and Pool, or Wildcat S. Peterson Pennsylvanian	
4. Location of Well UNIT LETTER <u>G</u> LOCATED <u>1980</u> FEET FROM THE <u>North</u> LINE AND <u>1980</u> FEET FROM THE <u>East</u> LINE OF SEC. <u>31</u> TWP. <u>5 S</u> RGE. <u>33 E</u> NMPM		12. County Roosevelt	
19. Proposed Depth PBD 7790'		19A. Formation Pennsylvanian	
20. Rotary or C.T. --		21. Elevations (Show whether DF, RT, etc.) 4393.5' GR	
21A. Kind & Status Plug. Bond American Ins. 5171534		21B. Drilling Contractor Devonian Well Service	
22. Approx. Date Work will start October 12, 1978			

23.

PROPOSED CASING AND CEMENT PROGRAM

SIZE OF HOLE	SIZE OF CASING	WEIGHT PER FOOT	SETTING DEPTH	SACKS OF CEMENT	EST. TOP
17-1/2"	13-3/8"	48#	377'	350 sx.	Circulated
12-1/4"	8-5/8"	24# & 32#	3297'	2000 sx.	Circulated
7-7/8"	5-1/2"	15.5#	8030'	800 sx.	6600'

The well is currently producing from the Fusselman pay section (perforations 7840', 42', 43', 44', 45', 46', 47', 48', 49'). The well will be plugged back by placing a cast iron bridge plug at 7800' and capped with 10' of cement. The Pennsylvanian zone will be perforated (7702', 03', 04', 05', 06', 07', 10', 12', 13', 15') and will be acidized with 2500 gallons of acid. A standard blowout preventer (max. 5000 psi) will be installed during the plugging and recompletion procedures.

IN ABOVE SPACE DESCRIBE PROPOSED PROGRAM: IF PROPOSAL IS TO DEEPEN OR PLUG BACK, GIVE DATA ON PRESENT PRODUCTIVE ZONE AND PROPOSED NEW PRODUCTIVE ZONE. GIVE BLOWOUT PREVENTER PROGRAM, IF ANY.

I hereby certify that the information above is true and complete to the best of my knowledge and belief.

Signed Jerry Nash Title Dist. Production Manager Date 10-11-78

(This space for State Use)

APPROVED BY John W. Runyan TITLE Geologist DATE 10-12-1978

CONDITIONS OF APPROVAL, IF ANY:

NEW MEXICO CONSERVATION COMMISSION  
WELL LOCATION AND ACREAGE DEDICATION AT

Form 1-128  
Supersedes C-128  
the five (5) 1965

All distances must be from the outer boundaries of the Section

Operator <b>Enserch Exploration Inc.</b>		Lease <b>Lambirth</b>		Area <b>3</b>	
Tract Letter <b>G</b>	Section <b>31</b>	Range <b>5 South</b>	Meridian <b>33 East</b>	County <b>Roosevelt</b>	
Actual Well Location (feet)					
<b>1980</b>		feet from the <b>North</b>		<b>1980</b> feet from the <b>East</b>	
Ground Level Elev. <b>4393.5</b>	Producing From (feet)		Foot		

1. Outline the acreage dedicated to the subject well by colored pencil or hatchure marks on the plat below.
2. If more than one lease is dedicated to the well, outline each and identify the ownership thereof (both as to working interest and royalty).
3. If more than one lease of different ownership is dedicated to the well, have the interests of all owners been consolidated by communitization, unitization, force-pooling, etc?

☐ Yes ☐ No If answer is "yes," type of consolidation \_\_\_\_\_

If answer is "no," list the owners and tract descriptions which have actually been consolidated (Use reverse side of this form if necessary.) \_\_\_\_\_

No allowable will be assigned to the well until all interests have been consolidated (by communitization, unitization, forced-pooling, or otherwise) or until a non-standard unit, eliminating such interests, has been approved by the Commission.

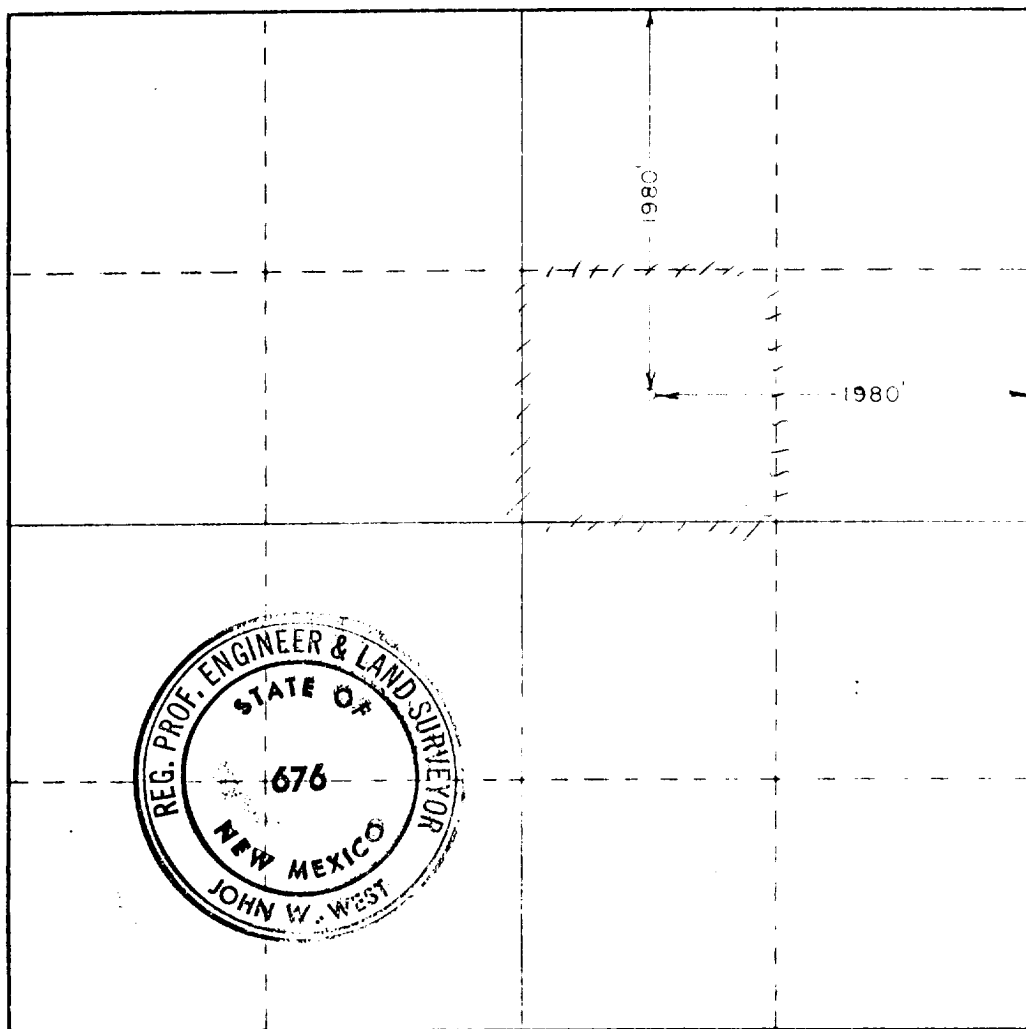

CERTIFICATION

I hereby certify that the information contained herein is true and complete to the best of my knowledge and belief.

I hereby certify that the well location shown on this plat was plotted from field notes of actual surveys made by me or under my supervision and that the same is true and correct to the best of my knowledge and belief.

May 26, 1978

Registration No. \_\_\_\_\_ Engineer  
Professional No. \_\_\_\_\_

*John W. West*

John W. West 676  
Ronald J. Eidson 3239

0 330 660 990 1320 1650 1980 2310 2640 2970 3300 3630 3960 4290 4620 4950 5280 5610 5940 6270 6600 6930 7260 7590 7920 8250 8580 8910 9240 9570 9900