

NO. OF COPIES RECEIVED	
DISTRIBUTION	
SANTA FE	
FILE	
U.S.G.S.	
LAND OFFICE	
OPERATOR	

NEW MEXICO OIL CONSERVATION COMMISSION

Form C-101
Revised 1-1-65

5A. Indicate Type of Lease	
STATE <input checked="" type="checkbox"/>	FEE <input type="checkbox"/>
5. State Oil & Gas Lease No.	

APPLICATION FOR PERMIT TO DRILL, DEEPEN, OR PLUG BACK

1a. Type of Work		7. Unit Agreement Name	
b. Type of Well OIL WELL <input checked="" type="checkbox"/> GAS WELL <input type="checkbox"/> OTHER <input type="checkbox"/>		8. Farm or Lease Name El Paso State	
2. Name of Operator Enserch Exploration, Inc.		9. Well No. 1	
3. Address of Operator Empire Central Bldg.-Suite 800, 7701 N. Stemmons Frwy., Dallas, Tx. 75247		10. Field and Pool, or Wildcat 47 Wildcat	
4. Location of Well UNIT LETTER L LOCATED 1980 FEET FROM THE South LINE AND 660 FEET FROM THE West LINE OF SEC. 8 TWP. 6-S RGE. 34E NMPM		12. County Roosevelt	
18. Proposed Depth 8000		19A. Formation Pre-Cambrian Granite	
21. Elevations (Show whether DF, RT, etc.) 4360.0		22. Approx. Date Work will start August 19, 1978	
21A. Kind & Status Plug. Bond American Insurance \$171534		21B. Drilling Contractor Ard Drilling Co.	

23.

PROPOSED CASING AND CEMENT PROGRAM

SIZE OF HOLE	SIZE OF CASING	WEIGHT PER FOOT	SETTING DEPTH	SACKS OF CEMENT	EST. TOP
17 1/2	13 3/8	40	50	40	Surface
12 1/4	8 5/8	24 & 32	2000	1150	Surface
7 7/8	5 1/2	15.5	8000	800	6000

Drill exploratory to 8000' in search of oil. Will set 13 3/8" conductor pipe and 8 5/8" surface casing with 8 5/8" 3000# braden head.

Rig up 12" 3000# double hydraulic B.O.P. & 10" 3000# hydril on top of braden head. 3000# choke manifold will be used from 2000' to TD.

APPROVAL VALID
FOR 90 DAYS UNLESS
DRILLING COMMENCED,

EXPIRES Nov. 15, 1978

IN ABOVE SPACE DESCRIBE PROPOSED PROGRAM; IF PROPOSAL IS TO DEEPEN OR PLUG BACK, GIVE DATA ON PRESENT PRODUCTIVE ZONE AND PROPOSED NEW PRODUCTIVE ZONE. GIVE BLOWOUT PREVENTER PROGRAM, IF ANY.

I hereby certify that the information above is true and complete to the best of my knowledge and belief.

Signed Leary B. Basher Title Drilling Supervisor Date August 14, 1978

(This space for State Use)

APPROVED BY John W. Runyan TITLE Geologist DATE AUG 15 1978

CONDITIONS OF APPROVAL, IF ANY:

RECEIVED

AUG 14 1978

CH. CONSERVATION COMM.
DOBS, D. M.

NEW MEXICO OIL CONSERVATION COMMISSION
WELL LOCATION AND ACREAGE DEDICATION PLAT

Form C-102
 Supersedes C-128
 Effective 1-1-65

All distances must be from the outer boundaries of the Section

Operator Enserch Exploration Inc.			Lease El Paso State		Well No. 1
Grid Letter L	Section 8	Township 6 South	Range 34 East	County Roosevelt	
Actual Footage Location of Well: 1980 feet from the South line and 660 feet from the West line					
Ground Level Elev. 4360.0	Producing Formation Pre-Cambrian Granite		Pool Wildcat		Dedicated Acreage: 40 Acres

1. Outline the acreage dedicated to the subject well by colored pencil or hachure marks on the plat below.
2. If more than one lease is dedicated to the well, outline each and identify the ownership thereof (both as to working interest and royalty).
3. If more than one lease of different ownership is dedicated to the well, have the interests of all owners been consolidated by communitization, unitization, force-pooling, etc?

☐ Yes ☐ No If answer is "yes," type of consolidation _____

If answer is "no," list the owners and tract descriptions which have actually been consolidated. (Use reverse side of this form if necessary.) _____

No allowable will be assigned to the well until all interests have been consolidated (by communitization, unitization, forced-pooling, or otherwise) or until a non-standard unit, eliminating such interests, has been approved by the Commission.

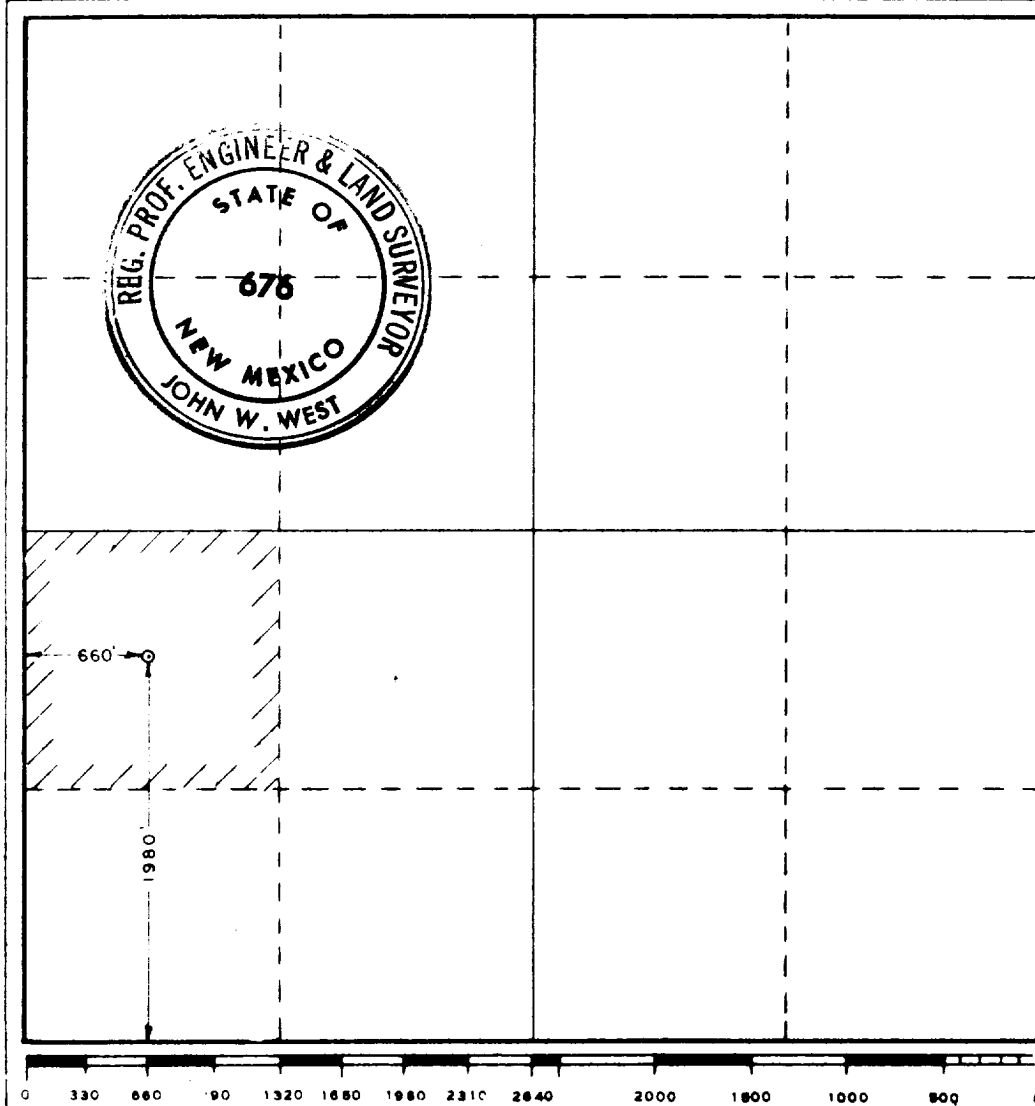

CERTIFICATION

I hereby certify that the information contained herein is true and complete to the best of my knowledge and belief.

Name *Ken Brasher*
 Position **Drilling Supervisor**

Company
Enserch Exploration, Inc.

Date
August 14, 1978

I hereby certify that the well location shown on this plat was plotted from field notes of actual surveys made by me or under my supervision, and that the same is true and correct to the best of my knowledge and belief.

Date Surveyed
August 8, 1978

Registered Professional Engineer and/or Land Surveyor

John W. West
 Certificate No. **John W. West 676**
Ronald J. Eidson 3239

RECEIVED

AUG 14 1978

OIL CONSERVATION COMM.
HOBBS, N. M.

FILE