

UNITED STATES DEPARTMENT OF THE INTERIOR
BUREAU OF LAND MANAGEMENT
WASHINGTON, D. C. 20250

APPLICATION FOR PERMIT TO DRILL DEEPER THAN 3000 FEET

LAND STATE OF TEXAS
COUNTY OF ODESSA
SECTION 31, T. 23N, R. 10E, S. 10E

APPLICANT'S NAME: **Phillips Petroleum Company**
ADDRESS: **4001 Penbrook Street, Room 401, Phillips Bldg., Odessa, Texas 79762**
DATE: **J 1980** TIME: **east**
WELL NO.: **2055** LOCATION: **south 31 5-5 33-E**
CITY: **Roosevelt**
DEPT. OF LAND MANAGEMENT: **6000' Fusselman**
TYPE OF WELL: **rotary**
APPROX. DATE WORK WILL START: **upon approval**
MATERIALS: **4410.1 GR Blanket advise later**

| SIZE OF PIPE | DEPT. OF LAND MANAGEMENT | EST. TOP |
|--------------|--|---|
| 17 1/2" | 13 3/8" 48#H-40, 54#K-55 (followed by 150 sx Cl-H w/2% A-7) | 350' (270sxCl-H w/1#Celloflakes) Circ @ (surface) |
| 11" | 8 5/8" 24#K-55 (followed by 200 sx Cl-H w/2% A-7) | 3500' (440sxCl-Hw/2%A-2,) Circ @ surface |
| 7 7/8" | 5 1/2" 17# & 15.5# K-55 (base w/0.5 of 1%D-19 & 5# KCL/sx) | 8000' (TD) (300sx BJLW w/Class H) TOC appx 5500' |

Use mud additives as required for control.
BOP Eqpt. Series 900 3000# WP (See Figure 6 attached)

APPROVAL FOR 90 DAYS UNLESS DRILLING COMMENCED,
EXPIRES Jan 26, 1978

APPROVED BY: W. J. Mueller Engineering Advisor DATE: 10-20-78
John W. Runyon Geologist
APPROVED BY: John W. Runyon DATE: OCT 26 1978

**NEW ICO OIL CONSERVATION COMMISSION
WELL LOCATION AND ACREAGE DEDICATION PLAT**

Form C-102
Supersedes C-128
Effective 1-1-65

All distances must be from the outer boundaries of the Section

| | | | | | |
|--|---|----------------------------|---|----------------------------|---------------------------------------|
| Operator Phillips Petroleum Co. | | | Lease Lambirth "A" | | Well No. 1 |
| Unit Letter J | Section 31 | Township 5 South | Range 33 East | County Roosevelt | |
| Actual Footage Location of Well: 2055 feet from the South line and 1980 feet from the East line | | | | | |
| Ground Level Elev. 4410.1 | Producing Formation Petroleum | | Pool Peterson South Petroleum | | Dedicated Acreage: 80 Acres |

1. Outline the acreage dedicated to the subject well by colored pencil or hatchure marks on the plat below.
2. If more than one lease is dedicated to the well, outline each and identify the ownership thereof (both as to working interest and royalty).
3. If more than one lease of different ownership is dedicated to the well, have the interests of all owners been consolidated by communitization, unitization, force-pooling, etc?

☐ Yes ☐ No If answer is "yes," type of consolidation _____

If answer is "no," list the owners and tract descriptions which have actually been consolidated. (Use reverse side of this form if necessary.) _____

No allowable will be assigned to the well until all interests have been consolidated (by communitization, unitization, forced-pooling, or otherwise) or until a non-standard unit, eliminating such interests, has been approved by the Commission.

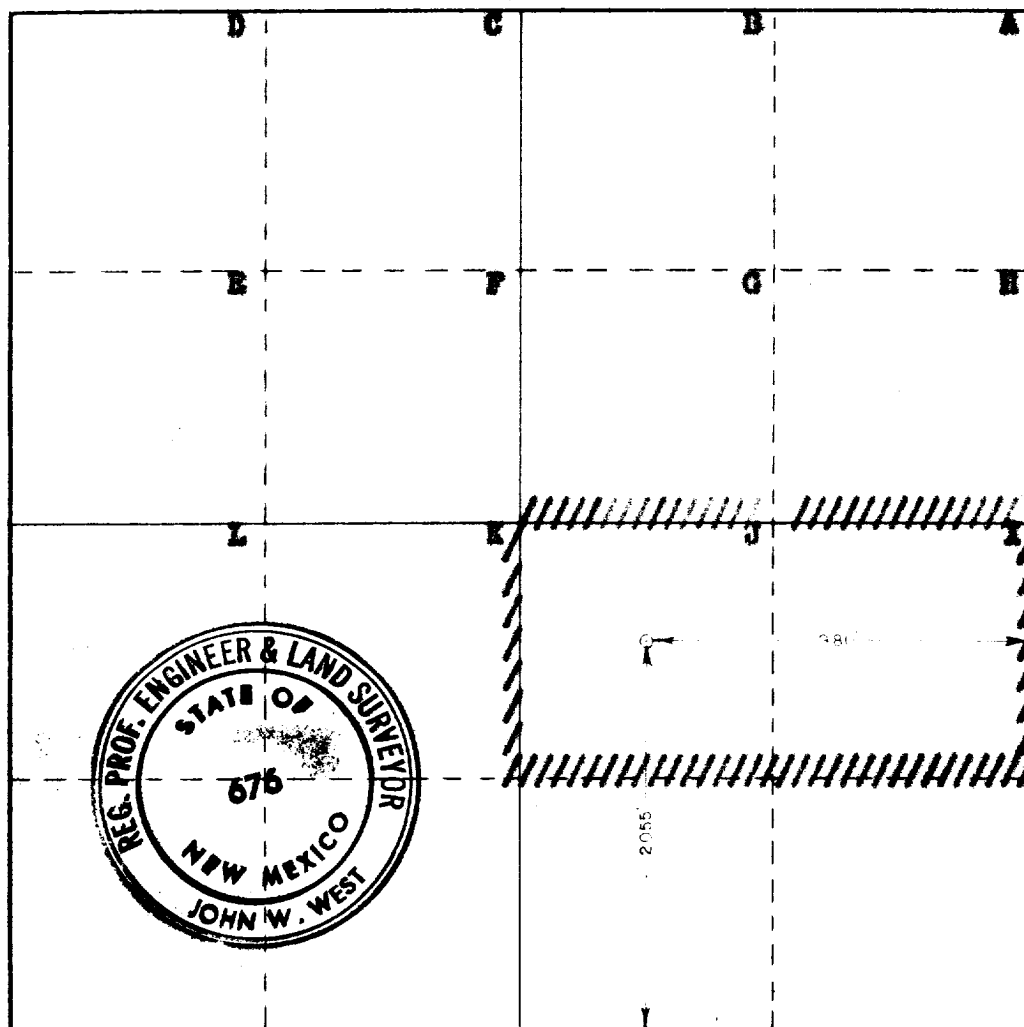

CERTIFICATION

I hereby certify that the information contained herein is true and complete to the best of my knowledge and belief.

[Signature]
Name **W. J. Mueller**

Position
Engineering Advisor

Company
Phillips Petroleum Company

Date
October 20, 1978

I hereby certify that the well location shown on this plat was plotted from field notes of actual surveys made by me or under my supervision, and that the same is true and correct to the best of my knowledge and belief.

Date Surveyed
October 17, 1978

Registered Professional Engineer and/or Land Surveyor

[Signature]
Certificate No. **John W. West**

676

Ronald J. Eidson 3239

0 330 660 990 1320 1650 1980 2310 2640 2970 3300 3630 3960 4290 4620 4950 5280 5610 5940 6270 6600

DOUBLE PREVENTER OPTION

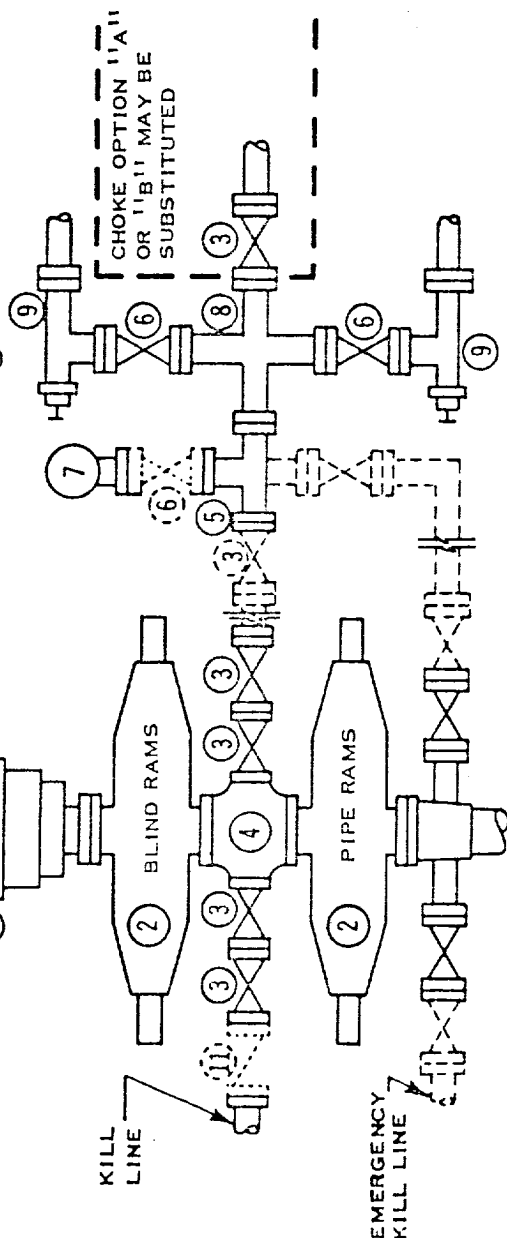
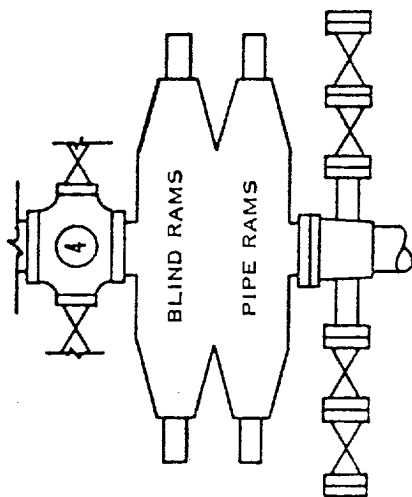

NOTES:

1. 3000 PSI WP OR BETTER CLAMP HUBS MAY BE SUBSTITUTED FOR FLANGES
2. ONE ADJUSTABLE CHOKE MAY BE REPLACED WITH A POSITIVE CHOKE
3. VALVES MAY BE EITHER HAND OR POWER OPERATED BUT, IF POWER OPERATED, THE VALVES FLANGED TO THE BOP RUN MUST BE CAPABLE OF BEING OPENED AND CLOSED MANUALLY OR CLOSE ON POWER FAILURE AND BE CAPABLE OF BEING OPENED MANUALLY

..... OPTIONAL EQUIPMENT

PHILLIPS PETROLEUM COMPANY
3000 PSI WORKING PRESSURE
BLOWOUT PREVENTER HOOK-UP
(SERIES 900 FLANGES OR BETTER)

RECEIVED

COPIES

OIL CONSERVATION DIVISION
MARCH 4, 1964

113