

**NEW MEXICO OIL CONSERVATION COMMISSION
WELL LOCATION AND ACREAGE DEDICATION PLAT**

Form C-102
Supersedes C-128
Effective 1-1-65

All distances must be from the outer boundaries of the Section.

Operator Enserch Exploration, Inc.			Lease Lambirth		Well No. 9
Unit Letter P	Section 25	Township 5 South	Range 32 East	County Roosevelt	
Actual Footage Location of Well: 560 feet from the South line and 560 feet from the East line					
Ground Level Elev. 4368.4	Producing Formation Fusselman	Pool Undesignated		Dedicated Acreage 80 Acres	

1. Outline the acreage dedicated to the subject well by colored pencil or hatchure marks on the plat below.
2. If more than one lease is dedicated to the well, outline each and identify the ownership thereof (both as to working interest and royalty).
3. If more than one lease of different ownership is dedicated to the well, have the interests of all owners been consolidated by communitization, unitization, force-pooling, etc?

☐ Yes ☐ No If answer is "yes," type of consolidation _____

If answer is "no," list the owners and tract descriptions which have actually been consolidated (Use reverse side of this form if necessary.) _____

No allowable will be assigned to the well until all interests have been consolidated (by communitization, unitization, forced-pooling, or otherwise) or until a non-standard unit, eliminating such interests, has been approved by the Commission.

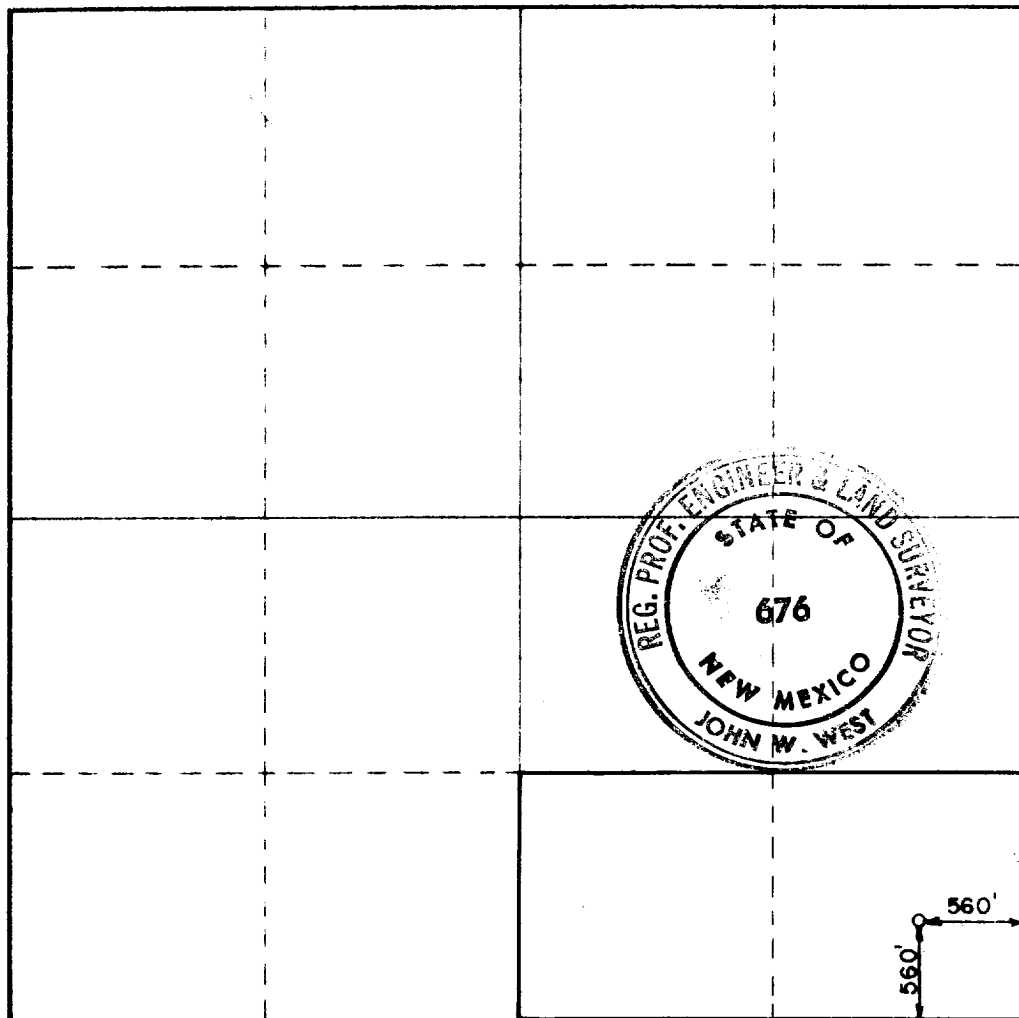

CERTIFICATION

I hereby certify that the information contained herein is true and complete to the best of my knowledge and belief.

Name
Danny E. Hagins
Position
Sr. Drilling Supervisor

Company
Enserch Exploration, Inc.

Date
December 3, 1979

I hereby certify that the well location shown on this plat was plotted from field notes of actual surveys made by me or under my supervision, and that the same is true and correct to the best of my knowledge and belief.

Date surveyed
November 27, 1979

Registered Professional Engineer and/or Land Surveyor

John W. West
Certificate No. **John W. West 676**
Ronald J. Eidson 3239

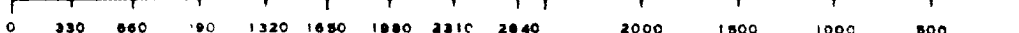

RECEIVED

DEC - 5 1979

OIL CONSERVATION DIV

173

(7) Petroleum Information.

© Copyrighted Reproduction Prohibited

COUNTY ROOSEVELT FIELD Peterson, S. STATE NM
 OPR ENSERCH EXPLORATIONS, INC. API 30-041-20523
 NO 9 LEASE Lambirth MAP
Sec 25, T5S, R32E CO-ORD
560' FSL, 560' FEL of Sec 3-4-27 NM
6 mi SE/Elida SPD 12-16-79 CMP 2-26-80

CSG	WELL CLASS: INIT <u>D</u> FINDO <u>ELEV</u> L & S			
	FORMATION	DATUM	FORMATION	DATUM
	TD <u>7960'</u> (FSLM)		PBD <u>7895'</u>	

IP (Fusselman) Perfs 7824-38' P 82 BOPD + 2 BW. Pot based
 on 24 hr test. GOR 1158; gty 51.2

CONTR Rial OPR ELEV 4368' GL PD 8000' RT

F.R. 12-10-79
 (Fusselman)
 12-26-79 Drlg 5246' 1m
 1-9-80 TD 7830'; Rng DST #1
 1-22-80 TD 7960'; WOCT
 DST (NR)
 1-28-80 TD 7960'; PBD 7895'; Flwg
 Perf (Fusselman) 7824-38' w/1 SPF
 1-30-80 TD 7960'; PBD 7895'; Swbg
 Acid (7824-38') 650 gals
 2-5-80 TD 7960'; PBD 7895'; Prep RUP
 2-18-80 TD 7960'; PBD 7895'; TOP
 Ppd 105 BO in 24 hrs (7824-38')
 3-17-80 TD 7960'; PBD 7895'; Complete
 Will Re-issue if DST becomes available
 LOG TOPS: Yates 2074', San Andres 3098', Glorieta
 4430', Tubb 5757', Abo 6508', Wolfcamp 7134',
 Pennsylvanian 7562', Cisco 7682', Silurian 7768',
 Fusselman 7822'
 3-22-80 Rig Released 1-14-80 3-4-27 NM
 COMPLETION ISSUED IC 30-041-70043-79