

30-041-20527

NO. OF COPIES RECEIVED	
DISTRIBUTION	
SANTA FE	
FILE	
U.S.G.S.	
LAND OFFICE	
OPERATOR	

NEW MEXICO OIL CONSERVATION COMMISSION

Form C-101
Revised 1-1-65

5A. Indicate Type of Lease	
STATE <input type="checkbox"/>	FEE <input checked="" type="checkbox"/>
5. State Oil & Gas Lease No.	

APPLICATION FOR PERMIT TO DRILL, DEEPEN, OR PLUG BACK

1a. Type of Work				7. Unit Agreement Name	
b. Type of Well DRILL <input checked="" type="checkbox"/> DEEPEN <input type="checkbox"/> PLUG BACK <input type="checkbox"/> OIL WELL <input checked="" type="checkbox"/> GAS WELL <input type="checkbox"/> OTHER <input type="checkbox"/> SINGLE ZONE <input type="checkbox"/> MULTIPLE ZONE <input type="checkbox"/>					
2. Name of Operator SUNDANCE OIL COMPANY				8. Farm or Lease Name Newman	
3. Address of Operator Suite 510, 1776 Lincoln Street, Denver, CO 80203				9. Well No. 1	
4. Location of Well UNIT LETTER <u>C</u> LOCATED <u>660</u> FEET FROM THE <u>North</u> LINE AND <u>1980</u> FEET FROM THE <u>West</u> LINE OF SEC. <u>35</u> TWP. <u>6S</u> RGE. <u>32E</u> NMPM				10. Field and Pool, or Wildcat Wildcat	
				12. County Roosevelt	
18. Proposed Depth 4500'		19A. Formation San Andres		20. Rotary or C.T. Rotary	
21. Elevations (Show whether DF, RI, etc.) 4446.0' GL		21A. Kind & Status Plug, Bond One-Well		21B. Drilling Contractor W.E.K. Drilling	
				22. Approx. Date Work will start January 28, 1980	

PROPOSED CASING AND CEMENT PROGRAM

SIZE OF HOLE	SIZE OF CASING	WEIGHT PER FOOT	SETTING DEPTH	SACKS OF CEMENT	EST. TOP
11"	8 5/8"	24#	1800'	600	Surface
7 7/8"	4 1/2"	10.5#	4500'	300	3000'

Drill 11" hole to 1800' (top of Salado). Run and set 8 5/8" casing at 1800'. Circulate cement to surface. Drill 7 7/8" hole to TD (4500' estimated). Log and test all prospective pay zones, i.e. P-2 and P-3 zones of the San Andres Formation. Run and cement 4 1/2" production casing if commercial production is found.

IN ABOVE SPACE DESCRIBE PROPOSED PROGRAM: IF PROPOSAL IS TO DEEPEN OR PLUG BACK, GIVE DATA ON PRESENT PRODUCTIVE ZONE AND PROPOSED NEW PRODUCTIVE ZONE. GIVE BLOW-OUT PREVENTER PROGRAM, IF ANY.

I hereby certify that the information above is true and complete to the best of my knowledge and belief.

Signed Richard O. Pimit Title Vice President, Production Date 1/21/80

(This space for State Use)

APPROVED BY [Signature] TITLE [Signature] DATE [Signature]

CONDITIONS OF APPROVAL, IF ANY:

**NEW MEXICO OIL CONSERVATION COMMISSION
WELL LOCATION AND ACREAGE DEDICATION PLAT**

Form C-102
Supersedes C-128
Effective 1-1-65

All distances must be from the outer boundaries of the Section

Operator Sundance Oil Co.			Lease Newman		Well No. #1
Unit Letter C	Section 35	Township 6 South	Range 32 East	County Roosevelt	
Actual Portage Location of Well: 660 feet from the North line and 1980 feet from the West					
Ground Level Elev. 4446.0	Producing Formations San Andres	Fluid Wildcat	Estimated Acreage 40		

1. Outline the acreage dedicated to the subject well by colored pencil or hachure marks on the plat below
2. If more than one lease is dedicated to the well, outline each and identify the ownership thereof (both as to working interest and royalty).
3. If more than one lease of different ownership is dedicated to the well, have the interests of all owners been consolidated by communitization, unitization, force-pooling, etc?

☐ Yes ☐ No If answer is "yes," type of consolidation _____

If answer is "no" list the owners and tract descriptions which have actually been consolidated. Use reverse side of this form if necessary.) _____

No allowable will be assigned to the well until all interests have been consolidated (by communitization, unitization, forced-pooling, or otherwise) or until a non-standard unit, eliminating such interests, has been approved by the Commission.

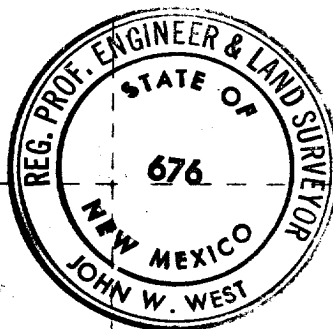
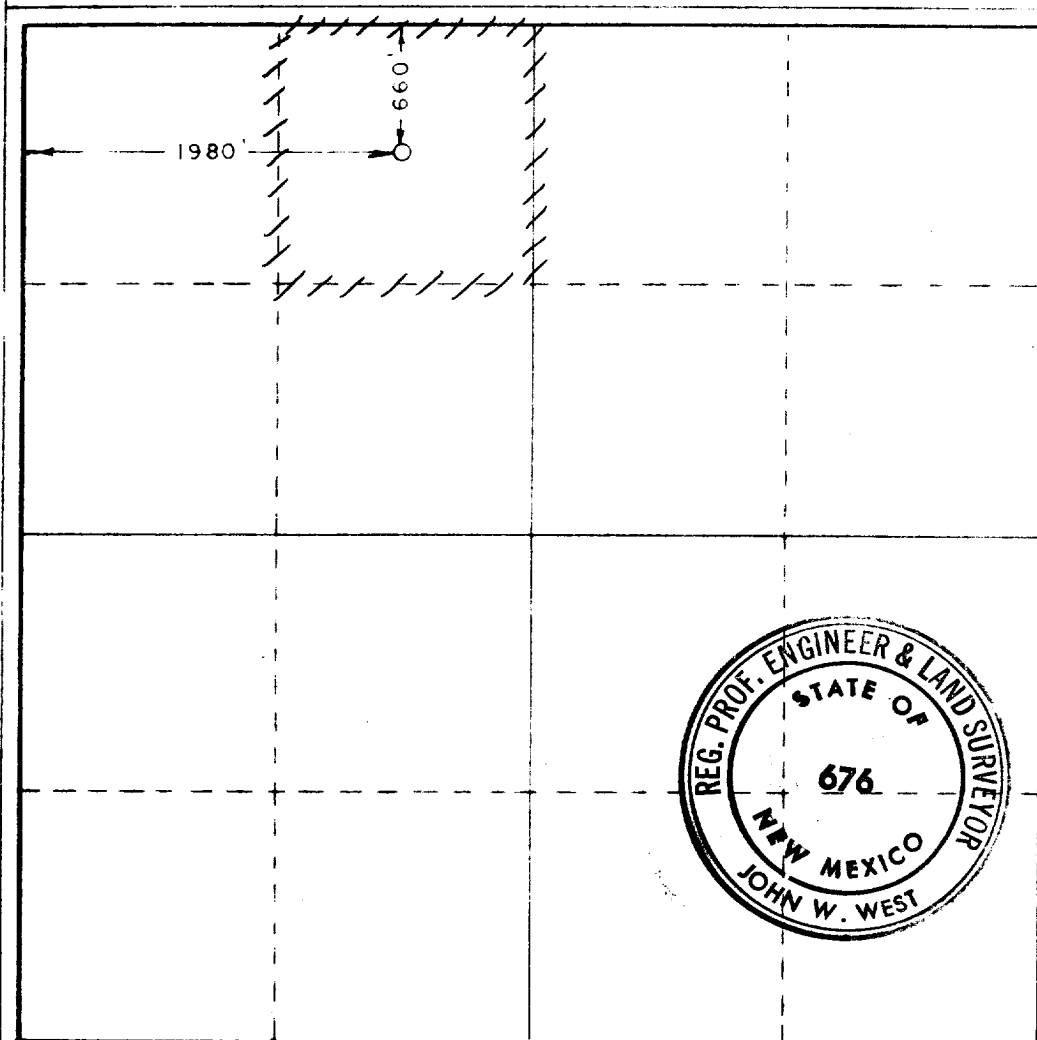

CERTIFICATION

I hereby certify that the information contained herein is true and complete to the best of my knowledge and belief.

Richard O. Dimit
Name _____

Richard O. Dimit

Vice President, Production

Sundance Oil Company

Date
January 21, 1980

I hereby certify that the well location shown on this plat was plotted from field notes of actual surveys made by me or under my supervision and that the same is true and correct to the best of my knowledge and belief.

Date Surveyed

January 9, 1980

Registered Professional Engineer and/or Land Surveyor

John W. West

Certificate No. **JOHN W. WEST 676**
PATRICK A. ROMERO 6863
Ronald J. Eidson 3239

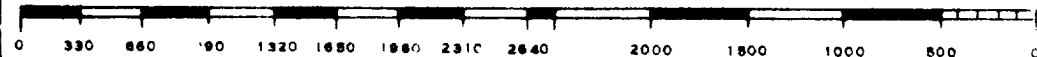

RECEIVED
JAN 24 1980
OIL CONSERVATION DIV

173