

NO. OF COPIES RECEIVED	
DISTRIBUTION	
SANTA FE	
FILE	
U.S.G.S.	
LAND OFFICE	
OPERATOR	

1A. Indicate Type of Lease
STATE <input checked="" type="checkbox"/> FEDERAL <input type="checkbox"/>

5. State Oil & Gas Lease No.
L-4524

## APPLICATION FOR PERMIT TO DRILL, DEEPEN, OR PLUG BACK

1a. Type of Work			7. Unit Agreement Name		
b. Type of Well DRILL <input checked="" type="checkbox"/> DEEPEN <input type="checkbox"/> PLUG BACK <input type="checkbox"/> OIL WELL <input checked="" type="checkbox"/> GAS WELL <input type="checkbox"/> OTHER <input type="checkbox"/> SINGLE ZONE <input type="checkbox"/> MULTIPLE ZONE <input type="checkbox"/>			8. Firm or Lease Name Roosevelt State		
2. Name of Operator American Quasar Petroleum Company of New Mexico			9. Well No. 1		
3. Address of Operator 1000 Midland National Bank Tower, Midland, TX 79707			10. Field and Pool, or Wildcat Wildcat		
4. Location of Well UNIT LETTER M LOCATED 660 FEET FROM THE South LINE AND 660 FEET FROM THE West LINE OF SEC. 16 TWP. 6S RGF. 34E NMPM			12. County Roosevelt		
19. Proposed Depth 8000'			19A. Formation Fusselman		20. Rotary or C.T. Rotary
21. Elevations (Show whether DF, RT, etc.) 4354' Ground	21A. Kind & Status Plug. Bond Blanket	21B. Drilling Contractor Cactus Drilling Co.	22. Approx. Date Work will start May 5, 1980		

## PROPOSED CASING AND CEMENT PROGRAM

SIZE OF HOLE	SIZE OF CASING	WEIGHT PER FOOT	SETTING DEPTH	SACKS OF CEMENT	EST. TOP
17-1/2"	13-3/8"	48#	350	350	Circulate
12-1/4"	8-5/8"	24#	2000	1000	Circulate
7-7/8"	4-1/2"	11.60#	8000	300	7000

Set 30' conductor casing with rathole machine and cement to surface. The 13-3/8" surface casing will be set with cable tools and cemented to surface by pump and plug displacement; the 8-5/8" intermediate casing will be set by rotary and cemented to surface by pump and plug displacement. If commercial production is encountered, the 4-1/2" casing will be set by rotary and cement brought to a depth sufficient to cover all potentially production zones.

The 13-3/8" casing and BOPs will be tested to 600 psi prior to drilling out casing shoe; the 8-5/8" casing will be tested to 1000 psi prior to drilling out casing shoe and BOP will be tested accordingly; the 4-1/2" casing will be tested to 1500 psi prior to perforating for production.

APPROVAL VALID  
FOR 90 DAYS UNLESS  
DRILLING COMMENCED,

EXPIRES Aug 15, 1980

IN ABOVE SPACE DESCRIBE PROPOSED PROGRAM; IF PROPOSAL IS TO DEEPEN OR PLUG BACK, GIVE DATE OF PRODUCTION ZONE AND PROPOSED NEW PRODUCTION ZONE. GIVE SLOWOUT PREVENTER PROGRAM, IF ANY.

I hereby certify that the information above is true and complete to the best of my knowledge and belief.

Signed David E. Bink Title Agent Date April 29, 1980

(This space for State Use)

APPROVED BY W. W. Thompson TITLE Geologist DATE MAY 15 1980

CONDITIONS OF APPROVAL, IF ANY

RECEIVED

MAY 6 1980

OIL CONSERVATION DIV.

RECEIVED

MAY 13 1980

OIL CONSERVATION DIV.

**N MEXICO OIL CONSERVATION COMMISSION**  
**WELL LOCATION AND ACREAGE DEDICATION PLAT**

Form O-100  
 Supersedes C-128  
 Effective 1-1-65

All distances must be from the outer boundaries of the Section.

Petroleum <b>American Quasar Co. of New Mexico</b>			Lease <b>ROOSEVELT STATE</b> <del>NEW MEXICO STATE</del>		Well No. <b>1</b>
Section <b>M</b>	Section <b>16</b>	Township <b>6 South</b>	Range <b>34 East</b>	County <b>Roosevelt</b>	
1. Well Location of Well: <b>660</b> feet from the <b>South</b> line and <b>660</b> feet from the <b>West</b> line					
Elevation <b>4354'</b>	Producing Formation <b>Fussein</b>	Pool <b>WILDCAT</b>	Dedicated Acreage: <b>40</b> Acres		

1. Outline the acreage dedicated to the subject well by colored pencil or hatchure marks on the plat below.
2. If more than one lease is dedicated to the well, outline each and identify the ownership thereof (both as to working interest and royalty).
3. If more than one lease of different ownership is dedicated to the well, have the interests of all owners been consolidated by communitization, unitization, force-pooling, etc?

☐ Yes    ☐ No    If answer is "yes," type of consolidation \_\_\_\_\_

If answer is "no," list the owners and tract descriptions which have actually been consolidated. (Use reverse side of this form if necessary.) \_\_\_\_\_

No allowable will be assigned to the well until all interests have been consolidated (by communitization, unitization, forced-pooling, or otherwise) or until a non-standard unit, eliminating such interests, has been approved by the Commission.

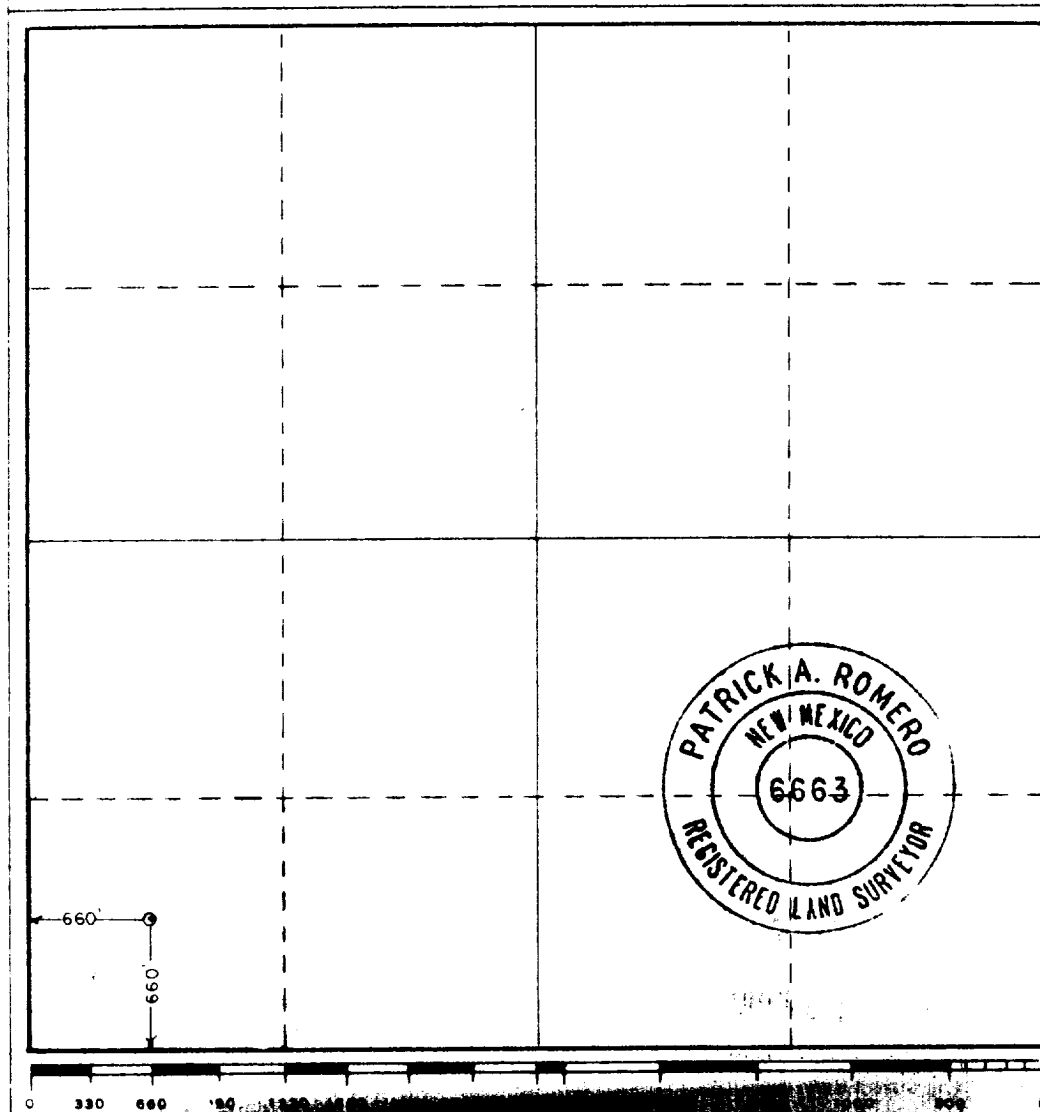

**CERTIFICATION**

I hereby certify that the information contained herein is true and complete to the best of my knowledge and belief.

*Samuel E. Burke*  
 Name \_\_\_\_\_

*Agent*  
 Position \_\_\_\_\_

Company \_\_\_\_\_

Date *May 8, 1980*

I hereby certify that the well location shown on this plat was plotted from field notes of actual surveys made by me or under my supervision, and that the same is true and correct to the best of my knowledge and belief.

Date Surveyed  
**April 25, 1980**

Registered Professional Engineer and/or Land Surveyor

*Patrick A. Romero*  
 Certificate No. **JOHN W. WEST 678**  
**PATRICK A. ROMERO 6663**  
**Ronald J. Eidson 3239**

RECEIVED  
MAY 6 1980  
OIL CONSERVATION DIV.

RECEIVED  
MAY 13 1980  
OIL CONSERVATION DIV.

FILE

*Log program  
18/1/80*